

Manuals.plus /

- › Briggs & Stratton /
- › Briggs & Stratton 693502 Fuel Pump Kit Replacement Part Instruction Manual

Briggs & Stratton 693502



Briggs & Stratton 693502 Fuel Pump Kit Instruction Manual

Genuine Replacement Part for Small Engines

[Introduction](#) [Installation](#) [Operation](#) [Maintenance](#) [Troubleshooting](#) [Specifications](#)
[Warranty & Support](#)

1. INTRODUCTION

This manual provides essential information for the proper installation, operation, and maintenance of your Briggs & Stratton 693502 Fuel Pump Kit. This genuine OEM replacement part is designed to restore optimal fuel delivery to your small engine, ensuring reliable performance for your lawn mower, generator, or other compatible equipment. Using genuine Briggs & Stratton parts helps maintain the engine's performance and compliance with emission regulations.

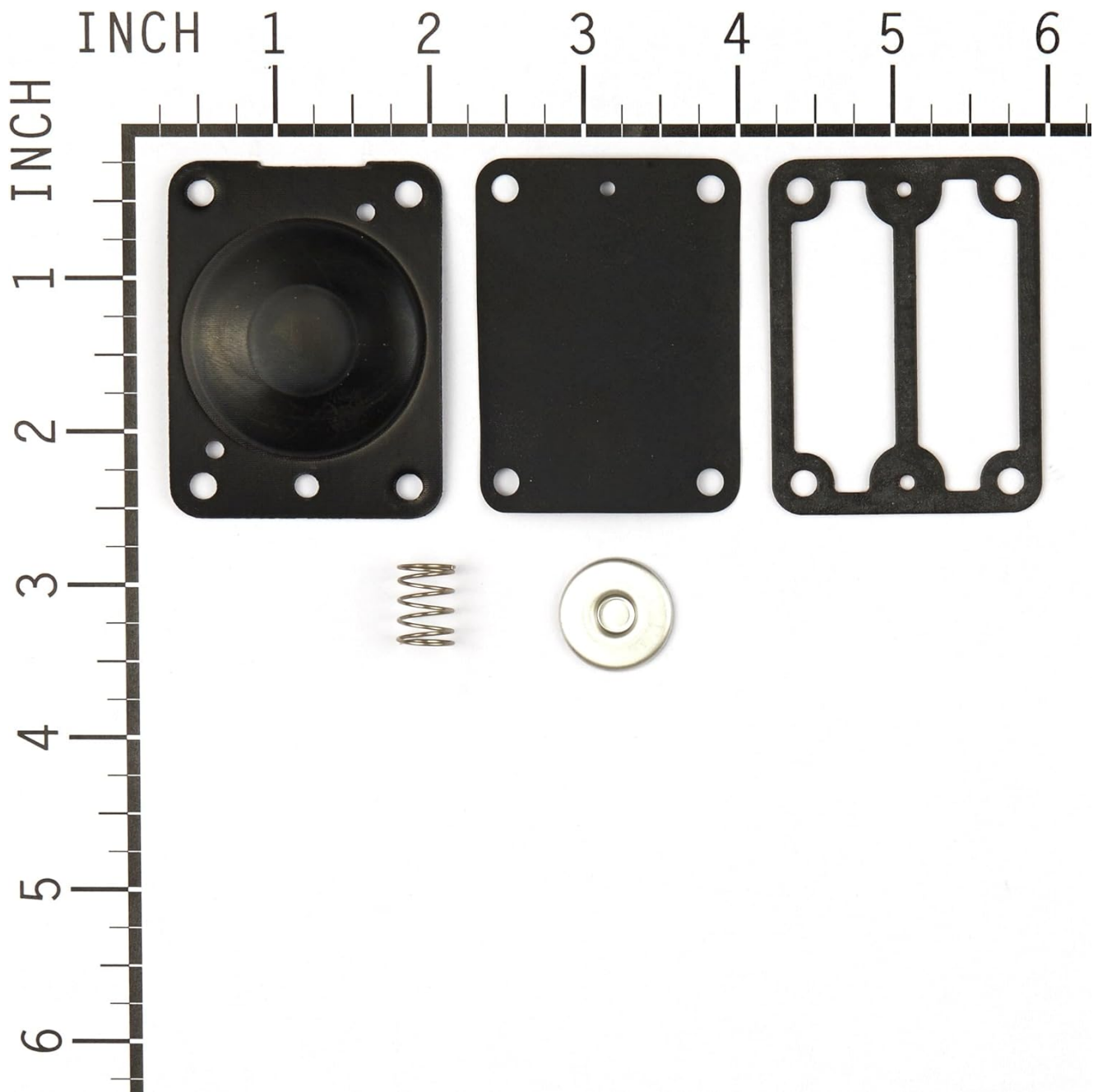

Image 1.1: Briggs & Stratton 693502 Fuel Pump Kit

The kit includes the necessary components to replace a worn or faulty fuel pump, often characterized by a hardened diaphragm that prevents proper fuel transfer. Regular maintenance and timely replacement of such critical components are vital for the longevity and efficiency of your engine.

2. INSTALLATION

Safety First: Before beginning any installation, ensure the engine is cool, the spark plug wire is disconnected to prevent accidental starting, and the fuel tank is either empty or the fuel line is clamped to prevent spills. Wear appropriate personal protective equipment, including gloves and eye protection.

2.1 Kit Contents

Familiarize yourself with the components included in your 693502 Fuel Pump Kit:

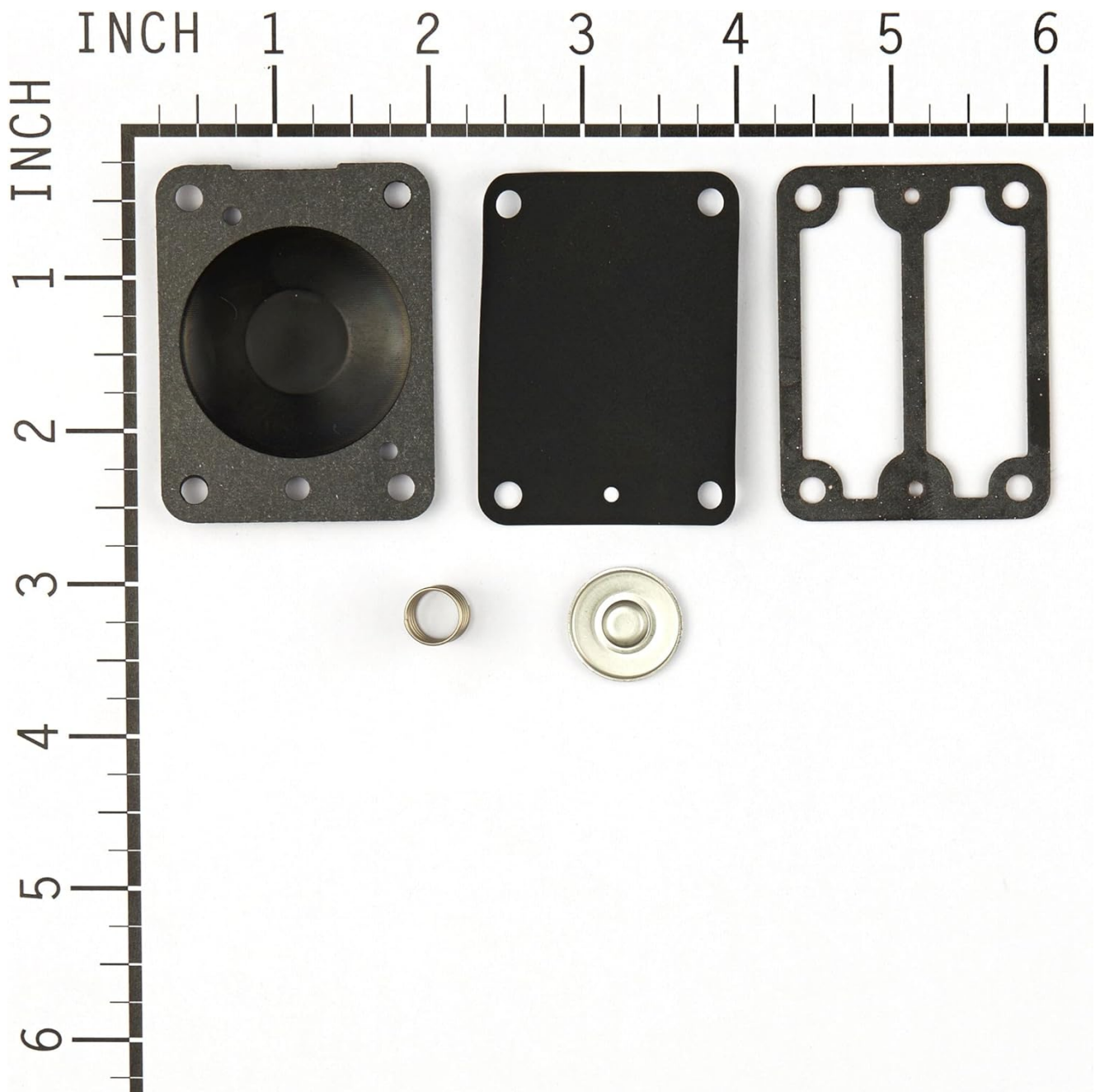

Image 2.1: Disassembled components of the fuel pump kit, including diaphragm, gaskets, spring, and washer.

2.2 Removal of Old Fuel Pump

1. Locate the existing fuel pump on your engine. It is typically mounted near the carburetor or engine block.
2. Carefully disconnect the fuel lines attached to the old pump. Be prepared for minor fuel leakage and have rags ready. Note the orientation of the lines for correct reattachment.
3. Remove any mounting screws or bolts securing the old fuel pump to the engine.
4. Gently detach the old fuel pump and its associated gaskets/diaphragm. Inspect the mounting surface for any debris or residue and clean if necessary.

2.3 Installation of New Fuel Pump Kit

1. Ensure the engine mounting surface is clean and free of old gasket material.
2. Assemble the new fuel pump components as shown in the kit diagram or by reversing the disassembly process of the old pump. Pay close attention to the correct layering of the diaphragm and gaskets.
3. Position the new fuel pump kit onto the engine, aligning it with the mounting holes.

4. Secure the fuel pump with the original mounting screws or bolts. Do not overtighten.
5. Reconnect the fuel lines to the new pump, ensuring a snug and leak-free connection. Double-check that the lines are connected to the correct inlet and outlet ports.



Image 2.2: The Briggs & Stratton 693502 Fuel Pump Kit as packaged.

3. OPERATION

After installation, perform the following steps to ensure proper operation:

1. Reconnect the spark plug wire.
2. Fill the fuel tank with fresh, clean gasoline.
3. Check all fuel line connections for leaks.
4. Start the engine according to the manufacturer's instructions for your specific equipment. The engine should start more readily and run smoothly if the fuel pump was the issue.
5. Monitor the engine for any unusual noises, fuel leaks, or performance issues during initial operation.

4. MAINTENANCE

To ensure the longevity and optimal performance of your fuel system and engine:

- **Use Fresh Fuel:** Always use fresh, clean gasoline. Stale fuel can lead to deposits and damage to fuel system components, including the fuel pump diaphragm.
- **Fuel Stabilizer:** For engines stored for extended periods, use a high-quality fuel stabilizer like Briggs & Stratton's own or Sta-Bil to prevent fuel degradation.
- **Regular Inspections:** Periodically inspect fuel lines and the fuel pump for cracks, leaks, or signs of wear. Replace any damaged components promptly.
- **Genuine Parts:** Always use genuine Briggs & Stratton replacement parts to ensure compatibility, performance, and adherence to OEM standards.

5. TROUBLESHOOTING

If your engine still experiences fuel delivery issues after replacing the fuel pump kit, consider the following:

- **No Start/Hard Start:**
 - **Check Fuel Lines:** Ensure all fuel lines are correctly connected, not kinked, and free of blockages.
 - **Fuel Filter:** A clogged fuel filter can restrict fuel flow. Inspect and replace if necessary.
 - **Carburetor Issues:** If the fuel pump is functioning, the issue might be with the carburetor (e.g., clogged jets, faulty float).
 - **Spark Plug/Ignition:** Verify the spark plug is clean, gapped correctly, and producing a strong spark.
- **Fuel Leaks:**
 - **Connection Points:** Re-check all fuel line connections to the pump and carburetor for tightness.
 - **Gasket Seating:** Ensure the fuel pump gaskets are properly seated and not pinched.
- **Engine Stalling/Rough Running:**
 - **Consistent Fuel Flow:** Confirm the fuel pump is providing a consistent flow of fuel to the carburetor.
 - **Air Leaks:** Check for any air leaks around the fuel pump or carburetor mounting surfaces.

If troubleshooting steps do not resolve the issue, it is recommended to consult a certified Briggs & Stratton service technician.

6. SPECIFICATIONS

Feature	Detail
Model Number	693502
Brand	Briggs & Stratton
Fit Type	Universal Fit
Vehicle Service Type	Lawn Mower, Generator, Small Engine
Material	Plastic
Item Dimensions (L x W x H)	6 x 6 x 0.25 inches
Item Weight	0.01 Ounces
Outlet Connection Type	Quick Connect
Inlet Connection Type	Fuel hose/Quick-connect fitting
Gas Type	Gasoline
Operation Mode	Automatic
Product Grade	Replacement Part (OE Specification Met)

7. WARRANTY & SUPPORT

Briggs & Stratton genuine parts are manufactured to high standards. For specific warranty information regarding this product, please refer to the documentation included with your purchase or visit the official Briggs & Stratton website. For technical support or assistance, please contact Briggs & Stratton customer service directly.

You can find more information and contact details on the official Briggs & Stratton website:

www.briggsandstratton.com