

SKYLINK TM-318

SkylinkHome TM-318 Snap-On Wireless Remote Lighting Control Transmitter User Manual

Model: TM-318 | Brand: SKYLINK

INTRODUCTION

The SkylinkHome TM-318 Snap-On Wireless Remote Lighting Control Transmitter is designed to provide convenient wireless control over your lighting and small appliances. It offers the flexibility to turn lights on and off, or dim and brighten them, from a distance of up to 500 feet in an open area. This transmitter is specifically designed to snap into the opening of the Skylink Wall Switches (WE-001 & WR-001) but can also work with other SkylinkHome Receivers. Key features include:

- Requires SkylinkHome Receivers for wireless remote home control (sold separately).
- Designed to fit and work with WE-001 and WR-001 SkylinkHome Wall Switch Receivers, and compatible with other SkylinkHome Receivers.
- Provides convenient wireless lighting control at your fingertips, ideal for bedside use.
- Easily snaps onto a SkylinkHome Wall Switch for local operation or snaps out for remote use.
- Operating range up to 500 feet.
- Includes a long-life lithium battery.
- **Note:** This transmitter does not work by itself and requires a compatible SkylinkHome Receiver.

SETUP AND INSTALLATION

The TM-318 transmitter is designed for easy integration with your existing SkylinkHome system. It comes with a long-life lithium battery already included.

Compatibility

The TM-318 is compatible with SkylinkHome WE-001 and WR-001 Wall Switches, as well as other SkylinkHome Receivers. Ensure you have a compatible receiver for the transmitter to function.



Image: The SkylinkHome TM-318 remote shown with compatible WE-001 and WR-001 Wall Switches.

Snapping into a Wall Switch

For local operation, the TM-318 can be easily snapped into the designated opening of a compatible SkylinkHome Wall Switch. This allows you to use the remote as a fixed switch on your wall.

Snap a cover into your Skylink Wall Switch.



Image: A hand demonstrating how to snap the TM-318 remote into a Skylink Wall Switch for integrated control.

When you need to use it as a portable remote, simply snap it out of the wall switch.

OPERATING INSTRUCTIONS

The TM-318 transmitter provides wireless control for various SkylinkHome receivers. Its simple push-button style allows for straightforward operation.

Basic Control

Press the button on the TM-318 to send commands to your paired SkylinkHome receiver. Depending on the receiver, this will turn lights or appliances on/off, or dim/brighten them. The effective operating range is up to 500 feet in an open area.

System Overview and Advanced Features

For a comprehensive understanding of the SkylinkHome system, including various receiver types, scene functions, all-on/all-off features, energy saving, motion sensor integration, and smartphone control via the Internet Hub, please

watch the official product video below. This video illustrates how different components of the SkylinkHome system work together to provide complete home control.

Your browser does not support the video tag.

Video: An overview of the SkylinkHome Control Product Line, demonstrating various receivers, control methods, and energy-saving features.

MAINTENANCE

Battery Replacement

The TM-318 uses 1 Nonstandard Lithium battery (included). If the remote's performance degrades or it stops responding, the battery may need replacement. Refer to the full user manual (link in Support section) for specific instructions on how to open the unit and replace the battery safely.

Cleaning

To clean the transmitter, wipe it gently with a soft, dry cloth. Do not use abrasive cleaners or solvents, as these may damage the unit.

TROUBLESHOOTING

If you experience issues with your TM-318 transmitter, consider the following common troubleshooting steps:

- **Remote Does Not Sync/Respond:**
 - Ensure the battery is properly installed and has sufficient charge. Replace the battery if necessary.
 - Verify that the transmitter is within the 500-foot operating range of the receiver. Obstacles like walls and large metal objects can reduce range.
 - Confirm that the transmitter is correctly paired with your SkylinkHome receiver. Refer to your receiver's manual for pairing instructions.
 - If programming a second transmitter, ensure the first programmed transmitter is turned off or deactivated during the pairing process for the new one.
- **Light Does Not Come On When Pushed:**
 - Check the receiver's status and power supply.
 - Ensure the light bulb or appliance connected to the receiver is functioning correctly.
- **Limited Durability/Button Wear:**

While designed for regular use, excessive force or frequent drops may affect the lifespan of the unit. Handle with care to prolong its operational life.

For more detailed troubleshooting or complex issues, please consult the official user manual or contact Skylink customer support.

SPECIFICATIONS

Feature	Detail
Manufacturer	Skylink
Part Number	TM-318
Item Weight	1.6 ounces

Product Dimensions	6.6 x 5.1 x 0.3 inches
Item Model Number	TM-318
Batteries	1 Nonstandard Battery (included)
Color	Off White
Style	TM-318 Snap-on Remote
Mounting Type	Wall
Switch Style	Push button
Date First Available	June 6, 2011

WARRANTY

The SkylinkHome TM-318 Snap-On Wireless Remote Lighting Control Transmitter comes with a **1 Year Warranty** from the manufacturer. Please retain your proof of purchase for warranty claims.



SUPPORT

For further assistance, detailed instructions, or to download the complete user manual, please visit the official Skylink website or refer to the PDF document provided by the manufacturer:

[Download User Manual \(PDF\)](#)

You can also visit the [SKYLINK Store on Amazon](#) for more product information and support resources.

Related Documents - TM-318

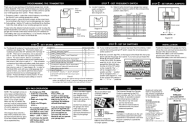
	<p>Skylink SK7 Wireless 3-Way On/Off/Dimmer Kit Installation Guide</p> <p>Comprehensive installation instructions and user guide for the Skylink SK7 Wireless 3-Way On/Off/Dimmer Kit, detailing setup, programming, operation, troubleshooting, and accessory options.</p>
	<p>Skylink SMO Side Mount Garage Door Opener Owner's Manual</p> <p>Comprehensive owner's manual for the Skylink SMO Side Mount Garage Door Opener, covering installation, programming, operation, maintenance, and troubleshooting. Learn how to safely and effectively use your garage door opener.</p>
	<p>Skylink KN-318 Garage Door Keypad User Manual</p> <p>Comprehensive user manual for the Skylink KN-318 Garage Door Keypad, covering installation, setup, programming, operation, troubleshooting, and warranty information.</p>
	<p>Skylink Model 89 Wireless Keyless Entry User's Instructions</p> <p>Comprehensive guide for the Skylink Model 89 Wireless Keyless Entry system. Learn how to program frequency switches, set brand jumpers, configure DIP switches, install the unit, and operate the keypad for your garage door opener. Includes compatibility charts and FCC information.</p>

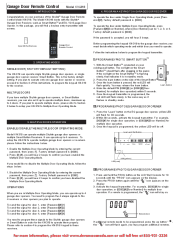

[Skylink KN-318 Garage Door Remote Control Programming and Operation Manual](#)

Comprehensive guide for the Skylink KN-318 Garage Door Remote Control, covering installation, programming for single and multiple doors, operation modes, troubleshooting, and warranty information.



[ATOMS PRO SMO Residential Side Mount Garage Door Opener | Skylink](#)

Discover the ATOMS PRO SMO, Skylink's ultra-slim, whisper-quiet side mount garage door opener. Features include built-in WiFi, LED lighting, battery backup compatibility, and easy installation for sectional doors up to 12' high. Explore optional accessories for enhanced functionality.