

Blanco 517667

Blanco Piona 517667 Chrome Dishwashing Liquid Dispenser User Manual

Model: 517667 | Brand: Blanco

INTRODUCTION

This manual provides detailed instructions for the installation, operation, and maintenance of your Blanco Piona 517667 Chrome Dishwashing Liquid Dispenser. Designed for convenience and durability, this dispenser is an ideal addition to your kitchen. Please read these instructions carefully before installation and use to ensure proper function and longevity of the product.

PRODUCT OVERVIEW

The Blanco Piona 517667 is a chrome-finished dishwashing liquid dispenser designed for seamless integration with kitchen sinks. It features a convenient top-up mechanism for easy refilling.

Key Features:

- Convenient top-up of fluid without needing to remove the bottle from underneath the sink.
- Requires a standard 35 mm diameter hole for installation.
- Total height of the dispenser: 320 mm.
- Height to the end of the spout: 76 mm.
- Spout range: 105 mm.
- Liquid capacity: 500 ml.



Figure 1: Front view of the Blanco Piona 517667 Chrome Dishwashing Liquid Dispenser. This image shows the sleek chrome finish and the design of the spout and pump mechanism.

SETUP AND INSTALLATION

Before beginning installation, ensure you have all components from the mounting set and the necessary tools. A 35 mm diameter hole is required in your sink or countertop.

Installation Steps:

1. **Prepare the Mounting Hole:** Ensure a 35 mm diameter hole is available in your sink or countertop. If not, carefully drill one according to manufacturer guidelines for your sink material.
2. **Insert Dispenser Body:** From above the sink, insert the main body of the dispenser through the prepared hole.
3. **Secure from Below:** From underneath the sink, attach the provided mounting hardware (washer, nut) to the threaded shaft of the dispenser. Tighten securely to prevent movement, but do not overtighten.
4. **Attach Liquid Bottle:** Screw the liquid bottle onto the threaded shaft from underneath the sink. Ensure it is firmly attached to prevent leaks.
5. **Initial Fill:** Before first use, fill the dispenser with dishwashing liquid as described in the "Operating Instructions" section.

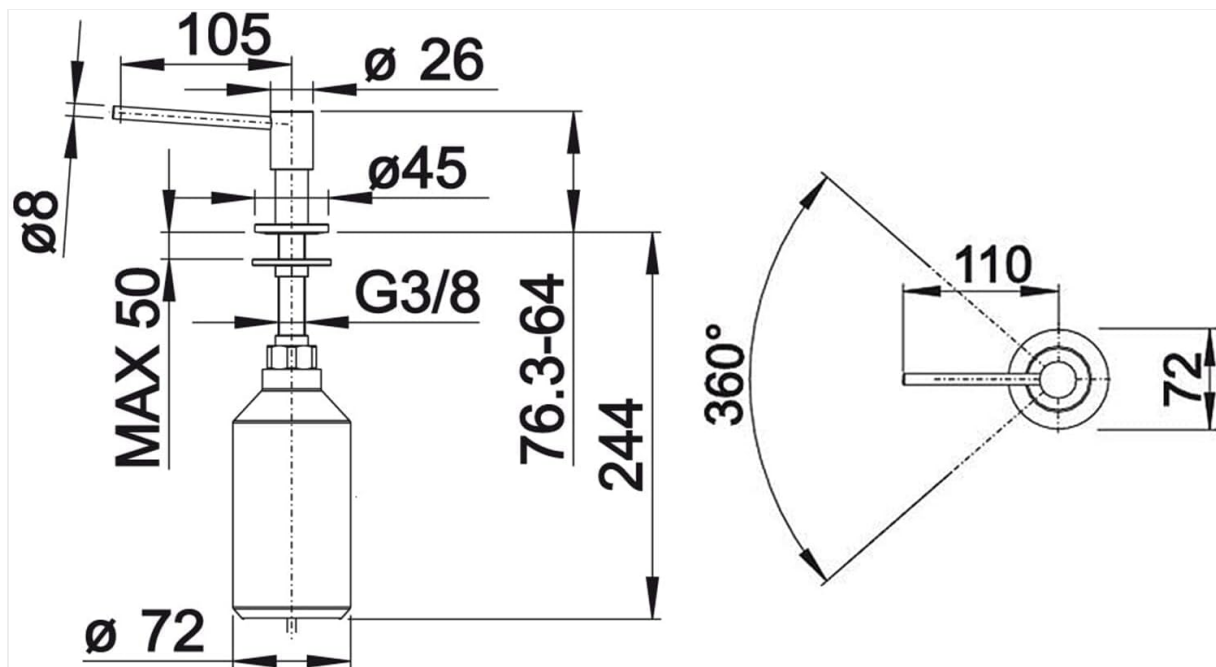

Figure 2: Technical diagram illustrating the dimensions and components of the Blanco Piona 517667 dispenser. This diagram provides measurements for installation planning, including the required hole diameter ($\varnothing 35$ mm) and overall height (320 mm).

OPERATING INSTRUCTIONS

Filling the Dispenser:

1. To refill, simply pull the dispenser pump head upwards and out of the base from above the sink.
2. Pour dishwashing liquid directly into the opening until the 500 ml capacity is reached. Avoid overfilling.
3. Reinsert the pump head firmly back into the base.

Dispensing Liquid:

- Press down on the pump head to dispense dishwashing liquid.
- The spout can be rotated 360 degrees for convenient access.

MAINTENANCE

Regular cleaning and proper care will ensure the longevity and optimal performance of your dispenser.

Cleaning:

- Wipe the exterior chrome finish with a soft, damp cloth and mild soap.
- Avoid abrasive cleaners, scouring pads, or harsh chemicals, as these can damage the chrome finish.
- For stubborn spots, use a chrome-safe cleaner and rinse thoroughly.

Refilling:

- Refer to the "Operating Instructions" section for detailed refilling steps.
- Ensure the liquid bottle is securely attached after refilling to prevent leaks.

TROUBLESHOOTING

If you encounter issues with your dispenser, refer to the following common problems and solutions:

Problem	Possible Cause	Solution
Dispenser not pumping liquid.	<ul style="list-style-type: none">• Liquid level is too low.• Pump mechanism is clogged.• Air lock in the pump.	<ul style="list-style-type: none">• Refill the dispenser.• Remove the pump head and clean the spout and pump mechanism thoroughly with warm water.• Pump several times to prime the pump and remove air.
Liquid leaking from the base.	<ul style="list-style-type: none">• Liquid bottle not securely attached.• Seal is damaged or improperly seated.	<ul style="list-style-type: none">• Ensure the liquid bottle is tightly screwed onto the dispenser body.• Check the rubber seal between the bottle and the dispenser body for damage or misalignment. Replace if necessary.
Dispenser feels loose.	<ul style="list-style-type: none">• Mounting nut underneath the sink is loose.	<ul style="list-style-type: none">• Tighten the mounting nut from underneath the sink.

SPECIFICATIONS

Model Number: 517667

Brand: Blanco

Material: Chrome

Color: Chrome

Product Dimensions: 24.4 x 13 x 8.4 cm (overall packaging/product size)

Item Weight: 370 g

Liquid Capacity: 500 ml

Required Hole Diameter: 35 mm

Total Height of Dispenser: 320 mm

Height to Spout End: 76 mm

Spout Range: 105 mm

Included Components: 1 x Dishwashing liquid dispenser, mounting set, user manual

WARRANTY AND SUPPORT

For warranty information or technical support, please refer to the official Blanco website or contact their customer service department. Keep your purchase receipt as proof of purchase.

Blanco Official Website: www.blanco.com