

## Hayward IDXL2ICB1931

# Hayward IDXL2ICB1931 Integrated Control Board Instruction Manual

For Hayward H-Series Low NOx and Hot Tub Heaters

## INTRODUCTION

This manual provides essential information for the installation, operation, and maintenance of the Hayward IDXL2ICB1931 Integrated Control Board. This control board is a replacement component designed for specific Hayward H-Series Low NOx induced draft heaters. Please read this manual thoroughly before attempting any installation or service.

## IMPORTANT SAFETY INFORMATION

**WARNING:** Installation and servicing of this product must be performed by a qualified service professional. Improper installation, adjustment, alteration, service, or maintenance can cause property damage, injury, or death. Read all instructions completely before proceeding.

- Always disconnect power to the heater at the main circuit breaker before performing any service or maintenance.
- Ensure all wiring connections comply with local electrical codes and manufacturer specifications.
- Wear appropriate personal protective equipment (PPE) during installation and service.
- Do not operate the heater if any part is submerged in water.

## PRODUCT COMPATIBILITY

The Hayward IDXL2ICB1931 Integrated Control Board is compatible with the following Hayward H-Series Low NOx induced draft heater models:

- H250IDL2
- H350IDL2

- H400IDL2
- Other compatible Hayward Universal H-Series Low NOx induced draft heaters.

This part is incorporated on all IDL Heaters built after September 20, 2004.

## PRODUCT OVERVIEW

The integrated control board is the central electronic component responsible for managing the heater's functions, including ignition, temperature regulation, and safety protocols. Familiarize yourself with the board's layout before installation.



**Figure 1:** Hayward IDXL2ICB1931 Integrated Control Board. This image displays the green circuit board with various electronic components, including capacitors, resistors, relays, and integrated circuits. Key connection points are labeled, such as "IGNITOR," "INDUCER," "24VAC," "POOL," and "120 VAC."

### Key Components and Connections:

- **IGNITOR:** Connection point for the heater's ignitor.
- **INDUCER:** Connection point for the induced draft motor.

- **24VAC:** Low voltage power input.
- **POOL:** Sensor connection for pool temperature.
- **120 VAC:** Main power input.
- **XFMR NEUT / XFMR H:** Transformer connections.
- **PF LIMITS:** Pressure/Flow limit switch connections.
- **SENSORS:** Various sensor inputs for monitoring heater conditions.

## INSTALLATION INSTRUCTIONS

---

1. **Power Disconnection:** Turn off all electrical power to the heater at the main circuit breaker before beginning installation.
2. **Access the Control Board:** Open the heater's control panel access cover. Refer to your heater's specific manual for instructions on accessing the existing control board.
3. **Document Connections:** Before disconnecting any wires, take clear photographs or make detailed diagrams of all existing wire connections to the old control board. Note the color and position of each wire.
4. **Remove Old Board:** Carefully disconnect all wires and connectors from the old control board. Remove any mounting screws or clips securing the old board.
5. **Install New Board:** Position the new Hayward IDXL2ICB1931 control board in the heater's enclosure. Secure it using the original mounting hardware or the new plastic standoffs provided with the replacement board, if applicable.
6. **Reconnect Wiring:** Using your photographs or diagrams, carefully reconnect all wires and connectors to their corresponding terminals on the new control board. Ensure all connections are secure and properly seated.
7. **Verify Connections:** Double-check all wiring against your documentation to ensure accuracy. Incorrect wiring can cause damage to the board or heater.
8. **Close Access Cover:** Once all connections are verified, close and secure the heater's control panel access cover.
9. **Restore Power:** Restore electrical power to the heater at the main circuit breaker.
10. **Initial Startup:** Follow the initial startup procedures outlined in your heater's main instruction manual. Observe the heater's operation for any error codes or unusual behavior.

**Note:** The new control board may come with a conformal coating for enhanced durability, which may differ from older boards. This is a design improvement.

## OPERATING INSTRUCTIONS

---

The Hayward IDXL2ICB1931 Integrated Control Board functions as the brain of your heater. Once installed, its operation is integrated with the heater's overall system. Refer to your specific Hayward H-Series heater's user manual for detailed operating instructions, including:

- Setting desired water temperature.
- Understanding display codes and indicators.
- Initiating heating cycles.

- Adjusting operational modes (e.g., pool/spa).

The control board processes inputs from sensors and user commands to manage the ignition sequence, gas valve operation, and fan motor, ensuring efficient and safe heating.

## MAINTENANCE

---

The integrated control board itself requires minimal direct maintenance. However, ensuring the overall health of your heater system will prolong the life of the control board and other components.

- **Keep Area Clean:** Ensure the heater's enclosure is free from dust, debris, and moisture.
- **Inspect Wiring:** Periodically inspect all wiring connections to the control board for signs of corrosion, looseness, or damage.
- **Environmental Protection:** Protect the heater from extreme weather conditions and ensure proper ventilation as specified by the heater manufacturer.
- **Professional Inspection:** It is recommended to have a qualified service professional inspect your heater system annually, which includes checking the control board and its connections.

## TROUBLESHOOTING

---

If your heater is experiencing issues after control board replacement, consider the following common troubleshooting steps:

- **No Power:**
  - Check the main circuit breaker for the heater.
  - Verify all 120 VAC and 24 VAC connections to the control board are secure.
- **Error Codes (e.g., "CE" - Communication Error, "PF" - Pressure/Flow Error):**
  - Refer to your heater's specific manual for a complete list of error codes and their meanings.
  - For "CE" errors, ensure the display board connections are secure. Sometimes, replacing the main control board resolves this, even if the display board was initially suspected.
  - For "PF" errors, check water flow, pressure switch connections, and ensure the pump is operating correctly.
- **Heater Not Igniting:**
  - Verify the ignitor connection to the control board.
  - Ensure gas supply is open and sufficient.
  - Check for proper operation of the induced draft motor (INDUCER connection).
- **Intermittent Operation:**
  - Inspect all wiring for loose connections or corrosion.
  - Ensure proper ventilation around the heater.

If troubleshooting steps do not resolve the issue, contact a qualified service professional for further diagnosis and repair.

## SPECIFICATIONS

Feature	Detail
Model Number	IDXL2ICB1931
Brand	Hayward
Compatibility	Hayward H-Series Low NOx Induced Draft Heaters (H250IDL2, H350IDL2, H400IDL2, etc.)
Part Type	Integrated Control Board Replacement
Weight	Approximately 0.01 ounces (product listing weight, actual shipping weight may vary)
Manufacturing Date Relevance	Incorporated on all IDL Heaters built after 9/20/04

## WARRANTY AND SUPPORT

For specific warranty information regarding the Hayward IDXL2ICB1931 Integrated Control Board, please refer to the documentation provided with your original Hayward heater or contact Hayward customer support directly. Warranty terms typically cover manufacturing defects for a specified period.





For technical support or service inquiries, please visit the official Hayward website or contact their authorized service centers. Always provide your product model number (IDXL2ICB1931) and heater model number when seeking support.

You can find more information and support resources on the [Hayward Store on Amazon](#).

© 2023 Hayward. All rights reserved. This manual is for informational purposes only.

### Related Documents - IDXL2ICB1931

	<p><a href="#">Hayward H150FD-H500FD Pool and Spa Heater Service &amp; Installation Manual</a></p> <p>Comprehensive service and installation manual for Hayward H150FD, H200FD, H250FD, H300FD, H350FD, H400FD, and H500FD pool and spa heaters. Covers safety, installation, gas and water piping, electrical connections, troubleshooting, and maintenance.</p>
-------------------------------------------------------------------------------------	-------------------------------------------------------------------------------------------------------------------------------------------------------------------------------------------------------------------------------------------------------------------------------------------------------------------------------------------------------------------

	<p><a href="#">Hayward Pool and Spa/Hot Tub Heaters Service &amp; Installation Manual (H150FD-H400FD Models)</a></p> <p>Comprehensive service and installation manual for Hayward H150FD, H200FD, H250FD, H300FD, H350FD, and H400FD pool and spa/hot tub heaters. Covers installation, operation, maintenance, troubleshooting, and safety.</p>
	<p><a href="#">Hayward Pool and Spa/Hot Tub Heaters Service &amp; Installation Manual</a></p> <p>Comprehensive service and installation manual for Hayward H150FD through H500FD series pool and spa/hot tub heaters, covering installation, operation, maintenance, and troubleshooting.</p>
	<p><a href="#">Hayward H-Series Pool and Spa Heater Service and Installation Manual</a></p> <p>Comprehensive service and installation manual for Hayward H-Series pool and spa/hot tub heaters, including models H150FD, H200FD, H250FD, H300FD, H350FD, and H400FD. Covers safety, installation procedures, troubleshooting, maintenance, and parts.</p>
	<p><a href="#">Hayward Pool and Spa Heater Owner's Manual: H150FD-H500FD Models</a></p> <p>Comprehensive owner's manual for Hayward H150FD, H200FD, H250FD, H300FD, H350FD, H400FD, and H500FD pool and spa heaters. Covers safety, operation, maintenance, water chemistry, error codes, and warranty.</p>
	<p><a href="#">Hayward Variable Speed Pump Safety Instructions and Installation Guide</a></p> <p>Essential safety instructions and installation guidelines for Hayward variable speed pool pumps. Learn about warnings, cautions, and proper usage to ensure safe operation and prevent injury.</p>

Documents - Hayward – IDXL2ICB1931

[\[pdf\]](#) Owner's Manual Instructions

Installation Operation Service Procedures for Models H250IDL2 H350IDL2 H400IDL2 Pool and Spa Hot Tub Heaters Hayward Products Propools Manual183 propools instructions owners manuals ||| HAYWARD Installation, Operation Service Procedures Pool and Spa/Hot Tub Heaters Models H250IDL2, H ... 1930 IDXL2BRN1930 IDXLFLS1930 IDXLBON1930 IDXLBOP1930 IDXLBON1931 IDXLBOP1931 HAXMAN1250 HAXMAN1400 **IDXL2ICB1931** IDXL2PBA1250 IDXL2PBA1400 IDXL2PBA1931 IDXL2BKP1930 IDXL2BKP1931 IDXL2DB1930 IDXLWHM193...

lang:en score:35 filesize: 4.12 M page\_count: 23 document date: 2007-02-26

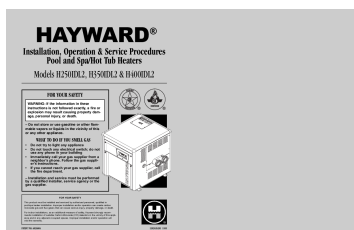



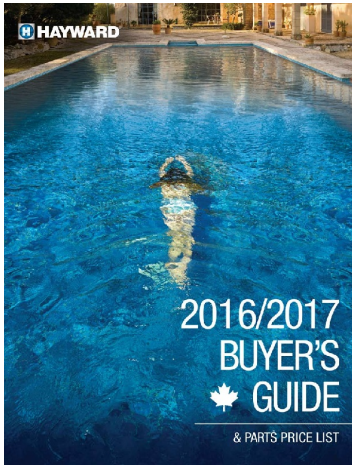

[\[pdf\]](#) Installation Guide Guide Buyer's Guide Price List

Download Hayward SP2607X10 Installation Guide 2016 2017 buyers guide LITPLC16C hayward pool ca literature |||

Table of Contents Effective January 1, 2016 Supersedes all price lists of prior dates.

Please see T ... Gas Manifold H400 34 HAXCIA1930 35 IDXL2PBA1250

IDXL2PBA1400 15 IHXILS1930 IHXILS1930 **\*\*IDXL2ICB1931** Interlock Switch 240V

Interlock Switch 120V Integrated Control Board IDXL2PBA1931 I...

lang:es **score:33** filesize: 57.33 M page\_count: 268 document date: 2016-05-03

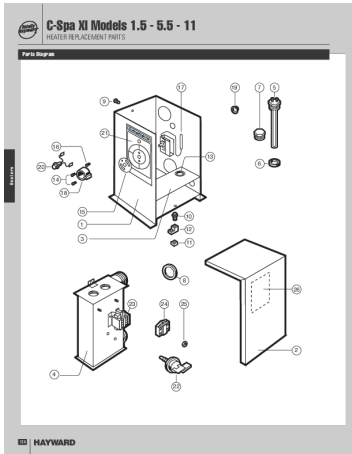

[\[pdf\]](#) Parts List Guide Diagram

2009 Buyer s Guide Rosanne Schloss 845 356 2226 Pro Production heater parts americanbestpoolsupply uploadfile data file abps hayward Heater |||

Heaters C-Spa XI Models 1.5 - 5.5 - 11 HEATER REPLACEMENT PARTS Parts

Diagram 17 19 75 9 21 16 ... 14 HAXMAN1250 Gas Manifold H250 HAXMAN1400

Gas Manifold H400 15 IHXILS1930 IHXILS1931 **\*\*IDXL2ICB1931** Interlock Switch 240V Interlock Switch 120V Integrated Control Board 16\* IDXLCPA19...

lang:en **score:30** filesize: 3.11 M page\_count: 24 document date: 2010-01-16

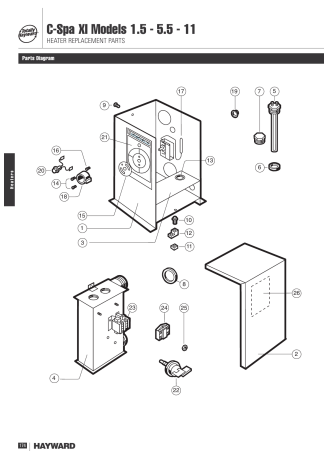

[\[pdf\]](#) Parts List Guide Diagram

2009 Buyer s Guide Rosanne Schloss 845 356 2226 Pro Production heater partsamericanbestpoolsupply uploadfile data file abps hayward Heater parts srsItid

AfmBOotQ3rBdxqRuIZ6tD0XzWmtgwAoo19UeldZAVOTX5 zWQ2mMCPs |||

Heaters C-Spa XI Models 1.5 - 5.5 - 11 HEATER REPLACEMENT PARTS Parts

Diagram 17 19 75 9 21 16 ... 14 HAXMAN1250 Gas Manifold - H250 HAXMAN1400

Gas Manifold - H400 15 IHXILS1930 IHXILS1931 **\*\*IDXL2ICB1931** Interlock Switch - 240V Interlock Switch - 120V Integrated Control Board 16\* IDXLCPA...

lang:en **score:29** filesize: 3.11 M page\_count: 24 document date: 2010-01-16

lang:de score:28 filesize: 55.59 M page count: 309 document date: 2023-02-06



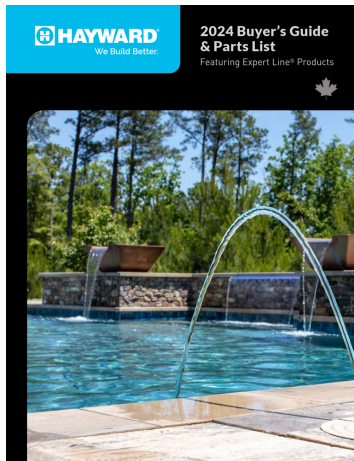

[\[pdf\]](#) Parts List Guide Buyer's Guide

LITPLC24C 2024 Canadian Residential Buyers Guide commerce hayward pool assets magento

MagentoContent |||

We Build Better. 2024 Buyer s Guide Parts List Featuring Expert Line Products Table of Contents ... 1101 IDXHXA1102 IDXIGN1930 IDXJKT1100 IDXKIT1930

IDXL2BVS1930 IDXL2DB1930 IDXL2FSB1930 IDXL2FSK1930 **IDXL2ICB1931**

IDXL2IGN1930 IDXL2SNT1930 IDXL2TRF1930 IDXL2VPS1930 IDXL2WHM1930

IDXLBVS1930 IDXLBWR193...

lang:de **score:28** filesize: 69.27 M page\_count: 328 document date: 2024-05-30



[\[pdf\]](#) Guide Buyer's Guide

2022 canadian buyers guide LITPLC22C LR hayward pool ca assets documents poolscanada literature |||

Table of Contents Effective January 1, 2022 Section 1. Pumps TriStar VS 900/950

Omni ..... 1101 IDXHXA1102 IDXIGN1930 IDXJKT1100 IDXKIT1930

IDXL2BVS1930 IDXL2DB1930 IDXL2FSB1930 IDXL2FSK1930 **IDXL2ICB1931**

IDXL2IGN1930 IDXL2SNT1930 IDXL2TRF1930 IDXL2VPS1930 IDXL2WHM1930

IDXLBVS1930 IDXLBWR193...

lang:de **score:27** filesize: 88.08 M page\_count: 388 document date: 2022-02-22

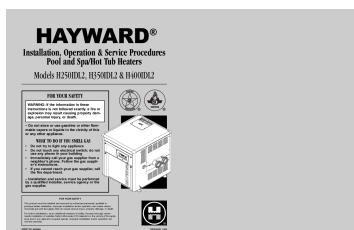

[\[pdf\]](#) User Manual Instructions Troubleshooting Guide Parts List

Installation Operation Service Procedures for Models H250IDL2 H350IDL2 H400IDL2 Pool and Spa Hot

Tub Heaters Hayward Products This manual contains instructions installation operation maintenance

troubleshooting parts lists the safe use of Model H250IDL H350IDL H400IDL Low NOx swimming pool

spa hot tub heaters strongly recommends that be read by installer before installing heater 1Hayward

Owners IDL eng 2Hayward master ca documents regroupements 80

HAYWARD Installation, Operation Service Procedures Pool and Spa/Hot Tub Heaters

Models H250IDL2, H ... 1930 IDXL2BRN1930 IDXLFLS1930 IDXLBON1930

IDXLBOP1930 IDXLBON1931 IDXLBOP1931 HAXMAN1250 HAXMAN1400

**IDXL2ICB1931** IDXL2PBA1250 IDXL2PBA1400 IDXL2PBA1931 IDXL2BKP1930

IDXL2BKP1931 IDXL2DB1930 IDXLWHM193...

lang:en **score:26** filesize: 4.1 M page\_count: 23 document date: 2012-05-29



iQ-Series



ABOVE-GROUND - INVOICED DRY HEAT REPLACEMENT PARTS

Part Number

Ref. No.	Part No.	Description	Ref. No.	Part No.	Description
1	DAE47100	Water Valve	14	DAE47410	Gas Assembly
2	DAE46100	Combustion Blower	15	DAE47100	Bar Assembly
3	DAE46100	Blower Gasket	16	DAE46100	Control Bladder with Igniter
4	DAE47410	H Levels Kit	17	DAE47410	Internal Switch
5	DAE46100	Water/Steam Switch	18	DAE47100	Coupling
6	DAE47100	Heat Exchanger Assembly	19	DAE47100	Thermocouple
7	DAE47100	Heat Exchanger Assembly	20	DAE47100	Control Panel Assembly
8	DAE47100	Heat Exchanger Assembly	21	DAE47410	Male Control Panel
9	DAE46100	Water Valve	22	DAE47100	Bar Assembly
10	DAE46100	Water Valve	23	DAE47100	Bar Assembly
11	DAE46100	Blower Gasket	24	DAE47100	Blower Switch
12	DAE46100	Blower	25	DAE47100	Control Panel Mount
13	DAE46100	Blower Gasket & Bar Gasket Bracket (C - Normal)			
14	DAE46100	Blower Gasket & Bar Gasket Bracket (C - Pressure)			
15	DAE46100	Igniter	26	DAE47100	Normal or Pressure
16	DAE46100	Gas Valve	27	DAE47100	Pressure or Natural

\*Last revised on 08/25/2008

\*\*Last revised on 08/25/2008

HAYWARD

[\[pdf\]](#) Parts List Label

H Series ABOVE GROUND INDUCED DRAFT HEATER REPLACEMENT PARTS Rosanne Schloss 845  
356 2226 Hayward Pool Products 197 203Hay2009 hayward pool assets documents pools parts heaters

111

Heaters Parts Listing Ref. No. 1 Part No. IDXJKT1100 2 IDXBWR1935 3 IDXBLG1930  
4 IDXHLLK1930 ... L2BWR1930 IDXL2CPA1250 IDXL2CPA1400 IDXL2CPA1931  
IDXL2DB1930 IDXL2FSB1930 IDXL2FSK1930 IDXL2ICB1930 **IDXL2ICB1931**  
IDXL2IGN1930 IDXL2JKT1250 IDXL2JKT1400 IDXL2PBA1250 IDXL2PBA1400 Air  
Pressure Switch B...

lang:en score:19 filesize: 123.58 K page\_count: 7 document date: 2008-12-15

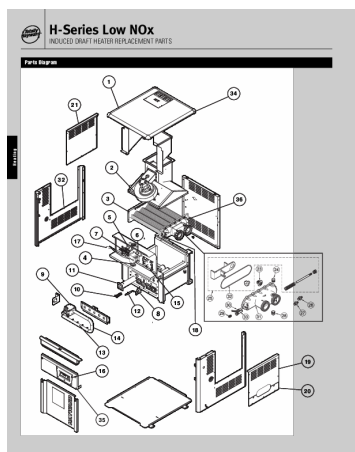

[\[pdf\]](#) Parts List Diagram

Rosanne Schloss 845 215 9797 H Series Low NOx hayward pool 80 Parts Diagrams

H-Series Low NOx INDUCED DRAFT HEATER REPLACEMENT PARTS Parts  
Diagram 1 34 21 Heating 2 32 3 36 ... 14 HAXMAN1250 Gas Manifold H250  
HAXMAN1400 Gas Manifold H400 15 IHXILS1930 IHXILS1930 **\*\*IDX21CB1931**  
Interlock Switch 240V Interlock Switch 120V Integrated Control Board 16\*  
IDXLCPA19...

lang:en score:16 filesize: 458.68 K page count: 2 document date: 2014-01-13

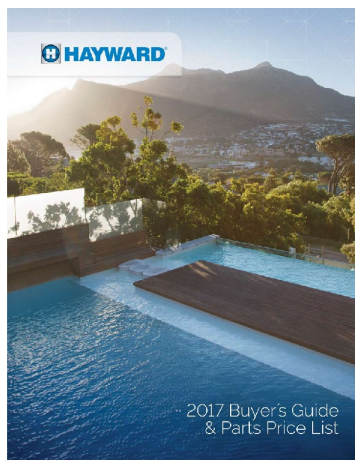
[Hayward 2017 Buyer's Guide & Parts Price List](#)

Explore the 2017 collection of Hayward pool and spa equipment, featuring energy-efficient pumps, advanced filters, innovative heaters, smart cleaners, and comprehensive automation and lighting solutions. This guide provides detailed product information and parts pricing for residential and commercial applications.

lang:it score:14 filesize: 60.09 M page count: 420 document date: 2016-11-30

[illegible]

[\[pdf\]](#) Guide

Layout 1 2014BuyersGuide hayward pool ca assets documents pools literature |||

Pumps 3 EcoStar™ and EcoStar SVRSTM VARIABLE SPEED PUMPS The most energy efficient pump at any ... HAXMAN1250 Gas Manifold H250 35 HAXMAN1400 Gas Manifold H400 15 IHXILS1930 IHXILS1930 **\*\*IDXL2ICB1931** Interlock Switch 240V Interlock Switch 120V Integrated Control Board 16\* IDXLCPA19...

lang:en score:13 filesize: 28.68 M page count: 223 document date: 2014-03-11

