

Manuals+

[Q & A](#) | [Deep Search](#) | [Upload](#)

manuals.plus /

› [Coleman](#) /

› [Coleman Electric Heat Kit 9233-4551 User Manual](#)

Coleman 9233A4551

Coleman Electric Heat Kit 9233-4551 User Manual

Model: 9233A4551 | Part Number: 708897

1. PRODUCT OVERVIEW

The Coleman Electric Heat Kit 9233-4551 (Part #708897) is designed to provide supplemental electric heating for compatible Coleman Air conditioning units, specifically for the 67305 series. This kit integrates with your existing system to offer an additional heat source, ideal for taking the chill out of the air without relying solely on a propane furnace.

Package Contents:

- 1 x Coleman Electric Heat Kit (Model 9233-4551)
- Installation Hardware (as supplied by manufacturer)
- Instruction Sheet (this document)

2. SAFETY INFORMATION

Read all instructions carefully before installation and operation. Failure to follow these instructions may result in electric shock, fire, or property damage. Keep this manual for future reference.

General Safety Guidelines:

- **Electrical Safety:** Ensure the power supply to the RV's air conditioning unit is disconnected before beginning any installation or maintenance. Work with electricity can be hazardous. If you are not comfortable with electrical work, consult a qualified technician.
- **Proper Installation:** Install the heat kit strictly according to the manufacturer's instructions. Incorrect installation can lead to malfunction or safety hazards.
- **Intended Use:** This electric heat kit is designed for supplemental heating and is not intended to replace a primary furnace. Do not use it for purposes other than its intended function.
- **Ventilation:** Ensure adequate airflow around the unit. Do not block air intake or exhaust vents.
- **Inspection:** Periodically inspect the unit and wiring for any signs of damage or wear.

3. SETUP AND INSTALLATION

The Coleman Electric Heat Kit is designed for straightforward installation into compatible Coleman Air conditioning units. While installation can be relatively simple, involving a single screw and a plug, it is crucial to ensure correct wiring, especially with computerized systems. If unsure, professional assistance is recommended.

Installation Steps:

1. **Disconnect Power:** Before starting, ensure all power to the RV and the air conditioning unit is completely disconnected at the source.
2. **Access AC Unit:** Open the cover of your Coleman Air conditioning unit to access the internal components where the heat kit will be installed. Refer to your AC unit's manual for specific access instructions.
3. **Position Heat Kit:** Carefully position the electric heat kit within the designated area of the AC unit. The design typically allows for a "plug and play" fit.
4. **Secure the Kit:** Secure the heat kit using the provided screw(s). Ensure it is firmly in place to prevent movement during operation.
5. **Connect Wiring:** Connect the electrical plug from the heat kit to the corresponding receptacle within the AC unit. Verify that all connections are secure and correctly seated. For units with computerized systems, double-check wiring diagrams or consult the manufacturer if any doubt arises.
6. **Close AC Unit:** Once the heat kit is securely installed and wired, close the AC unit cover, ensuring all latches or screws are fastened.
7. **Restore Power:** Reconnect the power supply to the RV and the air conditioning unit.

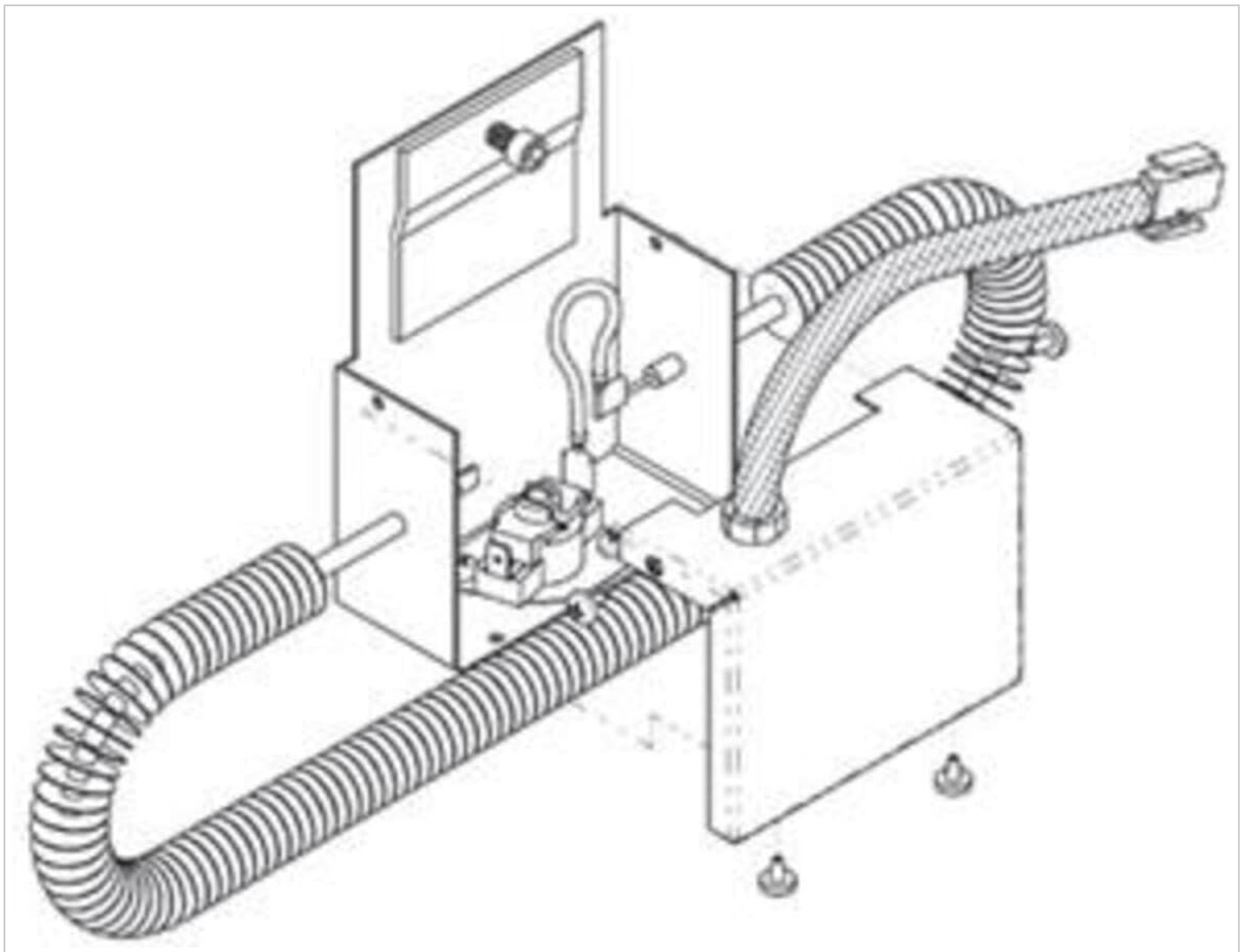

Figure 1: An illustrative diagram showing the Coleman Electric Heat Kit with its heating elements, wiring, and connection points. The image depicts the main body of the kit with two coiled heating elements extending from it, and electrical connections ready for integration into an AC unit. This visual aids in understanding the physical components and their general arrangement during installation.

4. OPERATING INSTRUCTIONS

After successful installation, the electric heat kit operates in conjunction with your RV's air conditioning system to provide warmth.

Using the Heat Kit:

1. **Select Heat Mode:** On your RV's thermostat or AC control panel, select the "Heat" or "Electric Heat" mode.
2. **Set Desired Temperature:** Adjust the thermostat to your desired temperature setting. The heat kit will activate to provide supplemental warmth.
3. **Supplemental Heating:** This kit is designed to provide a noticeable increase in air temperature, typically around 5 degrees Fahrenheit above the incoming air. It is effective for removing the chill from the air and for use in moderately cool conditions.
4. **Not a Primary Furnace:** Understand that this electric heat kit is not a replacement for your RV's primary propane furnace. For very cold temperatures or to heat the entire RV significantly, the furnace may still be required.

5. MAINTENANCE

Regular, simple maintenance can help ensure the longevity and efficient operation of your Coleman Electric Heat Kit.

Maintenance Tips:

- **Power Disconnection:** Always disconnect power to the AC unit before performing any maintenance.
- **Visual Inspection:** Periodically inspect the heat kit and its wiring for any visible signs of damage, corrosion, or loose connections.
- **Cleanliness:** Ensure that the air pathways within the AC unit, especially around the heat kit, remain free of dust, debris, and obstructions. A clean system operates more efficiently.
- **Professional Check:** Consider having your RV's HVAC system, including the heat kit, professionally inspected annually.

6. TROUBLESHOOTING

If you encounter issues with your electric heat kit, refer to the following common problems and solutions.

Common Issues:

- **No Heat Output:**
 - Ensure the RV's power supply is active and the AC unit is receiving power.
 - Verify that the thermostat is set to "Heat" mode and the desired temperature is above the ambient temperature.
 - Check for loose wiring connections within the AC unit.
 - Inspect the heating elements for visible damage.
- **Blowing Cold Air After Extended Use:**
 - Some units may have a safety mechanism that temporarily turns off the heating element if it overheats or runs for an extended period. Try turning the unit off for a short duration and then restarting it.
 - Ensure adequate airflow. Blocked vents or dirty filters can cause the unit to overheat and cycle off.
- **Insufficient Heat:**
 - Remember this is a supplemental heat source. For significant temperature increases or in very cold weather, the RV's primary furnace may be necessary.
 - Ensure all windows and doors are closed to minimize heat loss.

If problems persist after attempting these troubleshooting steps, contact Coleman customer support or a qualified RV

technician.

7. TECHNICAL SPECIFICATIONS

Brand	Coleman
Model	9233A4551
Manufacturer Part Number	708897
Item Weight	2 pounds
Product Dimensions	18 x 9 x 3 inches
Special Features	Heating Function (integrates with AC unit for supplemental heat)
Voltage	120 Volts
Wattage	20526 watts <i>(Note: This wattage seems unusually high for a supplemental RV heat strip. Users should verify actual operating wattage with their specific AC unit and electrical system capabilities.)</i>
Power Source	Corded Electric
Form Factor	Mini-Split <i>(Refers to the type of AC unit it integrates with)</i>

8. WARRANTY AND SUPPORT

Warranty Information:





This Coleman Electric Heat Kit comes with a**Limited Warranty**. For specific details regarding the warranty period, coverage, and terms, please refer to the warranty documentation included with your purchase or contact Coleman customer service directly. Keep your proof of purchase for warranty claims.

Customer Support:

For technical assistance, troubleshooting beyond this manual, or warranty inquiries, please contact Coleman customer support. You can typically find contact information on the Coleman website or within the original product packaging.

Online Resources: Visit the official Coleman website for additional product information, FAQs, and support resources.

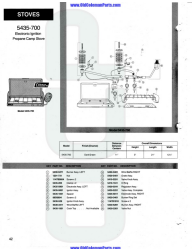

	<p>Coleman Single Piece Standard ECM Air Handlers Technical Guide</p> <p>Comprehensive technical guide for Coleman Single Piece Standard ECM Air Handlers (AE Series). Details product features, specifications, dimensions, electrical data, cooling capacity, airflow, and installation guidelines for split-system cooling and heat pumps.</p>
	<p>Auvent Gonflable Coleman Air : Manuel d'Utilisation et Guide d'Installation</p> <p>Instructions détaillées pour l'installation, l'utilisation et l'entretien de votre auvent gonflable Coleman Air. Inclut des avertissements de sécurité et des conseils de réparation.</p>
	<p>Coleman AP Series Single Piece PSC Air Handler Technical Guide</p> <p>Technical specifications, features, dimensions, electrical data, and application details for the Coleman AP Series single-piece PSC air handlers designed for split-system cooling and heat pumps.</p>
	<p>Coleman 360 Light & Sound Lantern: FCC & IC Compliance Information</p> <p>Detailed FCC and Industry Canada (IC) compliance statements, RF exposure warnings, and operational guidelines for the Coleman 360 Light & Sound Lantern (Model 2000033083R).</p>
	<p>Coleman Even Heat™ 3-Burner Barbecue Assembly Manual</p> <p>Assembly manual for the Coleman Even Heat™ 3-burner barbecue, covering propane and natural gas models 85-3026-0 and 85-3027-8. Includes parts lists, hardware details, and step-by-step assembly instructions.</p>
	<p>Coleman Propane Camp Stove Model 5435-700 Parts and Diagram</p> <p>Detailed parts list and diagram for the Coleman Propane Camp Stove, Model 5435-700. Includes specifications and part numbers for easy identification and replacement.</p>