

## Manuals+

[Q & A](#) | [Deep Search](#) | [Upload](#)

manuals.plus /

› [LUX](#) /

› [Lux Products TX9600TS Programmable Large Touchscreen Heating Cooling Thermostat User Manual](#)

## LUX TX9600TS

# LUX TX9600TS Programmable Large Touchscreen Thermostat

Model: TX9600TS | Brand: LUX

## INTRODUCTION

The LUX TX9600TS thermostat provides convenient and precise home comfort control through its easy-to-read touchscreen interface. This programmable thermostat is designed for use with most 24-volt heating and A/C systems, including two-stage heating and one-stage cooling setups. Its intuitive design ensures straightforward installation and operation, enhancing your home's climate management.

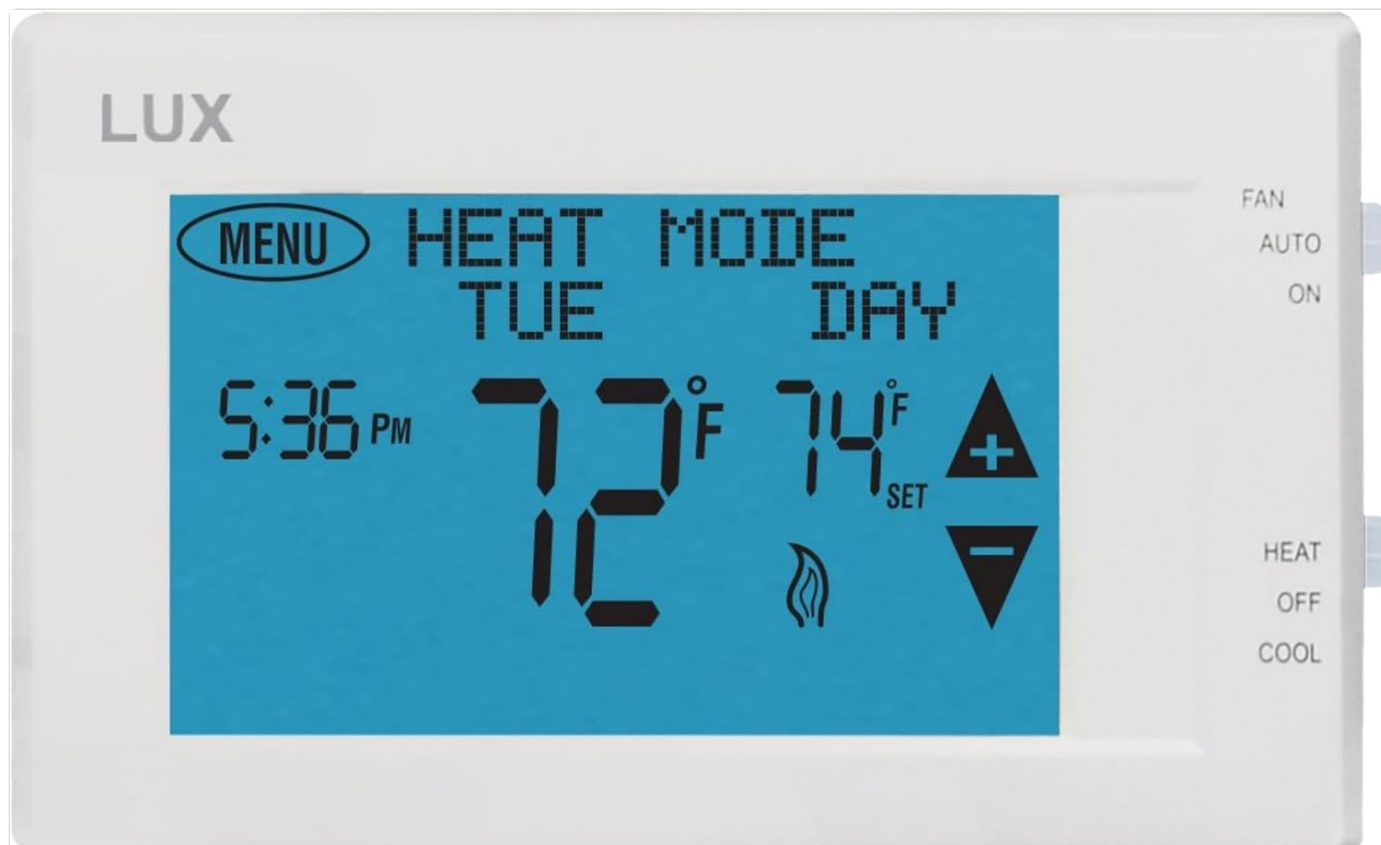

Figure 1: Front view of the LUX TX9600TS thermostat with its large, lighted touchscreen display.

## KEY FEATURES

- **Easy-to-Read Touchscreen:** Features a large, lighted touchscreen display for clear visibility of comfort levels.
- **High Compatibility:** Works with virtually all North American 24-volt heating and cooling systems, including 2 heat & 1 cool stage setups.
- **Versatile Programming:** Offers 7-day or 5/2-day temperature programming with options for 2 or 4 periods per day, allowing customization to fit your schedule.
- **Temperature Limits:** Adjustable heating and cooling temperature limits help maintain your desired comfort zone and prevent extreme settings.
- **Programmable Touch Pad Lockout:** Ensures consistency and prevents unauthorized changes to settings.
- **Temporary Temperature Override:** Allows for temporary temperature adjustments without affecting the programmed daily routine.
- **Manual Temperature Hold:** Manually hold a single fixed temperature for a specified duration (hour, day, week, or month).
- **Current Mode and Status Indication:** Displays a "flame" icon for heat mode and a "snowflake" icon for cool mode, providing clear operational status.
- **Easy Installation:** Designed for quick installation, typically in 15 minutes or less.

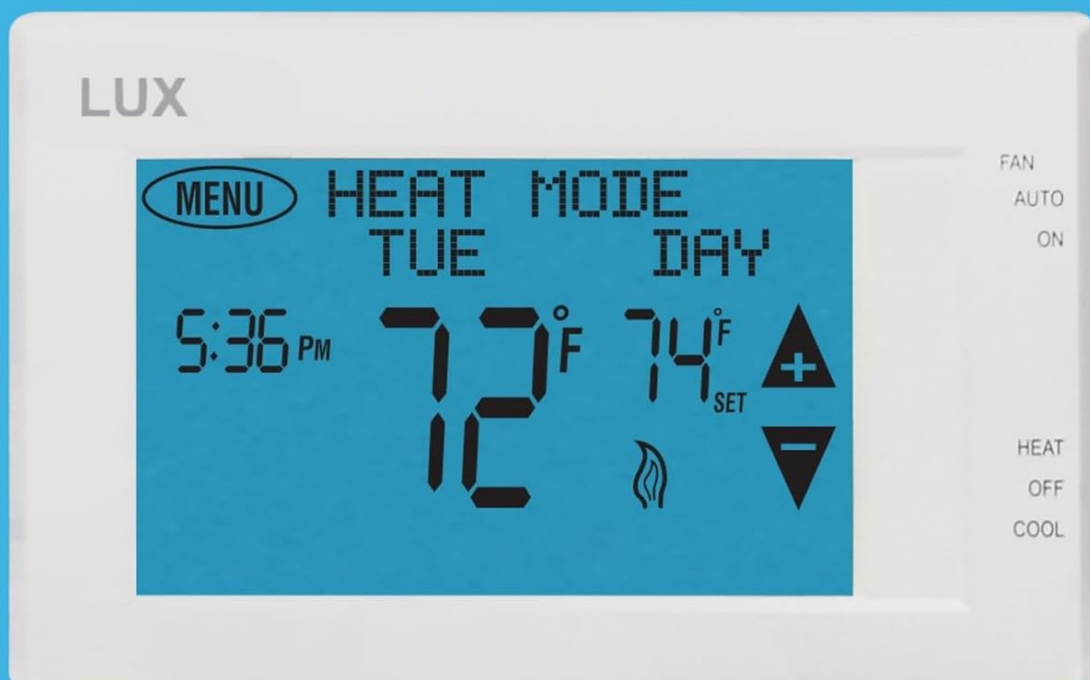
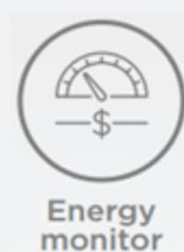
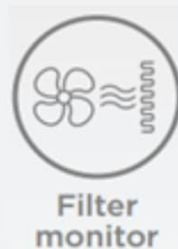

Figure 2: Visual representation of key features including multi-stage compatibility, filter monitoring, energy monitoring, and quick-copy programming.

INSTALLATION

System Compatibility

The TX9600TS thermostat is compatible with a wide range of HVAC systems. Please refer to the diagram below to ensure your system is compatible before installation.

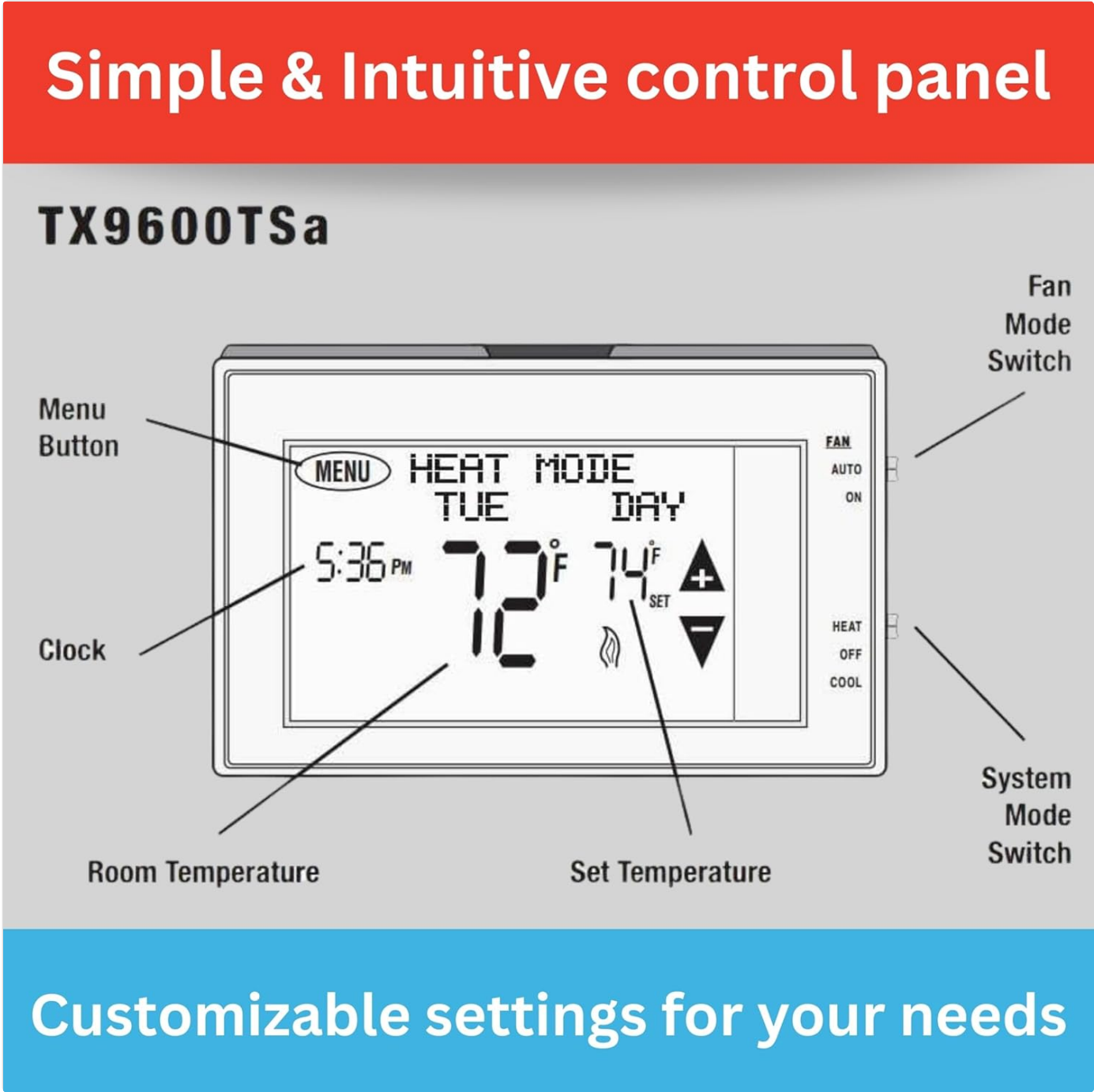

Figure 3: Detailed compatibility chart for various heating and cooling systems.

Wiring and Mounting

Installation is designed to be straightforward. The thermostat typically uses standard wiring connections. For detailed wiring diagrams and step-by-step mounting instructions, please consult the full User Guide (PDF) available from the manufacturer. The unit is powered by two AA batteries, which should be installed according to the instructions in the manual. It is recommended to open and close the unit's battery compartment a few times before final installation to ensure smooth access for future battery changes.

### Understanding the Display and Controls

The TX9600TS features a large, intuitive touchscreen display and side switches for fan and system mode selection.



Figure 4: Labeled components of the thermostat's control panel for easy identification.

### Setting Time and Programming

To set the current time and program your thermostat, use the touchscreen interface. The thermostat supports 7-day or 5/2-day programming, allowing you to customize temperature settings for different periods of the day (Morning, Day, Evening, Night). For detailed steps on programming, refer to the full user manual. The touchscreen operation simplifies the process, eliminating the need for small, hard-to-press buttons.

### Temperature Control and Override

Adjusting the temperature is done directly on the touchscreen using the up and down arrows. You can also apply a temporary override to your programmed schedule or manually hold a specific temperature for an extended period.

The display will show a flame icon when in heating mode and a snowflake icon when in cooling mode, providing a quick visual indicator of the current operational status.

## Official Product Overview Video

Your browser does not support the video tag.

Video 1: An official product overview of the Lux Products TX9600TS thermostat, highlighting its key features and ease of use.

## MAINTENANCE

### Filter Monitor

The TX9600TS includes a filter monitor feature to remind you when it's time to change your HVAC system's air filter. Regularly changing your filter is crucial for maintaining system efficiency and indoor air quality.

### Battery Replacement

The thermostat is powered by two AA batteries. When the battery indicator appears on the display, replace the batteries promptly to ensure continuous operation. Refer to the installation section or the full user manual for instructions on accessing the battery compartment.

## TROUBLESHOOTING

If you encounter any issues with your LUX TX9600TS thermostat, please refer to the comprehensive troubleshooting section in the full User Manual (PDF). Common issues and their solutions are typically covered, including display problems, temperature inaccuracies, and programming difficulties. For persistent problems, contact LUX customer support.

## SPECIFICATIONS

Feature	Detail
Brand	LUX
Model Name	TX9600TS
Product Dimensions	1.13"D x 5.38"W x 3.38"H
Controller Type	Touch
Special Feature	Programmable
Color	White
Specific Uses For Product	Heat Pump
Temperature Control Type	Programmable Digital
Connectivity Technology	Wi-Fi
Included Components	Thermostat
Power Source	Corded Electric / 2 AA batteries (required)
Item Weight	0.55 Pounds (8.8 ounces)
Shape	Rectangular

Feature	Detail
Display Type	Digital
Backlight	Yes
Batteries Required	2 AA batteries (for power or backup)
Average Battery Life	8760 Hours

## WARRANTY AND SUPPORT

For information regarding product warranty, technical support, or to access the complete user manual and installation guides, please visit the official LUX website or contact their customer service. Protection plans may also be available for extended coverage.

- User Guide (PDF): Download User Guide
- Installation Manual (PDF): Download Installation Manual
- User Manual (PDF): Download User Manual