

Manuals+

[Q & A](#) | [Deep Search](#) | [Upload](#)

[manuals.plus](#) /

- › [SOLO](#) /
- › [SOLO X16N-J8002 16 oz Symphony Trophy Plus Hot/Cold Cup Instruction Manual](#)

SOLO X16N-J8002

SOLO X16N-J8002 16 oz Symphony Trophy Plus Hot/Cold Cup Instruction Manual

Model: X16N-J8002

INTRODUCTION

This manual provides essential information for the proper use and handling of your SOLO X16N-J8002 16 oz Symphony Trophy Plus Hot/Cold Cups. These cups are designed for serving both hot and cold beverages, offering convenience and insulation.



Image: A single SOLO X16N-J8002 16 oz Symphony Trophy Plus Hot/Cold Cup, featuring the Symphony design. This cup is suitable for a variety of beverages.

SETUP AND PREPARATION

The SOLO X16N-J8002 cups are designed for immediate use upon unpacking. No assembly is required.

1. **Unpacking:** Carefully remove the cups from their packaging. Inspect for any damage during transit.
2. **Storage:** Store cups in a clean, dry environment away from direct sunlight and extreme temperatures to maintain their integrity.
3. **Lids (Optional):** If using coordinating lids (sold separately), ensure they are compatible with the 16 oz Trophy Plus cup size for a secure fit.

OPERATING INSTRUCTIONS

These cups are versatile for both hot and cold beverages.

For Hot Beverages:

- Pour hot liquids directly into the cup. The insulated foam construction helps maintain beverage temperature and keeps the exterior comfortable to touch.
- Ensure the beverage temperature does not exceed safe handling limits for foam products.
- If using a lid, press it firmly onto the rolled rim of the cup to create a seal.

For Cold Beverages:

- Fill the cup with cold liquids or ice. The insulation helps reduce condensation on the exterior.
- If using a lid, press it firmly onto the rolled rim of the cup to create a seal.



Image: A person writing at a table with a clear cup containing a cold beverage, demonstrating typical use in an office or study setting.

MAINTENANCE AND DISPOSAL

These cups are designed for single-use applications.

- **Cleaning:** Do not attempt to wash or reuse these cups. They are intended for one-time use only.
- **Disposal:** Dispose of used cups in accordance with local waste management regulations.

TROUBLESHOOTING

While these cups are simple in design, here are common inquiries:

- **Lid does not fit securely:** Ensure you are using a lid specifically designed for 16 oz Trophy Plus cups. Lids are sold separately and compatibility is crucial for a proper seal.

- **Cup feels too hot/cold:** The insulated foam is designed to maintain beverage temperature and provide a comfortable grip. Extreme temperatures of contents may still affect the cup's exterior. Always handle with care.
- **Leaking:** Check for any visible damage to the cup or rim. Ensure the lid (if used) is properly seated. These cups feature a rolled rim for structural rigidity and resistance to leaking when fitted with a compatible lid.

SPECIFICATIONS

Model Number	X16N-J8002
Brand	SOLO
Capacity	16 oz
Design/Theme	Symphony
Material	Insulated Foam
Special Feature	Non-Slip Grip, Rolled Rim
Cup Dimensions	Approximately 3.4" diameter x 5.1" height
Case Dimensions	17.6 x 10.8 x 31.3 inches
Case Weight	5.7 Pounds
Intended Use	Hot and Cold Beverages, Single-Use
Contents	Cup (Lids sold separately)

SUPPORT AND WARRANTY

For product inquiries or support, please contact SOLO customer service. As a disposable product, these cups typically do not come with a traditional warranty. Any issues related to manufacturing defects should be reported to the retailer or manufacturer directly upon receipt.

For more information about SOLO products, you may visit the official SOLO brand store [SOLO Store on Amazon](#).

© 2024 SOLO. All rights reserved. This manual is for informational purposes only.

Related Documents - X16N-J8002

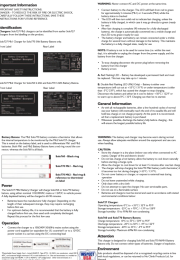
	<p>Solo 727 Battery Charger Instructions and Information</p> <p>This document provides important safety instructions, identification details, power and operation guidelines, and environmental considerations for the Solo 727 battery charger, compatible with Solo 760 and Solo 770 battery batons.</p>
-------------------------------------------------------------------------------------	----------------------------------------------------------------------------------------------------------------------------------------------------------------------------------------------------------------------------------------------------------------------------------------------------------------------------

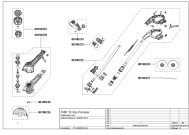

[SOLO PMAF 20 Solo Primaster Parts List](#)

Exploded view diagram and parts list for the SOLO PMAF 20 Solo Primaster, detailing components and their identification numbers.



[SOLO 260 Pulvérisateur à Batterie - Notice Originale](#)

Manuel d'instructions original pour le pulvérisateur à batterie SOLO 260. Ce guide fournit des informations essentielles sur l'utilisation sécuritaire et efficace, couvrant les consignes de sécurité, le chargement, l'application, le nettoyage et l'entretien de l'appareil SOLO 260.

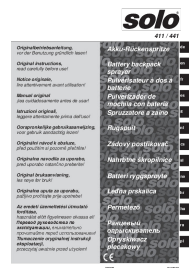

[SOLO 441 Battery Backpack Sprayer User Manual](#)

Comprehensive user manual for the SOLO 441 Battery Backpack Sprayer, detailing operation, safety, maintenance, and technical specifications. Includes instructions for assembly, use, and care of the sprayer.



[SOLO 411/441 Battery Backpack Sprayer User Manual](#)

Comprehensive user manual for the SOLO 411 and 441 battery backpack sprayers, covering operation, safety, maintenance, and technical specifications. Learn how to safely and effectively use your SOLO sprayer for various applications.



[SOLO 442 Battery Backpack Sprayer User Manual and Technical Specifications](#)

Comprehensive user manual and technical specifications for the SOLO 442 Battery Backpack Sprayer, covering operation, safety, maintenance, and product details. Includes assembly, usage instructions, and technical data.