

## Manuals+

[Q & A](#) | [Deep Search](#) | [Upload](#)

[manuals.plus](#) /

› [Westbrass](#) /

› [Westbrass D400-1-62 1-1/2 inch P-Trap Installation and Maintenance Manual](#)

## Westbrass D400-1-62

# Westbrass D400-1-62 1-1/2 inch P-Trap with High Box Flange Instruction Manual

Model: D400-1-62 | Brand: Westbrass

## PRODUCT OVERVIEW

The Westbrass D400-1-62 P-Trap is designed for use in bathroom or kitchen sink installations. This 1-1/2 inch OD, 17 gauge brass tubular P-trap includes a matching high box flange for a finished appearance. It features brass lock nuts on the neck and J-bend connections for secure installation.

- **Complete P-Trap Set:** Standard 1-1/2 inch OD, 17 Gauge Brass Tubular P-Trap with matching High Box Flange.
- **Premium Brass Durability:** Heavy-duty 17 Gauge brass construction for corrosion resistance and long-lasting performance.
- **Precise Measurements:** Approximately 11-1/2 inches from center of neck to end of tailpiece.
- **Universal Compatibility:** Suitable for standard residential and commercial sink installations with 1-1/2 inch drain configurations.
- **Easy Installation:** Kit includes slip joint nuts and all necessary hardware.



Figure 1: Westbrass D400-1-62 P-Trap with High Box Flange in Matte Black.

This image shows the complete Westbrass D400-1-62 P-Trap assembly in a matte black finish. It highlights the main components: the P-trap bend, the horizontal arm, and the high box flange.

## SETUP AND INSTALLATION

Follow these steps for proper installation of your Westbrass D400-1-62 P-Trap. Ensure all components are present before beginning.

1. **Prepare the Drain:** Ensure the sink tailpiece and wall drain pipe are clean and free of debris.
2. **Attach the High Box Flange:** Slide the high box flange onto the horizontal arm of the P-trap. This flange will sit flush against the wall for a clean aesthetic.
3. **Connect to Tailpiece:** Connect the vertical inlet of the P-trap to the sink's tailpiece using a slip joint nut and washer. Hand-tighten first, then use a wrench for a snug fit, being careful not to overtighten.
4. **Connect to Wall Drain:** Align the horizontal arm of the P-trap with the wall drain pipe. Use a slip joint nut and washer to secure this connection. Adjust the P-trap's position to ensure proper alignment and a slight downward slope towards the wall drain for optimal drainage.
5. **Tighten All Connections:** Once aligned, securely tighten all slip joint nuts. Avoid excessive force to prevent damage to the brass components or washers.

6. **Test for Leaks:** Run water through the sink for several minutes and carefully inspect all connections for any signs of leakage. If leaks occur, tighten the affected connections slightly.



Figure 2: Individual components of the Westbrass D400-1-62 P-Trap, including the P-trap body and high box flange.

This image displays the separate components of the P-trap assembly, including the main P-trap unit and the high box flange, ready for installation.

<div data-bbox="150 105 406 141" data-label="Text"> <p>PART NO. D400-1</p> </div>	<div data-bbox="584 105 994 147" data-label="Section-Header"> <p>SPECIFICATION SHEET</p> </div>	<div data-bbox="1117 89 1481 154" data-label="Text"> <p>Brass 1-1/2" x 1-1/2" or 1-1/2" x 1-1/4" P-Trap with hi-box flange.</p> </div>
<div data-bbox="103 1886 376 1944" data-label="Page-Footer"> <p>WESTBRASS Fine Decorative Plumbing Since 1935</p> </div>	<div data-bbox="534 1897 1415 1926" data-label="Page-Footer"> <p>info@westbrass.com   www.westbrass.com   (213) 627-8441   FAX (213) 627-2844</p> </div>	

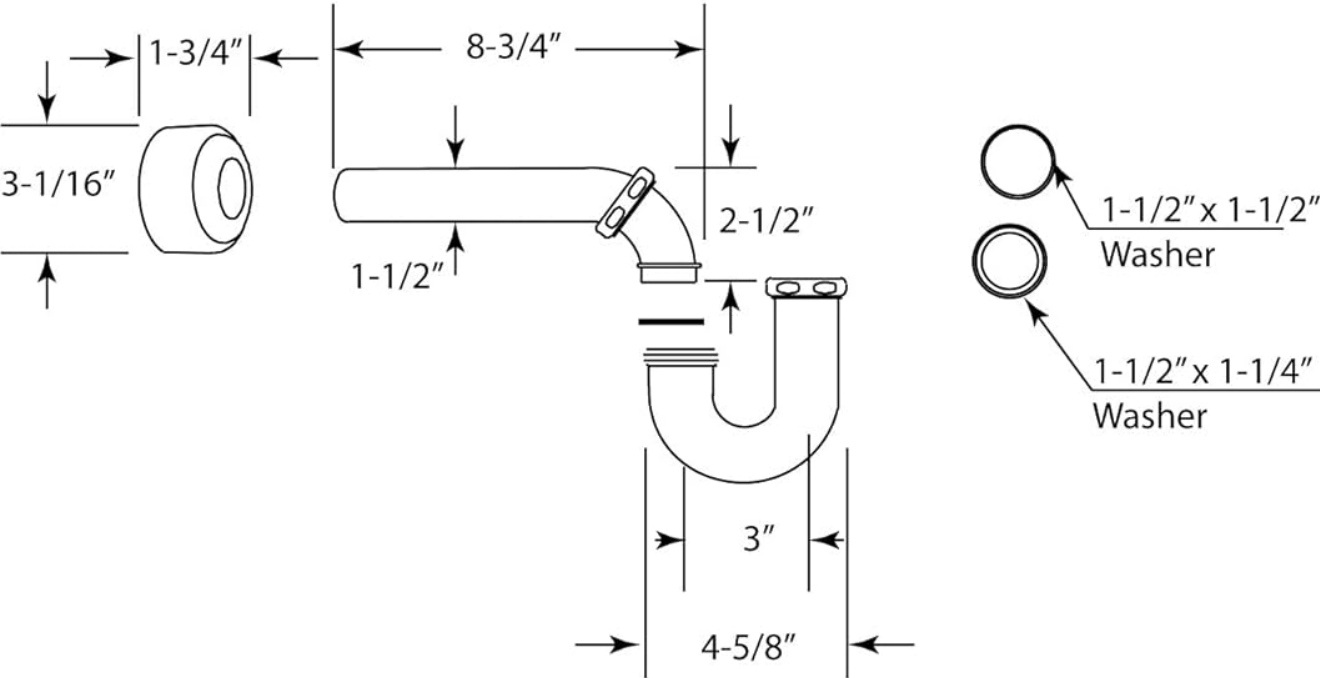

Figure 3: Technical drawing with dimensions for the Westbrass D400-1-62 P-Trap.

This specification sheet provides detailed measurements and a diagram of the P-trap, including the 1-1/2 inch OD and the overall dimensions, which are crucial for planning the installation space. It also shows the included washers.



Figure 4: Example installation of the Westbrass D400-1-62 P-Trap under a sink.

This image illustrates the P-trap installed beneath a sink, demonstrating how it connects to the tailpiece and extends to the wall drain, providing a visual reference for the completed setup.

## OPERATING PRINCIPLES

---

The Westbrass D400-1-62 P-Trap functions as a critical component of your plumbing system by creating a water seal. This seal prevents sewer gases and odors from entering your living space through the drain. When water flows through the sink, a small amount remains in the P-trap's U-bend, forming this essential barrier.



## ✓ EASY MAINTENANCE DESIGN

Simple to install, easy to clean, and engineered for leak-free, trouble-free operation for long-term peace of mind



## ✓ IDEAL DIMENSIONS

Designed approximately 11-1/2 inches from center of neck to end of tailpiece, ideal for easy and accurate installation

Figure 5: Illustration of the P-trap's function in preventing sewer odors.

This diagram visually explains how the classic P-trap design retains water to create a barrier, effectively preventing sewer gases from escaping into the room, thus maintaining a fresh and hygienic environment.

## MAINTENANCE

Regular maintenance ensures the longevity and proper function of your P-trap.

- **Regular Cleaning:** Periodically flush the drain with hot water to help prevent grease and soap buildup.
- **Avoid Harsh Chemicals:** Do not use strong chemical drain cleaners, as they can corrode brass and damage seals over time. Use enzymatic cleaners or a mixture of baking soda and vinegar for minor clogs.
- **Check for Leaks:** Occasionally inspect the P-trap connections for any signs of drips or moisture, especially after heavy use. Tighten connections if necessary.
- **Clear Blockages:** If a clog occurs, the P-trap can be disassembled to remove debris. Place a bucket underneath before loosening the slip nuts to catch any water.



Figure 6: The P-trap's design facilitates easy maintenance and cleaning.

This image highlights the P-trap's design, emphasizing its simple structure which allows for straightforward disassembly and cleaning, contributing to long-term, trouble-free operation.

TROUBLESHOOTING

Problem	Possible Cause	Solution
Leaks at connections	Loose slip nuts, damaged washers, improper alignment.	Ensure slip nuts are tightened securely (hand-tight plus a quarter turn with a wrench). Check washers for proper seating and damage; replace if necessary. Verify correct alignment of pipes.
Slow drainage or clog	Accumulation of hair, soap scum, or debris in the P-trap.	Disassemble the P-trap (place a bucket underneath) and manually remove any blockages. Clean the interior of the trap. Reassemble and test.

Problem	Possible Cause	Solution
Sewer odors	P-trap water seal has evaporated or been siphoned.	Run water for a minute to refill the P-trap. If the problem persists, check for proper venting in your plumbing system.

### SPECIFICATIONS

Feature	Detail
Model Number	D400-1-62
Brand	Westbrass
Material	Brass
Size	1-1/2 inch OD, 17 Gauge
Color	Matte Black
Product Dimensions	Approximately 12 x 1.5 x 6 inches (L x W x H)
Item Weight	1.2 pounds
Included Components	(1) - P-Trap with Flange

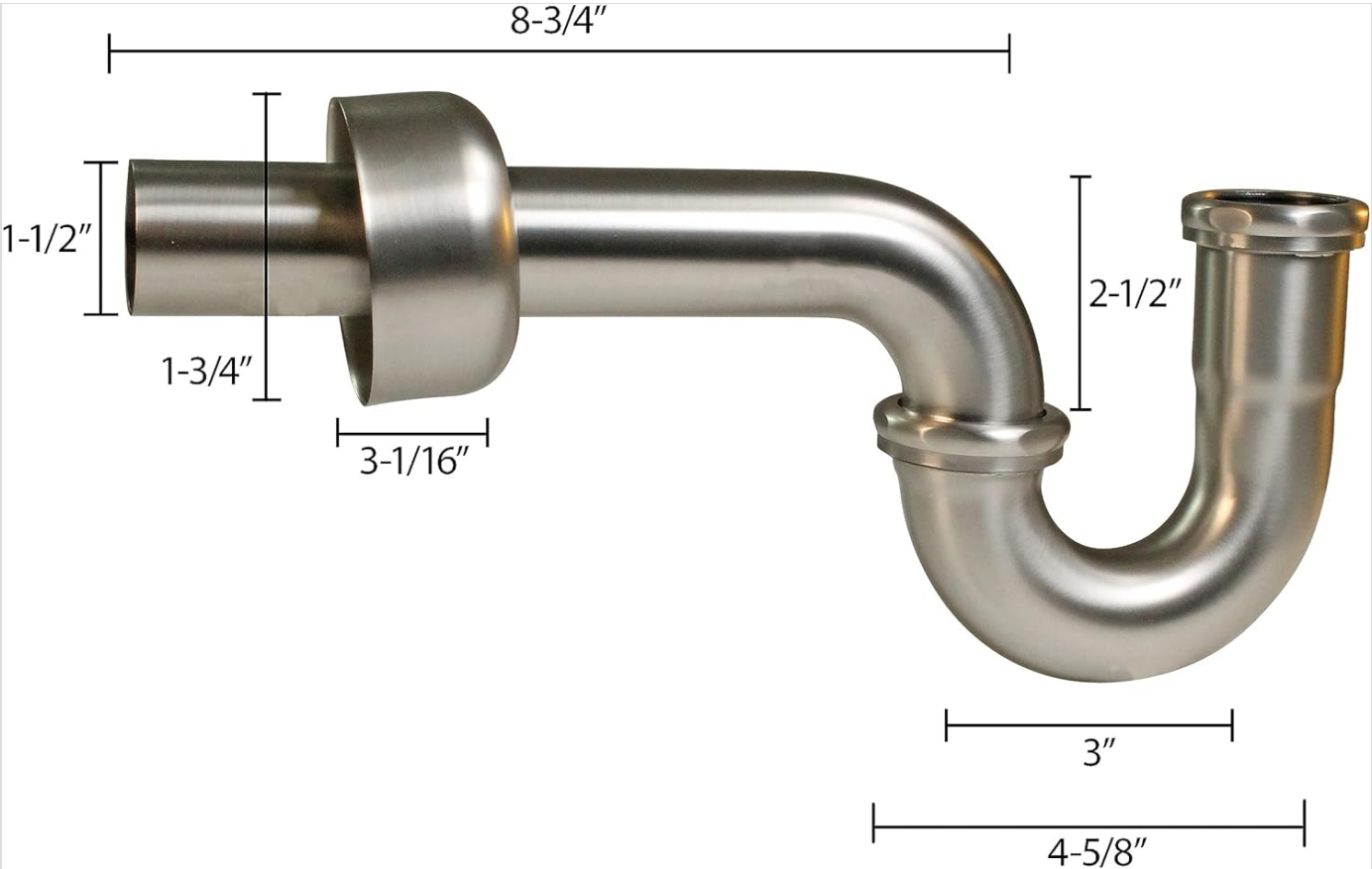

Figure 7: Dimensional drawing of the P-trap, showing key measurements for fitment.

This image provides a detailed dimensional drawing of the P-trap, including measurements such as the 1-1/2 inch diameter, 8-3/4 inch length from the wall, and other critical dimensions for installation planning.



## WARRANTY INFORMATION

---

The Westbrass D400-1-62 P-Trap is covered by a **1 Year Limited Warranty**. This warranty covers defects in materials and workmanship under normal use and service. For specific terms and conditions, please refer to the official Westbrass warranty documentation or contact Westbrass customer support.

## CUSTOMER SUPPORT

---

For further assistance, technical support, or warranty claims regarding your Westbrass D400-1-62 P-Trap, please contact Westbrass customer service.

**Brand:** Westbrass

**Website:** [www.westbrass.com](http://www.westbrass.com) (Please note: This is a general link, specific support contact information may be found on the official product page or packaging.)

