

Tell MQ008

TELL MANUFACTURING, INC. Commercial Grade 1 Door Closer, Model MQ008, Size 4 Instruction Manual

Model: MQ008 | Brand: Tell

INTRODUCTION

This instruction manual provides essential information for the proper installation, adjustment, and maintenance of your TELL MANUFACTURING, INC. Commercial Grade 1 Door Closer, Model MQ008, Size 4. Please read these instructions thoroughly before beginning installation to ensure safe and correct operation. Retain this manual for future reference.

PRODUCT OVERVIEW

The Tell Commercial Grade 1 Door Closer is designed for reliable and controlled closing of commercial doors. It is a non-handed unit, suitable for various mounting configurations, and built to meet high industry standards for durability and performance.



Figure 1: Tell Commercial Grade 1 Door Closer, Model MQ008. This image displays the silver-colored cast aluminum body with an adjustable arm and spring mechanism. The arm is designed for various mounting applications, including regular, top jamb, and parallel arm installations. The closer is engineered for durability and smooth door operation.

Key Features:

- **Commercial Grade 1:** Engineered for high-traffic commercial environments.
- **ANSI A 156.4, 300 Series, Grade 3:** Certified for 500,000 cycles, ensuring long-term performance.
- **UL Listed:** Meets safety and performance standards.
- **Non-Handed Design:** Versatile for regular, top jamb, or parallel arm mounting.
- **Adjustable Closing Speed:** Allows for precise control over door closing.
- **Durable Construction:** Made from cast aluminum with an aluminum finish.

SAFETY INFORMATION

- Always wear appropriate personal protective equipment (PPE), such as safety glasses and gloves, during installation.
- Ensure the door is securely propped open or removed from its hinges before beginning installation to prevent accidental movement.
- Do not attempt to disassemble the closer body, as it contains pressurized components.
- Follow all local building codes and regulations for door closer installation.
- If you are unsure about any part of the installation process, consult a qualified professional.

PACKAGE CONTENTS

Verify that all components are present before beginning installation:

- Door Closer Body (1)
- Main Arm Assembly (1)
- Parallel Arm Bracket (if applicable for parallel arm mounting) (1)
- Mounting Screws and Fasteners (Set)
- Instruction Template (1)

INSTALLATION (SETUP)

The Tell Commercial Grade 1 Door Closer can be installed in three common configurations: Regular Arm (Pull Side), Top Jamb (Push Side), and Parallel Arm (Push Side). Refer to the included template for precise drilling locations and specific instructions for your chosen mounting type.

General Steps:

1. **Prepare the Door and Frame:** Ensure the mounting surfaces are clean, flat, and structurally sound.
2. **Position the Template:** Affix the provided paper template to the door and/or frame according to your desired mounting configuration.
3. **Drill Pilot Holes:** Using the template, drill pilot holes for the closer body and arm bracket. The door preparation requires 9-1/16" horizontal and 3/4" vertical mounting hole locations.
4. **Mount the Closer Body:** Secure the closer body to the door or frame using the provided screws.
5. **Attach the Main Arm:** Connect the main arm to the closer spindle.
6. **Install the Arm Bracket:** Secure the arm bracket to the frame or door, depending on the mounting type.
7. **Connect the Arm Assembly:** Connect the main arm to the arm bracket, ensuring proper alignment.
8. **Initial Adjustment:** Perform initial adjustments as described in the "Operation and Adjustment"

section.

Note: The door closer is non-handed, meaning it can be installed on either left-hand or right-hand doors without modification. The door range is up to 180 degrees, depending on the installation type and door frame clearance.

OPERATION AND ADJUSTMENT

The door closer features adjustable valves to control the closing speed and latching action. These adjustments are crucial for optimal performance and safety.

Adjustment Valves:

- **Closing Speed Valve:** Controls the speed of the door from its fully open position until approximately 10-15 degrees from the closed position.
- **Latching Speed Valve:** Controls the speed of the door for the final 10-15 degrees of closing, ensuring the door latches securely.

Adjustment Procedure:

1. Use a flathead screwdriver to turn the adjustment valves.
2. Turn the valve **clockwise** to **decrease** the speed (slower).
3. Turn the valve **counter-clockwise** to **increase** the speed (faster).
4. Make small adjustments (quarter-turns) and test the door's closing action after each adjustment.
5. Ensure the door closes smoothly and latches without slamming or leaving the door ajar.

Caution: Do not turn the valves more than two full turns counter-clockwise from the factory-set position, as this may cause fluid leakage and damage the closer.

MAINTENANCE

Regular maintenance ensures the longevity and optimal performance of your door closer.

- **Periodic Inspection:** Annually inspect the closer body, arm assembly, and mounting screws for any signs of wear, damage, or looseness.
- **Tighten Fasteners:** If any screws or fasteners are loose, tighten them immediately.
- **Clean the Unit:** Wipe down the closer body and arm with a soft, damp cloth to remove dust and grime. Avoid abrasive cleaners.
- **Check for Leaks:** Inspect the closer body for any signs of fluid leakage. A leaking closer indicates internal damage and requires replacement.
- **Re-adjust as Needed:** Over time, environmental factors or heavy use may require minor re-adjustment of the closing and latching speeds.

TROUBLESHOOTING

Problem	Possible Cause	Solution
Door slams shut.	Closing or latching speed set too fast.	Turn closing and/or latching speed valves clockwise to decrease speed.

Problem	Possible Cause	Solution
Door does not close completely or latch.	Closing or latching speed set too slow; arm assembly loose; door hinges binding.	Turn closing and/or latching speed valves counter-clockwise to increase speed. Check and tighten arm assembly. Inspect door hinges.
Fluid leakage from closer body.	Internal seal failure; over-adjustment of valves.	The closer is damaged and requires replacement. Do not attempt to repair.
Door closer makes excessive noise.	Loose mounting screws; worn arm components.	Check and tighten all mounting screws. Inspect arm for wear and replace if necessary.

SPECIFICATIONS

Model Number	MQ008
Brand	Tell
Closer Size	4
Grade	Commercial Grade 1
Standards Met	ANSI A 156.4, 300 Series, Grade 3, 500,000 cycles, UL Listed
Material	Cast Aluminum
Finish	Aluminum (Silver)
Installation Type	Screw-In
Mounting Applications	Regular, Top Jamb, Parallel Arm
Door Range	Up to 180 degrees
Product Dimensions	9.8 x 1.75 x 3 inches
Item Weight	5.37 pounds
UPC	737874123442

WARRANTY AND SUPPORT

This TELL MANUFACTURING, INC. door closer is backed by a **10-year limited warranty** by the manufacturer. This warranty covers defects in materials and workmanship under normal use and service. For warranty claims, technical assistance, or further support, please contact Tell Manufacturing, Inc. customer service. Refer to the product packaging or the manufacturer's official website for current contact information.

Related Documents - MQ008

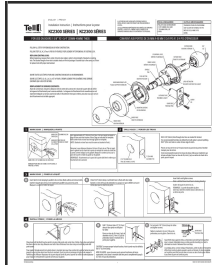

[Tell KC2300 Series Door Lock Installation Instructions](#)

Detailed installation guide for Tell KC2300 Series door locksets, suitable for doors 1-3/8" to 1-3/4" thick. Covers new installations and replacement of existing locks, including drilling, latch and strike installation, and knob adjustment.

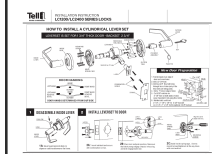

[Tell LC1200/LC2400 Series Locks Installation Instructions](#)

Detailed installation guide for Tell LC1200 and LC2400 series cylindrical lever locks, covering door preparation, assembly, and adjustments for various door thicknesses.

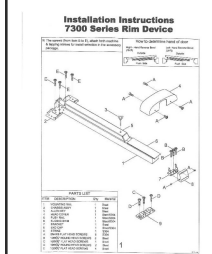

[Installation Instructions for Tell 7300 Series Rim Device](#)

Comprehensive installation guide for the Tell 7300, F7300, 7100, and F7100 Series Rim Devices, detailing parts identification, door hand determination, and step-by-step mounting procedures with detailed diagrams described textually.