

Manuals.plus /

- › British General /
- › BG Electrical Double Switched Power Socket User Manual

British General NPC22W-01

BG Electrical Double Switched Power Socket User Manual

Comprehensive instructions for installation, operation, and maintenance.

1. PRODUCT OVERVIEW

The BG Electrical Double Switched Power Socket (Model: NPC22W-01) is a 13 Amp, 2-gang switched outlet designed for domestic and commercial electrical installations. It features a polished chrome finish with white inserts, offering a sleek and modern aesthetic. This product is part of the Nexus Metal range, known for its softly rounded corners and slim profile.



Figure 1: The BG Electrical Double Switched Power Socket features a polished chrome finish with two switched outlets and white inserts,

designed for modern interiors.

Stylish Polished Chrome Finish with white inserts



No visible plastic around the switches

Figure 2: The socket boasts a sleek, polished chrome finish with no visible plastic around the switches, ensuring a clean and elegant appearance.

2. SETUP AND INSTALLATION

Important Safety Notice: Installation should only be carried out by a qualified electrician in accordance with current wiring regulations. Always isolate the mains power supply before commencing any electrical work.

2.1 Pre-Installation Checks

- Ensure the power supply to the circuit is switched off at the consumer unit/fuse box.
- Verify that the existing back box is suitable for the new socket. This unit is designed to fit a 25mm deep back box.
- Inspect the socket for any signs of damage before installation.

Decorative Raised Profile

premium metal with rounded edges



Fits a 25mm back box
ideal for retro fit

Figure 3: Designed with a decorative raised profile and rounded edges, this premium metal socket fits a standard 25mm back box, making it ideal for both new installations and retrofits.

2.2 Wiring Instructions

1. Carefully remove the existing socket (if applicable) and disconnect the wiring, noting the connections.
2. Prepare the new socket by loosening the angled in-line colour-coded captive screw terminals.
3. Connect the wires to the corresponding terminals:
 - **Brown/Red wire:** Connect to the 'L' (Live) terminal.
 - **Blue/Black wire:** Connect to the 'N' (Neutral) terminal.
 - **Green/Yellow wire:** Connect to the 'E' (Earth) terminal.

Ensure all wire insulation is stripped to the correct length and that no bare wires are exposed outside the terminals. Tighten the screws securely.

4. Gently push the wired socket into the back box, ensuring no wires are trapped or pinched.
5. Secure the socket to the back box using the provided screws.

6. Replace the faceplate and tighten any retaining screws.

Colour Coded Terminals for easy identification

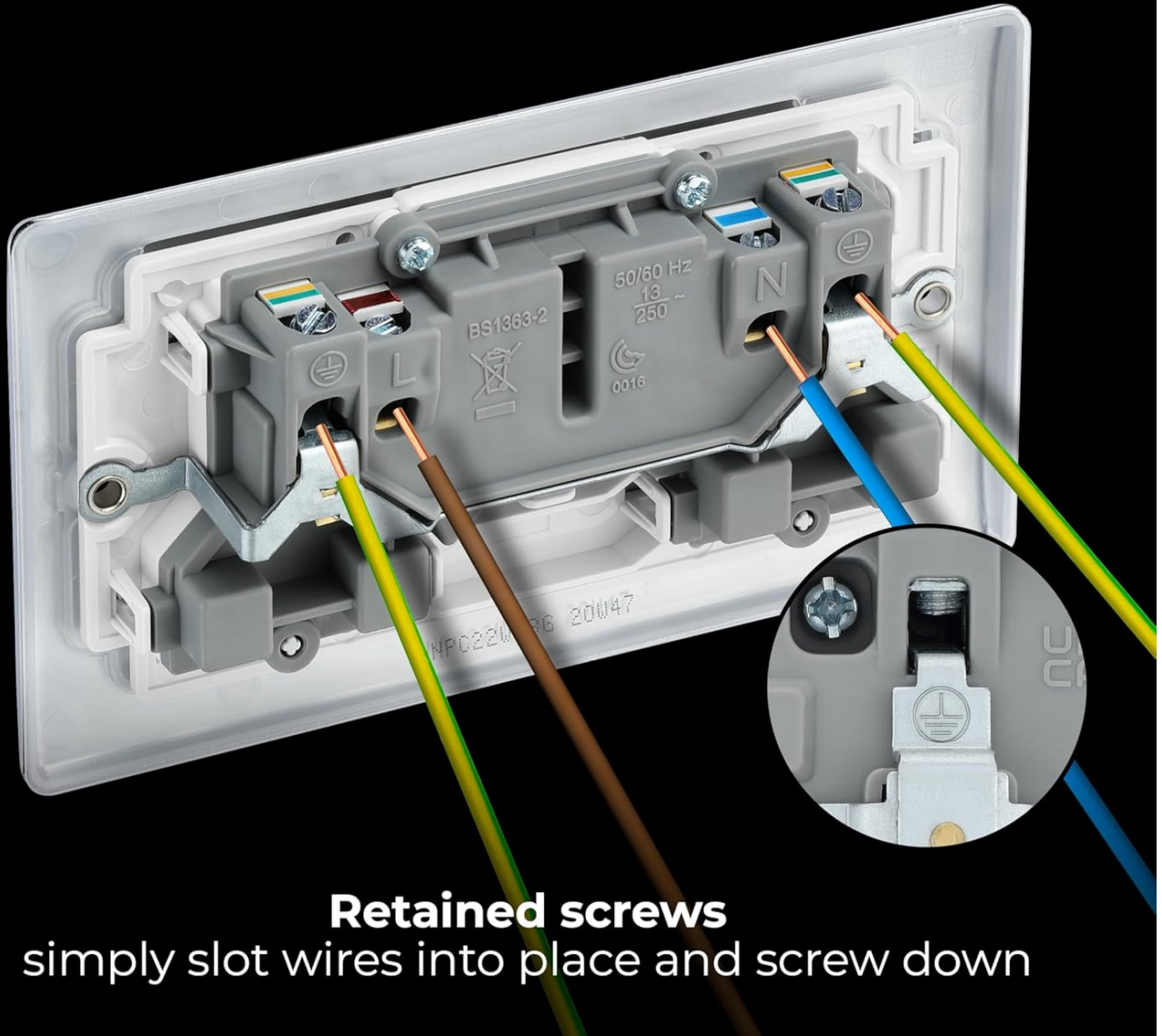

Figure 4: The rear of the socket features angled in-line colour-coded captive screw terminals (brown for live, blue for neutral, green/yellow for earth) for easy and secure wiring. The screws are retained, simplifying the installation process.

2.3 Post-Installation

- Once installation is complete, restore power at the consumer unit/fuse box.
- Test the functionality of both switched outlets.

3. OPERATING INSTRUCTIONS

The BG Electrical Double Switched Power Socket operates like any standard switched wall socket. Each outlet has an independent switch for controlling power to the connected appliance.

- **To supply power:** Insert the appliance plug into the desired socket. Flip the corresponding switch to the 'ON' position.
- **To cut power:** Flip the corresponding switch to the 'OFF' position. This will disconnect power to the appliance

without needing to unplug it.



Figure 5: The socket is designed for standard electrical plugs, providing reliable power access for various appliances.

4. MAINTENANCE

This power socket requires minimal maintenance. Regular cleaning and periodic safety checks are recommended.

- **Cleaning:** To clean the polished chrome finish, use a soft, dry cloth. For stubborn marks, a slightly damp cloth with mild soap can be used, followed by immediate drying. Avoid abrasive cleaners, solvents, or polishes as these can damage the finish. Always ensure the power is off before cleaning.
- **Safety Checks:** Periodically check the socket for any signs of damage, such as cracks, loose connections, or discoloration. If any issues are observed, isolate the power and consult a qualified electrician immediately.

5. TROUBLESHOOTING

If you encounter issues with your power socket, consider the following common troubleshooting steps. If the problem

persists, contact a qualified electrician.

- **No Power from Socket:**

- Check if the switch on the socket is in the 'ON' position.
- Verify that the appliance is working by testing it in another known-good socket.
- Check the circuit breaker or fuse for the circuit at your consumer unit/fuse box. Reset the breaker or replace the fuse if tripped/blown.
- Ensure the plug is fully inserted into the socket.

- **Loose Connection:**

- If the socket feels loose on the wall, isolate the power and gently tighten the mounting screws. Do not overtighten.
- If the internal wiring feels loose, this requires professional attention. Do not attempt to fix internal wiring unless you are a qualified electrician.

- **Socket is Hot to Touch:**

- Immediately unplug any appliances and switch off the power to the socket at the consumer unit.
- A hot socket can indicate an overload or a faulty connection. This requires immediate inspection by a qualified electrician.

6. SPECIFICATIONS

| Feature | Detail |
|----------------------|--|
| Model Number | NPC22W-01 |
| Brand | British General |
| Product Dimensions | 5.75 x 3.39 x 0.04 inches; 7.41 ounces |
| Current Rating | 13 Amps |
| Operation Mode | ON-NONE-ON, ON-OFF-ON |
| Contact Type | Normally Open |
| Connector Type | Plug In |
| Terminal Type | Screw |
| Circuit Type | 2-way |
| Contact Material | Metal |
| Number of Positions | 2 |
| Manufacturer | BG Electrical |
| Date First Available | October 31, 2012 |

7. WARRANTY INFORMATION

BG Electrical provides a **25-year manufacturer's warranty** for this product. This warranty guarantees against faulty materials and workmanship from the date of purchase. Please retain your proof of purchase for any warranty claims.



Figure 6: British General provides a 25-year manufacturer's warranty, reflecting their commitment to quality and over 80 years of experience in the electrical industry.

8. SUPPORT AND CONTACT

For further assistance, technical support, or warranty claims, please contact British General customer service. Refer to the packaging or the official British General website for the most current contact information.

In case of any electrical concerns or if you are unsure about any installation steps, always consult a qualified and certified electrician.

