



Manuals.plus /

- › The Helping Hand Company /
- › The Helping Hand Company Kingfisher Bath Seat Instruction Manual

## The Helping Hand Company HA0674

# Kingfisher Bath Seat Instruction Manual

Model: HA0674

## INTRODUCTION

---

The Kingfisher Bath Seat is designed to assist individuals who experience difficulty getting into or out of a bath safely. This sturdy, lightweight, and portable bath aid provides a secure seating solution, allowing users to relax and wash without the need to bend excessively. It features a contoured, slatted surface for quick drainage and non-slip suction cups for stability.

This manual provides essential information regarding the assembly, operation, maintenance, and specifications of your Kingfisher Bath Seat to ensure safe and effective use.

## SETUP AND ASSEMBLY

---

The Kingfisher Bath Seat is designed for quick and easy assembly without the need for tools. Please follow these steps carefully:

1. **Attach Feet:** Before initial use, push each of the four suction cup feet firmly into the leg sockets on the underside of the bath seat.
2. **Secure Feet:** Ensure each foot is pushed fully home until the catch 'A' engages securely in the rectangular slot 'B' located on the inside of the leg socket. Verify that all feet are securely attached before proceeding.



A close-up image showing how to attach the suction cup feet into the leg sockets during assembly.

## Positioning the Bath Seat

1. **Place in Bath:** Position the bath seat in your bath before filling it with water.
2. **Secure Suction Cups:** Press down firmly on the bath seat to engage and secure the suction cup feet to the bottom of the bath.

# Kingfisher Bath Seat 6", 8", 10", 12" - Instructions

**1** Before using the bath seat for the first time, push each of the four sucker feet into the leg sockets.

**2 & 3** Ensure the foot is pushed fully home and the catch 'A' is engaged in the rectangular slot 'B', on the inside of the leg socket.

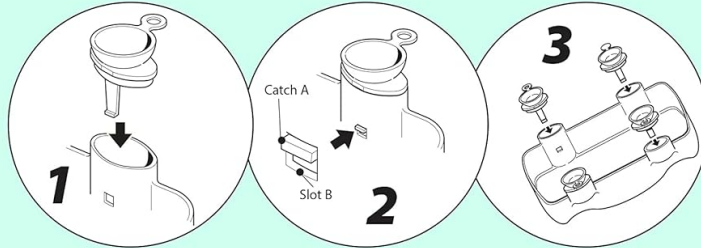

Check that the feet are secure before use.

## Positioning the bath seat to your bath

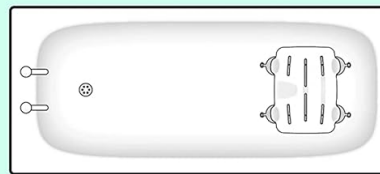
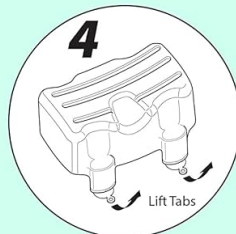

Position in bath.

**4** Place the bath seat in the bath before filling with water, press down firmly to secure the sucker feet.

**NOTE:**

Lift the suction release tab on each of the sucker feet before lifting the bath seat out of the bath.

  
The Helping Hand  
Company

An instructional diagram detailing the process of attaching the feet to the bath seat and how to correctly position it in the bath.

**NOTE: To remove the bath seat, lift the suction release tab on each of the sucker feet before attempting to lift the bath seat out of the bath.**

## OPERATING INSTRUCTIONS

The Kingfisher Bath Seat is designed for safe and comfortable use during bathing or showering. Once securely positioned in the bath, you can sit on the seat to wash, reducing the risk of slipping or falling. The slatted surface ensures efficient water drainage.



The Kingfisher Bath Seat shown with its standard, shorter leg configuration, designed for use within a bathtub.



The Kingfisher Bath Seat with optional leg extensions installed, providing a higher seating position within the bathtub.

- The seat's design allows for full leg extension within most baths, including corner baths.
- The front cutaway design facilitates personal cleaning.
- The bath seat is portable and can be easily removed and stored when not in use, or for travel.

## CARE AND MAINTENANCE

---

To ensure the longevity and hygiene of your Kingfisher Bath Seat, follow these maintenance guidelines:

- **Cleaning:** Clean the bath seat regularly using a non-abrasive cream cleaner. Avoid harsh chemicals or abrasive pads that could damage the plastic surface.
- **Storage:** Do not store the bath seat in direct sunlight, as prolonged exposure can affect the material's integrity and color.
- **Inspection:** Periodically inspect the bath seat and its suction cups for any signs of wear or damage. Replace any worn or damaged parts immediately.

## TROUBLESHOOTING

---

### Suction Cups Not Sticking

If the suction cups do not adhere reliably to the bottom of your bath, consider the following:

- **Surface Condition:** Ensure the bath surface is clean, dry, and smooth. Older cast iron baths with uneven or worn enamel surfaces may reduce suction effectiveness.
- **Application:** Press down firmly on the seat to expel air from under the suction cups.
- **Weight Bearing:** Even if suction is not perfect, the user's weight on the seat often provides sufficient friction to prevent movement. Always test stability before full use.

## PRODUCT SPECIFICATIONS

---

Feature	Specification
Model Number	HA0674
Material	Plastic
Color	White
Maximum Weight Capacity	160 kg (25 stone)
Height	12 inches (30 cm)
Seat Depth	15.35 inches (39 cm)
Product Dimensions (L x W x H)	10.63 x 15.35 x 11.81 inches (27 x 39 x 30 cm)
Item Weight	3.83 pounds (1.74 kg)

## WARRANTY INFORMATION

---

The Kingfisher Bath Seat is covered by a **3-year warranty** from the date of purchase. This warranty covers manufacturing defects under normal use conditions. Proper use and maintenance, as outlined in this manual, are essential for the product's longevity. Misuse or improper care may void the warranty.

## SUPPORT AND CONTACT

---

For any questions, concerns, or to inquire about spare parts, please contact The Helping Hand Company directly. Spare parts are readily available to ensure continued use of your bath seat.

Please refer to the product packaging or the official website of The Helping Hand Company for the most current contact information.