

Schock NEMN100AGON

SCHOCK CRISTALITE NEMN100AGON Granite Kitchen Sink Instruction Manual

Model: NEMN100AGON | Dimensions: 57 x 51 cm | Color: Onyx Blue

[Introduction](#) [Setup](#) [Operating](#) [Maintenance](#) [Troubleshooting](#) [Specifications](#) [Warranty & Support](#)

1. INTRODUCTION

This manual provides detailed instructions for the installation, operation, and maintenance of your SCHOCK CRISTALITE NEMN100AGON granite kitchen sink. Manufactured in Germany, this sink is designed for durability and functionality, featuring a robust CRISTALITE quartz composite material and a modern rectangular design. Please read these instructions carefully before installation and use to ensure proper function and longevity of your product.

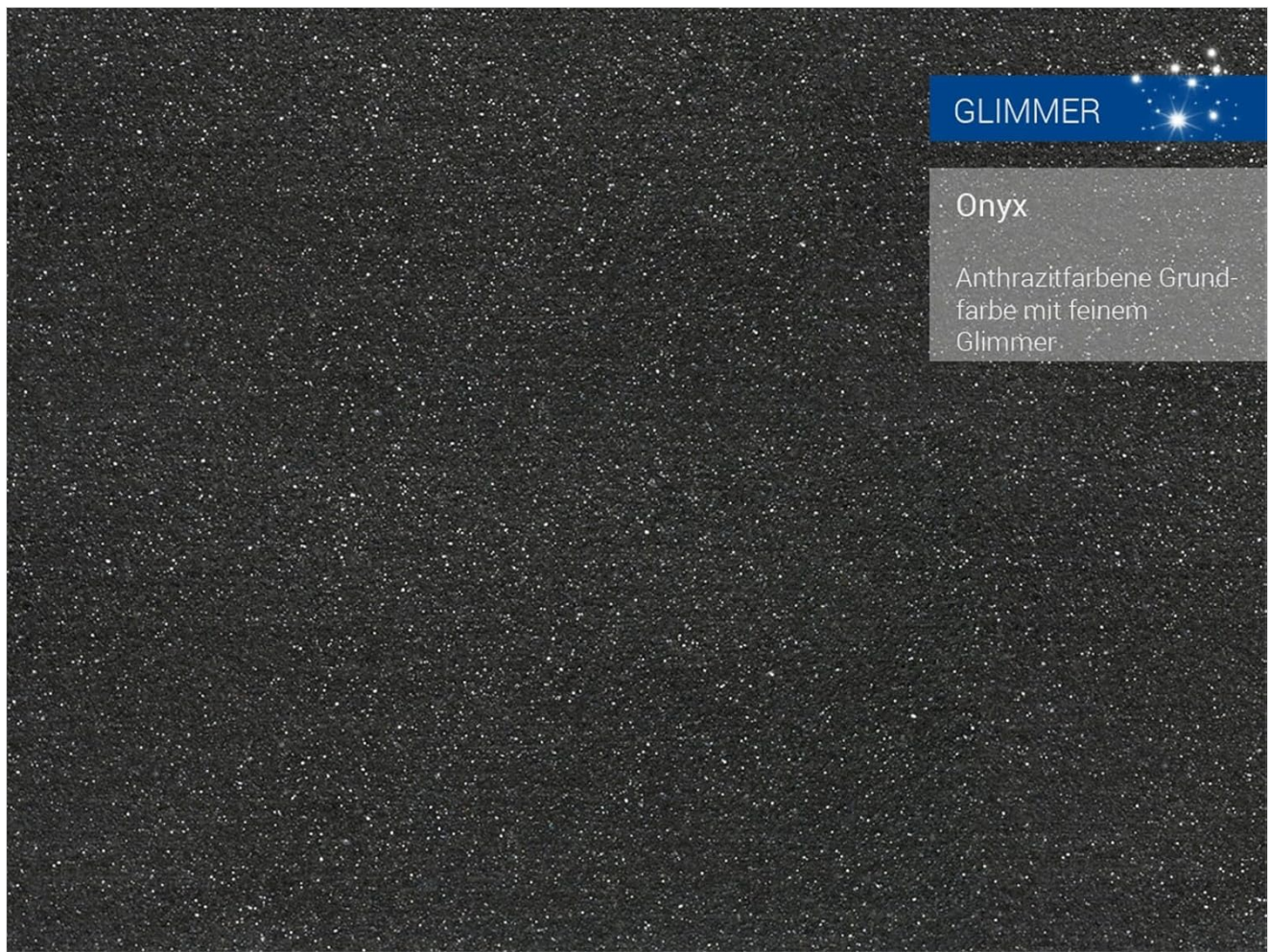

Image 1: SCHOCK CRISTALITE NEMN100AGON Kitchen Sink, showcasing its design and color.

2. SETUP AND INSTALLATION

The SCHOCK CRISTALITE NEMN100AGON sink is designed for countertop installation and requires a minimum base cabinet width of 60 cm. The sink features five pre-drilled holes for flexible placement of faucets or soap dispensers, which can be easily drilled out as needed.

2.1 Included Components

- SCHOCK CRISTALITE NEMN100AGON Sink
- 3.5" Waste Kit
- Basket Strainer
- Eccentric Control (for drain operation)
- Diamond Drill Bit (for pre-drilled holes)

2.2 Installation Steps (General Guidance)

1. **Prepare the Countertop:** Ensure the countertop opening matches the sink's dimensions (refer to technical drawing).
2. **Drill Faucet Holes:** Use the provided diamond drill bit to carefully open the desired pre-drilled holes for your faucet and/or soap dispenser.
3. **Install Faucet and Accessories:** Mount the faucet and any other accessories (like the soap dispenser) onto the sink before placing it into the countertop.
4. **Apply Sealant:** Apply a suitable sealant around the edge of the sink opening on the countertop to prevent water leakage.
5. **Place the Sink:** Carefully lower the sink into the countertop opening.

6. **Secure the Sink:** Use the provided mounting clips (if applicable, check packaging) to secure the sink firmly to the underside of the countertop.
7. **Connect Plumbing:** Connect the waste kit, basket strainer, and eccentric control to your household plumbing system. Ensure all connections are watertight.

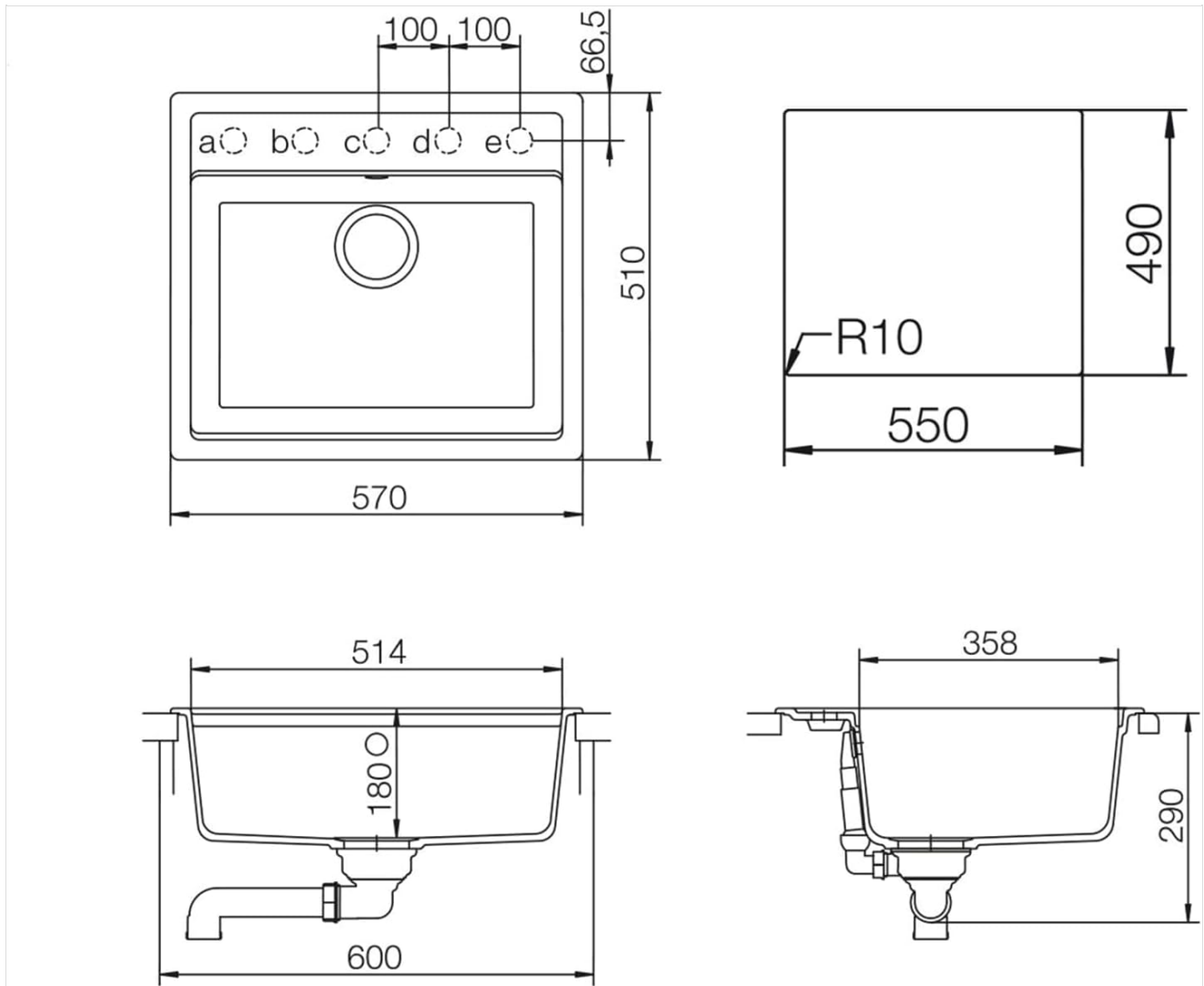

Image 2: Technical drawing showing precise dimensions and pre-drilled hole locations for installation.



Dreh-Exzenter

Dieses Szenebild ist beispielhaft. Alle Informationen entnehmen Sie bitte der Artikelbeschreibung.

Image 3: Close-up view of the eccentric control knob, used to operate the sink drain.

3. OPERATING INSTRUCTIONS

Your SCHOCK CRISTALITE sink is designed for daily kitchen tasks with ease and efficiency.

3.1 Daily Use

- **Spacious Bowl:** The large single bowl provides ample space for washing large pots, pans, and baking sheets.
- **Stepped Design:** The integrated stepped design allows for the use of additional accessories, such as steamer inserts or cutting boards, enhancing functionality.
- **Drain Operation:** Use the eccentric control knob to open and close the basket strainer for convenient draining without reaching into the water.

3.2 Material Properties

The CRISTALITE material offers exceptional performance:

- **Heat Resistant:** Withstands high temperatures from hot pots and pans.
- **Odor Neutral:** Does not absorb or retain food odors.
- **Food Safe:** Safe for contact with food items.
- **Impact Resistant:** Highly resistant to impacts and shocks from dropped items.



Abbildung: Schöck Nemo N-100 A in der Farbe Nero
Dieses Szenebild ist beispielhaft. Alle Informationen entnehmen Sie bitte der Artikelbeschreibung.



Abbildung: Schöck Nemo N-100 in der Farbe Colorado
Dieses Szenebild ist beispielhaft. Alle Informationen entnehmen Sie bitte der Artikelbeschreibung.

Image 4 & 5: Examples of SCHÖCK CRISTALITE sinks in different colors, demonstrating typical kitchen use.

4. CARE AND MAINTENANCE

The CRISTALITE material is known for its easy maintenance and robust surface. Regular cleaning will preserve its appearance and hygiene.

4.1 Daily Cleaning

- Wipe the sink with a soft cloth or sponge and a mild dish soap after each use.
- Rinse thoroughly with clean water to remove all soap residue.
- Dry the sink with a soft cloth to prevent water spots, especially in hard water areas.

4.2 Stain Removal

- For stubborn stains (e.g., coffee, tea, red wine), use a non-abrasive cleaner specifically designed for granite or composite sinks.
- Apply the cleaner, let it sit for a few minutes (as per cleaner instructions), then scrub gently with a soft brush or sponge.
- Rinse thoroughly and dry.

4.3 What to Avoid

- Avoid using abrasive cleaners, steel wool, or harsh chemicals (e.g., strong acids, alkalis, paint removers) as these can damage the surface.
- Do not place extremely hot items directly on the sink surface for extended periods, although the material is heat-resistant, extreme thermal shock should be avoided.
- Prevent prolonged contact with highly staining liquids or foods (e.g., beet juice, turmeric) to minimize the risk of discoloration, although the material is resistant.

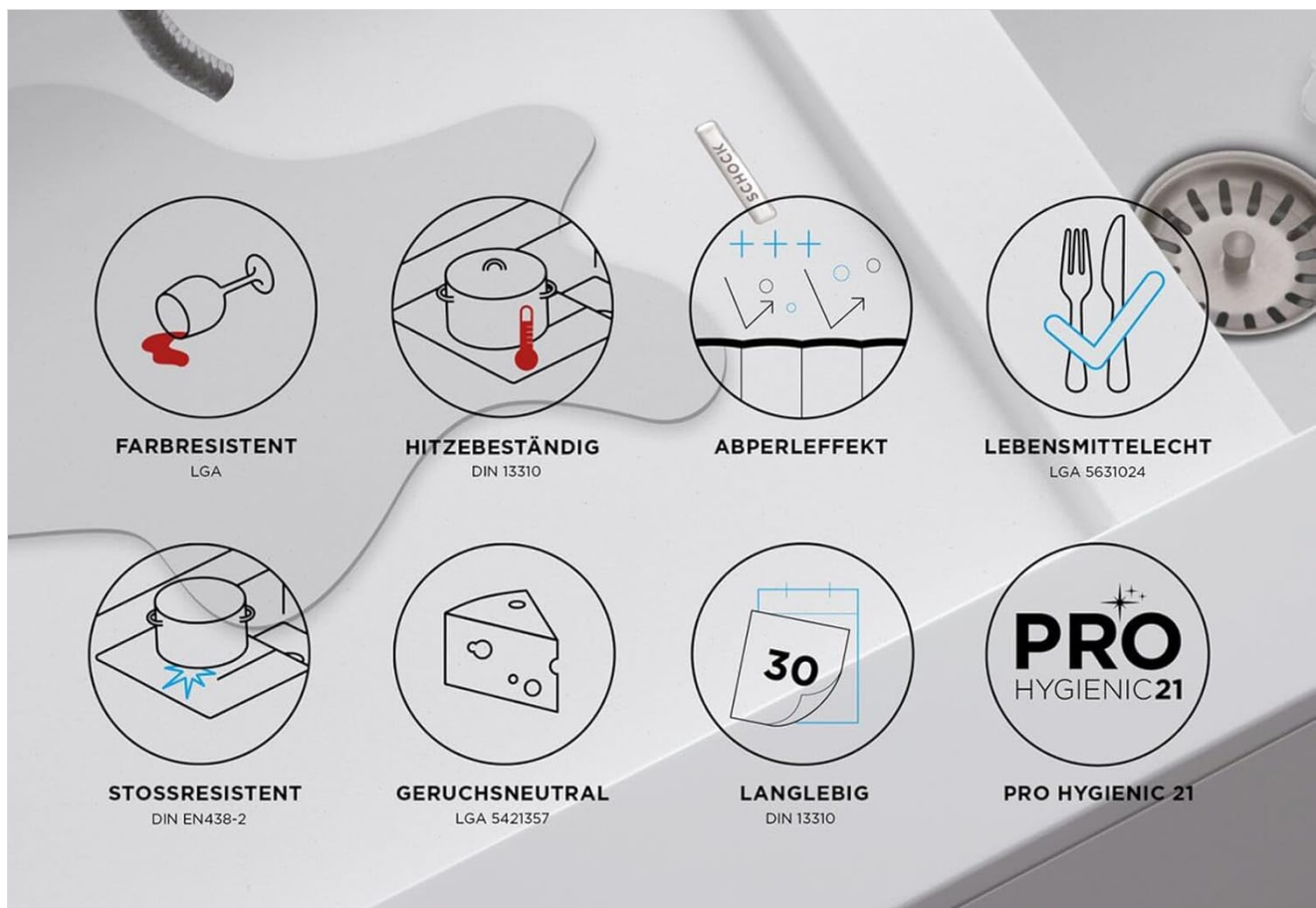

Den Alltagsbelastungen gewachsen. Eigenschaften der SCHOCK Spülenmodelle.
Dieses Szenebild ist beispielhaft. Alle weiteren Informationen entnehmen Sie bitte der Artikelbeschreibung.

Image 6: Visual representation of key material properties: color resistance, heat resistance, water repellent effect, food safety, impact resistance, odor neutrality, and durability.

5. TROUBLESHOOTING

This section addresses common issues you might encounter with your kitchen sink. For problems not listed here, please contact customer support.

5.1 Water Spots or Limescale

- **Cause:** Hard water deposits.
- **Solution:** Regularly dry the sink after use. For existing limescale, use a mild descaling agent or a solution of white vinegar and water. Apply, let sit briefly, scrub gently, and rinse thoroughly.

5.2 Fading or Dull Appearance

- **Cause:** Accumulation of soap film or mineral deposits over time.
- **Solution:** Perform a deep clean using a specialized granite sink cleaner. Ensure all residues are removed. Regular drying after use helps maintain shine.

5.3 Slow Draining

- **Cause:** Clogged basket strainer or drain pipe.
- **Solution:** Clear any debris from the basket strainer. If the issue persists, check the P-trap for blockages. Use a plumbing snake or a chemical drain cleaner if necessary, following product instructions carefully.

6. PRODUCT SPECIFICATIONS

Detailed technical specifications for the SCHOCK CRISTALITE NEMN100AGON kitchen sink.

Feature	Detail
Manufacturer	Schock
Model Number	NEMN100AGON
Product Dimensions (L x W x H)	51 x 57 x 29 cm
Sink Size	57 x 51 cm
Color	Onyx Blue
Style	Rectangular Sink
Finish	Unpolished
Material	Granite (CRISTALITE Quartz Composite)
Shape	Square
Installation Method	Countertop
Number of Holes	5 (pre-drilled)
Weight	11 Kilograms
Included Components	Sink, 3.5" Waste Kit, Basket Strainer, Eccentric Control, Diamond Drill Bit

SCHOCK

Farben **CRISTALITE®**

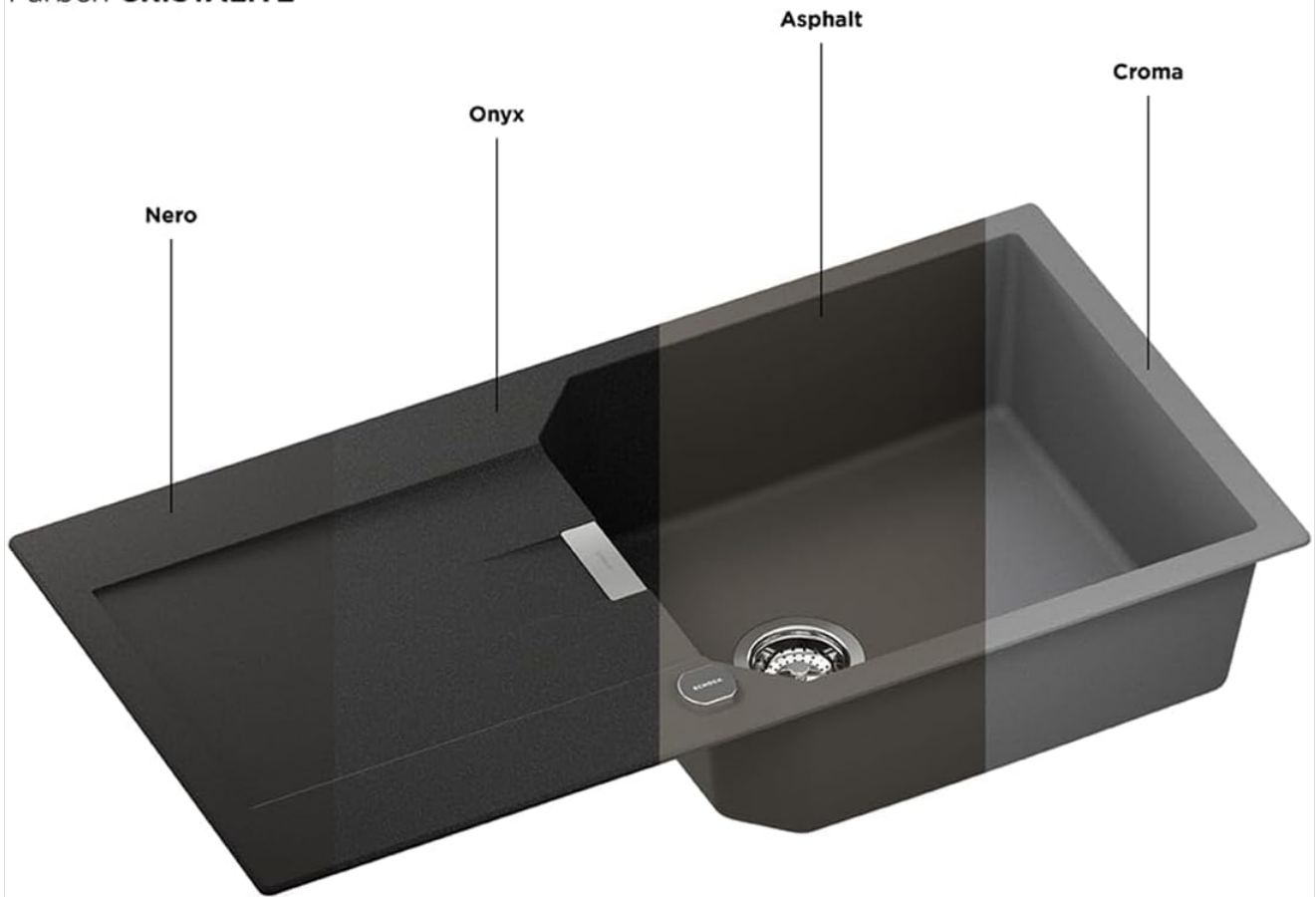

Image 7: Color representation of Onyx, highlighting the fine glimmer in the dark grey granite.

7. WARRANTY AND SUPPORT

7.1 Warranty Information

Specific warranty details for the SCHOCK CRISTALITE NEMN100AGON sink are typically provided at the point of purchase or can be found on the official SCHOCK website. Please retain your proof of purchase for any warranty claims. Warranty coverage usually includes manufacturing defects under normal use conditions.

7.2 Customer Support

For technical assistance, spare parts, or any questions regarding your SCHOCK product, please contact your retailer or visit the official SCHOCK website for customer service contact information.