

Yakima FrontLoader

# Yakima FrontLoader Rooftop Bike Rack Mount Instruction Manual

Model: FrontLoader | Brand: Yakima



## PRODUCT OVERVIEW

The Yakima FrontLoader is a versatile and durable rooftop bike carrier designed to transport your bicycle securely and conveniently. It features a wheel-on design, meaning you do not need to remove your bike's front wheel for transport. This rack is compatible with a wide range of bike types and vehicle crossbars, offering a reliable solution for your outdoor adventures.



Figure 1: Yakima FrontLoader Rooftop Bike Rack Mount

Key features include:

- **Versatile Bike Transport Solution:** Effortlessly carry your bicycles on car roofs with this secure Yakima bike rack, ideal for sedans and SUVs without hitches.
- **Durable and Reliable Design:** Crafted with high-quality materials, this bike carrier supports mountain bikes and fat tire bikes with strength and stability during every trip.
- **Safety & Security First:** Equipped with a secure mount system to hold bikes snugly in place while traveling. Sturdy and stable design minimizes movement, ensuring peace of mind on rugged journeys.
- **Compact & Lightweight:** The lightweight design allows for quick and easy setup without extra tools. Compact storage makes it perfect for on-the-go transportation and garage convenience.

## SETUP AND INSTALLATION

The Yakima FrontLoader comes fully assembled, making installation straightforward. It features universal mounts compatible with Yakima round, square, factory, or aerodynamic crossbars without needing special adapters.



# FrontLoader

## Rooftop Upright Bike Mount



### Easy Install & Use

No tools or assembly needed and no wheel removal when used



### Anti-theft

2 Optional SKS locks "Same Key System" (sold separately)

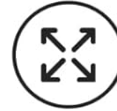

### Crossbar Compatible

Designed to fit all Yakima StreamLine crossbars and factory or aerodynamic crossbars



Figure 2: Key Features for Easy Installation and Compatibility

### Mounting to Vehicle Crossbars:

1. Open the clamps on the FrontLoader.
2. Place the FrontLoader onto your vehicle's crossbars.
3. Tighten the front clamp first, then close the rear clamp.
4. Secure the T-bolt to ensure the rack is firmly attached.

# YAKIMA®



## UNIVERSAL CROSSBAR MOUNTING

40 lbs. Single Bike Capacity Vehicle Rooftop Upright Mount

**Minimum  
Crossbar Spread**  
16"

**Maximum  
Crossbar Spread**  
42"



Figure 3: Universal Crossbar Mounting Details

### Official Product Video: Installation and Operation

Video 1: Yakima FrontLoader Wheel-On Mount Upright Bike Carrier for Roof Racks. This video demonstrates the easy installation process of the FrontLoader onto various crossbar types, followed by a step-by-step guide on how to load and secure a bicycle, highlighting the hands-free loading feature and the SKS security system.

### OPERATING INSTRUCTIONS

#### Loading Your Bicycle:

1. Drop the front wheel of your bike into the tray.
2. Roll the bike forward until the small hoop engages the bottom of the wheel. This holds your bike upright and hands-free.
3. Pull down on the front wheel hoop while turning the red knob clockwise to tighten and secure the front wheel.
4. Secure the rear wheel by threading the strap through the spokes and then ratcheting it tight through the buckle.



**YAKIMA®**



**Zero contact with frame;  
carbon fiber and paint  
jobs are protected**



Figure 4: The FrontLoader design ensures zero contact with your bike's frame, protecting carbon fiber and paint jobs.





Figure 5: Multiple FrontLoader racks can be installed to carry more bikes.

## SECURITY FEATURES

The Yakima FrontLoader offers integrated security to protect your bike and the rack itself.

- The rack includes a cable lock that threads through your bike frame and the small hoop, then locks into the rack.
- For enhanced security, the FrontLoader is compatible with Yakima's SKS (Same Key System) lock cores (sold separately). This allows you to use a single key for all your Yakima gear, including the FrontLoader and other accessories.



- |   |   |
|---|---|
| ① Folding Wheel Hoop Minimizes Drag And Wind Noise  | ④ Quick-Adjust Wheel Hoop Secures A Wide Range Of Tire Sizes          |
| ② Easy-To-Use Spinning Knob Tightens The Wheel Down | ⑤ Easy-To-Adjust Sliding Wheel Tray Fits A Wide Range Of Bike Lengths |
| ③ Optional 2 SKS Locks                              |   |

Figure 6: Detailed view of FrontLoader components, including the optional SKS lock core location (3).

## MAINTENANCE

To ensure the longevity and optimal performance of your Yakima FrontLoader, regular maintenance is recommended:

- Periodically inspect all fasteners and connections to ensure they are tight and secure.
- Clean the rack regularly with mild soap and water, especially after exposure to dirt, salt, or harsh weather conditions.
- Lubricate moving parts, such as the spinning knob and wheel hoop mechanism, as needed to ensure smooth operation.
- Store the rack in a dry, protected area when not in use to prevent corrosion and wear.

## TROUBLESHOOTING

If you encounter any issues with your Yakima FrontLoader, consider the following common troubleshooting steps:

- **Rack feels loose:** Re-check all mounting clamps and T-bolts to ensure they are fully tightened according to the installation instructions.

- **Bike is not stable:** Ensure the front wheel hoop is fully engaged and the red knob is tightened securely. Verify the rear wheel strap is ratcheted tight.
- **Difficulty with adjustments:** Clean any dirt or debris from the sliding mechanisms and lubricate if necessary.
- For persistent issues or concerns, please refer to the official Yakima support resources or contact customer service.

SPECIFICATIONS

Feature	Detail
Brand	Yakima
Model Name	FrontLoader
Item Dimensions (L x W x H)	56.5 x 8.5 x 10 inches
Load Capacity	40 Pounds
Mounting Type	Easy Snap (Universal Fit)
Included Components	Rack
UPC	736745021030
Part Number	8002103

WARRANTY AND SUPPORT

Yakima products are built to last and are backed by a limited lifetime warranty. For detailed warranty information, product registration, or to contact customer support, please visit the official Yakima website or refer to the warranty card included with your product. Keep your proof of purchase for any warranty claims.

© 2024 Yakima. All rights reserved.

Related Documents - FrontLoader

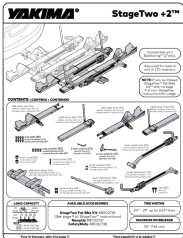

[Yakima StageTwo +2™ Hitch Bike Rack: Installation and User Guide](#)

Comprehensive guide for installing and using the Yakima StageTwo +2 hitch-mounted bicycle rack. Includes parts list, load capacity, installation steps, safety checks, and important warnings.



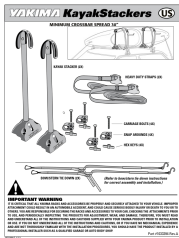

### [Yakima KayakStackers Installation Guide](#)

Comprehensive instructions for installing and securing Yakima KayakStackers on vehicle crossbars, including component lists, step-by-step procedures, safety warnings, and maintenance advice.

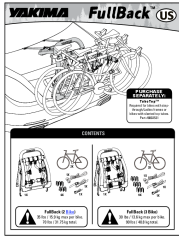

### [Yakima FullBack Bike Rack Installation and User Guide](#)

Comprehensive guide for installing, loading, and removing the Yakima FullBack bike rack. Includes safety warnings, weight limits, and vehicle compatibility notes for secure bicycle transport.

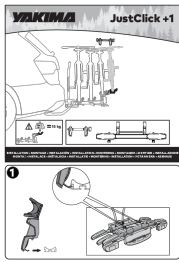

### [Yakima JustClick +1 Bike Rack Installation Guide](#)

Step-by-step installation instructions for the Yakima JustClick +1 bike rack, including weight limits and important safety information. Learn how to securely attach your bikes.

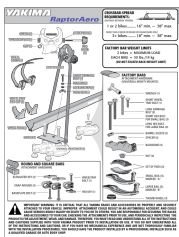

### [Yakima RaptorAero Bike Rack Installation Guide](#)

Comprehensive installation instructions for the Yakima RaptorAero bike rack, covering setup for various crossbar types, bike loading, securing, and maintenance.

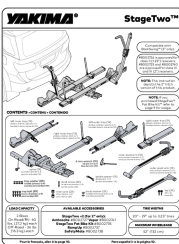

### [Yakima StageTwo Hitch Mount Bike Rack Installation and Use Guide](#)

Comprehensive guide for installing, loading, and using the Yakima StageTwo hitch mount bike rack. Includes safety checks, maintenance, and optional adjustments for optimal bike transport.