

[Manuals.plus](#) /

> [Hollister](#) /

> Hollister New Image 2-Piece Drainable Ostomy Pouch Instruction Manual (Model 18183)

## Hollister Hol-2059

# Hollister New Image 2-Piece Drainable Ostomy Pouch Instruction Manual

MODEL: 18183 | BRAND: HOLLISTER

## INTRODUCTION

---

This manual provides comprehensive instructions for the proper use and care of your Hollister New Image 2-Piece Drainable Ostomy Pouch. Designed for individuals with colostomies or ileostomies, this pouching system is engineered to prevent leakage, ensure comfort, and maintain skin health around the stoma. Please read all instructions carefully before use.





Image: Hollister New Image 2-Piece Drainable Ostomy Pouch.

## PRODUCT FEATURES

---

- **Two-Piece Pouching System:** Designed for easy detachment and reattachment of the pouch from the skin barrier.
- **Drainable Design:** Can be opened at the bottom for convenient emptying, suitable for colostomies or ileostomies.
- **Lock 'n Roll Microseal Closure:** Integrated plastic interlocking fasteners create a secure and reliable seal at the bottom of the pouch.
- **ComfortWear Pouch Panels:** Soft, beige panels on both sides enhance comfort during wear.

- **AF300 Filter:** Allows for slow release and deodorization of gas, featuring an odor-barrier film.
- **Flange Size:** 2-1/4" (57mm), designed for use with compatible New Image two-piece skin barriers with the same flange size and red color code match.
- **Latex-Free:** Not made with natural rubber latex.

## Features



- ✓ Two-piece drainable pouching system
- ✓ Designed to be used with any two-piece skin barrier with same flange size
- ✓ Lock 'n Roll™ microseal secure closure
- ✓ Integrated AF300™ filter
- ✓ Odor-barrier pouch film
- ✓ Belt tabs for easy attachment of ostomy belt
- ✓ ComfortWear™ pouch panels on both sides
- ✓ Not made with natural rubber latex
- ✓ Flange Size 2-1/4" (57mm)

Image: Key features of the Hollister New Image Ostomy Pouch, including two-piece system, Lock 'n Roll closure, AF300 filter, and ComfortWear panels.

## SETUP: APPLYING THE TWO-PIECE POUCHING SYSTEM

### 1. Gather Supplies

- New Ostomy Pouch (Model 18183)
- Compatible Skin Barrier (2-1/4" flange size, red color code match)
- Disposal Bag
- Tissue and/or soft cloth for cleaning
- Water
- Optional: Scissors, pen, stoma measuring guide, barrier rings/paste, accessories

### 2. Remove Used Pouching System

1. Carefully lift an edge of the adhesive and peel downward, gently pushing the skin away from the skin barrier.
2. Properly dispose of the used pouch and skin barrier in a disposal bag. Do not flush down the toilet.

### 3. Prepare the Skin and New Pouching System

1. Clean the skin around the stoma with water or a gentle soap as recommended by your healthcare professional. Rinse thoroughly and dry completely. **Do not use oils, powder, lotion, or lotion-type soaps on the skin, as these may interfere with adhesion.**
2. Check to ensure the skin around the stoma (peristomal skin) is intact, without irritation, rash, or redness. Consult a healthcare professional if complications are present.
3. Measure the stoma using a stoma measuring guide before every barrier application.
4. Trace the determined barrier size opening onto the skin barrier. The skin barrier should fit where the skin and stoma meet.
5. Using small curved scissors, carefully cut an opening in the skin barrier to match the pattern. Do not cut beyond the line of the release liner.
6. Verify that no skin is showing between the skin barrier and the stoma to help prevent leakage and skin irritation.
7. Remove the release liner from the skin barrier.
8. If appropriate, apply a barrier ring or a thin bead of paste around the opening, following the instructions for the specific product.



Gather pouch, skin barrier, disposal bag, tissue and/or cloth for cleaning, and water. Optional: scissors, pen, measuring guide, and/or accessories.

### Prepare the Skin Barrier and Pouch



Measure the stoma using a stoma measuring guide before every barrier application (if using a pre-sized barrier opening, go to step 7).

### Add Paste or Rings If Needed



If appropriate, apply a barrier ring or thin bead of paste around the opening following the instructions for use.



Carefully lift an edge of the adhesive and peel downward, gently pushing the skin away from the skin barrier. Properly dispose of used pouch and skin barrier. Do not flush down toilet.



Trace the determined barrier size opening onto the skin barrier. The skin barrier should fit where the skin and stoma meet. Verify that no skin is showing between the skin barrier and the stoma to help prevent leakage and skin irritation.

### Apply the New Pouching System

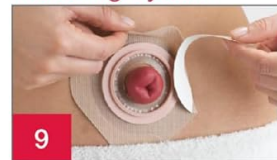

Center the skin barrier opening over the stoma in a diamond shape. For tape bordered barriers, remove the backing paper on both sides and press adhesive against the skin.



Clean the skin with water or with gentle soap as recommended by your healthcare professional. Rinse and dry thoroughly. Do not use oils, powder, lotion, or lotion-type soaps on the skin.



Using small curved scissors, carefully cut an opening in the skin barrier to match the pattern. Do not cut beyond the line on the release liner.



Check to make sure the skin around your stoma (peristomal) is intact without irritation, rash or redness.\*

\*Contact your WOC/NSWCC nurse if you notice irritation, rash or redness



Remove the release liner from the skin barrier.



Apply gentle pressure to the skin barrier for about a minute for best adhesion.



Attach the pouch to the skin barrier by engaging the lower edges of the pouch flange and the skin barrier flange. Press the two flanges together. A series of "clicks" will confirm you are doing it correctly. No more "clicks" means the pouch is secured.



If using a urostomy pouch, make sure the drain valve is closed. The teardrop on the drain valve should face the body side of the

Image: Steps for preparing the skin and measuring the stoma for ostomy pouch application.



Image: Steps for tracing, cutting, and verifying the skin barrier opening.

#### 4. Apply the New Pouching System

1. Center the skin barrier opening over the stoma in a diamond shape.
2. For tape-bordered barriers, remove the backing paper on both sides and press the adhesive against the skin.
3. Apply gentle pressure to the skin barrier for about a minute to ensure best adhesion.
4. Attach the pouch to the skin barrier by engaging the lower edges of the pouch flange and the skin barrier flange. Press the two flanges together. A series of “clicks” will confirm correct attachment. No more “clicks” means the pouch is secured.
5. If using a drainable pouch, close the Lock 'n Roll Microseal closure at the bottom of the pouch.
6. If using a urostomy pouch, ensure the drain valve is closed. The teardrop on the drain valve should face the body side of the pouch. If desired, apply the cap provided in the box.

Video: Detailed instructions on applying a two-piece ostomy pouching system, including preparation and attachment.

#### OPERATING: EMPTYING THE DRAINABLE POUCH

---

You should empty your pouch when it is one-third to one-half full of stool or gas. Regular emptying helps reduce the risk of leakage and prevents a noticeable bulge under clothing.

1. Sit on the toilet, ensuring you are comfortable. Most people find it best to position the pouch between their legs, over the toilet.
2. **For Lock 'n Roll Microseal Closure:** Hold the pouch outlet over the toilet. Lift the center of the transparent flap, lower the pouch outlet, and lightly pinch the sides to allow contents to drain.
3. **For a separate pouch clamp:** Lift the lower edge of the pouch, then open and remove the clamp. Lower the spout of the pouch over the toilet and allow the contents to drain.
4. If splatter is a problem, place a small amount of toilet tissue into the toilet bowl before emptying.
5. After emptying, clean the inside edge of the pouch tail with tissue. Ensure the outside of the pouch is also clean. Pre-moistened wipes can be convenient, especially when away from home.
6. To close the pouch:
  - **For Lock 'n Roll Microseal Closure:** Roll the pouch tail tightly three times. Fold the transparent flap down, aligning the fasteners, and seal by starting at the center and pressing out to the edges. You will feel the fasteners seal together.
  - **For a separate pouch clamp:** Fold the pouch tail over the thinner edge of the clamp and then close the clamp securely.

## How to use Lock 'n Roll™ Microseal Closure

*Before you apply your new pouch, close the pouch tail (see Figure 4 and Figure 5)*



1

### Opening

Lift from the center of the transparent flap

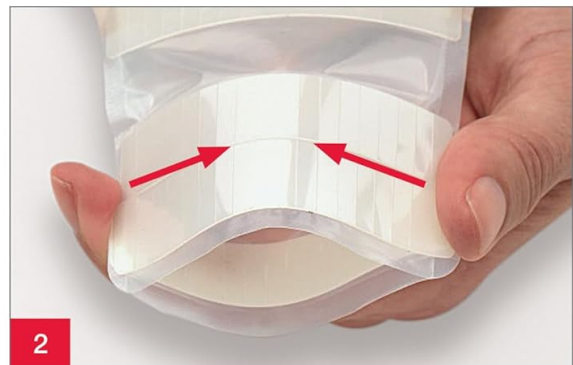

2

### Draining

Position fingers on both sides of the pouch tail, between the ribbed strips, and squeeze from the sides. Continue to hold the pouch open for cleaning



3

### Cleaning

Clean and dry the inside of the pouch tail. Wipe the outside edge of the pouch tail



4

### Closing

Roll the pouch tail up tightly three times. Fold flap down aligning the fasteners together (Figure 4)

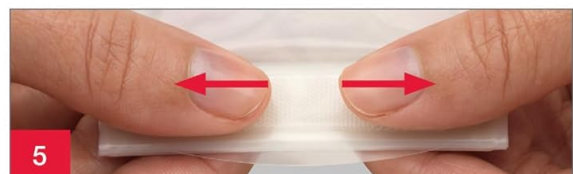

5

To close, start at the center and press. Continue pressing to the outer edges. You will feel the fasteners seal together (Figure 5)

Image: Visual guide for opening, draining, cleaning, and closing the Lock 'n Roll Microseal Closure.

Video: Instructions on how to empty a drainable ostomy pouch, demonstrating both Lock 'n Roll and separate clamp methods.

## MAINTENANCE

---

Hollister pouches are made with odor-barrier pouch film, so rinsing the inside of the pouch is generally not necessary or recommended. Introducing water into the pouch may actually decrease its wear time.

## SPECIFICATIONS

---

Specification	Detail
Item Model Number	Hol-2059
Product Dimensions	9.3 x 6.6 x 1.6 inches
Item Weight	8.47 ounces
Manufacturer	Hollister
Flange Size	2-1/4" (57mm)
Pouch Length	12"
Color Code Match	Red

## IMPORTANT WARNINGS AND NOTES

---

- **Warnings:** Reuse of a single-use product may create potential risk to the user such as poor adhesion. Reprocessing, cleaning, disinfection, and sterilization may compromise the product. This may result in odor or leakage. Ensure proper fit as instructed. If the barrier opening is incorrect or leakage occurs, skin damage may occur (e.g., irritation, broken skin, rash, or redness). This may decrease wear time.
- **Notes:** To help ensure proper adhesion, apply to clean, dry intact skin. Do not use oils or lotions. The products may interfere with adhesion of the skin barrier. Frequent removal of a FlexTend skin barrier in a short period of time (e.g., multiple times a day) may result in skin damage. Product fit is affected by many factors such as stoma construction, stoma output, skin condition, and abdominal contours. Contact a stoma care nurse or healthcare practitioner for help with the ostomy pouching system or skin irritation.
- Statements regarding dietary supplements have not been evaluated by the FDA and are not intended to diagnose, treat, cure, or prevent any disease or health condition.

## SUPPORT INFORMATION

---

For additional information or assistance, please visit the official Hollister website or contact customer support:

**Website:** [www.hollister.com](http://www.hollister.com)

**Phone:** 1.888.808.7456