

## MSR 21721

# MSR Alpine 4 Stainless Steel Camping Pot Set - Instruction Manual

Model: 21721

Brand: MSR

## PRODUCT OVERVIEW

The MSR Alpine 4 group pot set is crafted from incredibly durable stainless steel, designed to withstand even the most demanding outdoor conditions. This set is ideal for frequent travelers, guides, institutions, and families who require robust and reliable cookware for preparing multiple meals in diverse environments.

Its efficient nesting design ensures compactness, saving valuable space in your pack. The dedicated lids for each pot can also serve as plates, adding to the set's versatility. The included PanHandler pot lifter provides a secure grip, safely supporting up to 10 pounds.

## COMPONENTS





Figure 1: Exploded view of the MSR Alpine 4 Pot Set, showing the nested pots, lids, and PanHandler.

- One (1) 1-Liter Stainless Steel Pot
- One (1) 2-Liter Stainless Steel Pot
- One (1) 3-Liter Stainless Steel Pot
- Three (3) Lids/Plates (one for each pot)
- One (1) PanHandler Pot Handle
- One (1) Stuff Sack for storage

## SETUP

---

### Initial Cleaning

Before first use, wash all pots, lids, and the PanHandler with warm, soapy water. Rinse thoroughly and dry completely to remove any manufacturing residues.

### Assembling the Nested Set

The Alpine 4 Pot Set is designed for efficient nesting. Place the smallest pot inside the next largest, and so on, with the lids placed on top of their respective pots. The PanHandler and other small accessories can be stored inside the smallest pot for compact transport within the stuff sack.



Figure 2: The MSR Alpine 4 Pot Set, showing the three pots with their lids and the PanHandler.

## OPERATING INSTRUCTIONS

---

### Using the Pots for Cooking

The stainless steel pots are suitable for use on various camp stoves, open fires (with appropriate support), and racks. Ensure the pot is stable on your heat source before adding contents. The durable construction allows for boiling water, simmering meals, and other cooking tasks.



Figure 3: A person preparing a meal using the MSR Alpine Pot Set on a portable camp stove in an outdoor setting.

## Utilizing the PanHandler

The PanHandler is designed to securely grip the pots and lids, allowing for safe handling of hot cookware. To attach, align the PanHandler's jaws with the rim of the pot or lid and squeeze the handle firmly until it locks into place. To release, press the lever on the handle. Always ensure a secure grip before lifting or moving hot items.

## Lids as Plates/Frying Pans

The lids are designed to double as plates or small frying pans. When using as a frying pan, attach the PanHandler for a secure grip. Be mindful that stainless steel can heat quickly and may require oil or butter to prevent food from sticking, especially when frying.

## Official Product Video: MSR Cookware Overview

Your browser does not support the video tag.

Video Description: This video provides an overview of MSR cookware, including the features and benefits of different material types like stainless steel, aluminum, and titanium. It highlights the durability and versatility of the MSR Alpine series.

## MAINTENANCE

### Cleaning

Clean the pots and lids after each use. Stainless steel is generally easy to clean. For stubborn food residue, soak the pots in warm, soapy water. Use a non-abrasive sponge or brush. Avoid harsh chemicals or abrasive cleaners that could scratch the surface. Rinse thoroughly and dry immediately to prevent water spots and maintain shine.

### Storage

Ensure all components are completely dry before storing to prevent corrosion. Utilize the nesting design and the included stuff sack for compact and protected storage. Store in a dry place away from extreme temperatures.

## TROUBLESHOOTING

- **Food Sticking:** Stainless steel is not inherently non-stick. Use cooking oil or butter to prevent food from sticking, especially when frying or sautéing. Ensure the pan is adequately heated before adding food.
- **Discoloration:** High heat can sometimes cause stainless steel to discolor (e.g., blue or rainbow tint). This is normal and does not affect performance or safety. It can often be removed with a stainless steel cleaner or a mixture of vinegar and water.
- **Wobbly Pot on Stove:** Ensure your camp stove surface is level and stable. The pots are designed to be robust, but uneven surfaces can cause instability. If the pot base appears warped, it may be due to extreme temperature changes; ensure even heating when possible.
- **PanHandler Grip Issues:** Ensure the PanHandler is properly aligned with the pot or lid rim and fully engaged before lifting. If the grip feels loose, check for any debris or damage to the jaws.

## SPECIFICATIONS



Model Name	Stainless
Model Number	21721
Material	Stainless Steel
Color	Silver
Item Weight	2.44 Pounds (1.11 kg)
Package Weight	1.29 Kilograms
Number of Items	7 (3 pots, 3 lids, 1 PanHandler)
Occupant Capacity	3
Item Dimensions (LxWxH)	7.87 x 3.94 x 3.94 inches (nested)
Package Dimensions (LxWxH)	9.61 x 9.41 x 4.8 inches
UPC	442103157739, 400106947702, 040818217214

## WARRANTY AND SUPPORT

MSR products are built to last and come with a warranty. For specific warranty details, claims, or product support, please refer to the official MSR website or contact their customer service directly. You can visit the official MSR store for more information and products:[MSR Store on Amazon](#).

© 2024 MSR. All rights reserved.

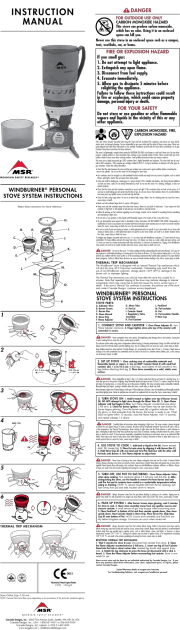
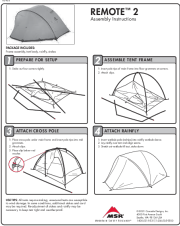

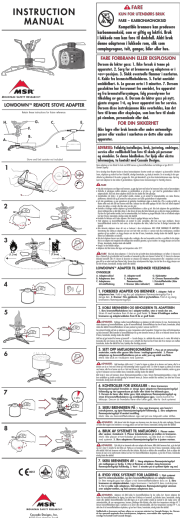
 <p><b>INSTRUCTION MANUAL</b></p> <p><b>WINDBURNER® PERSONAL STOVE SYSTEM INSTRUCTIONS</b></p> <p><b>WINDBURNER® PERSONAL STOVE SYSTEM INSTRUCTIONS</b></p>	<p><a href="#">MSR WindBurner Personal Stove System: Instruction Manual &amp; Safety Guide</a></p> <p>Detailed instruction manual and safety guide for the MSR WindBurner Personal Stove System. Learn how to safely set up, operate, maintain, and troubleshoot your MSR camping stove for outdoor adventures.</p>
 <p><b>REMOTE™ 2</b> Assembly Instructions</p> <p><b>REMOTE™ 2</b> Assembly Instructions</p>	<p><a href="#">MSR Remote 2 Tent Assembly Instructions</a></p> <p>Detailed assembly instructions for the MSR Remote 2 tent, guiding users through setup, frame assembly, cross pole attachment, and rainfly installation. Includes essential use tips for staking and weatherproofing.</p>
 <p><b>ELIXIR™ 2</b> Assembly Instructions</p> <p><b>ELIXIR™ 2</b> Assembly Instructions</p>	<p><a href="#">MSR Elixir 2 Tent Assembly Instructions</a></p> <p>Step-by-step guide for assembling the MSR Elixir 2 tent, covering preparation, pole assembly, ridge pole attachment, and rainfly installation. Includes package contents and use tips.</p>
 <p><b>INSTRUCTION MANUAL</b></p> <p><b>LOWDOWN® REMOTE STOVE ADAPTER</b></p> <p><b>LOWDOWN® REMOTE STOVE ADAPTER</b></p>	<p><a href="#">MSR LowDown Remote Stove Adapter Instruction Manual</a></p> <p>Comprehensive instructions for safely setting up, using, and storing the MSR LowDown Remote Stove Adapter for outdoor camping and cooking. Includes safety warnings and step-by-step guidance.</p>



### [MSR160 Data Logger Quick Start Guide and Software Installation](#)

Learn how to quickly set up and use the MSR160 data logger, including MSR PC software installation, connecting to a PC, starting data recording, and transferring data, with optional SD card usage.

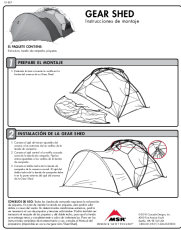

### [MSR Gear Shed Assembly Instructions](#)

Step-by-step guide for assembling the MSR Gear Shed tent accessory, including package contents, setup instructions, and usage tips.