

Phoenix GC609

Phoenix Safe KS0001C Key Safe User Manual

Model: KS0001C

INTRODUCTION

This user manual provides comprehensive instructions for the installation, operation, and maintenance of your Phoenix Safe KS0001C Key Safe. Designed for secure key storage, this high-strength cast alloy key holder features a 4-digit combination lock and is suitable for wall mounting in various environments. Please read this manual thoroughly before using your key safe to ensure proper function and security.

PRODUCT OVERVIEW

The Phoenix Safe KS0001C is a compact and robust key safe designed to provide secure access to keys. Its durable construction and user-friendly combination lock make it an ideal solution for homes, offices, or outdoor use.

- **Secure Storage:** Equipped with a 4-digit dial combination lock for enhanced security.
- **Durable Construction:** Made from high-strength cast alloy with a scratch-resistant black finish.
- **Wall Mounted:** Designed for easy wall installation, with included fixings.
- **Internal Magnetic Hook:** Features a magnetic key hook for convenient key placement and retrieval.
- **Compact Design:** Outer dimensions of 100 x 65 x 35mm, weighing 0.4kg.



Image: Front view of the Phoenix Safe KS0001C Key Safe, showing the four-digit combination dials.



Image: A hand interacting with the Phoenix Safe KS0001C Key Safe, which is mounted on a textured wall next to a door lock.

SETUP AND INSTALLATION

The KS0001C Key Safe is designed for easy wall mounting. Ensure you choose a discreet and secure location for installation.

Package Contents:

- Phoenix Safe KS0001C Key Safe
- Wall fixings (bolts)

Installation Steps:

1. **Choose Location:** Select a suitable wall surface for mounting. Consider both security and accessibility.
2. **Mark Drilling Points:** Open the key safe and use the pre-drilled holes on the back panel as a template to mark the drilling points on the wall.
3. **Drill Holes:** Drill holes at the marked points using an appropriate drill bit for your wall type.
4. **Insert Wall Plugs (if necessary):** For masonry walls, insert wall plugs into the drilled holes.
5. **Mount Key Safe:** Align the key safe with the drilled holes and secure it to the wall using the supplied bolts. Ensure it is firmly attached.



Image: The Phoenix Safe KS0001C Key Safe mounted on a brick wall, shown open to reveal the internal structure and mounting points.



Image: A key being inserted into the magnetic key hook inside the Phoenix Safe KS0001C Key Safe, which is mounted on a brick wall.

OPERATING INSTRUCTIONS

Setting the Combination:

The key safe comes with a factory preset combination (usually 0000). You can easily change this to your preferred 4-digit code.

1. **Open the Safe:** Enter the current combination (factory preset or your last set code) and pull down the front cover to open the safe.
2. **Locate Reset Lever:** Inside the safe, usually on the back of the door or near the combination mechanism, locate the reset lever or switch.
3. **Move Reset Lever:** Move the reset lever to the "SET" or "RESET" position (often a small switch or screw that needs to be turned 90 degrees).
4. **Set New Combination:** While the lever is in the reset position, rotate the dials to your desired 4-digit combination. Choose a memorable but secure code.
5. **Return Reset Lever:** Move the reset lever back to its original "LOCK" or "NORMAL" position.
6. **Test New Combination:** Close the safe, scramble the dials, and then enter your new combination to ensure it opens correctly. Do this several times before fully relying on the new code.

Accessing and Storing Keys:

1. **Open Safe:** Enter your 4-digit combination and pull down the front cover.
2. **Store/Retrieve Keys:** Place or remove keys from the internal magnetic hook. The magnetic feature helps keep keys securely in place and prevents them from falling out when the safe is opened.
3. **Close Safe:** Push the front cover back up until it clicks securely into place.
4. **Scramble Dials:** Always scramble the combination dials after closing the safe to prevent unauthorized access.



Video: Official product video demonstrating the use and features of the Phoenix Safe KS0001C Key Safe, including opening, closing, and key storage.

MAINTENANCE

To ensure the longevity and optimal performance of your Phoenix Safe KS0001C Key Safe, follow these simple maintenance guidelines:

- **Cleaning:** Wipe the exterior with a soft, damp cloth to remove dust and grime. Avoid abrasive cleaners or solvents that could damage the scratch-resistant finish.
- **Combination Dials:** Periodically rotate the combination dials to ensure they move freely. If they become stiff, a small amount of silicone-based lubricant can be applied, but avoid oil-based lubricants.
- **Environmental Exposure:** While the high-strength cast alloy is resistant to harsh weather, prolonged exposure to extreme conditions (e.g., direct rain, freezing temperatures) may affect the combination mechanism over time. Consider a sheltered location for outdoor installation.
- **Check Mounting:** Regularly check that the key safe remains securely mounted to the wall. Tighten any loose bolts if necessary.

TROUBLESHOOTING

Problem	Possible Cause	Solution
Key safe will not open.	Incorrect combination entered. Dials not aligned correctly.	Ensure each number on the dial is precisely aligned with the indicator mark. Double-check your combination. If you forgot the combination, there is no master key or override; you will need to try combinations or contact support.

Problem	Possible Cause	Solution
Dials are stiff or hard to turn.	Accumulation of dirt or debris. Lack of lubrication.	Clean the dials with a soft cloth. Apply a small amount of silicone-based lubricant to the moving parts of the dials.
Key safe does not close securely.	Keys obstructing the closing mechanism. Debris in the latch.	Ensure keys are fully seated on the magnetic hook and not protruding. Check for any obstructions in the latch area and clear them.
Combination reset lever is stuck.	Mechanism is dirty or jammed.	Gently try to move the lever. Do not force it. If it remains stuck, contact customer support.

SPECIFICATIONS

Feature	Detail
Model Number	KS0001C (GC609)
Brand	Phoenix Safe Company
Lock Type	4-Digit Mechanical Combination Lock
Material	High Strength Cast Alloy
Colour	Black
Outer Dimensions (H x W x D)	100 x 65 x 35 mm
Item Weight	0.4 kg
Installation Method	Wall Mount (Surface Mount)
Included Components	Key Box, Wall Fixings

WARRANTY AND SUPPORT

Phoenix Safe Company is a UK-based manufacturer with a long history of producing high-quality security products. For any questions, technical assistance, or warranty claims regarding your KS0001C Key Safe, please contact Phoenix Safe Company directly.

Refer to the product packaging or the official Phoenix Safe Company website for the most up-to-date contact information and warranty details.

Website: www.phoenixsafe.co.uk

Related Documents - GC609



[Phoenix DS2500E Series Electronic Lock Operating Instructions](#)

Comprehensive operating instructions for the Phoenix DS2500E Series electronic lock, covering setup, code management, dual control, alarm features, and battery replacement.

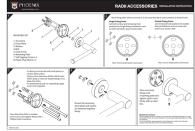

[Phoenix Radii Accessories Installation Instructions - Model IN0142](#)

Step-by-step installation guide for Phoenix Radii bathroom accessories, including mounting kit details, fixing methods for various wall types, and maintenance tips. Model IN0142.



[Phoenix Solution LGR Performance Amplifier Owner's Manual & Installation Guide](#)

Owner's manual, installation, operation, and service instructions for the Therma-Stor Phoenix Solution LGR Performance Amplifier (PN 4026600). Learn about its specifications, setup, maintenance, and warranty.



[Phoenix 250 MAX LGR Dehumidifier Owner's Manual and Service Instructions](#)

Comprehensive owner's manual for the Phoenix 250 MAX LGR dehumidifier by Therma-Stor. Covers installation, operation, maintenance, troubleshooting, specifications, and warranty for this high-capacity restoration equipment.



[Phoenix Solution LGR Performance Amplifier Owner's Manual](#)

Owner's manual for the Therma-Stor Phoenix Solution LGR Performance Amplifier, covering installation, operation, service, specifications, troubleshooting, and warranty information.



[Phoenix 200 HT LGR Dehumidifier Owner's Manual: Installation, Operation, and Service](#)

Comprehensive owner's manual for the Phoenix 200 HT LGR Dehumidifier, detailing installation, operation, maintenance, troubleshooting, and service instructions. Learn about its LGR technology, high-ambient performance, and specifications.