

[Manuals.plus](#) /

> [GROHE](#) /

> GROHE Friedrich Euromix Faucet Lever 46026000 Instruction Manual

GROHE 46026000

GROHE Friedrich Euromix Faucet Lever 46026000 Instruction Manual

Model: 46026000 | Brand: GROHE

1. INTRODUCTION

This instruction manual provides essential information for the safe and correct installation, operation, and maintenance of your GROHE Friedrich Euromix Faucet Lever, model 46026000. Please read this manual thoroughly before beginning any procedures and retain it for future reference. This product is designed as a control element for plumbing faucets.

2. PRODUCT OVERVIEW

The GROHE Friedrich Euromix Faucet Lever 46026000 is a replacement control element for compatible GROHE bathroom faucets. It is constructed from alloy steel with a chrome finish, ensuring durability and a sleek appearance. The lever allows for precise control over water flow and temperature.



Figure 1: Exploded view diagram showing the faucet lever and associated rings/components.



Figure 2: Detailed diagram of the GROHE Friedrich Euromix Faucet Lever.

3. SAFETY INFORMATION

- Always turn off the main water supply to the faucet before attempting any installation or maintenance.
- Ensure all connections are secure to prevent leaks.
- If you are unsure about any step, consult a qualified plumber.

- Use appropriate tools and wear protective eyewear if necessary.

4. INSTALLATION (SETUP)

This section outlines the general steps for replacing a faucet lever. Specific faucet models may vary, so refer to your faucet's original manual if available.

1. **Turn off Water Supply:** Locate the shut-off valves for your faucet (usually under the sink) and turn them clockwise until the water flow stops completely. Open the faucet to relieve any remaining pressure.
2. **Remove Old Lever:** Depending on your faucet design, the old lever may be secured by a set screw (often hidden under a decorative cap) or simply pull off. Use an Allen key or screwdriver as needed. Carefully remove any retaining rings or washers.
3. **Clean Faucet Base:** Clean any mineral deposits or debris from the faucet body where the new lever will be installed.
4. **Install New Lever:** Place the new GROHE Friedrich Euromix Faucet Lever onto the faucet stem. Ensure it is correctly oriented for proper hot/cold operation.
5. **Secure Lever:** Re-attach any retaining rings or washers. Secure the lever with the set screw, if applicable. Do not overtighten.
6. **Restore Water Supply:** Slowly turn the water shut-off valves counter-clockwise to restore water flow. Check for any leaks around the lever base.

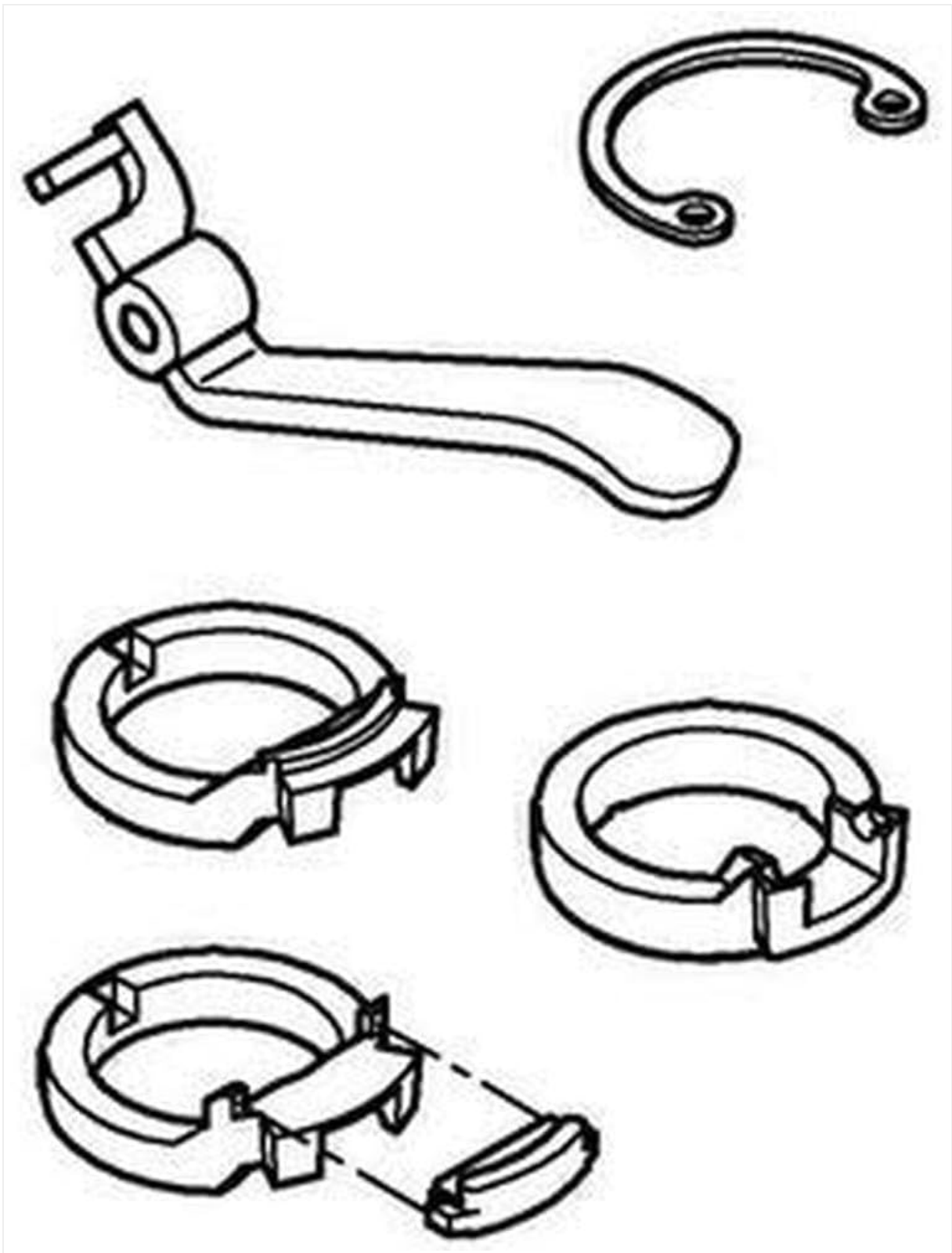

Figure 3: Diagram illustrating various components involved in faucet lever installation.

5. OPERATION

The GROHE Friedrich Euromix Faucet Lever provides intuitive control:

- **Water Flow:** Lift the lever upwards to increase water flow. Push it downwards to decrease or stop the flow.
- **Temperature Control:** Move the lever to the left for hot water and to the right for cold water. The precise temperature can be adjusted by finding the desired position between hot and cold.

6. MAINTENANCE

To ensure the longevity and appearance of your GROHE faucet lever, follow these maintenance guidelines:

- **Cleaning:** Clean the lever regularly with a soft cloth and mild soap. Avoid abrasive cleaners, scouring pads, or harsh chemicals, as these can damage the chrome finish.
- **Inspection:** Periodically check the lever for any signs of looseness or wear. Tighten any loose screws gently.
- **Hard Water:** In areas with hard water, mineral deposits may accumulate. Use a vinegar-based solution or a specialized descaler designed for chrome finishes, applied with a soft cloth, then rinse thoroughly.

7. TROUBLESHOOTING

Problem	Possible Cause	Solution
Lever is loose	Set screw is loose or missing.	Tighten or replace the set screw.
Water drips from lever base	Internal cartridge issue or worn O-rings.	This lever is a component; the issue might be with the faucet's internal cartridge. Consult a plumber or the faucet's specific manual for cartridge replacement.
Lever is stiff to operate	Mineral buildup or internal friction.	Clean around the lever base. If the stiffness persists, the issue may be with the faucet's internal cartridge, requiring professional attention.

8. SPECIFICATIONS

- **Model Number:** 46026000
- **Brand:** GROHE
- **Dimensions (L x W x H):** 7.59 x 7.49 x 5.08 cm
- **Weight:** 80 grams
- **Color:** Metallic Silver
- **Style:** Knob (referring to the overall design aesthetic)
- **Finish:** Chrome
- **Material:** Alloy Steel
- **Quantity of Items:** 1
- **Usage:** Plumbing faucet control element

9. WARRANTY AND SUPPORT

For warranty information or technical support regarding your GROHE Friedrich Euromix Faucet Lever 46026000, please refer to the official GROHE website or contact GROHE customer service directly. Keep your purchase receipt as proof of purchase.

Contact Information: Please visit the official GROHE website for the most up-to-date contact details for your region.

