

Lifetime 1270

Lifetime Portable Adjustable Outdoor Basketball Hoop
(Model 1270)

User Manual

[Introduction](#) [Safety](#) [Components](#) [Assembly](#) [Operation](#) [Maintenance](#) [Troubleshooting](#) [Specifications](#) [Warranty](#)

1. INTRODUCTION

This manual provides essential instructions for the safe assembly, operation, and maintenance of your Lifetime Portable Adjustable Outdoor Basketball Hoop, Model 1270. Please read this manual thoroughly before installation and use to ensure proper function and longevity of your product. Keep this manual for future reference.



Image 1.1: Lifetime Portable Adjustable Outdoor Basketball Hoop, 42 Inch Fusion Backboard.

2. SAFETY INFORMATION

WARNING: This product may contain chemicals known to the State of California to cause cancer and birth defects or other reproductive harm. For more information, visit www.P65Warnings.ca.gov.

- Always ensure the base is filled with sand or water to prevent tipping.
- Do not hang on the rim or backboard.
- Supervise children during use.
- Regularly inspect all components for wear or damage. Replace damaged parts immediately.
- Keep hands and fingers clear of moving parts during height adjustment.

3. PRODUCT COMPONENTS

The Lifetime Portable Adjustable Outdoor Basketball Hoop system includes the following main components:

- 42-inch Shatterproof Fusion Backboard
- Classic Rim with All-Weather Net
- Telescoping Steel Pole (2.75-inch round)
- 27-Gallon Heavy-Duty Portable Base with Wheels

For a complete list of all parts and hardware, please refer to the detailed installation manual available as a PDF document: [Installation Manual \(PDF\)](#).

4. SETUP AND ASSEMBLY

Assembly of the Lifetime Portable Adjustable Outdoor Basketball Hoop requires careful attention to detail. It is recommended to have at least two adults for assembly. Follow the steps below and consult the official PDF installation manual for detailed diagrams and instructions.

4.1. Unpacking and Preparation

- Unpack all components and verify against the parts list in the PDF manual.
- Ensure you have all necessary tools (e.g., wrenches, screwdrivers).

4.2. Pole Assembly

Assemble the steel pole sections according to the instructions in the manual, ensuring all connections are secure.

4.3. Backboard and Rim Attachment

Attach the 42-inch Fusion Backboard and Classic Rim to the assembled pole. Ensure the net is properly secured to the rim.

4.4. Base Filling

The 27-gallon portable base must be filled with sand or water to provide stability. Sand offers greater stability and is recommended for windy conditions. Do not use the system until the base is fully weighted.

CLASSIC RIM



**Regulation
Rim**



Solid Steel



Product graphics may
be different than shown

Image 4.1: The 27-gallon heavy-duty portable base should be filled with sand or water for stability.

5. OPERATING INSTRUCTIONS

5.1. Height Adjustment

The telescoping height adjustment mechanism allows you to adjust the rim height from 7.5 feet to 10 feet in 6-inch increments. Follow these steps:

1. **Untwist Adjustment Knob:** Locate the adjustment knob on the pole and untwist it to loosen the mechanism.

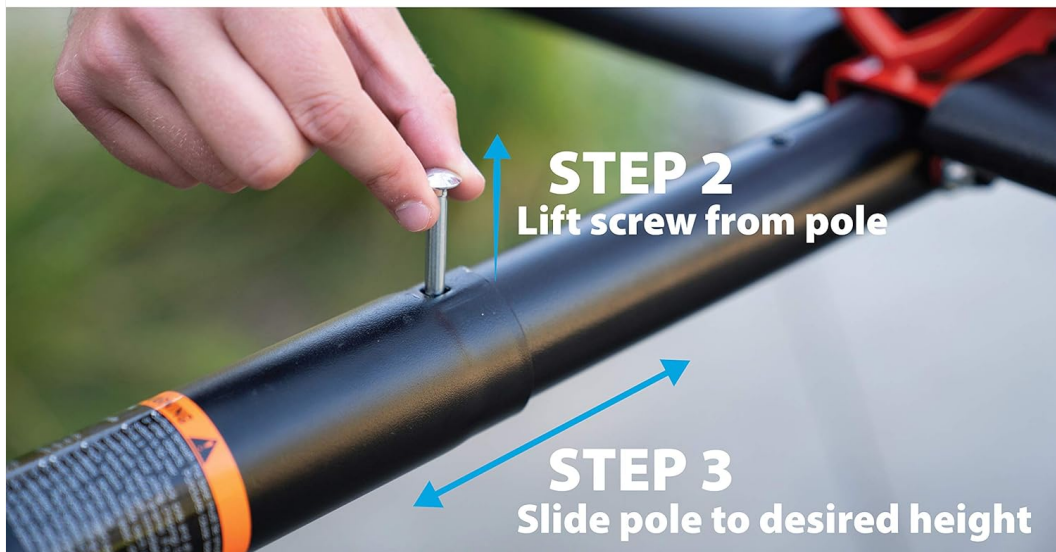
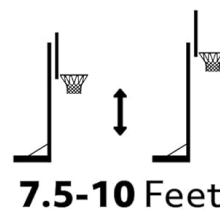

Image 5.1: Untwist the adjustment knob to prepare for height change.

2. **Lift Screw from Pole:** Carefully lift the screw or pin from its current position in the pole.
3. **Slide Pole to Desired Height:** Slide the upper pole section up or down to the desired height increment. Reinsert the screw/pin into the corresponding hole and tighten the adjustment knob securely.

TELESCOPING ADJUST



Adjusts in
Minutes



Image 5.2: Lift the screw and slide the pole to adjust height, then secure.

PRO COURT™ **PORTABLE BASE**

Fills with
27 Gallons
of sand
or water



Rolls Easily
to desired
location



Image 5.3: The telescoping adjustment allows for quick height changes between 7.5 and 10 feet.

5.2. Portability

The heavy-duty portable base is equipped with wheels, allowing for easy relocation of the basketball system. Ensure the base is fully weighted before moving. Tilt the system onto its wheels and roll it to the desired location. Exercise caution when moving the system.

6. MAINTENANCE

- **Cleaning:** Clean the backboard and pole with mild soap and water. Avoid abrasive cleaners that could damage the surfaces.
- **Base Check:** Periodically check the base to ensure it remains adequately filled with sand or water. Refill as necessary to maintain stability.
- **Hardware Inspection:** Regularly inspect all bolts, nuts, and connections for tightness. Tighten any loose hardware to ensure structural integrity.
- **Net Replacement:** The all-weather net is designed for durability, but may require replacement over time due to wear.
- **Rust Prevention:** The pole is rust-resistant, but regular cleaning and inspection can help prevent corrosion, especially in harsh weather conditions.

7. TROUBLESHOOTING

7.1. System Instability

- **Issue:** The basketball system feels wobbly or unstable.

- **Solution:** Ensure the 27-gallon base is completely filled with sand or water. Check all pole connections and hardware for tightness.

7.2. Difficulty Adjusting Height

- **Issue:** The pole is difficult to slide during height adjustment.
- **Solution:** Ensure the adjustment knob is fully untwisted and the locking pin/screw is completely disengaged. Clean any debris from the telescoping sections.





8. SPECIFICATIONS

Feature	Detail
Brand	Lifetime
Model Name	Lifetime Portable Adjustable Outdoor Basketball Hoop, 42 Inch Fusion Backboard
Model Number	1270
Backboard Material	Fusion (Polycarbonate and High-Density Polyethylene)
Backboard Size	42 Inches
Rim Type	Classic, Heavy-Duty Steel
Rim Size	18 Inches
Height Adjustment	Telescoping, 7.5 to 10 feet in 6-inch increments
Pole Material	Steel (2.75-inch round), Rust-resistant
Base Capacity	27 Gallons (sand or water)
Portability	Heavy-duty portable base with wheels
Product Dimensions (LxWxH)	30 x 42 x 12 inches (Item) / 69"D x 42"W x 146"H (Overall)
Item Weight	50 Pounds
Indoor/Outdoor Usage	Outdoor
Special Features	Adjustable Height, Fade Resistant, Portable, Rust Resistant, Shatterproof
Assembly Required	Yes

9. WARRANTY AND SUPPORT

This Lifetime Portable Adjustable Outdoor Basketball Hoop is covered by a **5-Year Limited Manufacturer Warranty**. This warranty covers defects in materials and workmanship under normal use and service. Please retain your proof of purchase for warranty claims.

For warranty service, technical support, or to order replacement parts, please contact Lifetime customer service directly. You can find more information and contact details on the official Lifetime website or through their Amazon store page: [Visit the Lifetime Store on Amazon](#).

	<p>Lifetime 73729 Backboard & Rim Basketball System Assembly Instructions</p> <p>Comprehensive assembly guide for the Lifetime 73729 Backboard & Rim Basketball System, covering setup, mounting, maintenance, and warranty details. Includes parts lists and safety information.</p>
	<p>Lifetime Model 71525 Owner's Manual and Assembly Guide</p> <p>This owner's manual provides comprehensive instructions for assembling, operating, and maintaining the Lifetime Model 71525 basketball system. Includes parts lists, safety warnings, and warranty information.</p>
	<p>Lifetime Model 71281 Owner's Manual: Assembly, Operation, and Care</p> <p>This owner's manual provides essential information for the Lifetime Model 71281 basketball system, including detailed assembly steps, safety precautions, parts identification, operational guidance, and maintenance advice from Lifetime Products, Inc.</p>
	<p>Lifetime Streamline Basketball System Assembly Instructions - Model 90588</p> <p>Comprehensive assembly guide for the Lifetime Streamline Basketball System (Model 90588). This document provides step-by-step instructions, required tools, parts identification, safety warnings, maintenance tips, and warranty information.</p>
	<p>Lifetime Speed Shift 51550 Basketball System Assembly Instructions</p> <p>Detailed assembly instructions for the Lifetime Speed Shift 51550 Basketball System. Learn how to assemble your basketball hoop with step-by-step guidance and required tools.</p>
	<p>Lifetime Horizontal Storage Shed Assembly Instructions</p> <p>Step-by-step assembly manual for the Lifetime Horizontal Storage Shed (Model 60170). Includes parts identification, required tools, safety warnings, and support contact information.</p>