

Hama 10.260

Hama Beads 10.260 Egg Shaped Pegboard Instruction Manual

Model: 10.260 | Brand: Hama

1. PRODUCT OVERVIEW

The Hama 10.260 Egg Shaped Pegboard is a creative tool designed for use with Hama beads. This pegboard allows users to create unique egg-shaped designs by placing individual Hama beads onto its pegs. Once the design is complete, the beads can be fused together using an iron and ironing paper (not included) to create a permanent art piece.

Included Components

- 1 x Hama Egg Shaped Pegboard (Model 10.260)

Note: Hama beads, ironing paper, and iron are sold separately and are required for full functionality.

2. SETUP

Before beginning your Hama bead project, ensure you have a clean, flat, and stable surface to work on. Gather your Hama beads, ironing paper, and a household iron (adult supervision required for ironing).



Image 2.1: The Hama Egg Shaped Pegboard. This clear plastic pegboard features an array of small pegs arranged in an oval, egg-like shape, ready for bead placement.

Place the Hama Egg Shaped Pegboard on your chosen work surface. Ensure it is stable and will not move during bead placement.

3. OPERATING INSTRUCTIONS

Follow these steps to create your Hama bead designs:

1. **Design Creation:** Carefully place individual Hama beads onto the pegs of the egg-shaped board according to your desired pattern. You can follow pre-made designs or create your own unique artwork.
2. **Ironing Preparation:** Once your design is complete, place a sheet of Hama ironing paper (or parchment paper) over the entire bead design on the pegboard.
3. **Fusing the Beads (Adult Supervision Required):**
 - Set a household iron to a medium heat setting (no steam).
 - Gently iron over the ironing paper in a circular motion for approximately 10-20 seconds, or until

the beads are fused together. The heat will melt the tops of the beads, connecting them.

- Allow the design to cool slightly.

4. **Removing the Design:** Carefully remove the ironing paper. Once cooled, gently lift the fused bead design from the pegboard. If the beads are not fully fused, place the ironing paper back and iron for a few more seconds.
5. **Finishing:** For a stronger design, you may turn the design over, place ironing paper on the reverse side, and iron again. This fuses both sides of the beads.

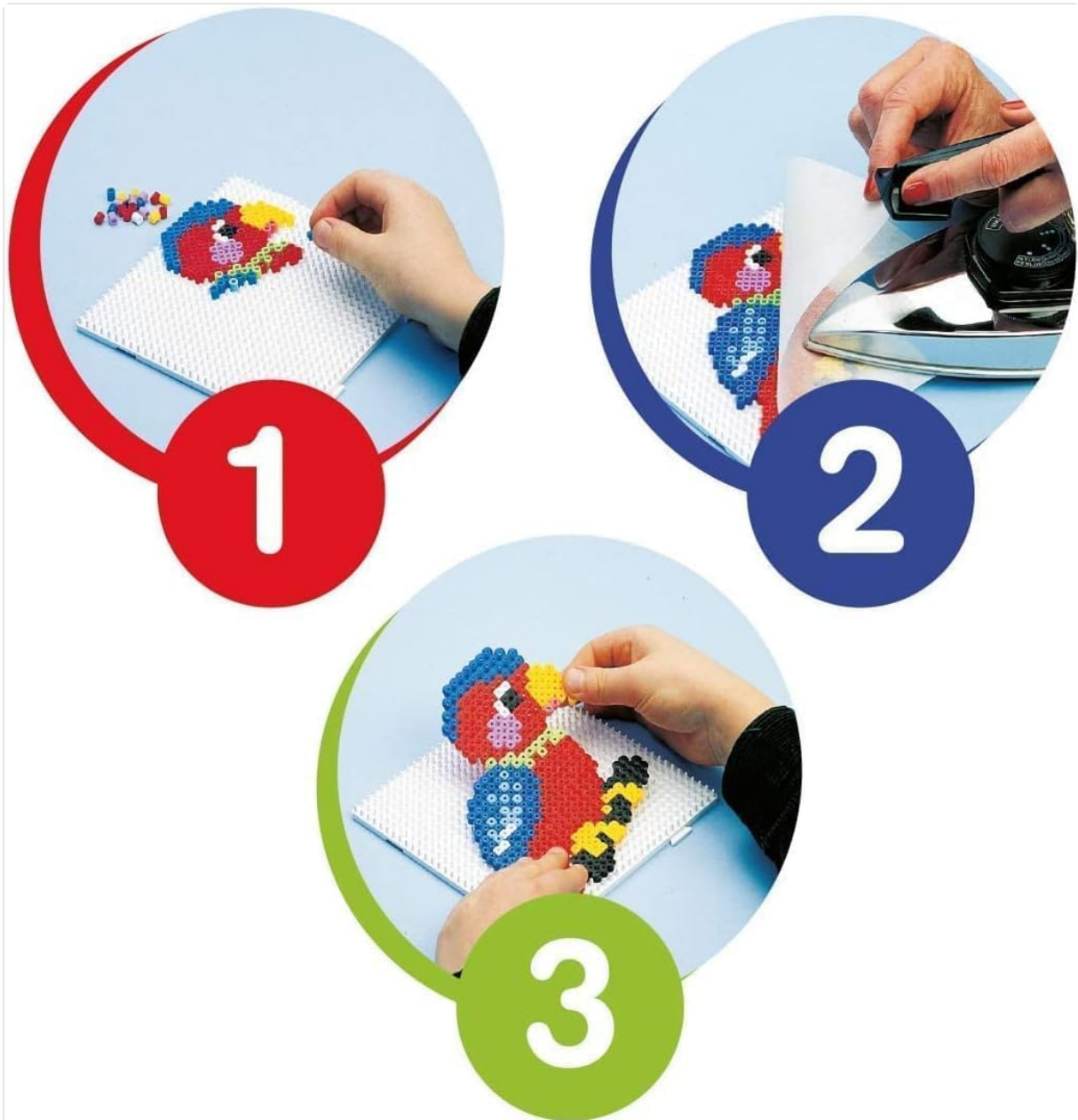

Image 3.1: Step-by-step guide for Hama bead creation. This image illustrates three stages: 1) placing colorful beads onto a pegboard to form a parrot design, 2) an adult ironing over the design with ironing paper, and 3) carefully removing the finished, fused bead design from the pegboard.



Image 3.2: A family engaged in Hama bead crafting. Two adults and two children are seated around a table, each working on their own colorful bead designs on various pegboards, demonstrating the product in use for creative activities.



Image 3.3: Two children focused on creating Hama bead designs. A girl is carefully placing beads on a pegboard, while a boy works on another design, showcasing the product's appeal for young crafters.

4. CARE AND MAINTENANCE

Proper care ensures the longevity of your Hama Egg Shaped Pegboard:

- **Cleaning:** To clean the pegboard, wipe it gently with a damp cloth. Avoid abrasive cleaners or harsh chemicals, as these can damage the plastic.

- **Storage:** Store the pegboard in a flat, dry place away from direct sunlight and extreme temperatures. This prevents warping and damage to the pegs.
- **Heat Exposure:** Do not expose the pegboard directly to the iron's heat without ironing paper, as this will melt and damage the pegs.

5. TROUBLESHOOTING

- **Beads not fusing properly:**

Ensure the iron is set to a medium heat (no steam) and that you are applying even pressure. Iron for a slightly longer duration (e.g., 20-30 seconds) if beads are not melting sufficiently. Make sure the ironing paper is correctly positioned over the beads.
- **Pegboard warping:**

Warping can occur if the pegboard is exposed to excessive heat or stored improperly. Always use ironing paper between the iron and the beads. Store the pegboard flat and away from heat sources. If minor warping occurs, sometimes placing a heavy, flat object on it while it cools can help.
- **Beads sticking to ironing paper:**

This can happen if the beads are over-ironed or if the ironing paper is not suitable. Use genuine Hama ironing paper or high-quality parchment paper. Allow the design to cool slightly before attempting to remove the paper.

6. SPECIFICATIONS





Feature	Detail
Brand	Hama
Model Number	10.260
Material	Plastic
Shape	Oval (Egg Shaped)
Size	One Size
Product Dimensions	5.91 x 5.12 x 0.47 inches (15 x 13 x 1.2 cm)
Item Weight	0.32 ounces (approximately 9 grams)
Manufacturer Recommended Age	5 years and up
Number of Pieces	1 (Pegboard only)
UPC	028178260064

7. WARRANTY AND SUPPORT

This product is a simple crafting accessory and typically does not come with an extended manufacturer's warranty. For any product-related inquiries, support, or to explore other Hama products, please visit the official Hama brand store or contact their customer service.

Official Hama Store: [Hama Store on Amazon](#)

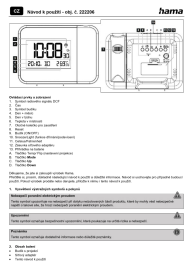
Related Documents - 10.260

	<p>PEGPRO 800 Modular Pegboard Kit: Warnings and Safety Instructions</p> <p>Comprehensive safety warnings and instructions for the Hama PEGPRO 800 Modular Pegboard Kit, covering installation, usage, and warranty information. Ensure safe mounting and operation.</p>
	<p>Hama FIT move Smartwatch App Guide</p> <p>Comprehensive guide to setting up and using the Hama FIT move app with your Hama smartwatch, covering features like activity tracking, health monitoring, device settings, and user preferences.</p>
	<p>Hama Hvar Digitální Budík s Projekcí - Návod k Použití</p> <p>Kompletní návod k použití pro digitální budík Hama Hvar s projekcí času. Obsahuje informace o nastavení, funkcích, bezpečnosti, údržbě a technických údajích.</p>
	<p>Hama Smartwatch 8900: Operating Instructions and Features</p> <p>Explore the Hama Smartwatch 8900 with this comprehensive operating manual. Learn about setup, features, app integration, and maintenance for your Hama fitness tracker.</p>
	<p>Hama Home X12CD Shredder: Operating Instructions and Safety Guide</p> <p>Comprehensive operating instructions and safety guide for the Hama Home X12CD shredder, covering setup, operation, maintenance, troubleshooting, and technical specifications.</p>
	<p>Hama SAMOS Alarm Clock - User Manual and Instructions</p> <p>Get detailed operating instructions, safety guidelines, technical data, and setup information for the Hama SAMOS alarm clock (model 00222204). Learn how to set the time, alarms, use the snooze function, and more.</p>

