

Manuals+

[Q & A](#) | [Deep Search](#) | [Upload](#)

[manuals.plus](#) /

- › [ABUS](#) /
- › [ABUS 165/40 Combination Padlock User Manual](#)

ABUS 165/40

ABUS 165/40 Combination Padlock User Manual

Model: 165/40 (32163)

INTRODUCTION

This manual provides comprehensive instructions for the setup, operation, and maintenance of your ABUS 165/40 Combination Padlock. Designed for low to medium security applications, this padlock features a resettable combination, a solid brass body, and a steel shackle, making it suitable for various uses such as luggage, sports equipment, and lockers.

PRODUCT OVERVIEW



Front view of the ABUS 165/40 Combination Padlock, showing the brass body, steel shackle, and four-digit combination dials.

The ABUS 165/40 is a robust combination padlock featuring a 4-digit resettable combination. Its construction includes a solid brass body for durability and a hardened steel shackle for enhanced security. The combination dials are designed for clear readability and smooth operation.

Key Features:

- 4-digit resettable combination for personalized security.
- Solid brass body for corrosion resistance and durability.
- Hardened steel shackle for cut resistance.
- Suitable for various indoor and outdoor applications.

SETUP: SETTING YOUR COMBINATION

Your ABUS 165/40 Combination Padlock comes with a factory-set combination, usually 0-0-0-0. Follow these steps to set your personal combination:

1. Open the padlock by entering the current combination (factory default is 0-0-0-0) and pulling up the shackle.
2. Rotate the shackle 180 degrees from its open position.
3. Press the shackle down firmly into the lock body.
4. While holding the shackle down, set your desired 4-digit combination by rotating the dials. Ensure the numbers align precisely with the indicator line.
5. Release the shackle.
6. Rotate the shackle back 180 degrees to its original open position.
7. Close the padlock by scrambling the dials and pushing the shackle down.

Important: Remember your new combination. There is no master key or override function to reset a forgotten combination.

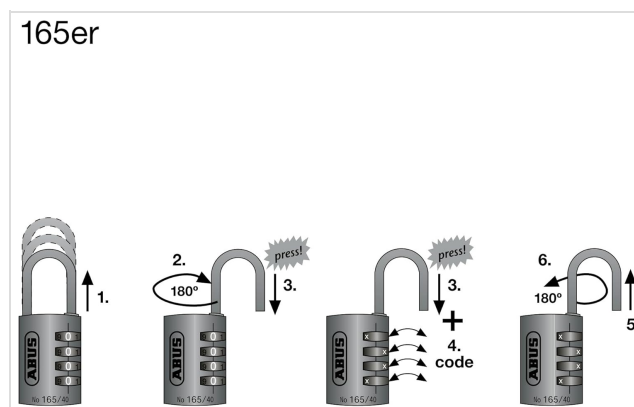

Visual guide for setting the combination: 1. Open shackle. 2. Rotate 180°. 3. Press down. 4. Set code. 5. Release. 6. Rotate back 180°.

OPERATING THE PADLOCK

To Open:

1. Align your personal 4-digit combination with the indicator line on the padlock body.
2. Pull the shackle upwards to open the padlock.

To Close:

1. Push the shackle down into the lock body until it clicks securely.
2. Scramble the combination dials to lock the padlock and conceal your code.

MAINTENANCE

To ensure the longevity and smooth operation of your ABUS 165/40 padlock, follow these simple maintenance guidelines:

- **Cleaning:** Wipe the padlock body and shackle with a soft, dry cloth periodically to remove dirt and grime.
- **Lubrication:** For outdoor use or in dusty environments, apply a small amount of non-greasy lubricant (e.g., graphite powder or silicone spray) to the shackle mechanism and combination dials once or twice a year. Avoid oil-based lubricants as they can attract dust.
- **Storage:** Store the padlock in a dry environment when not in use to prevent corrosion.

TROUBLESHOOTING

Padlock Will Not Open:

- **Incorrect Combination:** Double-check that you have entered the correct 4-digit combination. Ensure each number is precisely aligned with the indicator line.
- **Dials Stuck:** If the dials are stiff, try wiggling them gently or applying a small amount of lubricant (see Maintenance section).
- **Forgotten Combination:** If you have forgotten your combination, there is no way to reset it without knowing the current code. The padlock will need to be replaced.

Shackle Is Stiff:

- **Dirt or Debris:** Clean the shackle and the shackle holes in the lock body.
- **Lack of Lubrication:** Apply a suitable lubricant as described in the Maintenance section.

SPECIFICATIONS

| | |
|-------------------|---------------------------|
| Brand | ABUS |
| Model Name | 165/40 |
| Item Model Number | 32163 |
| Lock Type | Combination Lock |
| Combination | 4-digit, Resettable |
| Material | Brass Body, Steel Shackle |
| Overall Width | 40 mm (1.57 inches) |

| | |
|-------------------------|--|
| Overall Height | 81 mm (3.19 inches) |
| Overall Depth | 18 mm (0.71 inches) |
| Item Weight | 0.2 kg (7 ounces) |
| Color | Silver/Gold (Brass body, Steel shackle) |
| Recommended Uses | Indoor, Outdoor, Luggage, Sports Equipment |

WARRANTY AND SUPPORT

For information regarding the warranty of your ABUS 165/40 Combination Padlock, please refer to the documentation provided at the time of purchase or visit the official ABUS website. Warranty terms and conditions may vary by region and retailer.

For technical support, product inquiries, or to find authorized service centers, please visit the official ABUS website or contact their customer service department directly.

Official ABUS Website: www.abus.com