

## Alarm Lock DL2700WP26D

# Alarm Lock Trilogy T2 Electronic Digital Keypad Cylindrical Lock Leverset

Model: DL2700WP26D

Brand: Alarm Lock

### 1. PRODUCT OVERVIEW

The Alarm Lock Trilogy T2 DL2700WP26D is a robust electronic digital keypad cylindrical lock leverset designed for secure keyless entry. It supports up to 100 user entry codes, ranging from 3 to 5 digits, and is suitable for both exterior and interior doors. The lock features a durable satin chrome finish and a reversible lever handle for versatile installation.



**Figure 1:** Overview of the Alarm Lock Trilogy T2 DL2700WP26D and its included components. This image displays the main lock assembly, latch cylinder, strike plate, latch cover, trim plate, keys, and battery pack.

## 2. SETUP AND INSTALLATION

### 2.1. What's in the Box

- Trilogy T2 electronic digital keypad leverset
- Latch cylinder
- Strike plate
- Latch cover
- Trim plate
- Keys (2)
- Battery pack with 5 AA batteries

### 2.2. Installation Requirements

Installation of the cylindrical lock mechanism requires two bored perpendicular holes in the door: one in the door face and a crossbore hole in the door edge. The lever handle is reversible, allowing for installation on either right- or left-hand opening doors.

### 2.3. Battery Installation

The leverset is powered by 5 AA batteries, which are included. Ensure correct polarity when inserting the batteries into the battery pack. The lock is designed for long-lasting operation, providing approximately 120,000 cycles per set of batteries.

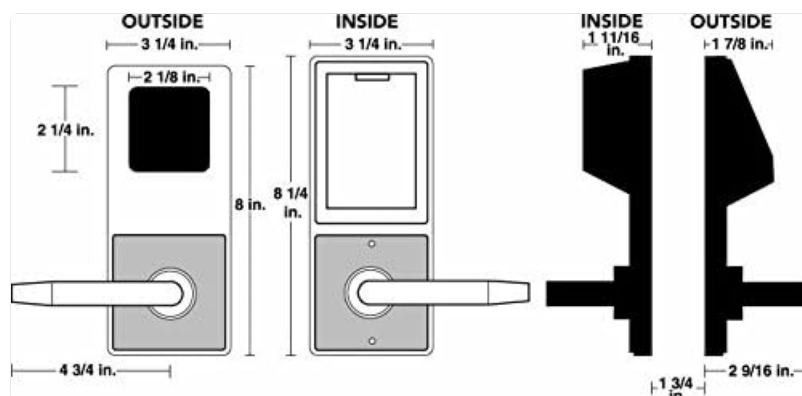

**Figure 2:** Dimensional specifications for the Alarm Lock Trilogy T2 DL2700WP26D, illustrating outside and inside measurements, as well as door thickness compatibility.

## 3. OPERATING INSTRUCTIONS

### 3.1. Keypad Entry

The lock supports up to 100 unique user entry codes, each consisting of 3 to 5 digits. Codes are manually programmed directly through the keypad. LED indicators and audible sounds provide feedback during code entry and programming.



**Figure 3:** Close-up view of the electronic keypad on the Alarm Lock Trilogy T2 DL2700WP26D, used for code entry and programming.

### **3.2. Proximity Card/Fob Entry**

In addition to keypad entry, the lock supports proximity card or fob access. Simply present a programmed card or fob to the reader on the lock to gain entry.

### **3.3. Privacy Lock Feature**

The lock includes a privacy feature, ideal for applications like bathrooms or private offices. A button located on the inside of the lock, when pressed, will lock out all standard user codes and proximity cards/fobs from the outside. The

exterior keypad will display a flashing red light to indicate that the lock is in privacy mode.



Figure 4: Rear view of the Alarm Lock Trilogy T2 DL2700WP26D, highlighting the privacy button on the interior side of the lock.





**Figure 5:** Two Alarm Lock Trilogy T2 DL2700WP26D units, one demonstrating the 'Press Button to Lock' feature, which activates the privacy mode.

### 3.4. Emergency Override

In an emergency or when the privacy feature is active, entry can still be gained using a master code or a manager's fob. The lock also features a solid brass fixed key cylinder for key override, allowing mechanical access.

**Video 1:** A product demonstration of the Alarm Lock Trilogy T2 DL2700WP26D, showcasing its keypad and proximity card entry, as well as the privacy lock and emergency override functions.

## 4. MAINTENANCE

### 4.1. Battery Replacement

The lock operates on 5 AA batteries. When the battery level is low, the lock will provide an indication. Replace all 5 batteries simultaneously with new alkaline AA batteries to ensure optimal performance and longevity.

### 4.2. General Care

The leverset trim is constructed from stainless steel with a satin chrome finish, designed to resist corrosion. Regular cleaning with a soft, damp cloth is recommended to maintain its appearance. Avoid using abrasive cleaners or solvents.

## 5. TROUBLESHOOTING

### 5.1. Lock Not Responding to Codes/Fobs

- **Check Privacy Mode:** If the exterior keypad shows a flashing red light, the lock is in privacy mode. Use a master code or manager's fob for entry, or deactivate privacy mode from the inside.
- **Check Batteries:** Ensure batteries are properly installed and have sufficient charge. Replace if necessary.
- **Verify Codes/Fobs:** Confirm that the entered code is correct and that the proximity card/fob is properly programmed and active.

### 5.2. Lever Not Engaging/Locking

- **Mechanical Check:** Inspect the latch mechanism for any obstructions or damage.
- **Internal Motor/Spring:** If the internal motor runs continuously or the lever feels loose and does not retract the latch sufficiently, this may indicate an internal mechanical issue.

For persistent issues not resolved by these steps, please refer to the support section for contact information.

## 6. SPECIFICATIONS

Feature	Specification
Lock Type	Cylindrical, Electronic Digital Keypad

Feature	Specification
User Codes Supported	Up to 100
Code Length	3 to 5 digits
Key Override	Solid brass, 6-pin cylinder with SC1 keyway
Temperature Rating	-31 to +151 degrees F (-35 to +66 degrees C)
Power Source	5 AA batteries (included)
Battery Life	Approx. 120,000 cycles
Door Thickness	1-5/8 to 1-7/8 inches
Backset Width	2-3/4 inches
Dimensions (L x W x H)	1.87 x 3.25 x 8 inches
Weight	8 pounds
Material	Metal, Stainless Steel (Handle)
Finish	Satin Chrome
Certifications	ANSI/BHMA Grade 1, ADA compliant (when properly installed), UL listed (3-hour fire rating), FCC certified

## 7. WARRANTY INFORMATION

The Alarm Lock Trilogy T2 DL2700WP26D is warranted for two years from the date of manufacture. Please retain your proof of purchase for warranty claims. For specific warranty terms and conditions, refer to the documentation included with your product or contact Alarm Lock Systems, Inc. directly.

## 8. SUPPORT

For technical assistance, programming inquiries, or troubleshooting support, please contact Alarm Lock Systems, Inc. customer service. Detailed contact information can typically be found on the manufacturer's official website or in the product packaging.

