

[Manuals.plus](#) /

> [Accutire](#) /

> Accutire MS-4021B Digital Tire Pressure Gauge User Manual

Accutire MS-4021B

Accutire MS-4021B Digital Tire Pressure Gauge User Manual

Model: MS-4021B | Brand: Accutire

PRODUCT OVERVIEW

The Accutire MS-4021B Digital Tire Pressure Gauge is designed for accurate and convenient tire pressure measurement. Its robust construction ensures durability, while the ergonomic design provides a comfortable grip. The clear digital display makes readings simple and quick.

- Heavy duty construction and rugged design for long lasting use.
- Angled head and rubber coated handle for easy gripping.
- Large, easy-to-read backlit LCD display; Easily switch between psi, bar, kPa, kg/cm².
- Equipped with an automatic shut off to conserve battery life.
- Accurate to within 0.5 PSI, reading air pressure from 5-150 PSI in 0.5 pound increments.



Image: The Accutire MS-4021B Digital Tire Pressure Gauge shown with four black valve caps.

PACKAGE CONTENTS

Verify that all items are present in your package:

- 1 x Accutire MS-4021B Digital Tire Pressure Gauge
- 4 x Valve Caps

SETUP

Battery Installation

The Accutire MS-4021B requires 3 LR44 1.5V coin cell batteries. These are typically pre-installed. If replacement is needed:

1. Locate the battery compartment on the back of the gauge.
2. Use a small screwdriver to remove the screw securing the battery cover.
3. Carefully remove the battery cover.
4. Insert three new LR44 1.5V coin cell batteries, ensuring correct polarity (+/-).
5. Replace the battery cover and secure it with the screw.

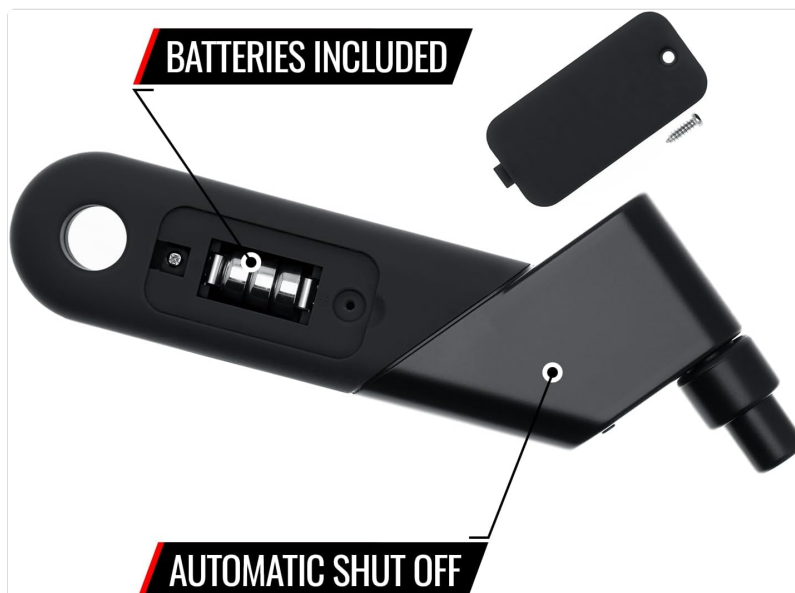

Image: The Accutire MS-4021B with its battery compartment open, showing the three LR44 batteries inside.

Initial Power On

The gauge powers on automatically when pressure is applied to the nozzle or when the unit button is pressed. It will display '0.0' or the last measured reading.

OPERATING INSTRUCTIONS

Measuring Tire Pressure

1. Ensure the tire is cold (driven less than one mile).
2. Remove the valve cap from the tire valve stem.
3. Firmly press the nozzle of the gauge straight onto the tire valve stem. A slight hiss may be heard; this is normal. Maintain a tight seal.
4. The digital display will show the tire pressure reading. Hold the gauge in place until the reading stabilizes.
5. Remove the gauge from the valve stem. The reading will hold on the display for a few seconds before automatically shutting off to conserve battery life.
6. Replace the valve cap on the tire valve stem.



Image: The Accutire MS-4021B in use, demonstrating its easy-to-read backlit display showing a pressure reading.

Switching Measurement Units

The Accutire MS-4021B can display pressure in PSI, BAR, KPA, and KG/CM². To switch between units:

- With the gauge powered on, locate the small button on the side of the unit.
- Press this button repeatedly to cycle through the available measurement units. The active unit will be displayed on the screen.



Image: The Accutire MS-4021B with an arrow pointing to the small button used to toggle between PSI, BAR, KPA, and KG/CM² units.

Official Product Video

Your browser does not support the video tag.

Video: An unboxing and feature overview of the Accutire MS-4021B Digital Tire Pressure Gauge, demonstrating its design, display, and unit switching capabilities.

MAINTENANCE

Battery Replacement

Refer to the 'Battery Installation' section under Setup for detailed instructions on replacing the LR44 1.5V coin cell batteries. Regular battery checks are recommended to ensure optimal performance.



Image: The underside of the Accutire MS-4021B, highlighting the easily accessible battery compartment for maintenance.

Cleaning

Wipe the gauge with a soft, dry cloth. Do not use abrasive cleaners or immerse the unit in water.

TROUBLESHOOTING

- **No Display / Faint Display:** Check battery installation and replace batteries if necessary. Ensure batteries are inserted with correct polarity.
- **Inaccurate Readings:** Ensure the gauge is pressed firmly and squarely onto the tire valve stem to create a tight seal. Verify that the tire is cold before measuring. Compare readings with another known accurate gauge if available.
- **Gauge Not Turning On:** Press the unit button to manually activate the display. If still unresponsive, check or replace batteries.

PRODUCT SPECIFICATIONS

Feature	Detail
Brand	Accutire
Model	MS-4021B
Measurement Range	5-150 PSI
Accuracy	Within 0.5 PSI
Measurement Units	PSI, BAR, KPA, KG/CM ²
Display Type	Backlit LCD
Power Source	3 x LR44 1.5V Coin Cell Batteries (included)
Material	Acrylonitrile Butadiene Styrene (ABS), Rubber
Item Dimensions (L x W x H)	6.7 x 2.4 x 0.8 inches
Item Weight	0.8 ounces (22.68 g)
UPC	703546962442, 015507108562, 658551455895, 708315660253, 600740190643
Manufacturer	Accutire



Image: The Accutire MS-4021B highlighting its measurement range of 5-150 PSI and 0.5 PSI increments.

WARRANTY AND SUPPORT

For warranty information, technical support, or service inquiries, please refer to the contact information provided on the product packaging or visit the official Accutire website. Keep your purchase receipt for warranty claims.