

## Rode NT1000

# Rode NT1000 Large-Diaphragm Condenser Microphone User Manual

Model: NT1000

## 1. INTRODUCTION

---

Thank you for choosing the Rode NT1000 Large-Diaphragm Condenser Microphone. This manual provides essential information for the proper setup, operation, and maintenance of your new microphone. The NT1000 is engineered for superior large-capsule performance, making it ideal for capturing both vocal and instrumental performances with ultra-low noise and true condenser operation.

Please read this manual thoroughly before using the microphone to ensure optimal performance and longevity.

## 2. SAFETY INFORMATION

---

- Always handle the microphone with care. Avoid dropping or subjecting it to strong impacts.
- Do not expose the microphone to moisture, rain, or extreme temperatures.
- Ensure proper ventilation around the microphone during operation.
- Only use the microphone with compatible audio equipment that provides 48V phantom power.
- Keep the microphone away from strong magnetic fields.

## 3. PACKAGE CONTENTS

---

Please verify that all items are present in your package:

- Rode NT1000 Large-Diaphragm Condenser Microphone
- Shock Mount
- Protective Pouch/Case
- This User Manual

## 4. SETUP

---

### 4.1 Mounting the Microphone

The Rode NT1000 is designed to be used with a standard microphone stand and the included shock mount. The shock mount helps to isolate the microphone from vibrations and handling noise.

1. Securely attach the shock mount to your microphone stand.
2. Carefully insert the Rode NT1000 microphone into the shock mount, ensuring it is firmly seated.





Figure 1: The Rode NT1000 microphone, showcasing its robust silver casing and mesh grille.

## 4.2 Connecting to an Audio Interface/Mixer

The NT1000 requires 48V phantom power for operation. It connects via a standard XLR cable.

1. Connect one end of a high-quality XLR cable to the microphone's XLR output.
2. Connect the other end of the XLR cable to an input on your audio interface, mixer, or preamplifier.
3. Activate the 48V phantom power on your audio interface or mixer. The microphone will not function without phantom power.

## 5. OPERATING THE MICROPHONE

---

### 5.1 Polar Pattern

The Rode NT1000 features a Unidirectional (Cardioid) polar pattern. This means it is most sensitive to sound coming from the front of the microphone and rejects sound from the sides and rear. This characteristic is beneficial for isolating the desired sound source and minimizing background noise.

### 5.2 Optimal Placement

For best results, position the microphone directly in front of the sound source. Experiment with distance and angle to achieve the desired tone and clarity. For vocals, a distance of 6-12 inches (15-30 cm) is often a good starting point. For instruments, placement will vary depending on the instrument and desired sound.



Figure 2: The Rode NT1000 positioned to capture the rich sound of a brass instrument, demonstrating its versatility for instrumental recording.

### 5.3 Gain Staging

Proper gain staging is crucial for achieving a clean recording. Adjust the gain on your audio interface or mixer so that the input signal is strong but does not clip (distort). Monitor your levels carefully during recording.

## 6. MAINTENANCE

---

- **Cleaning:** Use a soft, dry cloth to clean the microphone's exterior. Do not use abrasive cleaners or solvents.
- **Storage:** When not in use, store the microphone in its protective pouch or case in a cool, dry place, away from direct sunlight and excessive humidity.
- **Handling:** Always handle the microphone by its body, not by the grille or cable.

## 7. TROUBLESHOOTING

---

### 7.1 No Sound Output

- Ensure 48V phantom power is enabled on your audio interface/mixer.
- Check all cable connections. Ensure the XLR cable is securely plugged into both the microphone and the input device.
- Verify that the input gain on your audio interface/mixer is turned up.
- Test with a different XLR cable or input channel if available.

### 7.2 Hum or Noise in Audio

- Ensure all cables are properly shielded and in good condition.
- Check for ground loops. Try plugging your audio equipment into a different power outlet or using a power conditioner.
- Keep the microphone and cables away from power supplies, monitors, and other electronic devices that may cause interference.

### 7.3 Distorted Audio

- Reduce the input gain on your audio interface/mixer.
- Increase the distance between the microphone and the sound source.
- Ensure the microphone is not overloaded by excessively loud sound sources.

## 8. SPECIFICATIONS

Feature	Specification
Power Source	Corded Electric
Material	Nickel
Signal-to-Noise Ratio	82 dB
Number of Channels	1
Frequency Range	20Hz - 20kHz
Frequency Response	20 KHz
Noise Level	6 dB
Polar Pattern	Unidirectional
Impedance	100 Ohm
Item Weight	2.2 Pounds
Product Dimensions	11 x 3 x 6 inches

## 9. WARRANTY AND SUPPORT

The Rode NT1000 microphone comes with a manufacturer's warranty. For detailed information regarding warranty terms and conditions, please refer to the official Rode website or the warranty card included with your product. For technical support, service, or additional resources, please visit the [Rode Microphones official website](#) or consult the [User Guide \(PDF\)](#) available online.



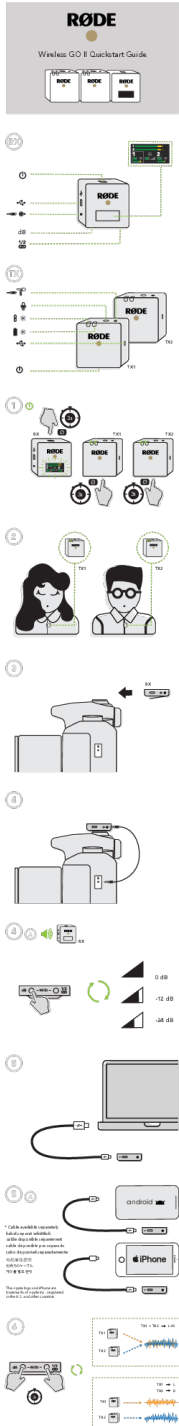

### [RODE NTH-100 Professional Over-Ear Headphones User Manual](#)

Discover the RODE NTH-100 professional over-ear headphones, engineered for exceptional audio performance, superior comfort, and durability for content creators. Learn about key features, design, and specifications.



### [Rode Wireless GO II Quickstart Guide](#)

A quickstart guide for the Rode Wireless GO II, covering setup, operation, and safety information.

	<p><a href="#">RØDEcaster Video: All-in-One Production Console for Video and Audio</a></p> <p>Discover the RØDEcaster Video, a revolutionary all-in-one console for seamless video and audio production, live streaming, and podcasting. Featuring advanced switching, professional audio mixing, and powerful processing.</p>
	<p><a href="#">RØDE Stereo VideoMic Pro Instruction Manual - Setup, Features, and Specifications</a></p> <p>Comprehensive guide to the RØDE Stereo VideoMic Pro on-camera microphone, covering setup, controls, features, specifications, troubleshooting, and care instructions. Learn how to achieve broadcast-quality audio for your videos.</p>
	<p><a href="#">ZGCINE ZG-R30 Charging Case for RODE Wireless Go - User Manual</a></p> <p>Comprehensive user manual for the ZGCINE ZG-R30 charging case, designed for RODE Wireless Go microphones. Learn about features, specifications, operation, safety, storage, transportation, and warranty information.</p>

**PERFORMANCE TO VIRTUAL**  
Tools, Tips and Techniques  
A Video Production Guide for Theater and Dance

**EPISODE 1: Video Theater and Dance**  
Performance to Video, Sound, Green Screen

As the first of a series of three episodes, this video production guide provides the performance to video and sound recording tips for video theater and dance. It also includes a list of essential equipment and early production tips for video theater and dance.

**Video Theater and Dance**  
The video production guide for video theater and dance provides the performance to video and sound recording tips for video theater and dance. It also includes a list of essential equipment and early production tips for video theater and dance.

**Sound**  
The video production guide for video theater and dance provides the performance to video and sound recording tips for video theater and dance. It also includes a list of essential equipment and early production tips for video theater and dance.

**Equipment**  
The video production guide for video theater and dance provides the performance to video and sound recording tips for video theater and dance. It also includes a list of essential equipment and early production tips for video theater and dance.

**Production**  
The video production guide for video theater and dance provides the performance to video and sound recording tips for video theater and dance. It also includes a list of essential equipment and early production tips for video theater and dance.

**Post-Production**  
The video production guide for video theater and dance provides the performance to video and sound recording tips for video theater and dance. It also includes a list of essential equipment and early production tips for video theater and dance.

**Conclusion**  
The video production guide for video theater and dance provides the performance to video and sound recording tips for video theater and dance. It also includes a list of essential equipment and early production tips for video theater and dance.

[Performance to Virtual: Video Production Guide for Theater and Dance](#)

Learn essential tools, tips, and techniques for converting live theater and dance performances to video, covering sound, green screen, storyboarding, and essential equipment from the Video Association of Dallas.