

Manuals+

[Q & A](#) | [Deep Search](#) | [Upload](#)

[manuals.plus](#) /

› [Lincoln](#) /

› [Lincoln 1142 Lever Action Manual Grease Gun User Manual](#)

Lincoln 1142

Lincoln 1142 Lever Action Manual Grease Gun User Manual

Model: 1142

INTRODUCTION

The Lincoln 1142 Lever Action Manual Grease Gun is a robust and reliable tool designed for efficient lubrication in various demanding environments, including automotive, industrial, and agricultural settings. This manual provides comprehensive instructions for the safe and effective use, maintenance, and troubleshooting of your grease gun, ensuring optimal performance and longevity.



SAFETY INFORMATION

Always prioritize safety when operating the grease gun. Failure to follow these instructions may result in injury or damage to the equipment.

- **Wear Protective Gear:** Always wear safety glasses and gloves to protect against grease splashes and potential injury.
- **Use Correct Grease:** Ensure the grease used is appropriate for the application and the grease gun's specifications (e.g., NLGI 2 or less).
- **Inspect Before Use:** Before each use, inspect the grease gun for any damage, loose parts, or leaks.
- **Do Not Over-Pressurize:** Avoid excessive force when pumping, as this can damage the equipment or cause fittings to rupture.
- **Keep Clean:** Keep the grease gun and work area clean to prevent contamination of grease and equipment.
- **Store Properly:** Store the grease gun in a clean, dry place away from extreme temperatures.

PRODUCT OVERVIEW

The Lincoln 1142 grease gun is engineered for durability and ease of use. Key components include:

- **Lever Handle:** Provides mechanical advantage for high-pressure grease delivery.
- **Cast Pump Head:** Heavy-duty construction for long-term reliability.
- **Rigid Extension:** Allows for precise application in hard-to-reach areas.
- **Dual Lip Follower:** Minimizes grease bypass for efficient use of grease.
- **Jam-Proof Toggle Mechanism:** Ensures smooth operation and prevents binding.
- **Accessible Check Valve:** Facilitates easy cleaning and removal of contaminated grease.
- **Precision-Machined Plunger:** Delivers consistent lubrication.



Image: An infographic detailing the key features of the Lincoln 1142 Grease Gun, including the jam-proof toggle mechanism, dual lip follower, rugged cast iron head, accessible check valve, and precision machined plunger.

SETUP

Proper setup is crucial for the efficient operation of your grease gun.

Loading a Grease Cartridge:

1. Unscrew the barrel from the head assembly.
2. Pull the plunger rod all the way back and lock it into the slot on the head assembly.
3. Remove the plastic cap from one end of a new grease cartridge and insert the open end into the barrel.
4. Remove the pull-tab seal from the other end of the cartridge.
5. Screw the barrel back onto the head assembly until hand-tight.
6. Release the plunger rod from its locked position and push it forward slightly to ensure it engages with the cartridge follower.
7. Prime the gun by pumping the lever several times until grease begins to flow from the nozzle. If air pockets persist, loosen the head assembly 1.5 turns and pump until grease flows, then retighten.



Image: A close-up view of the grease gun's head assembly, showing the accessible check valve and its components (nut, ball bearing, spring) for maintenance.

OPERATING INSTRUCTIONS

Follow these steps for effective lubrication:

1. Ensure the grease gun is properly loaded and primed.
2. Clean the zerk fitting on the component to be lubricated to prevent contamination.
3. Press the coupler firmly onto the zerk fitting until it snaps into place.

4. Operate the lever handle with steady, full strokes until fresh grease appears or resistance is felt. Refer to the equipment manufacturer's recommendations for specific lubrication intervals and quantities.
5. To remove the coupler, tilt it slightly and pull it straight off the zerk fitting.
6. Wipe any excess grease from the zerk fitting and the grease gun nozzle.



Image: A person wearing gloves using a Lincoln grease gun to lubricate a component near a vehicle wheel, demonstrating practical application.



Image: The Lincoln grease gun being used to lubricate a pivot point on heavy blue machinery, highlighting its utility in industrial applications.

MAINTENANCE

Regular maintenance ensures the longevity and optimal performance of your Lincoln 1142 grease gun.

- **Cleaning:** After each use, wipe down the exterior of the grease gun to remove any excess grease or dirt.
- **Check Valve Cleaning:** The accessible check valve allows for easy cleaning. If hardened or contaminated grease is suspected, disassemble the check valve (as shown in the setup image) and clean its components. Lincoln recommends cleaning at least twice a year, which takes less than five minutes.
- **Coupler Inspection:** Periodically inspect the coupler for wear or damage. Replace if it no longer forms a tight seal on zerk fittings.
- **Storage:** Store the grease gun in a clean, dry environment to prevent corrosion and contamination.

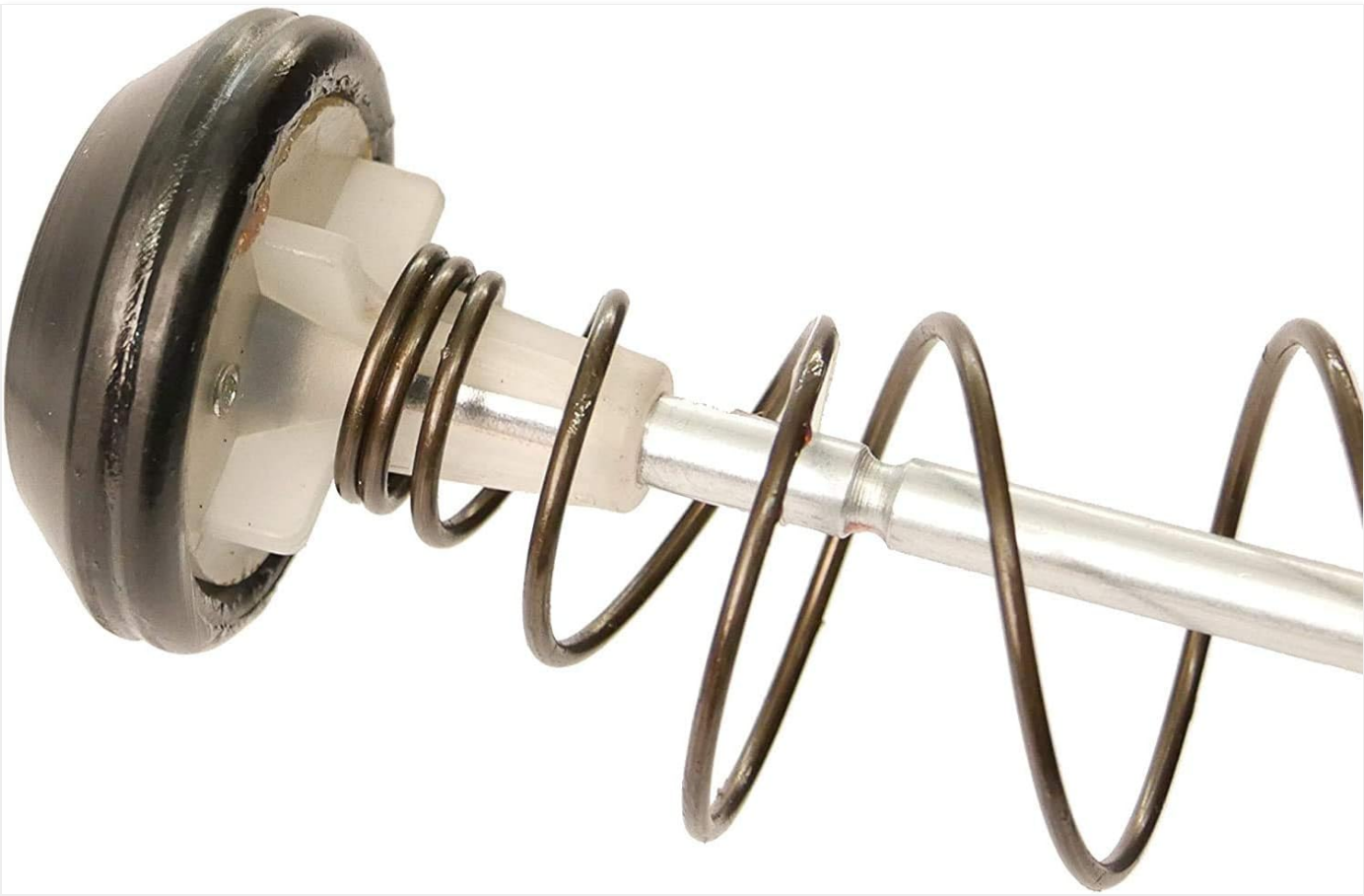

Image: A detailed view of the grease gun's plunger and heavy-duty follower spring, components critical for consistent grease delivery.

TROUBLESHOOTING

Common issues and their solutions:

Problem	Possible Cause	Solution
Grease gun does not pump grease (no prime/loss of prime)	Air pockets in the system; grease too cold or thick; improper cartridge loading.	Follow priming instructions (loosen head 1.5 turns, pump, retighten). Verify grease is NLGI 2 or less. Warm grease if operating in cold temperatures. Ensure cartridge is loaded correctly and plunger rod is engaged.

Problem	Possible Cause	Solution
Grease gun is leaking	Worn coupler; old/bad grease causing oil separation; loose connections.	Check what is leaking and where. Replace worn coupler. Ensure all connections are tight. If oil is leaking, it may indicate old or bad grease; replace grease.
Grease around the spring (inside the barrel)	Improper positioning of the follower lip seal (older models); worn follower.	Ensure the follower lip seal is properly positioned to prevent grease bypass. If the follower is worn, it may need replacement.

SPECIFICATIONS

Brand: Lincoln

Model: 1142

Item Weight: 3 pounds

Product Dimensions: 16.1 x 5.6 x 3.1 inches

Manufacturer Part Number: 1142

National Stock Number: 4930-01-491-4675

Type: Lever Action Manual Grease Gun

Included: Rigid Extension

WARRANTY AND SUPPORT

Lincoln products are known for their durability and quality. For specific warranty information, please refer to the documentation included with your purchase or visit the official Lincoln website. For technical support or service inquiries, please contact Lincoln customer service.



You can find more information and related products on the [Lincoln Store on Amazon](#).

OFFICIAL PRODUCT VIDEOS

No official product videos from the seller were found to be relevant and useful for inclusion in this manual.

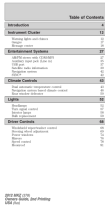

Related Documents - 1142

 <p>Models 1800, 1842, 1842E, 1844, 1844E PowerLuber Grease Gun Series "A"</p> <p>Note: E & G battery only included on Models 1842 and 1844E Direct PowerLuber Model 1800</p> <p>CE</p> <p>017-0000 Page 40/500 Section 07 Page 81A</p>	<p>LINCOLN PowerLuber Grease Gun Manual: Models 1800, 1842, 1842E, 1844, 1844E</p> <p>Comprehensive manual for LINCOLN PowerLuber Grease Gun series, covering operation, safety, specifications, and maintenance for models 1800, 1842, 1842E, 1844, and 1844E.</p>
 <p>Hand-Held Lubrication PowerLuber Grease Guns Professional Non-Spray 1/4" & 3/8" Drive Grease Gun</p>	<p>Lincoln Hand-Held Lubrication PowerLuber Grease Guns and Accessories</p> <p>A comprehensive guide to Lincoln's PowerLuber series of hand-held grease guns, including cordless and pneumatic models, along with a wide range of accessories such as hoses, couplers, fittings, and bearing packers. Details features, specifications, and model numbers for various lubrication tools.</p>
 <p>CUSTOM LINCOLN ACCESSORIES</p>	<p>Lincoln Accessories Catalog: Enhance Your Lincoln Vehicle</p> <p>Explore the official Lincoln Accessories catalog, featuring a comprehensive range of enhancements for your Lincoln vehicle. Discover high-quality accessories for models like Continental, MKX, Navigator, Aviator, and more, covering electronics, security, interior comfort, and exterior styling.</p>
 <p>MODELS 740, 3050, 81495, 82393 HIGH PRESSURE CONTROL VALVE Owner's Manual & Specifications</p>	<p>Lincoln High Pressure Control Valve Model 740 - Owner's Manual & Specifications</p> <p>Official owner's manual and service parts list for the Lincoln High Pressure Control Valve, models 740, 3050, 81495, and 82393. Includes operation, maintenance, safety warnings, and warranty information.</p>
 <p>2023 LINCOLN CORSAIR Owner's Manual</p>	<p>2023 Lincoln Corsair Owner's Manual: Comprehensive Guide to Vehicle Features and Operation</p> <p>Explore the 2023 Lincoln Corsair Owner's Manual. This comprehensive guide provides detailed information on vehicle operation, safety features, interior and exterior controls, technology, maintenance, and more for your Lincoln Corsair.</p>
 <p>Table of Contents</p>	<p>2012 Lincoln MKZ Owner's Guide: Features, Operation, and Maintenance</p> <p>Comprehensive owner's manual for the 2012 Lincoln MKZ, detailing vehicle features, controls, safety systems, maintenance, and troubleshooting. Learn how to operate your Lincoln MKZ effectively and safely.</p>