

FELCO F 6 (100052385)

Felco Pruning Shears (F 6) Instruction Manual

Brand: FELCO

Model: F 6 (100052385)

1. INTRODUCTION AND OVERVIEW

The Felco F 6 Pruning Shears are high-performance, Swiss-made hand pruners designed for precision and durability in gardening tasks. This model is particularly suited for individuals with smaller to medium-sized hands, offering comfortable and efficient operation for various pruning needs.



Figure 1: Felco F 6 Pruning Shears, showcasing their compact design and red handles.

Constructed with forged aluminum handles and hardened steel blades, these bypass pruners are built to last, with all components being replaceable to ensure a long lifespan. Their ergonomic design, including a revolving handle and cushioned-shock absorber, minimizes strain during prolonged use, making them a preferred choice for both amateur and professional gardeners.

2. KEY FEATURES

- **Ultra-Durable Construction:** Features forged aluminum handles and hardened steel blades, ensuring longevity and resilience. All components are designed for easy replacement.
- **Ergonomic Design:** Equipped with a revolving handle for enhanced comfort and a cushioned-shock absorber to reduce cutting impact, suitable for various pruning tasks.
- **Precise Cutting:** Offers a large cutting capacity (up to 0.8 inches or 20 mm) and a well-balanced weight. Includes a wire cutter and a sap groove to prevent blade sticking.
- **High Performance Blades:** Hardened steel blade and screw-mounted anvil blade provide reliably clean,

precise cuts. The narrow pointed anvil blade allows for close cuts to the plant stem.

- **Optimized for Medium Hands:** With a length of 7.7 inches (195 mm) and a weight of 0.46 pounds (210 grams), this model is ideal for users with medium-sized hands.
- **Swiss Made Quality:** Manufactured in Switzerland, ensuring high standards of craftsmanship and reliability.



Figure 2: Detailed view of the Felco F 6's precision mechanism and locking system.

3. SETUP AND GETTING STARTED

Your Felco F 6 Pruning Shears come ready for immediate use. Before first use, and periodically thereafter, inspect the blades and moving parts.

1. **Unpacking:** Carefully remove the pruners from their packaging.
2. **Initial Inspection:** Check for any visible damage or loose parts. Ensure the blades open and close smoothly.
3. **Lubrication:** Apply a small amount of light oil (e.g., mineral oil or specialized tool oil) to the pivot point and the spring mechanism. This ensures smooth operation and helps prevent rust.
4. **Lock Mechanism:** Familiarize yourself with the locking mechanism located on the side of the pruners. Push the lever down to unlock and open the blades, and push it up to lock the blades in the closed position for safety when not in use.



Figure 3: Proper grip of the Felco F 6 Pruning Shears, demonstrating comfortable handling for medium-sized hands.

4. OPERATING INSTRUCTIONS

The Felco F 6 Pruning Shears are designed for efficient and clean cuts on various plant materials. Always ensure the blades are sharp for optimal performance and plant health.

1. **Selecting the Right Branch:** These pruners are ideal for small pruning work, such as grape vines, shrubs, and young trees, with a maximum cutting capacity of 0.8 inches (20 mm).
2. **Making a Clean Cut:** Position the branch as deep as possible into the jaws of the pruner, close to the pivot point. This maximizes leverage and ensures a clean, precise cut.
3. **Angle of Cut:** For optimal plant health, make cuts at a slight angle, just above a bud or branch collar.
4. **Wire Cutter:** The pruners include a small wire cutter notch near the pivot point for cutting thin wires.
5. **Sap Groove:** The sap groove helps to prevent the blade from sticking when cutting resinous wood.



Figure 4: Demonstrating the Felco F 6 Pruning Shears making a precise cut on a small branch.

Official Product Video: Felco Ergonomic Hand Pruner

Your browser does not support the video tag.

Video 1: This video provides a detailed overview of the Felco Ergonomic Hand Pruner, highlighting its features and demonstrating its use for various cutting tasks. It showcases the pruner's design and cutting capabilities.

5. MAINTENANCE

Regular maintenance will extend the life and performance of your Felco F 6 Pruning Shears.

1. **Cleaning:** After each use, especially after pruning resinous plants, clean the blades with a cloth dampened with alcohol or a specialized resin cleaner. This prevents sap buildup and maintains cutting efficiency.
2. **Sharpening:** Keep the blades sharp using a sharpening stone or file. A sharp blade ensures clean cuts, which are healthier for plants and require less effort from the user. Sharpening should be done regularly, depending on

usage.

3. **Lubrication:** Periodically apply a few drops of light oil to the pivot bolt, spring, and locking mechanism. This reduces friction and prevents rust.
4. **Tightening:** Check the tightness of the pivot bolt regularly. If it becomes loose, tighten it slightly to ensure proper blade alignment and cutting action.
5. **Component Replacement:** All parts of the Felco F 6, including blades, springs, and handles, are replaceable. Refer to the parts diagram (Figure 5) for identification and replacement instructions.
6. **Storage:** Store your pruners in a dry place, preferably in a sheath or tool bag, to protect them from moisture and damage. Always engage the locking mechanism before storage.

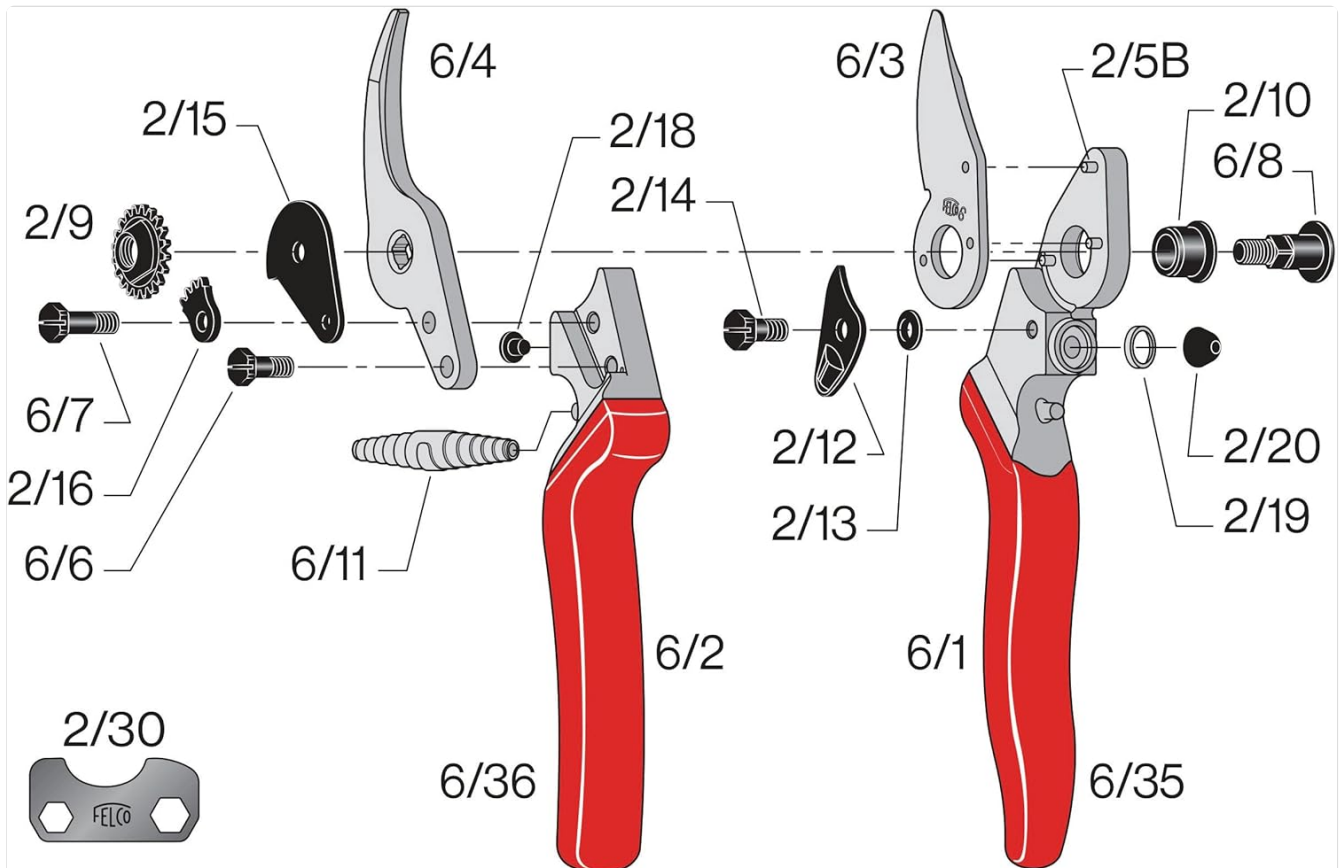

Figure 5: Exploded view diagram of the Felco F 6 Pruning Shears, showing all replaceable components for maintenance and repair.

6. TROUBLESHOOTING

Problem	Possible Cause	Solution
Blades not cutting cleanly or crushing stems.	Dull blades or loose pivot bolt.	Sharpen blades. Check and tighten the pivot bolt.
Blades sticking or difficult to open/close.	Sap buildup or lack of lubrication.	Clean blades thoroughly. Apply lubricant to pivot and spring.
Handles feel stiff or uncomfortable.	Spring is worn or dirty.	Clean and lubricate the spring. If worn, replace the spring.

Problem	Possible Cause	Solution
Locking mechanism is difficult to engage/disengage.	Dirt or lack of lubrication.	Clean the locking mechanism and apply lubricant.

7. SPECIFICATIONS

Brand: FELCO

Model: F 6 (Item model number: 100052385)

Style: Pruner

Hand Orientation: Right (also suitable for ambidextrous use with slight adjustment)

Product Dimensions: 7.7"L x 0.79"W (195 mm length)

Item Weight: 0.46 pounds (210 grams)

Cutting Capacity: 0.8 inches (20 mm)

Blade Material: Hardened Steel

Handle Material: Forged Aluminum with Red coating

Blade Type: Bypass

Country of Origin: Switzerland

UPC: 086009016075

8. WARRANTY AND SUPPORT

The Felco F 6 Pruning Shears come with a **Limited Lifetime Warranty**. This warranty covers defects in materials and workmanship under normal use. For specific details regarding warranty coverage, claims, or to purchase replacement parts, please refer to the official FELCO website or contact their customer support.

FELCO is known for its commitment to product longevity and offers a wide range of replacement parts, ensuring that your pruners can be maintained and repaired for many years of reliable service.

