

## KitchenAid K5ASBP

# KitchenAid 5 Quart Polished Stainless Steel Bowl (K5ASBP) Instruction Manual

Model: K5ASBP

## 1. INTRODUCTION

This instruction manual provides essential information for the proper use, care, and maintenance of your KitchenAid 5 Quart Polished Stainless Steel Bowl, model K5ASBP. Please read this manual thoroughly before first use to ensure optimal performance and longevity of your product.

## 2. PRODUCT OVERVIEW

The KitchenAid 5 Quart Polished Stainless Steel Bowl (K5ASBP) is designed as an accessory for select KitchenAid Bowl-Lift Stand Mixers. It features a durable stainless steel construction with a polished exterior and a flat handle for secure handling and attachment.



Image 1: Front view of the KitchenAid 5 Quart Polished Stainless Steel Bowl, showing the flat handle and polished finish.

### 3. COMPATIBILITY

---

This 5-quart bowl is specifically designed for use with the following KitchenAid Bowl-Lift Stand Mixer models:

- KSM500
- KSM450
- KPM5
- KPM50
- K5SS
- KSM5

Ensure your mixer model is listed above for proper fit and function. This bowl is not compatible with tilt-head stand mixers.

### 4. SETUP AND INSTALLATION

---

To install the bowl onto your KitchenAid Bowl-Lift Stand Mixer:

1. Ensure the mixer is turned off and unplugged from the power outlet.
2. Raise the mixer head to its highest position using the bowl-lift lever.
3. Place the bowl's rear pin into the spring-loaded pin on the mixer's bowl clamping plate.
4. Press down on the back of the bowl until the front pins snap over the bowl clamps.

5. Lower the mixer head using the bowl-lift lever until it locks into the mixing position.
6. To remove, reverse these steps.

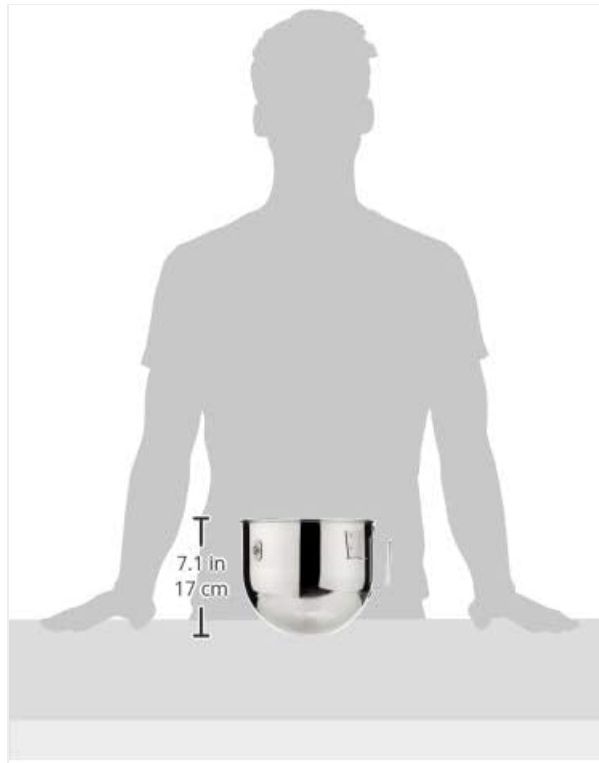

Image 2: Diagram illustrating the dimensions of the 5-quart bowl, showing a height of 7.1 inches (17 cm).

## 5. OPERATION (USAGE)

---

Once the bowl is securely attached to your KitchenAid Bowl-Lift Stand Mixer, you can proceed with your mixing tasks. The 5-quart capacity is suitable for a variety of recipes, including large batches of dough or batter. Always ensure the appropriate attachment (flat beater, wire whip, dough hook) is correctly installed and adjusted for bowl clearance before operating the mixer.

## 6. CLEANING AND MAINTENANCE

---

The KitchenAid 5 Quart Polished Stainless Steel Bowl is designed for easy cleaning.

- **Dishwasher Safe:** The bowl is dishwasher safe. Place it on the top rack for best results.
- **Hand Washing:** For hand washing, use warm, soapy water and a non-abrasive sponge or cloth. Rinse thoroughly and dry immediately to prevent water spots.
- **Stubborn Stains:** For stubborn food residue, soak the bowl in warm, soapy water before cleaning. Avoid using steel wool or abrasive cleaners, as these can scratch the stainless steel surface.

## 7. TROUBLESHOOTING

---

If you encounter issues with your bowl, consider the following:

- **Bowl Not Fitting Securely:**
  - Verify that your mixer model is listed in the "Compatibility" section (Section 3).
  - Ensure the bowl is correctly aligned with the mixer's pins and clamps as described in "Setup and Installation" (Section 4).

- Check for any obstructions or damage to the bowl's pins or the mixer's clamping plate.
- **Scratches or Discoloration:**
  - Avoid using abrasive cleaning tools or harsh chemicals.
  - Stainless steel can sometimes show water spots; ensure thorough drying after washing.

8. SPECIFICATIONS

Model Number	K5ASBP
Capacity	5 Quarts
Material	Polished Stainless Steel
Color	Silver
Dimensions (W x H)	10" x 8" (approximately)
Item Weight	1.67 pounds
Dishwasher Safe	Yes
Microwaveable	No

9. WARRANTY AND SUPPORT

For specific warranty information regarding your KitchenAid accessory, please refer to the documentation included with your original KitchenAid Stand Mixer or visit the official KitchenAid website. For customer support, product registration, or to purchase additional accessories, please visit [www.kitchenaid.com](http://www.kitchenaid.com) or contact KitchenAid customer service directly.

Related Documents - K5ASBP

<div data-bbox="124 1496 304 1780">  </div>	<div data-bbox="339 1615 1473 1807"> <p><a href="#">KitchenAid Stand Mixer Manual: Parts, Features, Assembly, Usage, Safety, and Warranty</a></p> <p>Comprehensive guide for KitchenAid Stand Mixers (models 3KSM150, 3KSM95, 3KSM6583, 3KSM5CBT, 3KSM5CBTWH, 3KSM5CBTER) covering parts identification, features, assembly instructions for tilt-head and bowl-lift models, product usage, speed control, accessory guide, safety precautions, care and cleaning, troubleshooting, and warranty information.</p> </div>
--	--



EN	Owner's Manual	2
FR	Manuel du propriétaire	6
ES	Manual del propietario	10

Comprehensive safety and operating instructions for the KitchenAid Commercial Bowl Lift Stand Mixer, covering product safety, important safeguards, care, cleaning, and detailed information. Includes model W11669707A.



8	Head Hider	19	Double Flex Edge Bracer*
9	Attachment Hub	20	Flux Bracer
10	Attachment Knob	21	Spring Duct/Hook
11	Hub Core	22	Wire Wrench**
12	Bracer Knob	23	1/4" Alloy Stainless Steel Elliptical Wrench**
13	Speed Control Lever	24	Flaming Shield**
14	Brax Offset Lever	25	Spring Guide and Brax Flex Hider**
15	Braxer Height Adjustment Screw	26	Fluxy Bracer**
16	Brax Support	27	Flex Edge Bracer**
17	Locating Pin	28	Grasper**
18	Brax		

\* Items may vary. Brax's are also available for purchase in separate assemblies.

\*\* Included with select models. Future/Style may vary from product depending on model.

Comprehensive guide for the KitchenAid KSM70SN Bowl Lift Stand Mixer, covering safety, assembly, usage, care, troubleshooting, and warranty information.



943878203A

Product guide for the KitchenAid KSM5SSBCB Stand Mixer Copper Bowl, covering parts, features, safety, assembly, disassembly, care, cleaning, and warranty information.

[illegible]

This guide provides essential information for using, attaching, removing, and cleaning the KitchenAid Glass Bowl with Tilt-Head Stand Mixers. Includes safety warnings and care instructions.

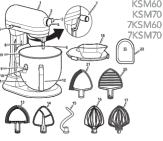

1 Motor Head	12 Double Flex Edge Bracket
2 Attachment Hub	14 Flat Beater
3 Attachment Knob	15 Spring Dough Hook
4 Hub Cover	16 Wire Whip
5 Beater Shaft	17 1/4" Alpha Stainless Steel Elliptical Whip**
6 Speed Control Lever	18 Flaming Shredder
7 Bowl-Lift Lever	19 Spring Guard and Bowl Feet Mount
8 Bowl Support	20 Pasty Beater**
9 Locating Pins	21 Flex Edge Beater**
10 Base**	22 Sprocket***
11 Bowl Handle**	

\*Base type may vary. Bowl's may also vary due to separate accessories.

\*\*Included as standard on models. Pasty Beater may vary from product depending on model.

\*\*\*Base type may vary. Sprocket may vary from product depending on model.

Comprehensive guide for the KitchenAid Bowl Lift Stand Mixer, covering safety precautions, assembly, usage, care, troubleshooting, and warranty information. Includes model numbers KSM55, KSM60, KSM70, 7KSM60, 7KSM70.

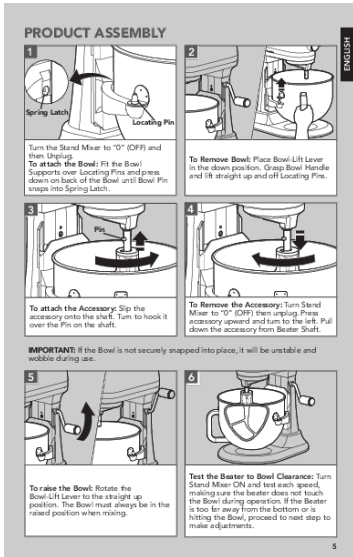

[\[pdf\]](#) Guide Accessories

User Guide KitchenAid 5 Quart Bowl Lift Polished Stainless Steel with Flat Handle K5ASBP Silver Electric Mixer Replacement Parts Home Kitchen 91rufhxnPYL m media amazon images I |||

ENGLISH PRODUCT ASSEMBLY 1 2 0 .5 1 2 3 4 5 6 7 8 9 10 Spring Latch Locating Pin Turn the Stand Mixer to 0 OFF and then Unplug. To attach the Bowl: Fit the Bowl Supports over Locating Pins and press down on back of the Bowl until Bowl Pin snaps into Spring Latch. 3 Pin To Remove Bowl: Pl...

lang:en score:31 filesize: 632.08 K page\_count: 5 document date: 2023-04-27

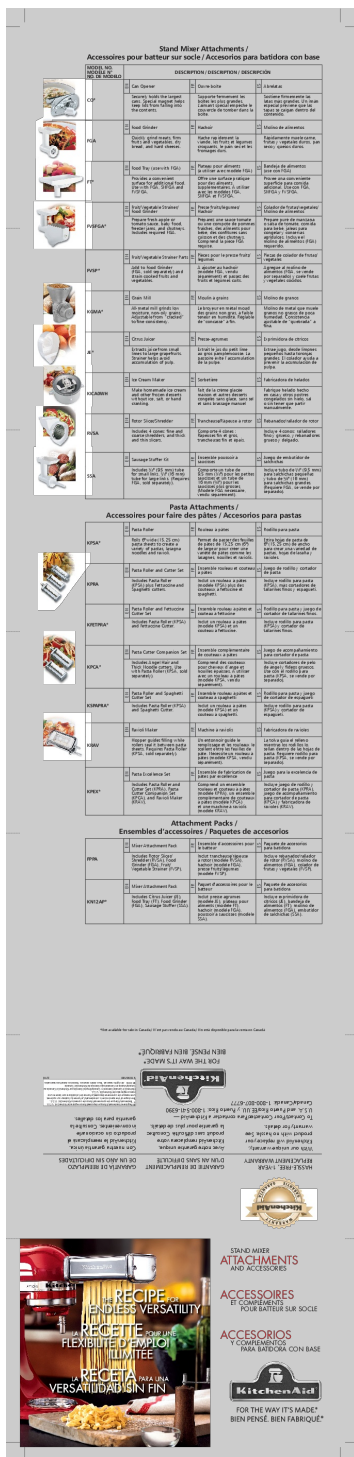

[pdf]

untitled Guía de accesorios KSM150PS KitchenAid KSM150PSOB ElectroDomesticos do

electrodomesticos guia ksm150ps dl file id 229 product 556 |||

Stand Mixer Attachments / Accessoires pour batteur sur socle / Accesorios para batidora con base MO ... able cepillado de 5 cuartos 4,7 L con manija 5 Qt 4.7 L Polished Stainless Bowl with Handle **K5ASBP** Bol 4, 7 L 5 pte en acier inoxydable poli avec poigne Tazn inoxidable pulido de 5 cuart...

lang:es score:18 filesize: 18.23 M page\_count: 2 document date: 2010-03-04



## Inovasi dari Dapur

Alat dan bahan dapur inovatif, berkualitas premium untuk profesional food & beverages. Katalog ini berisi daftar alat dan bahan-bahan bermerek asli, berbahan food grade, dan bergaransi.

Semua produk dalam katalog ini distribusikan secara resmi oleh SerataFoods.

Edisi: Juli- Desember 2019

SERATA  
FOODS  
www.seratafoods.com

[pdf] Catalog

OFFLINE CATALOG PART2 DADgAdfhkqg BADWloqVxGQ Fandi Sido Download Katalog

SERATAFOODS 2 merged 904 cdn shopify s files 1 0003 5068 3180 |||

PRODUCT CATALOG Inovasi dari Dapur Alat dan bahan dapur inovatif, berkualitas premium untuk profesi ... Roller KSM1APC Spiralizer JE Citrus Juicer KSM1FPA Food Processor K5THSBP S/S Bowl 4,8L K5GBF **K5ASBP** Frosted Glass Bowl S/S Bowl - KPM-K5 KSMC7QEW 6,9L Bowl K5WW Wire Whip - KPM-K5 K5AB Flat...

lang:id score:11 filesize: 3.18 M page\_count: 56 document date: 2019-08-13

