

[manuals.plus](#) /

› [Volkswagen](#) /

› [Volkswagen New Beetle Service Manual: 1998, 1999, 2000, 2001, 2002, 2003, 2004, 2005, 2006, 2007, 2008, 2009, 2010:
Including Convertible](#)

Volkswagen New Beetle

Volkswagen New Beetle Service Manual: 1998-2010

Including Convertible Models

INTRODUCTION

This service manual provides comprehensive maintenance, service, and repair information for Volkswagen New Beetle models manufactured from 1998 to 2010, including convertible variants. It is designed to assist both professional technicians and do-it-yourself Volkswagen owners in understanding, caring for, and repairing their vehicles.

The manual emphasizes the importance of proper service procedures to ensure the longevity and optimal performance of your Volkswagen New Beetle.

Volkswagen New Beetle

Service Manual

1998, 1999, 2000, 2001, 2002, 2003, 2004
2005, 2006, 2007, 2008, 2009, 2010
including Convertible



B BentleyPublishers™
.com

Image: Front cover of the Volkswagen New Beetle Service Manual, displaying the title and two yellow New Beetle cars.

Using This Manual

This manual is structured to provide clear, step-by-step instructions for various service and repair tasks. It includes detailed explanations, diagrams, and illustrations to guide users through complex procedures.

- **Navigation:** Chapters are organized by vehicle system (e.g., Engine, Transmission, Brakes).

- **Safety First:** Always observe all safety precautions and warnings provided before beginning any work.
- **Tools and Equipment:** Refer to the specific tool requirements for each procedure.
- **Specifications:** Consult the specifications section for torque values, fluid capacities, and other critical data.

Volkswagen

New Beetle 1998 ▶ 2010

Service Manual (NB)



Service to Volkswagen owners is of top priority to the Volkswagen organization and has always included the continuing development and introduction of new and expanded services. Whether you're a professional or a do-it-yourself Volkswagen owner, this manual will help you understand, care for, and repair your Volkswagen.

Although the do-it-yourself Volkswagen owner will find this manual indispensable as a source of theory of operation and step-by-step maintenance and repair information, the Volkswagen owner who has no intention of working on his or her car will find that reading and owning this manual will make it possible to discuss repairs more intelligently with a professional technician.



See how to perform routine maintenance procedures, such as checking fluids.
03 Maintenance

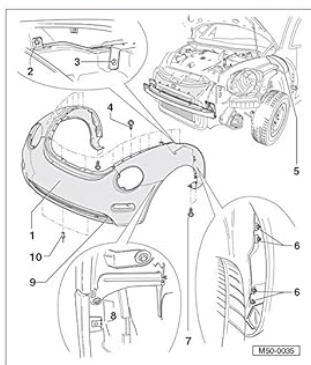

Fully detailed exploded views including front body assembly.
50 Body-Front

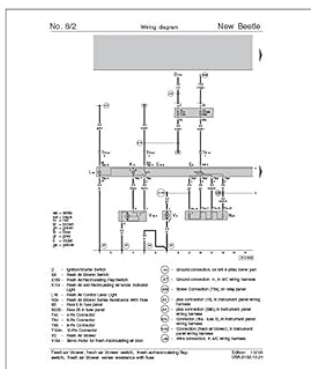

Comprehensive electrical wiring diagrams.
EWD Electrical Wiring Diagrams

Features:

- Maintenance procedures for everything from routine oil changes to replacing key battery in remote control. This manual tells you what to do and how and when to do it.
- Engine and cylinder head service, repair and reconditioning, including camshaft timing belt replacement.
- Explanation of Motronic 5.9.2, ME7 and Diesel Turbo Direct Injection (TDI) engine management systems.
- Emission control tests, repairs and adjustments, including Exhaust Gas Recirculation (EGR) and Secondary Air Injection (AIR) system.
- Drivetrain maintenance, troubleshooting, adjustment and repair, including hydraulic clutch, gearshift linkage, and drive axles.
- Suspension component replacement, including front struts, rear shocks, rear coil springs, and wheel bearing/hub units.
- Coverage of ABS/EDL/ASR/ESP brake and drivetrain systems.
- Heating and air conditioning repair, including A/C component replacement.
- Body adjustment and repairs, including front and rear clip removal and installation.
- Wiring schematics, fuse/relay locations and a general explanation of electrical circuitry.
- Comprehensive Volkswagen factory tolerances, wear limits, adjustments, and tightening torques that you've come to expect from Bentley manuals.

Engines:

- 1.8L turbo gasoline (engine code: APH, AWV, AWP, BKF, BNU)
- 1.9L TDI diesel (engine code: ALH, BEV)
- 2.0L gasoline (engine code: AEG, AVH, AZG, BDC, BEV, BGD)
- 2.5L gasoline (engine code: BPR, BPS)

Transmissions:

- 02J 5-speed manual
- 02M 5- and 6-speed manual
- 0A4 5-speed manual
- 01M 4-speed automatic
- 09G 6-speed automatic
- 02E 6-speed direct shift gearbox (DSG)

ISBN 978-0-8376-1640-7



9 780837 616407

VB10

BentleyPublishers™
.com

Automotive Reference™

1734 Massachusetts Avenue
Cambridge, MA 02138 USA
800.423.4595 / 617.547.4170

VB10-02

Image: Back cover of the service manual, highlighting key features such as maintenance procedures, engine and transmission explanations, wiring diagrams, and body assembly information.

MAINTENANCE

Regular maintenance is crucial for the reliability and performance of your Volkswagen New Beetle. This section outlines routine service intervals and procedures.

Routine Maintenance Procedures:

- Oil and Filter Changes
- Tire Rotation and Inspection
- Brake System Checks
- Fluid Level Inspections (coolant, brake fluid, power steering fluid)
- Air Filter Replacement
- Spark Plug Inspection/Replacement
- Timing Belt Service (as per manufacturer's schedule)

Detailed instructions for each maintenance task, including required tools and torque specifications, are provided within the relevant chapters of the manual.

TROUBLESHOOTING

This section provides guidance on diagnosing common issues that may arise with your Volkswagen New Beetle. It includes diagnostic flowcharts and symptom-based troubleshooting tables.

Common Issues and Diagnostics:

- **Engine Performance Issues:** Rough idle, misfires, lack of power.
- **Brake System Malfunctions:** Squealing, grinding, soft pedal.
- **Electrical System Problems:** Non-functional lights, power windows, or radio.
- **Suspension and Steering Noises:** Clunking, creaking, excessive play.
- **Transmission Shifting Problems:** Hard shifts, delayed engagement.

For detailed diagnostic procedures and repair steps, refer to the specific system chapters in the manual. Always use appropriate diagnostic tools and follow safety guidelines.

SPECIFICATIONS

This section provides key technical specifications for the Volkswagen New Beetle models covered by this manual (1998-2010).

Engines Covered:

- **1.8L Turbo Gasoline:** Engine codes APH, AWV, AWP, BKF, BNU
- **1.9L TDI Diesel:** Engine codes ALH, BEW
- **2.0L Gasoline:** Engine codes AEG, AVH, AZG, BDC, BEV, BGD
- **2.5L Gasoline:** Engine codes BPR, BPS

Transmissions Covered:

- **02J:** 5-speed manual
- **02M:** 5- and 6-speed manual
- **0A4:** 5-speed manual
- **01M:** 4-speed automatic
- **09G:** 6-speed automatic
- **02E:** 6-speed direct shift gearbox (DSG)

General Specifications:

- **Publication Date:** September 1, 2010
- **Print Length:** 1664 pages
- **Language:** English
- **Item Weight:** 7.55 pounds
- **Dimensions:** 8.8 x 2.7 x 11.2 inches
- **ISBN-10:** 0837616409
- **ISBN-13:** [978-0837616407](#)

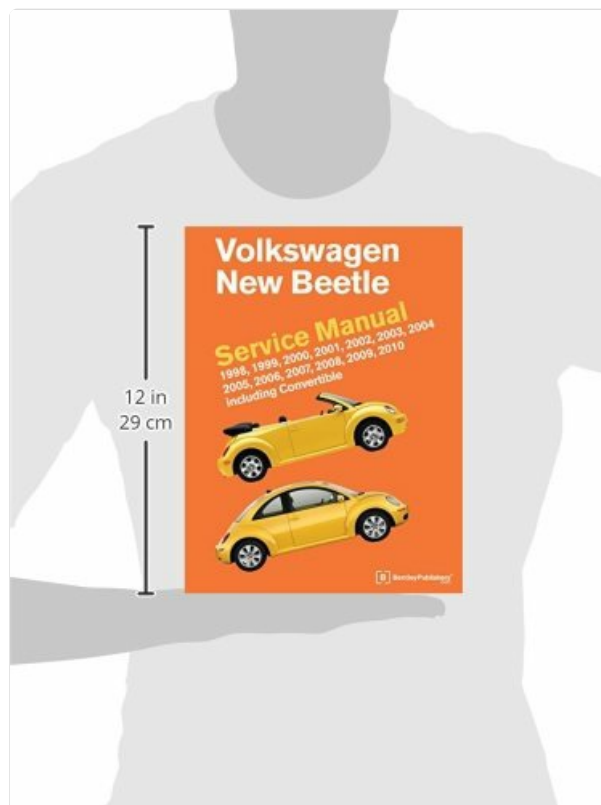

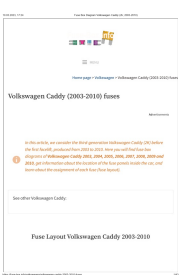

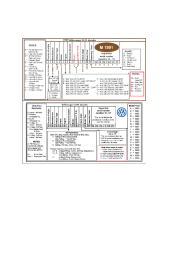
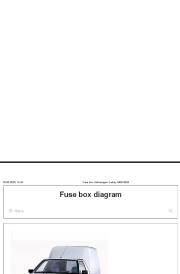

Image: The service manual displayed next to a ruler, illustrating its physical dimensions of approximately 12 inches (29 cm) in height.

© 2024 Volkswagen New Beetle Service Manual. All rights reserved.

Published by Bentley Publishers.

Related Documents - New Beetle

	<p>Volkswagen New Beetle (1998-2011) Fuse Box Diagrams and Relay Assignments</p> <p>Comprehensive guide detailing fuse box locations, fuse diagrams, and relay assignments for the Volkswagen New Beetle models manufactured between 1998 and 2011. Includes fuse color codes, amperage ratings, and specific component functions.</p>
	<p>Volkswagen Workshop Manual: Wheels and Tyres Guide for Bora, Golf, Lupo, New Beetle, Passat, Polo, Sharan, Touareg, Vento Models</p> <p>Comprehensive Volkswagen Workshop Manual and Wheels and Tyres Guide, providing detailed technical information on wheel and tyre maintenance, repair, and geometry for various VW models including Bora, Golf, Lupo, New Beetle, Passat, Polo, Sharan, Touareg, and Vento, covering editions up to 2010.</p>
	<p>Volkswagen Caddy (2003-2010) Fuse Box Diagrams and Layout</p> <p>Detailed guide to the fuse box diagrams and fuse assignments for the Volkswagen Caddy (2K) models produced between 2003 and 2010. Find fuse locations and functions.</p>
	<p>Volkswagen Golf IV / Bora (mk4; 1997-2004) Fuse and Relay Diagrams</p> <p>Comprehensive guide to the fuse box diagrams, locations, and assignments for Volkswagen Golf IV and Bora (mk4) models manufactured between 1997 and 2004. Includes details on instrument panel fuses, battery fuses, and relay configurations.</p>
	<p>Volkswagen VIN Decoder Guide: Understanding Vehicle Identification Numbers (2001-2007)</p> <p>A comprehensive guide to decoding Volkswagen Vehicle Identification Numbers (VINs) from 2001 to 2007. Learn the meaning of each VIN position, model year codes, restraint systems, engine types, assembly plants, and model codes.</p>
	<p>Volkswagen Caddy 1996-2003 Fuse Box and Relay Diagram</p> <p>Detailed guide to the fuse box and relay locations and functions for the Volkswagen Caddy models from 1996 to 2003. Includes diagrams and circuit protection information for passenger and engine compartments. Source: fusesdiagram.com</p>

