

Anchor Paperback

Lullaby: An Engagement Guide

By Chuck Palahniuk

INTRODUCTION

NATIONAL BESTSELLER From the author of the New York Times bestseller *Choke* and the cult classic *Fight Club*, a cunningly plotted novel about the ultimate verbal weapon, one that reinvents the apocalyptic thriller for our times. “A harrowing and hilarious glimpse into the future of civilization.” —Minneapolis Star-Tribune Ever heard of a culling song? It’s a lullaby sung in Africa to give a painless death to the old or infirm. The lyrics of a culling song kill, whether spoken or even just thought. You can find one on page 27 of *Poems and Rhymes from Around the World*, an anthology that is sitting on the shelves of libraries across the country, waiting to be picked up by unsuspecting readers. Reporter Carl Streator discovers the song’s lethal nature while researching Sudden Infant Death Syndrome, and before he knows it, he’s reciting the poem to anyone who bothers him. As the body count rises, Streator glimpses the potential catastrophe if someone truly malicious finds out about the song. The only answer is to find and destroy every copy of the book in the country. Accompanied by a shady real-estate agent, her Wiccan assistant, and the assistant’s truly annoying ecoterrorist boyfriend, Streator begins a desperate cross-country quest to put the culling song to rest.

NATIONAL BESTSELLER

Lullaby

Chuck

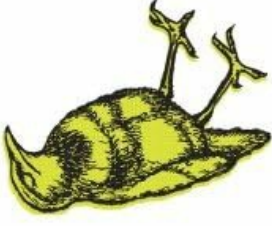

Palahniuk

AUTHOR OF
Fight Club and *Choke*

"A story so eccentric and complex that you begin to understand why
Palahniuk's literature is a breed all its own." — *USA Today*

The cover of 'Lullaby' by Chuck Palahniuk, depicting the title in elegant script with a subtle, unsettling illustration of a deceased bird, reflecting the novel's dark themes.

1. PREPARING FOR ENGAGEMENT

1.1 Optimal Reading Environment

To fully immerse yourself in the narrative of 'Lullaby', consider establishing an environment conducive to deep reading. Minimize external distractions to allow for complete focus on the text.

- **Quiet Space:** Select a location free from interruptions and excessive noise.
- **Comfortable Seating:** Ensure a comfortable posture to sustain prolonged reading sessions.
- **Adequate Lighting:** Provide sufficient light to prevent eye strain.

1.2 Mindset Preparation

Chuck Palahniuk's works often challenge conventional perspectives. Approaching 'Lullaby' with an open mind will enhance your experience.

- **Openness to Unconventional Narratives:** Be prepared for a non-linear or abstract storytelling style.
- **Readiness for Mature Themes:** The novel explores dark and potentially disturbing subjects; reader discretion is advised.
- **Engagement with Social Commentary:** The text often contains satirical elements and critiques of modern society.

2. ENGAGING WITH THE NARRATIVE

2.1 Reading Techniques



The narrative structure of 'Lullaby' benefits from attentive reading.

- **Sequential Reading:** Follow the story from beginning to end to grasp the unfolding plot.
- **Attention to Detail:** Small details often carry significant meaning or foreshadow future events.
- **Re-reading:** Consider re-reading certain passages or the entire novel to uncover deeper layers of meaning and symbolism.

2.2 Understanding Themes and Symbolism

'Lullaby' delves into several profound themes, often presented through dark humor and satire. Key themes include the power of language, societal control through distraction, the nature of good and evil, and the search for meaning in a chaotic world. The

Related Documents - Paperback

	InnovaGoods Portable Complete Training System User Manual User manual for the InnovaGoods Portable Complete Training System, detailing contents, instructions for use, accessories, and safety warnings in multiple languages.
	Danley Sound Labs OS12CX 2-Way Outdoor Loudspeaker Specifications and Details Comprehensive specifications, performance data, and dimensional drawings for the Danley Sound Labs OS12CX 2-Way Outdoor Loudspeaker, including details on its Synergy crossover network, power handling, sensitivity, and available mounting accessories.

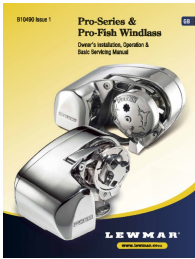

[Lewmar Pro-Series & Pro-Fish Windlass: Owner's, Installation, Operation & Servicing Manual](#)

Comprehensive manual for Lewmar Pro-Series and Pro-Fish windlasses, covering installation, electrical wiring, operation, maintenance, troubleshooting, and warranty information. Includes detailed specifications and parts lists.



[Assembly Instructions for Chest](#)

Comprehensive assembly instructions for a chest, including tools required, pre-assembly tips, care advice, parts list, hardware details, and wall mounting guidance.

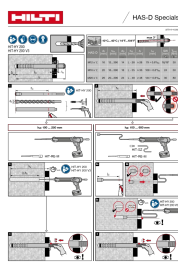

[Hilti HAS-D Specials Installation Guide](#)

This document provides installation instructions for Hilti HIT-HY 200 and HIT-HY 200 V3 HAS-D Specials, including technical specifications and usage guidelines.

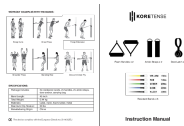

[KoreTense Resistance Bands Instruction Manual](#)

A comprehensive guide to using KoreTense resistance bands for effective workouts, including safety information, setup instructions, and exercise examples.