



ASALL001-APP Smart Music LED Ceiling Light with Speaker Installation Guide

[Home](#) » [ASALL](#) » ASALL001-APP Smart Music LED Ceiling Light with Speaker Installation Guide 

ASALL001-APP Smart Music LED Ceiling Light with Speaker Installation Guide



Contents

- [1 Remote control instruction](#)
- [2 Download the APP registration](#)
- [3 Connect the device to the internet](#)
- [4 How to connect the device to Amazon Alexa](#)
- [5 How to connect the device to Google Assistant](#)
- [6 Documents / Resources](#)
 - [6.1 References](#)
- [7 Related Posts](#)

Remote control instruction

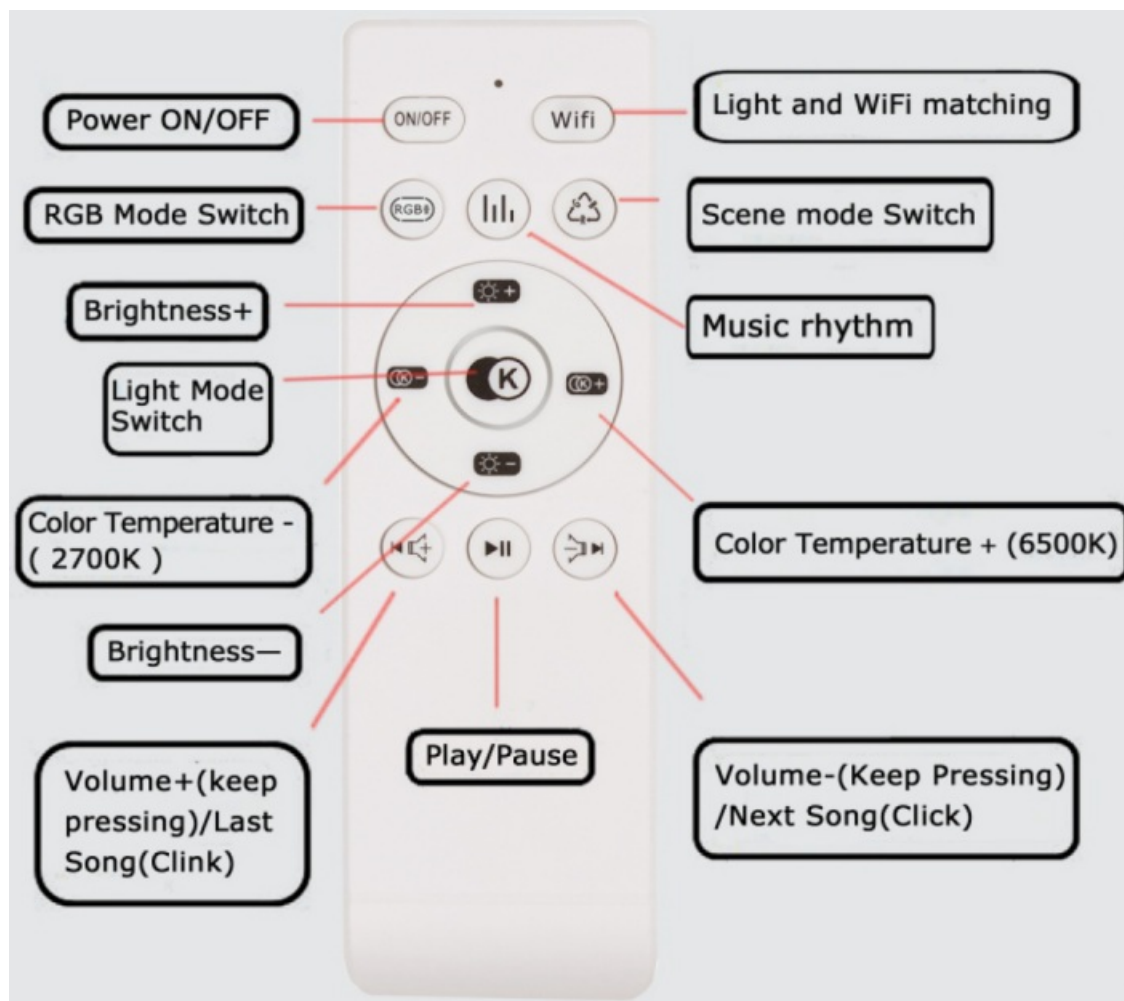

Remote Control Tips

1. **Battery** : 2PCS AAA batteries
2. **How to pair remote:**

Within 5 seconds after the lamp is powered on, press the pairing key and then click the WiFi button until the lamp flashes; Long press the WiFi button and the light keeps flashing to enter the network matching mode.

Bluetooth Connection

For the first time you use it or never pair with "MX-light" after moving the equipment, please have it paired according to the steps below.

Music Connection

Enter the System Settings – Bluetooth – to discover and connect the device name "MX-light". Once connected, you will hear the connection tone. The initial password is 1111.

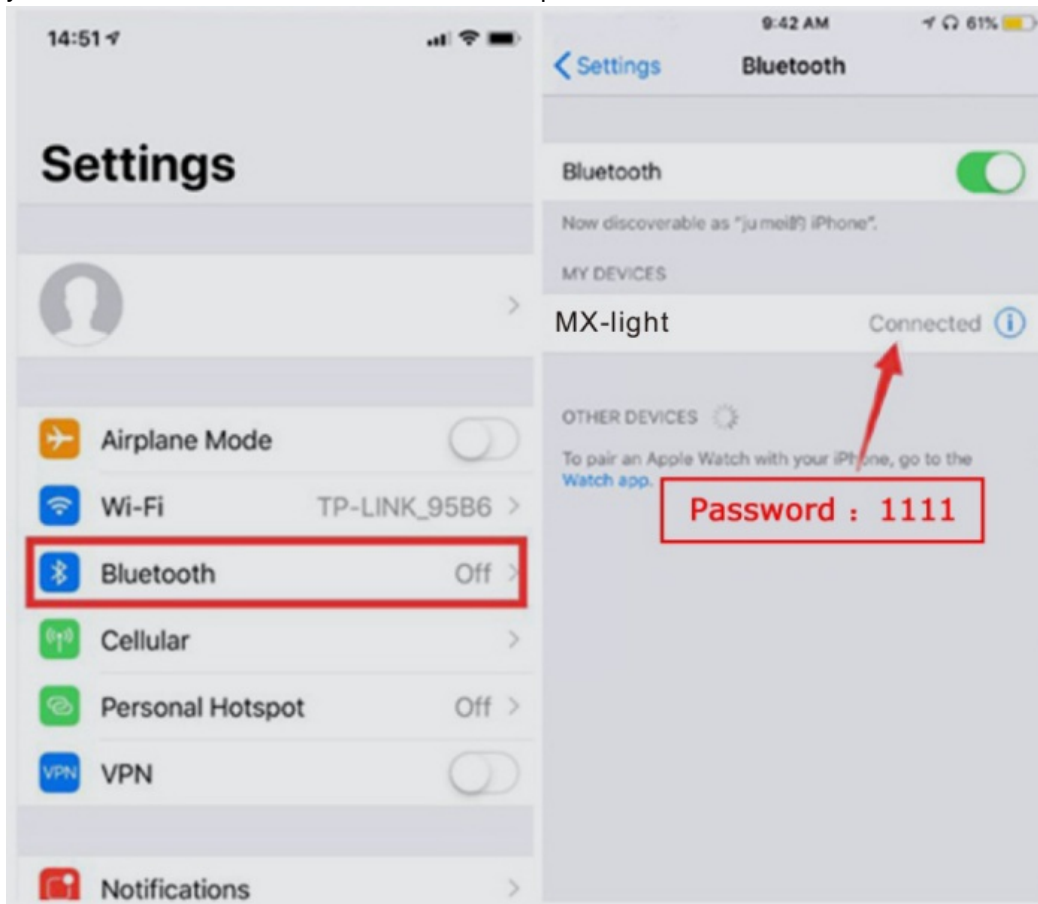

Download the APP registration

1. Search the keyword "Tuya Smart" in APP Store or Google Play to download the APP
2. Open the APP and register an account to login.



Tuya Smart

Connect the device to the internet

1. Power on the light and ensure your mobile device's Wi-Fi is turned on and is connected to your home Wi-Fi Network
Note: 2.4GHz b/g/n networks are compatible, 5GHz networks are not compatible.
2. Tap the add icon "+" in the right and select "Lighting" and "Light Source(BLE+WI-FI)".
3. Select "EZ Mode" in the top right.

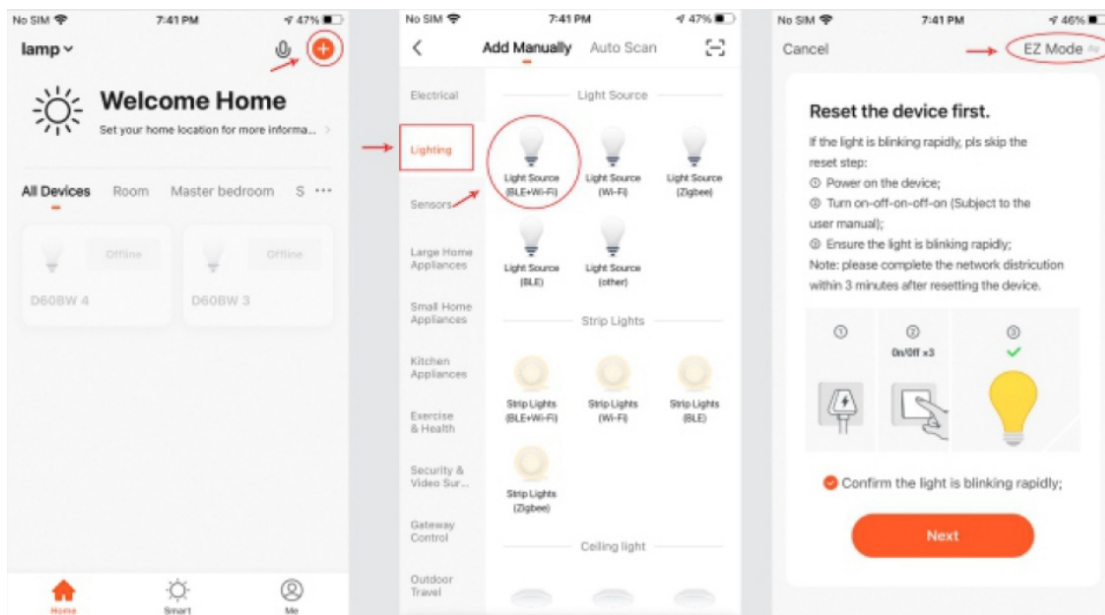

4. Press the "WiFi" button of remote control for 5 seconds, the light will blink this time.
5. Enter your home's wifi in this step, And then connect the phones WiFi to the device's hotspot back to the APP and continue to add devices

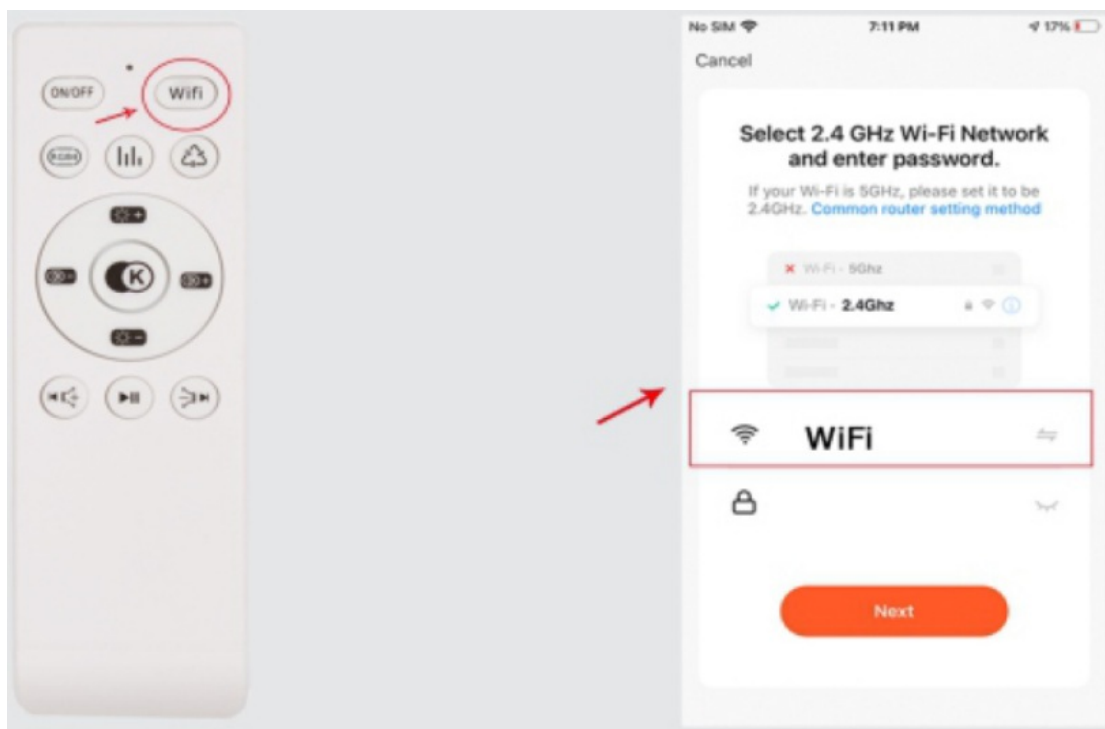

6. The APP will automatically search for nearby WiFi devices.
7. Once the light was initialized successfully, you will be able to quickly control it within the APP.

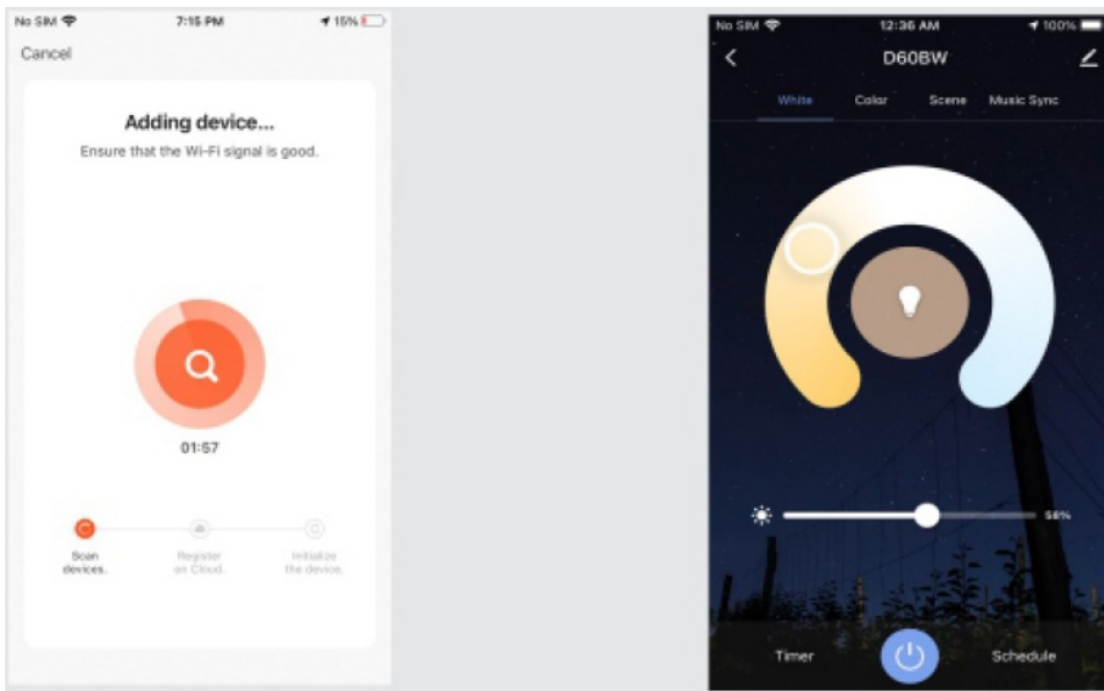

Reminder: The first connection may take a few minutes, please be patient.

How to connect the device to Amazon Alexa

1. Open the Amazon Alexa App, tap "skills" on the menu to go to the Amazon skill store.
2. Search the Skill name "Tuya Smart" in the search bar.
3. Enable the Skill and type in your login information from the App account to finish the account linking.

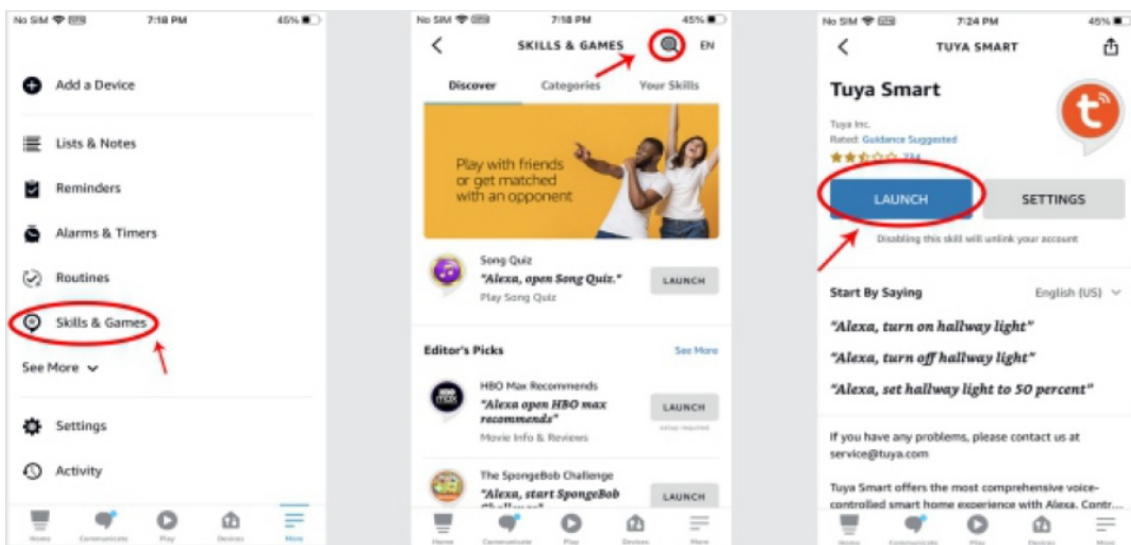

4. Bind the account, open the Tuya Smart APP, and click "My- Third-Party Voice Services-Alexa".

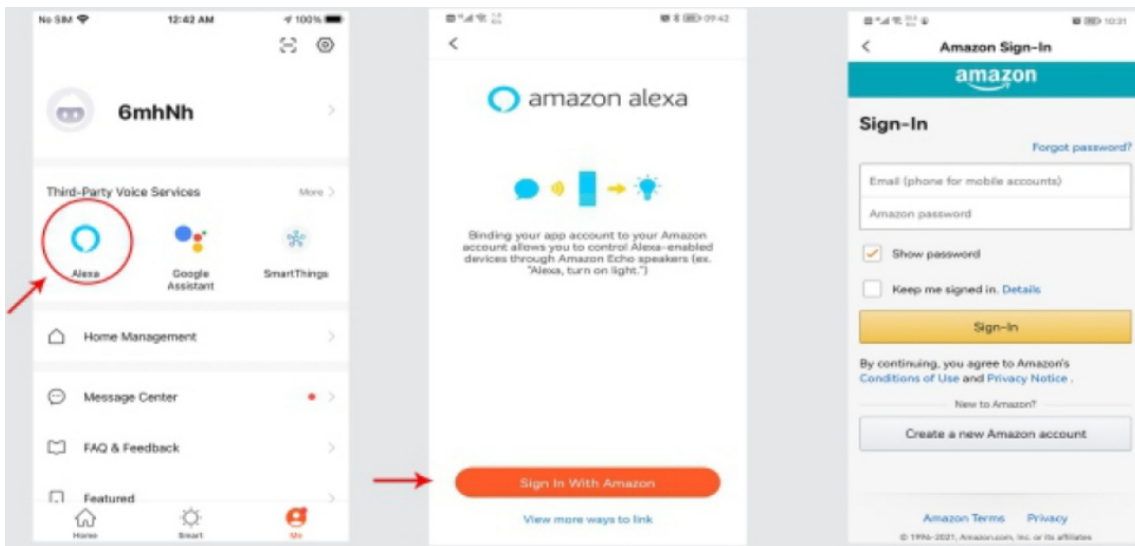

5. Tap “Discover Devices” to sync your devices to Alexa, after about 20s, the devices will be discovered and Alexa will tell you “I found xx devices”, then you can control your devices using voice through your Amazon Alexa devices.

The following voice commands are supported:

Alexa, turn on/off “xxx”

Alexa, set the “xx” to [color] Alexa, set the “xx” to [percentage] Alexa, set the brightness of “xxx” [percentage]

How to connect the device to Google Assistant

1. On the homepage of Google Home App, click the “+” button in the upper left corner, select “Set up device”, and select “Have something already set up” under the “Set up” list.

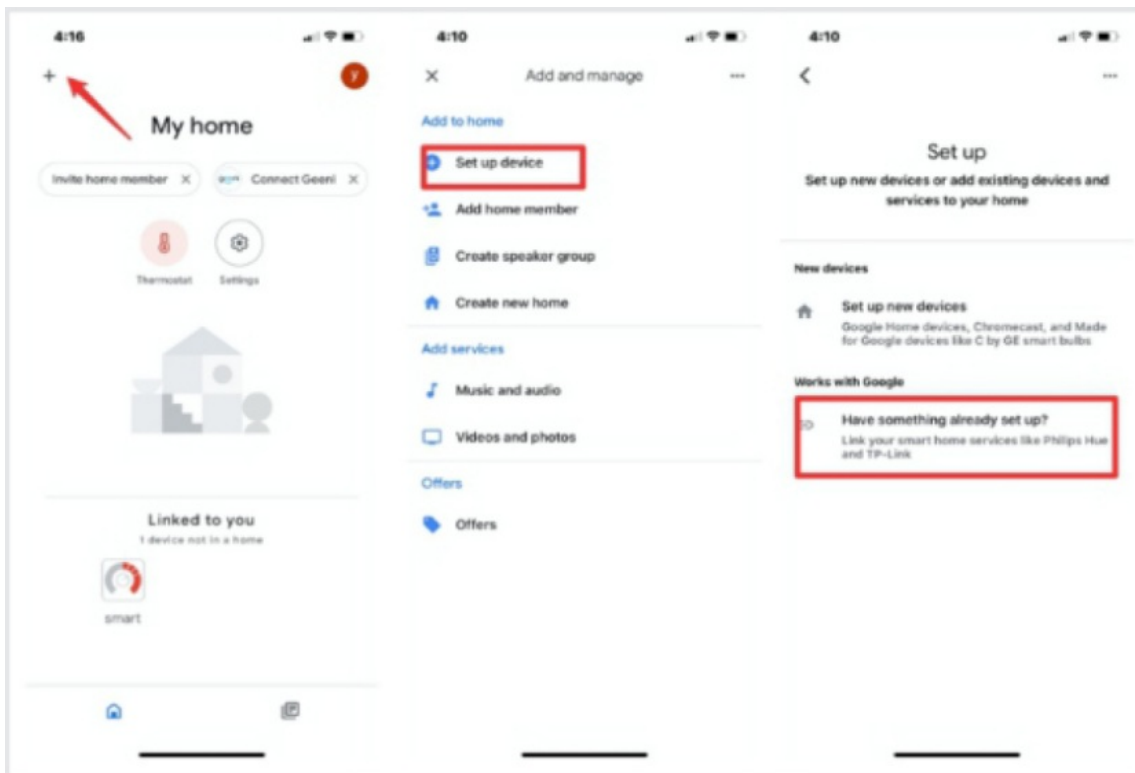

2. Find Tuya Smart in the list and open it. On the new page, select the country where your Smart Life App account is located, enter your Tuya Smart App account and password, and click Link Now. After binding, your device will appear in the Devices list of Home Control.

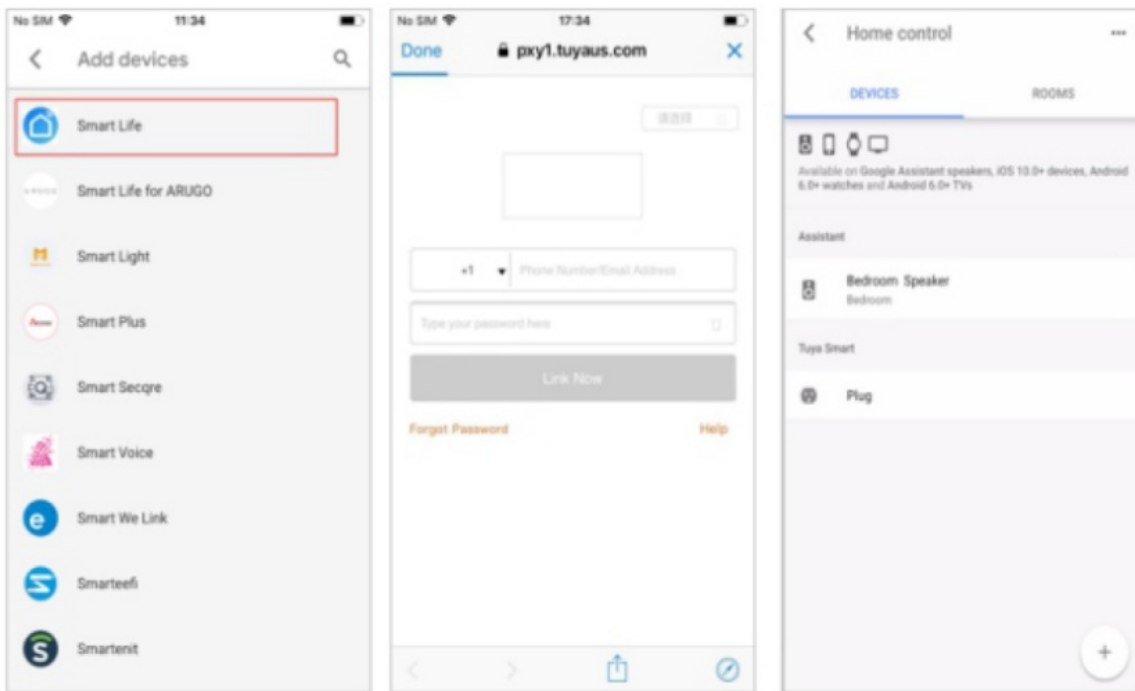

3. Bind the account, open the Tuya Smart App, and click “Me-More Services-Google Assistant””

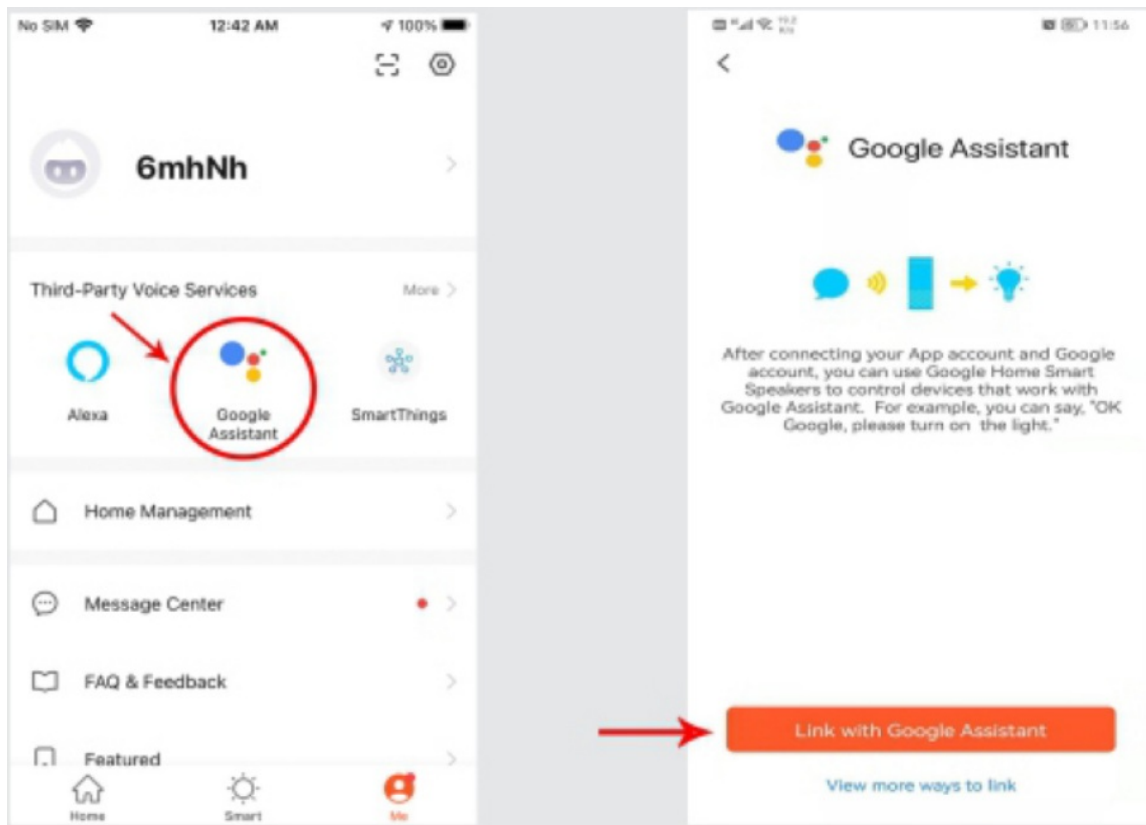

4. Now, you can use Google Home to control your smart device.

Take bedroom light as an example, the supported commands include (Google Home currently only supports English commands):

- Ok Google, turn on bedroom light. (Switch lights or other devices)
- Ok Google, turn off bedroom light. (Switch lights or other devices)
- Ok Google, set bedroom light to 50 percent. (Set the light to any brightness)
- Ok Google, brighten bedroom light. (turn the light on)
- Ok Google, dim bedroom light. (Dim the light)
- Ok Google, set bedroom light to red. (Set the color of the light, only color lights support)

Documents / Resources

	<p>ASALL ASALL001-APP Smart Music LED Ceiling Light with Speaker [pdf] Installation Guide</p> <p>ASALL001-APP Smart Music LED Ceiling Light with Speaker, ASALL001-APP, Smart Music LED Ceiling Light with Speaker, Ceiling Light with Speaker, Light with Speaker</p>
---	--

References

- [User Manual](#)