

artopex RC3 Reception Desk Instruction Manual

[Home](#) » [artopex](#) » artopex RC3 Reception Desk Instruction Manual 

Contents

- 1 artopex RC3 Reception Desk
- 2 Assembly Instructions
- 3 IMPORTANT NOTE:
- 4 Product Specifications
- 5 Product Usage Instructions
 - 5.1 Assembly Steps:
 - 5.2 Completed Assembly:
- 6 Frequently Asked Questions (FAQ)
 - 6.1 Q: How many people are required for assembling the RC3 RECEPTION DESK?
 - 6.2 Q: Are there any specific tools needed for assembly?
- 7 Documents / Resources
 - 7.1 References
- 8 Related Posts

artopex RC3 Reception Desk

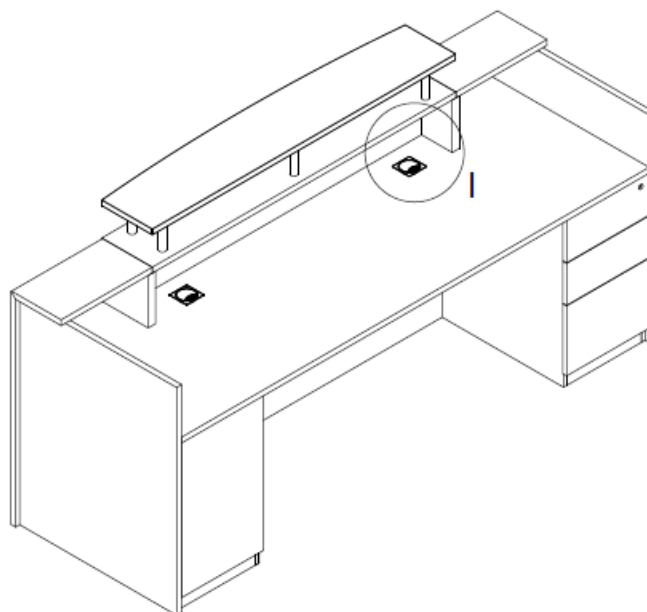

INSTRUCTION MANUAL

Assembly Instructions

MODEL NO.: RC3 RECEPTION DESK

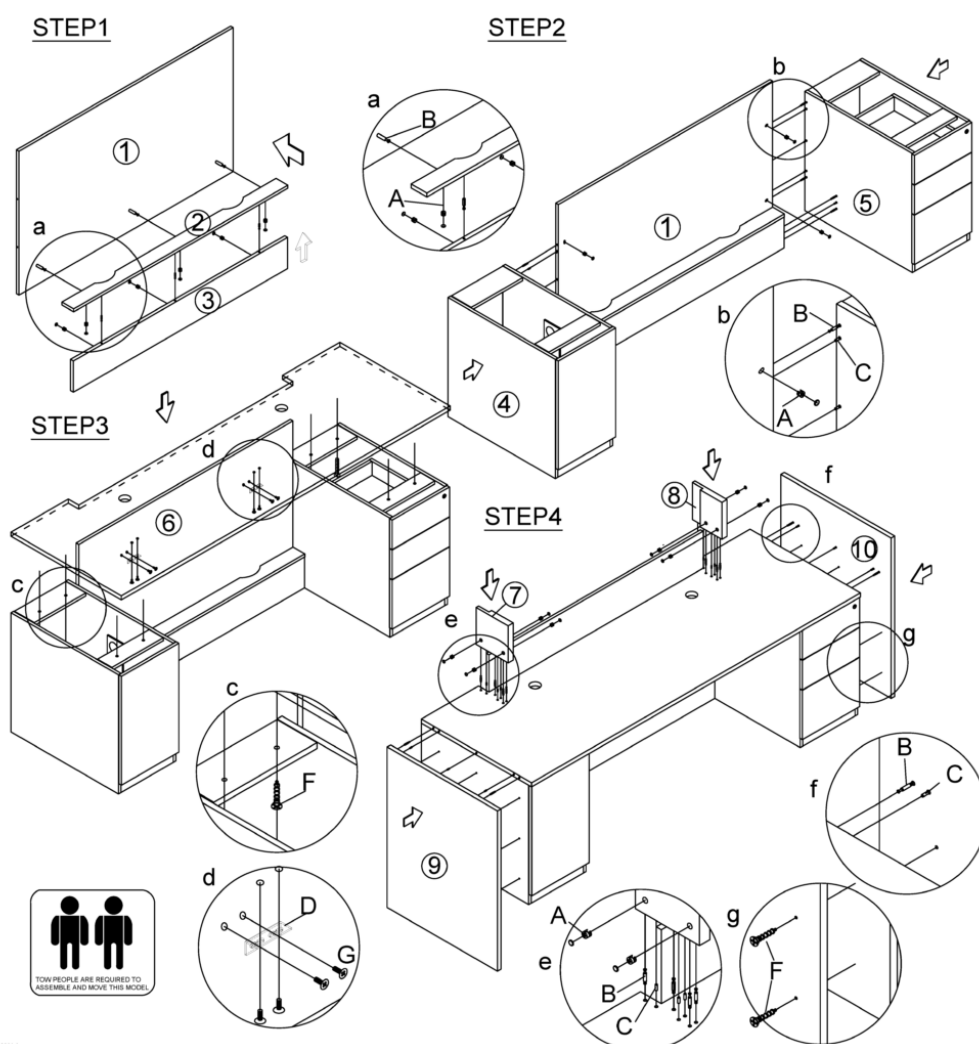

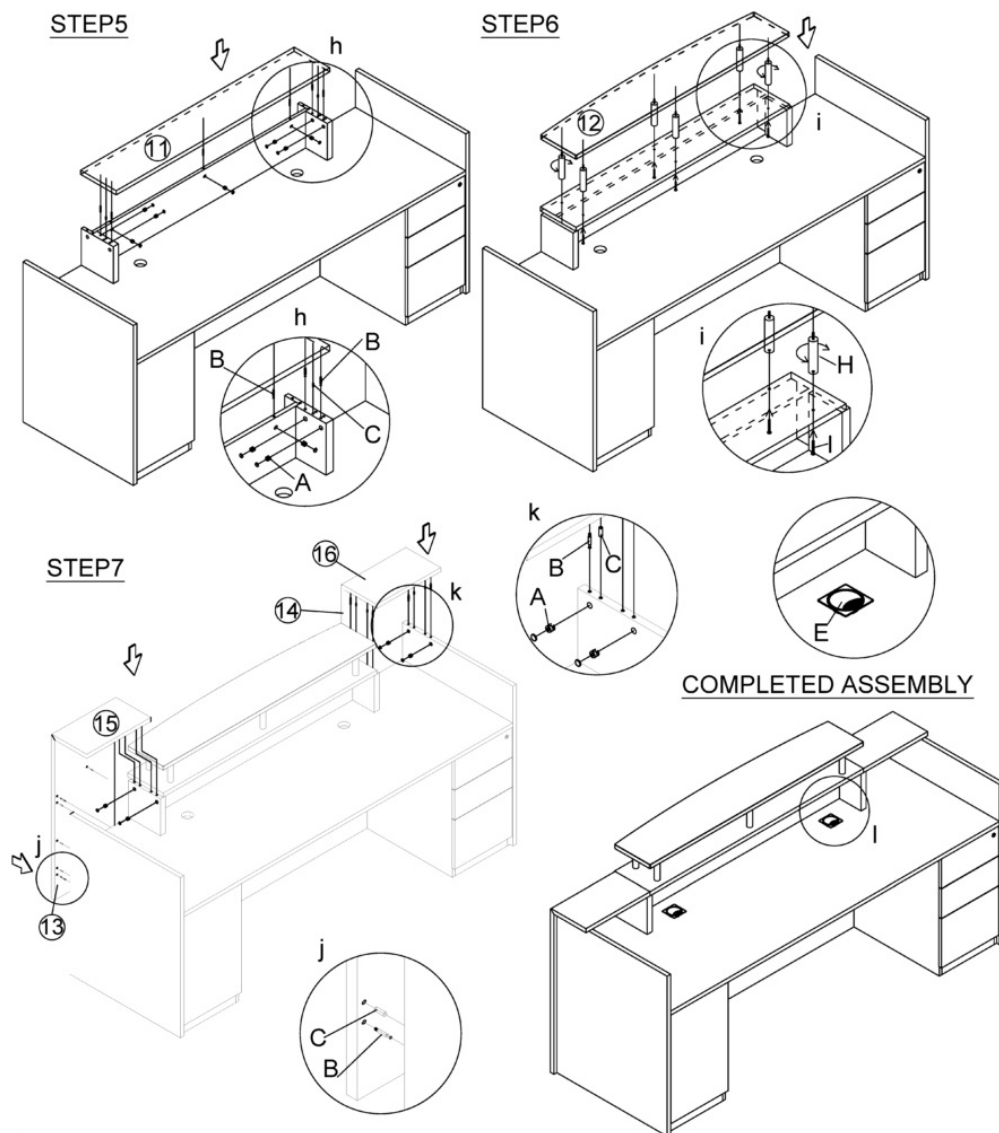

IMPORTANT NOTE:

- Place all parts on a clean and smooth surface such as a rug or carpet to avoid the parts from being scratched.
- Check to be sure that you have all parts and hardware.
- Remove all wrapping materials, including staples & packing straps before you start to assemble.
- Don't tighten all screws/bolts until all completely assembled.
- Keep all hardware parts out of reach of children

Product Specifications

- Model No.: RC3 RECEPTION DESK
- Number of Pieces: 54 (Set), 54 (Pcs)

Product Usage Instructions

Assembly Steps:

1. Step 1:
 - Arrange parts A, B, C, D, E, F, G, H, I as indicated.
 - Use 44 pieces to complete this step.
2. Step 2:
 - Combine parts a and B.
 - Set up 6 sets with part b.
 - Use 2 pieces for this step.
3. Step 3:
 - Arrange parts a, b, c, d, e, f as shown.
4. Step 4:
 - Follow the instructions to assemble parts 7, 8, 9, 10.
5. Step 5: Complete the assembly according to the provided diagram.
6. Step 6: Assemble parts h, i, and follow the sequence for completion.
7. Step 7:
 - Finish assembly with parts h, B, i, H, C, I, A, k, BC, k, A, E.

Note:

Two people are required to assemble and move this model effectively.

Completed Assembly:

After following all steps, the assembly should be completed with parts j and l in place as per the diagram.

Frequently Asked Questions (FAQ)

Q: How many people are required for assembling the RC3 RECEPTION DESK?

A: Two people are required for assembling and moving this model.

Q: Are there any specific tools needed for assembly?

A: The assembly can be done using the provided parts without the need for additional tools.

Documents / Resources

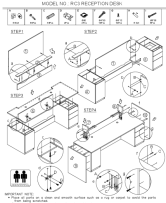
	<p>artopex RC3 Reception Desk [pdf] Instruction Manual RC3, RC3 Reception Desk, Reception Desk, Desk</p>
---	--

References

- [User Manual](#)

[Manuals+](#), [Privacy Policy](#)

This website is an independent publication and is neither affiliated with nor endorsed by any of the trademark owners. The "Bluetooth®" word mark and logos are registered trademarks owned by Bluetooth SIG, Inc. The "Wi-Fi®" word mark and logos are registered trademarks owned by the Wi-Fi Alliance. Any use of these marks on this website does not imply any affiliation with or endorsement.