



Array By Hampton Revive Connected Deadbolt for Apartment Dwellers Installation Guide

[Home](#) » [Array By Hampton](#) » Array By Hampton Revive Connected Deadbolt for Apartment Dwellers Installation Guide 

Array By Hampton Revive Connected Deadbolt for Apartment Dwellers Installation Guide



Contents

- [1 Over view](#)
- [2 In the Box](#)
- [3 Contact US](#)
- [4 Setup](#)
- [5 IC Warning](#)
- [6 FCC Caution](#)
- [7 Documents / Resources](#)
- [8 Related Posts](#)

Over view

REVIVE lock upgrades your existing lock by replacing the interior assembly only, It attaches to your existing deadbolt easily.

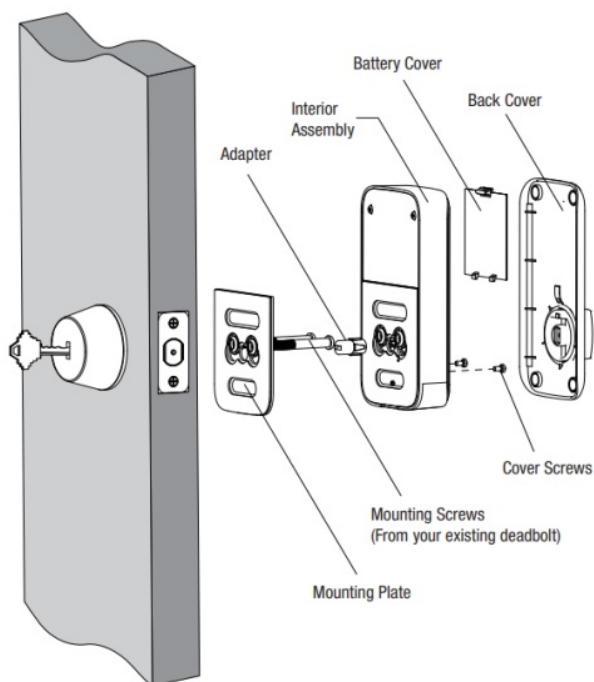

In the Box

REVIVE
Smart Lock

REVIVE Lock
Gateway(Optional)

Lock Adapter &
Mounting Hardware

Adhesive Strip

Reset Tool

Installation Guide

Contact US



For Installation Videos Visit:

www.doorlocks.care

Setup

1. Download the APP

Please download the LaView App from the App Store or Scan the QR Code below. LaView App is available for both iOS and Android OS. Search the name 'LaView' in App Store or Google Play. (The other LaView apps, such as LaView Connect, LaView ONE, LaView Life do NOT support HU06 Smart Deadbolt)



2. Set up LaView H06U

- Click '+' on the top right corner of the App's home page to find your device.
- Follow the in-app instructions and replace your existing thumbturn lock

3. Set up Bluetooth Gateway (Required for remote access)

- Plug the gateway into an outlet near your door (within 50 feet) .
- Click '+' on the top right corner of the App's home page to find your device.
- Follow the in-app instructions in the app to complete setup.

4. Bind the HU06 to the Gateway (Required for remote access)

- In LaView APP, enter the Bluetooth Gateway menu and click ' Add device by list '
- Select the HU06 that has just been added.



Notes

Network configuration should be completed within 3 minutes after factory reset.

IC Warning

This device complies with Industry Canada's licence-exempt RSSs. Operation is subject to the following two conditions:

- (1) This device may not cause interference.
(2) This device must accept any interference, including interference that may cause undesired operation of the device.

This equipment complies with FCC radiation exposure limits set forth for an uncontrolled environment. This equipment should be installed and operated with minimum distance 20cm between the radiator & your body.

This equipment complies with IC radiation exposure limits set forth for an uncontrolled environment. This equipment should be installed and operated with minimum distance 20cm between the radiator & your body.

FCC Caution

This device complies with part 15 of the FCC Rules. Operation is subject to the following two conditions:

- (1) This device may not cause harmful interference.
(2) this device must accept any interference received, including interference that may cause undesired operation.

Any Changes or modifications not expressly approved by the party responsible for compliance could void the user's authority to operate the equipment.

Note: This equipment has been tested and found to comply with the limits for a Class B digital device, pursuant to part 15 of the FCC Rules. These limits are designed to provide reasonable protection against harmful interference in a residential installation. This equipment generates uses and can radiate radio frequency energy and, if not installed and used in accordance with the instructions, may cause harmful interference to radio communications. However, there is no guarantee that interference will not occur in a particular installation. If this equipment does cause harmful interference to radio or television reception, which can be determined by turning the equipment off and on, the user is encouraged to try to correct the interference by one or more of the following measures:

- Reorient or relocate the receiving antenna.
- Increase the separation between the equipment and receiver.
- Connect the equipment into an outlet on a circuit different from that to which the receiver is connected.
- Consult the dealer or an experienced radio/TV technician for help.

FCC Radiation Exposure Statement

This equipment complies with FCC radiation exposure limits set forth for an uncontrolled environment. This equipment should be installed and operated with minimum distance 20cm between the radiator & your body.

Documents / Resources

	<p>Array By Hampton Revive Connected Deadbolt for Apartment Dwellers [pdf] Installation Guide</p> <p>HP101, 2AQY4-HP101, 2AQY4HP101, Revive Connected Deadbolt for Apartment Dwellers, Connected Deadbolt for Apartment Dwellers, Deadbolt for Apartment Dwellers</p>
---	---