



AromaPlan SDPRO2 Pro 2 Scent Diffuser Instruction Manual

[Home](#) » [AromaPlan](#) » AromaPlan SDPRO2 Pro 2 Scent Diffuser Instruction Manual 

AromaPlan™



Scentiment, LLC. Miami, FL. 33122
Pro 2 Scent Diffuser
Instruction Manual

Contents

- 1 [Factory Reset](#)
- 2 [Replacing the Nozzle](#)
- 3 [How to clean the diffuser](#)
- 4 [Safety](#)
- 5 [What's included in the box:](#)
- 6 [Diffuser technical description](#)
- 7 [Features](#)
- 8 [How to use the Diffuser](#)
- 9 [FCC Warning:](#)
- 10 [Documents / Resources](#)
 - 10.1 [References](#)

Factory Reset

To perform a factory reset, follow these steps:

1. Turn your diffuser off.



2. Press the top button for five (05) seconds. The lightbar will blink with blue light, indicating that the factory reset was successful.



3. You can now turn your diffuser back on.



Note: If your diffuser was connected to the Scentiment App, after the reset you will need to pair the diffuser again.

Replacing the Nozzle

In case your Diffuser Scent Diffuser Pro 2 nozzle gets damaged, you can replace it with the spare nozzle that comes with your Diffuser.

Follow these instructions to replace the nozzle:

1. Pull the Scent Diffuser Pro 2 top section (Diffusion Head).



2. Unscrew the oil bottle and set it aside.



3. Remove the nozzle and oil pipe from the diffuser by hand or using a set of tweezers.



4. Install the spare nozzle, making sure it's tight enough to ensure.



5. Screw the fragrance oil bottle in the Diffusion Head.



6. Install the Diffusion Head back on the diffuser.



7. You are ready to use your diffuser.



How to clean the diffuser

For best performance:

If the machine is unused for a while, clean the container with Scentiment's Diffuser Cleaner solution, filling it almost to the top of the oil bottle.

Clean the Scent Diffuser Pro 2 every 1-2 months:

1. Remove the Diffusion Head.



2-Replace the oil bottle with a 120 ml Scentiment Diffuser Cleaner Bottle or fill the provided glass bottle with Scentiment's Diffuser Cleaner and reinstall securely.



3. Install the Diffusion Head back in the Scent Diffuser Pro 2.



4. Let the Diffuser run for two hours to ensure thorough cleaning.



Important Note: Place the diffuser in a very ventilated area when using the Diffuser Cleaner. For your safety, refrain from directly inhaling the mist emitted from the diffuser as it may pose risks to your respiratory system. For general cleaning, use a damp cloth to remove stains and fingerprints.

Safety

Is it safe for kids and animals?

Yes, our fragrance oils are safe to use around people, pets, plants, and furniture. 100% free of all Parabens,

Formaldehyde, Color Additives, Synthetic Dyes, and Preservatives.

Warnings

- Avoid turning over or tilting the product for long periods to prevent damage.
- Don't modify or disassemble it.
- Use within the recommended temperature range of 2°C to 35°C.
- When not in use for a while, remove the oil bottle and store it separately.
- Keep out of reach of children and pets.
- Normal shaking may cause sound due to the anti-dumping device.
- Atomization effect may vary based on the fragrance oil type.
- For optimal results, use fragrance oils.

Warranty

Your device comes with 6 months limited warranty. Please ensure that you have proof of purchase in case a claim arises. Please note that the warranty is non-transferable.

The following will not be covered under warranty:

- Damage caused by accidents or fire.
- Failure to use the device properly.
- If the device is repaired by a non-authorized dealer.
- Third-party parts are used in the machine.

What's included in the box:

- Scent Diffuser Pro 2.
- Remote Control.
- Atomizer Head.
- User Manual.
- USB-C charging cable.
- Empty 120ml Oil Bottle and Cap.
- X2 Magnetic Keys.
- X2 Pear Cotton.
- Spare Oil Pipe.
- Wall Hook Stickers.
- Screw Pack.

Diffuser technical description

- Weight: 1.7 Kg.
- Voltage: DC 12V 1A
- Coverage: 2000 sq ft.
- Oil Bottle Capacity: 200 ml
- Power: 8W

Features



- Effortlessly scent large spaces up to 2,000 sq ft.
- Adjust the intensity to create your perfect ambiance.
- Advanced technology ensures a safe residue-free experience for everyone and everything.

How to use the Diffuser

Power Connection

1. Take your USB-C cable out of the box



2. Connect the Scent Diffuser Pro 2 to the cable.



3. Plug the cable into a power outlet. You will see the front Lightbar turning on in white.



How to add oil to the diffuser

Pair your Scent Diffuser Pro 2 with Scentiment's 120 ml oil bottles.

1. Locate your magnetic key to unlock the Scent Diffuser Pro 2.



2. Place it on the right side of the diffuser, at the center of the marked circle. You will hear a subtle click, indicating that the diffusion head has been unlocked.



3. Pull the Diffusion Head up to reveal the empty oil reservoir.



4. Unscrew the empty bottle.



5. You can pour your favorite Scentiment oil in the bottle or use Scentiment's 120ml bottles directly.



6. After filling the bottle or replacing it with your desired oil bottle, screw it back to the diffusion head and install it back in the Scent Diffuser Pro 2.



7. You can now enjoy your scenting experience.



How to Use the Diffuser

To turn on/off the device press and hold the top power button for 2 secs.



Misting Intensity Settings.

The Intensity Level can be changed by pressing the top intensity button.

- **Low:** It will mist for 15 seconds and then remain dormant for 90 seconds.



- **Medium:** It will mist for 30 seconds and then remain dormant for 60 seconds.



- **High:** It will mist for 60 seconds and then remain dormant for 30 seconds.



Connect your diffuser to Scentiment App

1. Scan the code to download the app.

 	 
https://www.scentiment.com/pages/go?qrcode=scentiment-app-download-ios	https://www.scentiment.com/pages/go?qrcode=scentiment-app-download-play

2. Turn your diffuser on.



3. Open Scentiment App



4. Create an account.

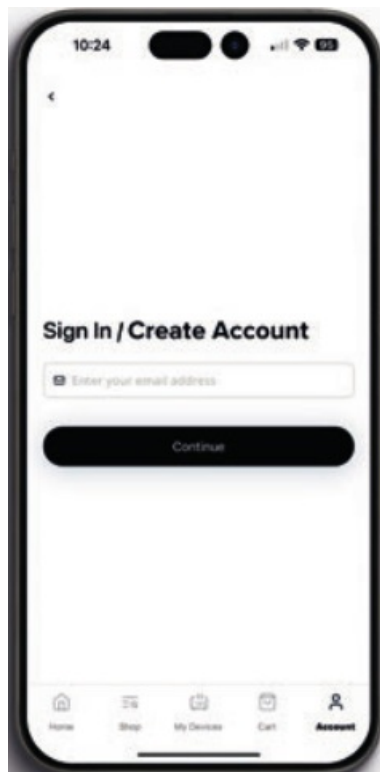

5. Select "Connect My Device" and follow the prompts.

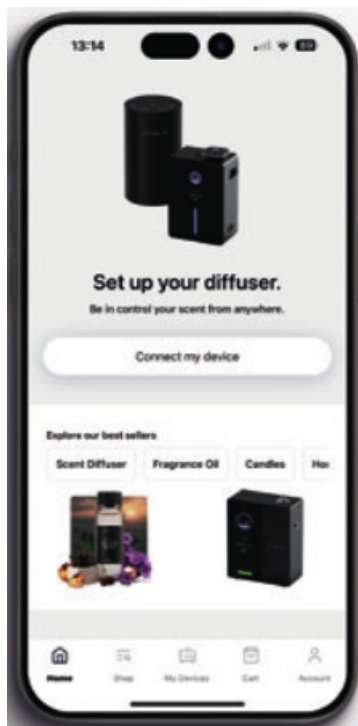

Scentiment's App will allow you to fully control your diffuser remotely. You can set a schedule for the diffuser to follow, with your desired misting intensity level to elevate your space with your favorite fragrances.

How to use the remote

- Press the **On/Off** button to turn the diffuser on and off.



- Select the "**Low**" button to set the Low Misting Intensity.



- Select the “**Medium**” button to set the Medium Misting Intensity.



- Select the “**High**” button to set the High Misting Intensity.



Returns & Replacements

All returned items, whether for a refund, exchange, repair, or replacement, undergo inspection in our warehouse within a timeframe of 10 to 14 business days. If you haven't received an update from us within this period, feel free to reach out and inquire after the 14th business day mark,

Additional Resources

 <p>Additional Resources</p>	 <p>Scent Diffuser Pro 2 User Manual</p>	 <p>Returns and Exchanges</p>
https://www.scentiment.com/pages/go?qrcode=mini-2-additional-resources	https://www.scentiment.com/pages/go?qrcode=scent-diffuser-pro-2-manual	https://www.scentiment.com/pages/go?qrcode=returns-exchange

FCC Warning:

This equipment has been tested and found to comply with the limits for a Class B digital device, pursuant to part 15 of the FCC Rules. These limits are designed to provide reasonable protection against harmful interference in a residential installation. This equipment generates, uses and can radiate radio frequency energy and, if not installed and used in accordance with the instructions, may cause harmful interference to radio communications. However, there is no guarantee that interference will not occur in a particular installation. If this equipment does cause harmful interference to radio or television reception, which can be determined by turning the equipment off and on, the user is encouraged to try to correct the Interference by one or more of the following measures:

- Reorient or relocate the receiving antenna.

- Increase the separation between the equipment and receiver.
- Connect the equipment into an outlet on a circuit different from that to which the receiver is connected.
- Consult the dealer or an experienced radio/TV technician for help.

Caution: Any changes or modifications to this device not explicitly approved by manufacturer could void your authority to operate this equipment.

This device complies with part 15 of the FCC Rules. Operation is subject to the following two conditions:

1. This device may not cause harmful Interference, and
2. this device must accept any interference received, including interference that may cause undesired operation.

This equipment complies with FCC radiation exposure limits set forth for an uncontrolled environment. This equipment should be installed and operated with minimum distance 20cm between the radiator and your body.

AromaPlanTM

Documents / Resources



[AromaPlan SDPRO2 Pro 2 Scent Diffuser](#) [pdf] Instruction Manual
SDPRO2, SDPRO2 Pro 2 Scent Diffuser, Pro 2 Scent Diffuser, Scent Diffuser, Diffuser

References

- [User Manual](#)

[Manuals+](#), [Privacy Policy](#)

This website is an independent publication and is neither affiliated with nor endorsed by any of the trademark owners. The "Bluetooth®" word mark and logos are registered trademarks owned by Bluetooth SIG, Inc. The "Wi-Fi®" word mark and logos are registered trademarks owned by the Wi-Fi Alliance. Any use of these marks on this website does not imply any affiliation with or endorsement.