



ARMYTEK WIZARD C2 WR Magnet USB Multi Flashlight User Manual

[Home](#) » [ARMYTEK](#) » ARMYTEK WIZARD C2 WR Magnet USB Multi Flashlight User Manual 

Contents

- 1 ARMYTEK WIZARD C2 WR Magnet USB Multi Flashlight
- 2 Specifications
- 3 Set description
- 4 Initial Service
 - 4.1 TO SET/REPLACE BATTERY
- 5 HOW TO CONNECT THE MAGNETIC CHARGER
- 6 CHARGER COLOR INDICATION
 - 6.1 Charger not plugged in
- 7 MOMENTARY ACCESS
- 8 Warranty and Service
- 9 Documents / Resources
 - 9.1 References
- 10 Related Posts



ARMYTEK WIZARD C2 WR Magnet USB Multi Flashlight



Thank you for choosing the products of Armttek.
Please read this manual carefully before using the flashlight.

Specifications

Headlamp: simple one-hand operation, reliable headmount. Solid body without long wires, weak rubber connectors and unnecessary boxes. The flashlight is easily installed, removed and 180° rotatable in the mount. Quick-release rubber ring provides additional fixation

Every Day Carry light: compact design, convenient side button, spe-cial matt anti-abrasive finish without rough knurling, strong built-in tail magnet and robust removable steel clip

Bicycle light: body made from durable and lightweight aircraft-grade aluminum, improved shock resistance, new springs for better bat-tery and driver protection. Constant light without flickering, optional quick-release mount. Red light for use as bicycle rear light

- 4 LEDs: amazing beam of red light up to 230 lumens and white light up to 1100 lumens thanks to 2 LEDs for each color
- Red light is almost invisible for animals, fish and insects, comfortable for night vision
- 5 brightness modes for each color, easy operation with one button and double click for switching between white and red light
- Convenient wide beam of fully upgraded optical system, TIR-lenses is protected from scratches by tempered glass with anti-reflective coating
- Innovative technology allows using any 18650 Li-Ion batteries and provides full protection against short circuit even in case of contact between magnetic connector and metal objects
- Active real-time temperature control to prevent overheating above + 58 °C and warning indication of low battery level
- Total protection from water, dirt and dust in accordance with IP68 standard — flashlight continues to work even at 10 meters depth. Withstands fallings from up to 10 meters
- Robust and water resistant magnetic connector

Set description

Flashlight, 18650 Li-Ion 3200 mash battery, magnetic USB charger, clip, headcount, 2 spare O-rings, user manual.

The producer reserves the right to change the package at his own discretion without modifying this manual. Specifications are subject to change without notice.

Model		Wizard C2 WR (White)	
LED/Optics		2 x XD16 (white) + 2 x XQE (red)/TIR	
Brightness stabilization type		FULL (constant light)	
		White light	Red light
Light output		1100 lm	230 lm
Peak beam intensity		2400 cd	430 cd
Hotspot : Spill		70°:120°	
Beam distance		98 m	41 m
Modes, light output and runtimes (measured with 18650 Li-Ion 3200 mAh battery until the light output drops to 10% of the initial value)	Turbo	1100 lm/2 h 30 min (520 lm after 90 sec)	230 lm/3 h (160 lm after 7 min)
	Main2	410 lm/4 h	72 lm/13 h
	Main1	130 lm/13 h	18 lm/46 h
	Firefly	0.6 lm/65 d	0.1 lm/65 d
	Strobe	410 lm/1 Hz/17 h	230 lm/1 Hz/9 h 20 min
Power source		1x18650 Li-Ion	
Length/Body diameter/Head diameter		112 mm/20.4 mm/33 mm	
Weight without/with battery		65 g /115 g	
Submersion and Impact resistance		IP68, 10 m for 2 h. Height up to 10 m	

- Light output for flashlights with Warm light is about 7% less, beam distance is about 3% less.

All the above specifications are test results based on ANSI/NEMA FL1-2009 Standard. The tests are performed using the battery included in the set. The data may vary due to environment, heat dissipation and other factors.

Initial Service

TO SET/REPLACE BATTERY

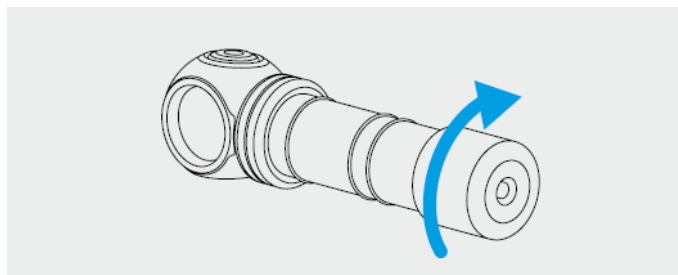

1. Unscrew the tailcap.
2. Place the battery with the positive contact (+) facing the head of the flashlight.
3. Adjust the tailcap and tighten it as far as it can go.

The flashlight is ready for operation.

HOW TO CONNECT THE MAGNETIC CHARGER

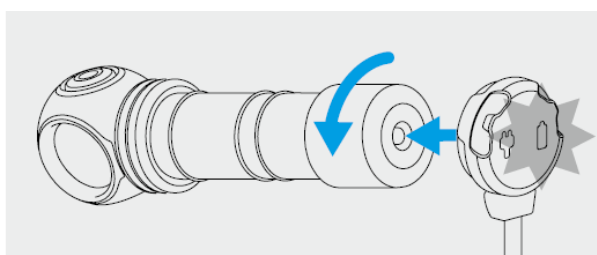

Unscrew the tailcup to 1/4 of a circle and adjust the magnetic charger to the tailcup.

CHARGER COLOR INDICATION

Charger not plugged in

- Green — device is in waiting mode.

Charger plugged in:

- Green blinking — evaluation of battery voltage.
- Red blinking — unscrew the tailcup to 1/4 for charging.
- Orange blinking — USB power source voltage is too low for correct continuation of charging or bad contact between charger and battery. Clean the tailcup and the threads of the flashlight parts, use a different power source.
- Red — charging with rated charging current is going on.
- Orange — USB power source voltage is too low, charging current may be reduced.
- Green — charging is finished.

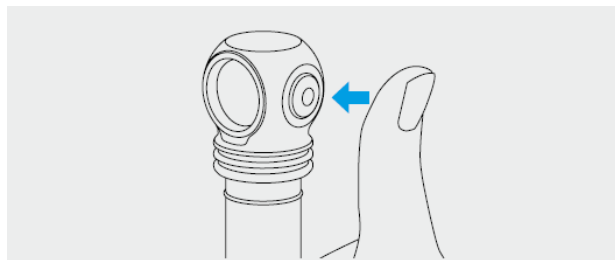

In OFF state:

1. click: To turn on the last used mode.

Press and hold: To turn on Firefly mode of the last used light. Keeping button pressed will start cycling through modes of the chosen light. Release to select.

In ON state:

1. click: To turn off the flashlight.

Press and hold: To start cycling through modes of the chosen light. Release to select.

2. clicks: To change between white and red light in any mode.

Add/Remove Strobe modes. Unscrew the tailcup to 1/4 while the flashlight is off, press the button, tighten the tailcup while keeping the button pressed and then unscrew it again.

MOMENTARY ACCESS

Firefly. Press and hold the button in OFF state to start cycling through Firefly modes. Release to select. Keeping button pressed will start cycling through Main modes.

Main. Short click from OFF state activates Main mode if it was the last used mode.

Turbo. Double click in any mode in ON state. The second double click brings back last used mode.

Cycling through Main modes. In ON state press and hold the button in any mode. Main modes will start switching cyclically. In Firefly1 cycling through Main modes starts after cycling through Firefly modes. Release to select. AutoMap mortising. After switching off the last used mode is memorized for quick access at next switching on. Active temperature control. When the temperature of the flashlight becomes close to +58 °C, brightness decreases to safe value, allowing the flashlight to avoid overheating for a long period of time. In conditions of good air-cooling the flashlight delivers light without stepping down. Low battery level. When the brightness is approximately <25% from the nominal value, the LED will flash 2 times. If you are not sure wheth-er or not it flashed, switch the flashlight off and on: in case the battery is low, the flashes will repeat after 30 sec from switching on. At critical level light output decreases to Firefly mode. Lock-out function. Unscrew the tailcap to 1/4 for the protection from accidental switching on.

Warnings

For effective operation of the flashlight we recommend branded 18650 Li-Ion batteries without PCB (unprotected) no more than 70 mm long.

The flashlight can get hot in Turbo and Strobe modes quickly and discharge the battery with high current. Don't leave it without your attention as very bright light might heat objects and cause fire. It is forbidden to charge the battery inside the flashlight when the ambient temperature is below 0 °C.

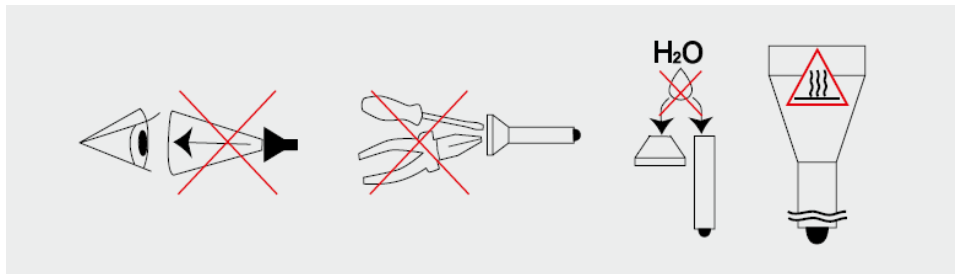

1. Always follow the instructions from this manual and recommendations on battery usage.
2. Apply only the recommended power sources.
3. Do not reverse battery polarity.
4. Do not modify or recast the flashlight and its components as it will deprive you of the warranty.
5. Do not allow water or any other liquid to leak into the flashlight.
6. Do not aim a switched-on flashlight at people's or animals' eyes – it can cause temporary blindness.
7. Do not allow children to use the flashlight without your assistance.

The producer will not be liable for any harm done to the user if it was caused by improper use of the product.

To clean the threads do the following:

1. Unscrew the tailcap and remove the sealing ring carefully with a toothpick (do not use sharp metal things as they can damage the ring).
2. Wipe the sealing ring thoroughly with a soft cloth (or tissue). Do not use solvents. If the sealing ring is worn out or damaged replace it by a new one.
3. Clean the metal threads with a brush using ethanol. Be careful not to allow the applied liquid to get inside the flashlight or tailcap as it can cause fails in functionality of the flashlight.

After cleaning lubricate the thread and the sealing ring with polyol- phalli fin -based silica grease, e.g. Nigel 760G. The application of other types of grease is unacceptable. In case of active operation and exploitation in dusty environments, it is recommended to perform cleaning and lubricating of the parts as often as required. WE DO NOT RECOMMEND to leave power sources inside the flash-light for a long storage period, as batteries (especially non-recharge-able) can leak for various reasons and damage the inner parts of the flashlight. If you

want to keep your flashlight in a stand-by state with batteries in, previously install new and high-quality batteries, store the flashlight in acceptable for batteries operational temperature and revise the batteries' state at least once a month. If you have noticed any signs of defects, withdraw the batteries from the flashlight and dispose of them.

Warranty and Service

Armtek provides free warranty repairs for 10 years (excluding batteries, chargers, switches and connectors, which have 2-year warranty) from the date of purchase if there is a document confirming the purchase. The warranty does not extend to damage during:

1. Improper usage.
2. Attempts to modify or repair the flashlight by nonqualified specialists.
3. Application in chlorinated, contaminated liquids or sea water.
4. Immersion into liquids in case of broken leak proofness.
5. Exposure to high temperatures and chemicals, including the liquids from defected batteries.
6. Usage of low-quality batteries.

Armtek

Germany, 10551 Berlin, Jonasstraße 6

+1 (206) 785-9574, service@armytek.com www.armytek.com

Documents / Resources

	<p>ARMYTEK WIZARD C2 WR Magnet USB Multi Flashlight [pdf] User Manual WIZARD C2 WR, Magnet USB Multi Flashlight, WIZARD C2 WR Magnet USB Multi Flashlight, USB Multi Flashlight, Multi Flashlight, Flashlight</p>
---	--

References

- [Armytek Flashlights and Headlamps — 10 Years Warranty | Armytek.com](#)
- [Armytek Official Website in Finland - Headlamps & EDC & Tactical flashlights | Armytek.fi](#)
- [Latarki LED Armytek — Oficjalny przedstawiciel Armytek na Polsce | Armytek.pl](#)
- [Armytek Flashlights and Headlamps — Official Website in Germany | ArmytekStore.de](#)