

# ARMYTEK F09001C Wizard C1 Pro Magnet USB Multi Flashlight User Manual

[Home](#) » [ARMYTEK](#) » ARMYTEK F09001C Wizard C1 Pro Magnet USB Multi Flashlight User Manual 

## Contents

- [1 ARMYTEK F09001C Wizard C1 Pro Magnet USB Multi Flashlight](#)
- [2 Specifications](#)
- [3 Set description](#)
- [4 Initial Service](#)
- [5 CHARGER COLOR INDICATION](#)
- [6 Operation](#)
- [7 ADVANCED TYPE](#)
- [8 Care and Storage](#)
- [9 Warranty and Service](#)
- [10 Documents / Resources](#)
  - [10.1 References](#)
- [11 Related Posts](#)



**ARMYTEK F09001C Wizard C1 Pro Magnet USB Multi Flashlight**

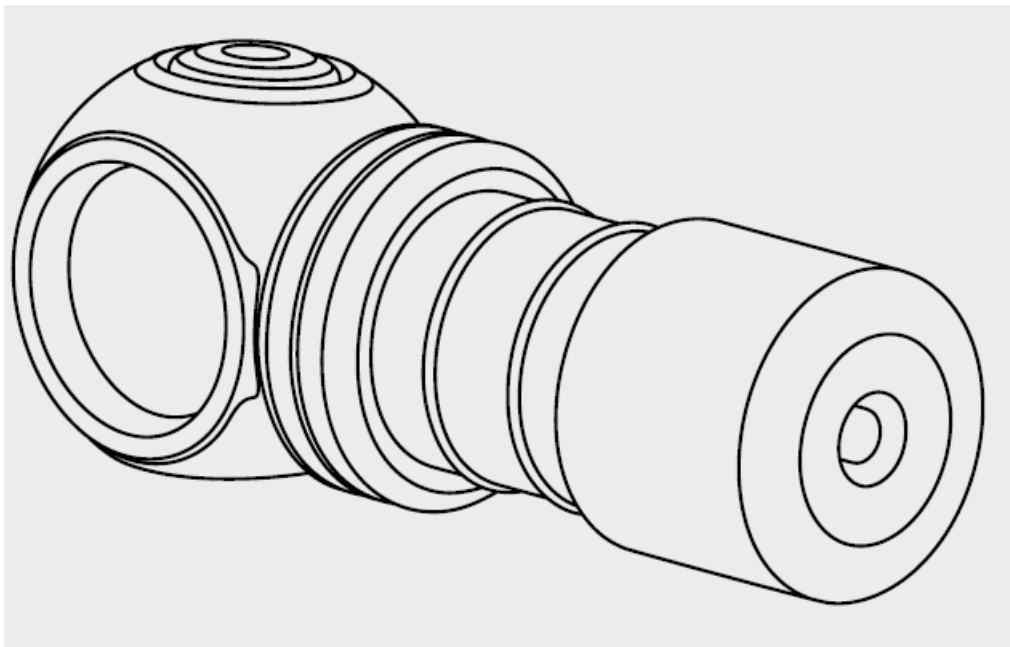

Thank you for choosing the products of Armytek Optoelectronics Inc. Please read this manual carefully before using the flashlight.

## Specifications

**Headlamp:** simple one-hand operation, reliable headmount for running. Solid body without long wires, weak rubber connectors and unnecessary boxes. The flashlight is easily installed, removed and 180° rotatable in the mount. Quick-release rubber ring provides additional fixation

**Every Day Carry light:** compact design, convenient side button, special matt anti-abrasive finish without rough knurling. Strong built-in magnet and robust steel clip. Constant light without flickering

Bicycle light: made from aircraft-grade aluminium, optional durable quick-release mount

- Compact and lightweight — smaller version of Wizard C2 for even more comfortable carry on head or in a pocket
- Powerful electronics provides impressive light output up to 1000 lumens and record 60 days in Firefly mode
- Total protection from water, dirt and dust — flashlight continues to work even at 10 meters depth
- Convenient wide beam of the TIR-optics, protected from scratches by tempered glass with anti-reflective coating
- Innovative technology allows to use any 18350 Li-Ion batteries and provides full protection against short circuit even in case of contact between magnetic connector and metal objects
- Active real-time temperature control to prevent overheating above 58 °C and warning indication of low battery level
- Multicolor temperature and battery state indication for 25 years helps to find the flashlight in the dark
- Robust and water resistant magnetic connector

<b>Model</b>		<b>Wizard C1 Pro (White)</b>
<b>LED/Optics</b>		Samsung LH351D/TIR
<b>Brightness stabilization type</b>		DIGITAL (CPU brightness control)
<b>Light output</b>		1000 lm
<b>Peak beam intensity</b>		2510 cd
<b>Hotspot : Spill</b>		70°:120°
<b>Beam distance</b>		100 m
<b>Modes, light output (OTF lumens) and runtime s (measured with 18350 Li-Ion 900 mAh battery until the light output drops to 10% of the initial value)</b>	<b>Turbo2</b>	1000 lm/55 min (500 lm after 5 min)
	<b>Turbo1</b>	440 lm/1 h 24 min
	<b>Main3</b>	210 lm/3 h
	<b>Main2</b>	100 lm/6 h 40 min
	<b>Main1</b>	40 lm/16 h 30 min
	<b>Firefly3</b>	7 lm/2.5 d
	<b>Firefly2</b>	2 lm/8 d
	<b>Firefly1</b>	0.11 lm/60 d
	<b>Strobe3</b>	1000 lm/10 Hz/1 h
	<b>Strobe2</b>	1000 lm/1Hz/2 h 20 min
	<b>Strobe1</b>	100 lm/1 Hz/32 h
<b>Power source</b>		1×18350 Li-Ion
<b>Length/Body diameter/Head diameter</b>		76.3 mm/20.4 mm/33 mm
<b>Weight without/with battery</b>		55 g/80 g
<b>Submersion and Impact resistance</b>		IP68, 10 m for 2 h. Height up to 10 m

- Light output for flashlights with Warm light is about 7% less, beam distance is about 3% less.
- All the above specifications are test results based on ANSI/NEMA FL1-2009 Standard. The tests are performed using the battery included in the set. The data may vary due to environment, heat dissipation and other factors.

## Set description

Flashlight, 18350 Li-Ion battery, magnetic USB charger, clip, head-mount, 2 spare O-rings, user manual. The flashlight and accessories can inconsiderably differ from the pictures in the manual. The producer reserves the right to change the package at his own discretion without modifying this manual. Specifications are subject to change without notice.

## Initial Service

### TO SET/REPLACE BATTERY

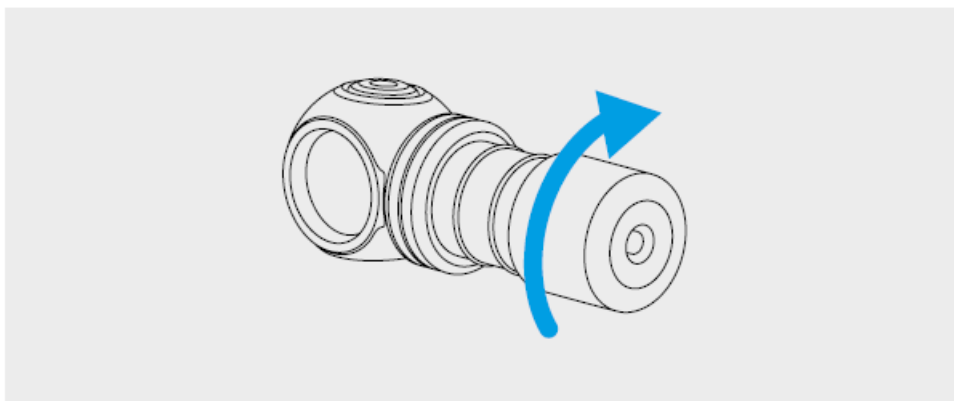

1. Unscrew the tailcap.
2. Place the battery with the positive contact (+) facing the head of the flashlight.
3. Adjust the tailcap and tighten it as far as it can go.

The flashlight is ready for operation.

### HOW TO CONNECT THE MAGNETIC CHARGER

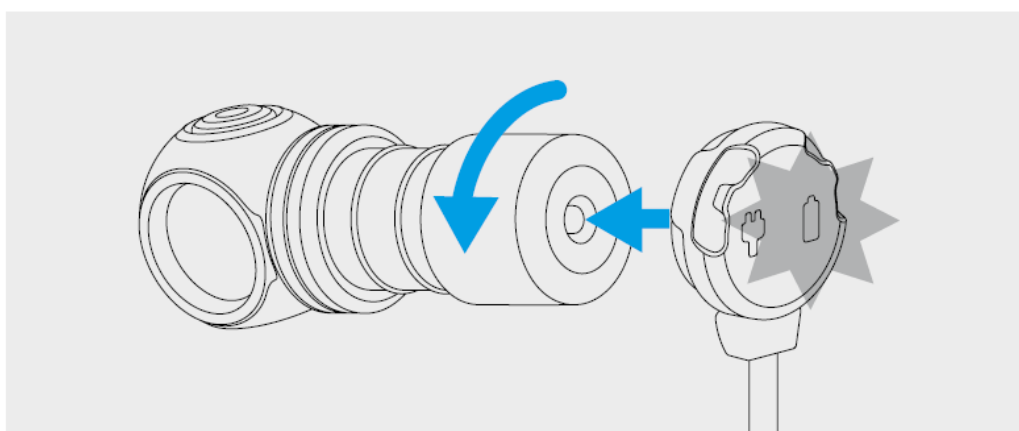

Unscrew the tailcap for 1/4 of a circle and adjust the magnetic charger to the tailcap.

### CHARGER COLOR INDICATION

#### Charger not plugged in:

Green — device is in waiting mode.

#### Charger plugged in:

- Green blinking — evaluation of battery voltage.
- Red blinking — unscrew the tailcap for 1/4 for charging.
- Orange blinking — USB power source voltage is too low for correct continuation of charging or bad contact between charger and battery. Try cleaning the tailcap and the threads of the flashlight parts or use a different

power source.

- Red — charging is going on, charging current is 1A.
- Orange — USB power source voltage is too low, charging current has been reduced by half.
- Green — charging is finished.

## Operation

Before use: Tighten the tailcap.

### GENERAL TYPE

Modes: Firefly1, Firefly2, Main modes, Turbo1 or Turbo2 (last used in Advanced, Turbo2 by default).

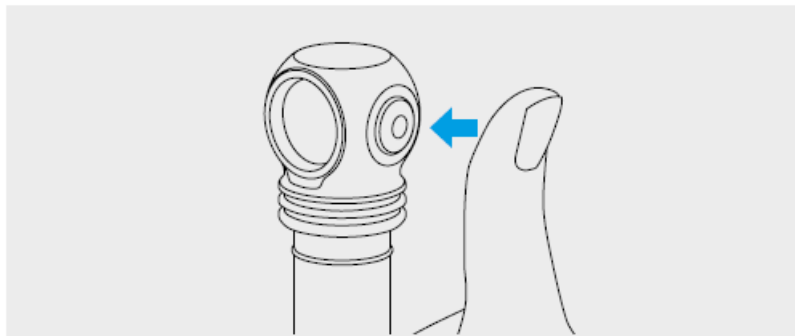

#### In OFF state

click: To turn on the last used mode. Press and hold: To start cycling through Firefly modes. Release to select. Keeping button pressed will start cycling through Main modes.

#### In ON state

1. click: To turn off the flashlight. Press and hold: To start cycling through Main modes from any mode. In Firefly1 cycling through Main modes starts after cycling through Firefly modes. Release to select.
2. clicks: To turn on Turbo mode from any mode. The second double click brings back last used mode.

### ADVANCED TYPE

To switch between types of operation unscrew the tailcap to 1/4 while the flashlight is off, press the button and tighten the tailcap while keeping the button pressed.

#### Sections of modes:

[1] – Firefly modes, [2] – Main modes, [3] – Turbo modes, [4] – Strobe modes

#### In OFF state:

1 click: To turn on the last used mode. Press and hold: To turn on Firefly1 mode [Section 1]. Keeping button pressed will start cycling through modes: Firefly1 – Firefly2 – Firefly3 – Main1 – Main2 – Main3 – Turbo1.

#### In ON state:

click: To turn off the flashlight. Press and hold: To start cycling through the modes of relevant Section.

#### The same in OFF & ON states:

2 clicks: To turn on Main mode [Section 2]. Another double click will switch between chosen modes in [Section 1] and [Section 2]. 3 clicks: To turn on Turbo mode [Section 3]. 4 clicks: To turn on Strobe mode [Section 4].

**Auto memorizing.** After switching off the last used mode is memorized for quick access at next switching on.

**Safe high brightness modes.** Turbo modes give maximum brightness until the temperature of the flashlight and discharge current of the battery don't exceed critical values.

**Digital Light Stabilization & Safe Soft-Start System** allows to increase runtime, get longer lifetime of rechargeable battery and protect it from overdischarge or overheating.

**Active temperature control.** When the temperature of the flashlight becomes close to critical, brightness decreases to safe value, allowing the flashlight to avoid overheating for a long period of time. In conditions of good air-cooling the flashlight delivers light without stepping down.  
Warning indication shows the battery level and the temperature inside the flashlight.

**Low battery level.** When battery level is approximately <25%, the color LED will show the warning level by flashing orange once in 2 seconds. With further voltage reduction brightness will start to decrease in steps for safety of the battery and user. If brightness of the mode (except Firefly modes and Main1) is approximately <25% from nominal value, the main LED will flash 2 times. Critical battery level approximately <10% is indicated by flashing red once a second.

**High temperature.** When the temperature increases to the warning level, the color LED flashes orange 3 times once in 2 seconds. At critical level it flashes red 3 times once in 1 second. Brightness starts to reduce to safe level.

**Lock-out function.** Unscrew the tailcap to 1/4 for the protection from accidental switching on. State Indication will be turned off.

**Multicolor State Indication.** Short flashes every 4 seconds show the battery level even in OFF state (until battery level becomes lower than the critical one). The indication also helps to find the flashlight in the dark.

**Switching Multicolor State Indication ON/OFF.** The indication is switched off by default in Firefly modes (disabled after 10 seconds of operation) and in OFF state. To turn it on/off, unscrew the tailcap to 1/4, press the button and keeping the button pressed tighten and unscrew the tailcap again. The settings will be memorized even when battery is changed. Ultra-low current consumption allows color indication to work for maximum period of time.

## Warnings

For effective operation of the flashlight, we recommend branded 18350 batteries or 16340 Li-Ion batteries without PCB (unprotected) or with PCB which guarantees 3A discharge current.

The flashlight can get hot in Turbo modes, Strobe2 and Strobe3 quickly and discharge the battery with high current. Don't leave it without your attention as very bright light might heat objects and cause fire.

1. Always follow the instructions from this manual and recommendations on battery usage.
2. Apply only the recommended power sources.
3. Do not reverse battery polarity.
4. Do not modify or recast the flashlight and its components as it will deprive you of the warranty.
5. Do not allow water or any other liquid to leak into the flashlight.
6. Do not aim a switched-on flashlight at people's or animals' eyes – it can cause temporary blindness.
7. Do not allow children to use the flashlight without your assistance.

The producer will not be liable for any harm done to the user if it was caused by improper use of the product.

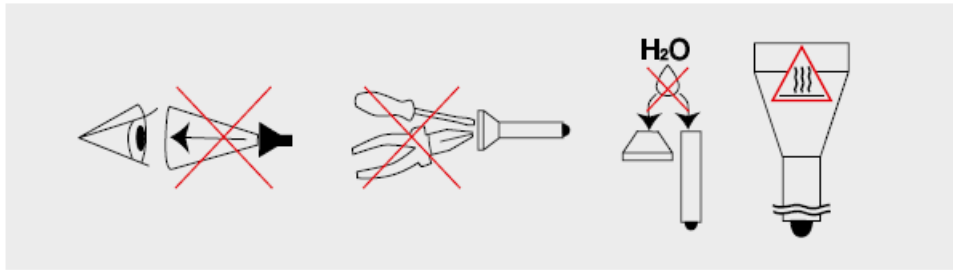

## Care and Storage

It is recommended to clean the threads and O-rings off dirt and old grease once or twice per year. Remember that reliable protection from water and dust cannot be provided by worn out sealing. The fouling as well as lack of lubricant cause fast wear-out of threads and sealing rings.

### To clean the threads do the following:

1. Unscrew the tailcap and remove the sealing ring carefully with a toothpick (do not use sharp metal things as they can damage the ring).
2. Wipe the sealing ring thoroughly with a soft cloth (or tissue). Do not use solvents. If the sealing ring is worn out or damaged replace it by a new one.
3. Clean the metal threads with a brush using ethanol. Be careful not to allow the applied liquid to get inside the flashlight or tailcap as it can cause fails in functionality of the flashlight.

After cleaning lubricate the thread and the sealing ring with polyal-phaolefin-based silica grease, e.g. Nyogel 760G. The application of other types of grease is unacceptable. In case of active operation and exploitation in dusty environments, it is recommended to perform cleaning and lubricating of the parts as often as required. WE DO NOT RECOMMEND to leave power sources inside the flash-light for a long storage period, as batteries (especially non-recharge-able) can leak for various reasons and damage the inner parts of the flashlight. If you want to keep your flashlight in a stand-by state with batteries in, previously install new and high-quality batteries, store the flashlight in acceptable for batteries operational temperature and revise the batteries' state at least once a month. If you have noticed any signs of defects, withdraw the batteries from the flashlight and dispose of them.

## Warranty and Service

Armytek provides free warranty repairs for 10 years (excluding bat-teries, chargers, switches and connectors, which have 2-year warran-ty) from the date of purchase if there is a document confirming the purchase. The warranty does not extend to damage during:

1. Improper usage.
2. Attempts to modify or repair the flashlight by nonqualified specialists.
3. Long-term application in chlorinated and contaminated liquids or sea water.
4. Exposure to high temperatures and chemicals (including the liquids from defected batteries).
5. Usage of low-quality batteries.

Armytek Optoelectronics Inc. Germany, 10551 Berlin, Jonasstraße 6 +1 (206) 785-9574, [service@armytek.com](mailto:service@armytek.com)  
[www.armytek.com](http://www.armytek.com)

## Documents / Resources

	<p><a href="#">ARMYTEK F09001C Wizard C1 Pro Magnet USB Multi Flashlight</a> [pdf] User Manual F09001C, Wizard C1 Pro Magnet USB Multi Flashlight</p>
--	---

References

-  [Armytek Flashlights and Headlamps — 10 Years Warranty | Armytek.com](#)