

ARMYTEK
ELF C2 Multi Flash
Light



ARMYTEK ELF C2 Multi Flash Light User Manual

[Home](#) » [ARMYTEK](#) » ARMYTEK ELF C2 Multi Flash Light User Manual 

Contents

- [1 ARMYTEK ELF C2 Multi Flash Light](#)
- [2 Product Usage Instructions](#)
- [3 FAQ](#)
- [4 Before use](#)
- [5 MOMENTARY ACCESS](#)
- [6 Cycling through Main modes](#)
- [7 FLASHLIGHT CHARGING](#)
- [8 WARRANTY AND SERVICE](#)
- [9 CONTACT](#)
- [10 Documents / Resources](#)
 - [10.1 References](#)



ARMYTEK ELF C2 Multi Flash Light



Product Usage Instructions

- Turn off the flashlight before charging.
- Connect the charging cable to the flashlight.
- Check the color indication in the button:
- The approximate charging time for a fully discharged battery is 4 hours 30 minutes.
- Use adapters with at least 1A current for optimal charging.
- Use branded 18650 Li-Ion batteries without PCB (unprotected) up to 70mm long for effective operation.
- Turbo mode can generate high heat quickly, leading to battery discharge.
- Free warranty repairs are provided by Armytek for 10 years from the date of purchase (excluding specific components).
- Ensure to keep the purchase document for warranty claims.
- Warranty exclusions include improper usage, modifications by non-qualified personnel, exposure to certain liquids, high temperatures, and low-quality batteries.

FAQ

- **Q: What type of batteries should I use with the ELF C2 flashlight?**
 - **A:** We recommend using branded 18650 Li-Ion batteries without PCB (unprotected) up to 70mm long for optimal performance.
- **Q: How long does it take to charge a fully discharged battery?**
 - **A:** The approximate charging time for a fully discharged battery is 4 hours and 30 minutes.

Scan to view the full manual



USER MANUAL

- Thank you for choosing the products of Armytek.

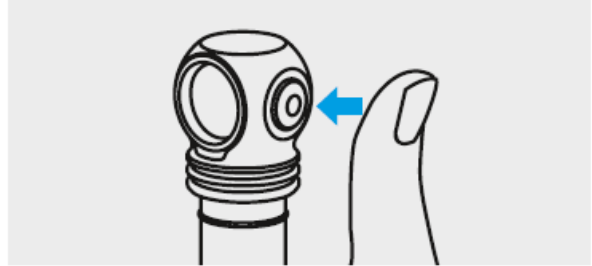
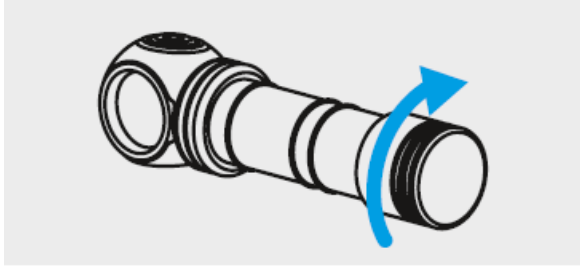

Before use

- Tighten the tailcap as far as it can go.

In OFF state

1. click: To turn on the last used mode.

Press and hold: To start cycling through Firefly modes. Release to select. Keeping the button pressed will start cycling through the Main modes.

In ON state

1. click: To turn off the flashlight.

Press and hold: To start cycling through the Main modes from any mode. In Firefly1 cycling through Main modes starts after cycling through Firefly modes. Release to select.

2. clicks: To turn on Turbo mode from any mode. The second double click brings back the last used mode.

MOMENTARY ACCESS

- Firefly. Press and hold the button in the OFF state to start cycling through Firefly modes.
- Release to select. Keeping the button pressed will start cycling through the Main modes.
- Main. A short click from the OFF state activates the Main mode if it is the last used mode.
- Turbo. Double-click in any mode in the ON state. The second double click brings back the last used mode.

Cycling through Main modes

- In the ON state press and hold the button in any mode.

- The main modes will start switching cyclically.
- In Firefly1 cycling through Main modes starts after cycling through Firefly modes. Release to select.

Lamp mode. The flashlight can work without a battery in Firefly1, Firefly2, and Main1 modes. For this connect the USB-C cable to the flashlight and power source, and remove the battery.

1. click: To turn on/off the flashlight.

Press and hold: To start cycling through modes.

For activation of the timer, unscrew the tailcap to 1/4 while the flashlight is off, press the button, and tighten the tailcap while keeping the button pressed.

- Press and hold the button for 5 seconds. When the flashlight starts flashing with the main LED, release the button. Press the button the required number of times to set the timer:
- 1 click – 2 min; 2 clicks – 5 min; 3 clicks and more – 10 min.
- The main LED will flash from 1 to 3 times, confirming the action:
- 1 flash – 2 min; 2 flashes – 5 min; 3 flashes – 10 min.
- After confirming the activation of the timer, the flashlight will work in the previously selected mode for a specified period. The next click turns the flashlight off and resets the timer.

To return to permanent on, unscrew the tailcap to 1/4 while the flashlight is off, press the button, release it, and tighten the tailcap.

Lock-out function

- Unscrew the tailcap to 1/4 for protection from accidental switching on.

FLASHLIGHT CHARGING

- Turn off the flashlight and connect the cable.
- Color indication in the button displays the charging stage: red — the flashlight is charging, green — the flashlight is charged.
- If there is no indication, the battery is removed or installed in the wrong polarity.
- The approximate time for charging a fully discharged battery is 4 h 30 min. We recommend using adapters with 1A current and higher.

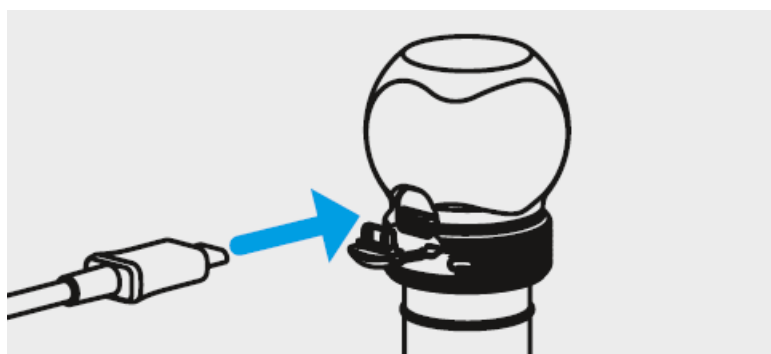

WARNINGS

- For efficient operation of the flashlight, we recommend branded 18650 Li-Ion batteries without PCB (unprotected) no more than 70 mm long.
- The flashlight can get hot in Turbo mode quickly and discharge the battery with a high current. Don't leave it without your attention as very bright light might heat objects and cause a fire.
- For storage or transportation of the flashlight in a pocket or a bag, it is necessary to activate the lock-out function to ensure protection from accidental switching on.
- It is forbidden to charge the battery inside the flashlight when the ambient temperature is below 0 °C.

WARRANTY AND SERVICE

Armytek provides free warranty repairs for 10 years (excluding batteries, chargers, mounts, holders, switches, and connectors, which have a 2-year warranty) from the date of purchase if there is a document confirming the purchase.

The warranty does not apply to magnets, silicone covers of connectors and buttons, silicone installation rings and holders, clips, silicone grips, holsters, lanyards, O-rings and pads, or Velcro tapes. The warranty also does not extend to damage during:

1. Improper usage.
2. Attempts to modify or repair the flashlight by nonqualified specialists.
3. Application in chlorinated, contaminated liquids or seawater.
4. Immersion into liquids in case of broken leakproofness.
5. Exposure to high temperatures and chemicals, including the liquids from defective batteries.
6. Usage of low-quality batteries.

Specifications are subject to change without notice.

CONTACT

- Armytek Worldwide / Representative and importer in the EU
- Germany, 10551 Berlin, Jonasstraße 6
- +1 (206) 785-95-74, +49 (30) 3119-68-00
- service@armytek.com
- www.armytek.com

Documents / Resources



[ARMYTEK ELF C2 Multi Flash Light](#) [pdf] User Manual
 ELF C2 Multi Flash Light, ELF C2, Multi Flash Light, Flash Light, Light

References

- [min.La](https://min.la)
- [User Manual](#)

Manuals+. Privacy Policy

This website is an independent publication and is neither affiliated with nor endorsed by any of the trademark owners. The "Bluetooth®" word mark and logos are registered trademarks owned by Bluetooth SIG, Inc. The "Wi-Fi®" word mark and logos are registered trademarks owned by the Wi-Fi Alliance. Any use of these marks on this website does not imply any affiliation with or endorsement.