



**ARMYTEK**  
**1 Multi Flashlight**



## Contents [ [hide](#) ]

- [1 ARMYTEK ELF C1 Multi Flashlight](#)
- [2 Specifications](#)
- [3 Set description](#)
- [4 Operation](#)
- [5 MOMENTARY ACCESS](#)
- [6 BATTERY LEVEL AND FLASHLIGHT TEMPERATURE INDICATION](#)
- [7 Care and Storage](#)
- [8 Warranty and Service](#)
- [9 FAQs](#)
- [10 Documents / Resources](#)
  - [10.1 References](#)



## ARMYTEK ELF C1 Multi Flashlight



Thank you for choosing the products of Armytek. Please read this manual carefully before using the flashlight.

## Specifications

1. Headlamp: simple one-hand operation, reliable headmount. Solid body without long wires, weak rubber connectors, and unnecessary boxes. The flashlight is easily installed, removed and 180° rotatable in the mount
  2. Every Day Carry light: compact design, convenient side button, special matt anti-abrasive finish without rough knurling. Robust removable steel clip and strong built-in tail magnet
  3. Sports flashlight: body made from durable and lightweight aircraft-grade aluminium, improved shock resistance, constant light without flickering. Multiple variants of installation, optional accessories for mounting on sporting gear
  4. Keychain light: compact and lightweight for even more comfortable carry in a pocket, hole for keyring or lanyard in the tailcap
  5. Lamp mode: works without batteries directly from a Powerbank or any USB power supply
- Possibility to set the timer for automatic switching off
  - Multicolor temperature, battery level, charging process, and state indication
  - Convenient wide beam of the fully upgraded optical system, steel bezel, and tempered

glass with anti-reflective coating for protection of the TIR-lens

- Innovative technology allows using any standard 18350 Li-Ion battery even without an additional protection circuit board
- Active real-time temperature control to prevent overheating above + 58 °C
- Total protection from water, dirt, and dust in accordance with IP68 standard — flashlight continues to work even after submersion at 10 meters. Withstands falls from up to 10 meters
- Robust and water-resistant USB-C socket even without a rubber cover.

| <b>Model</b>   |              | <b>Elf C1 (white light)</b>         | <b>Elf C1 (warm light)</b>         |
|--|--------------|-------------------------------------|------------------------------------|
| <b>Optics</b>  |              | TIR                                 |                                    |
| <b>Brightness stabilization type</b>   |              | DIGITAL (CPU brightness control)    |                                    |
| <b>Light output</b>  |              | 1000 lm                             | 930 lm                             |
| <b>Peak beam intensity</b>   |              | 2670 cd                             | 2590 cd                            |
| <b>Hotspot : Spill</b>   |              | 70°:120°                            |                                    |
| <b>Beam distance</b>   |              | 103 m                               | 102 m                              |
| <b>Modes, light output and runtimes (measured)</b>   | <b>Turbo</b> | 1000 lm/52 min (530 lm after 4 min) | 930 lm/52 min (493 lm after 4 min) |
| <b>with 18350 Li-Ion 900 mAh battery until the light output drops to 10% of the initial value)</b> | <b>Main3</b> | 500 lm/1 h 11 min                   | 465 lm/1 h 11 min                  |

|  |                           |                     |             |
|--|---------------------------|---------------------|-------------|
|  | <b>Ma<br/>in2</b>         | 220 lm/3 h          | 205 lm/3 h  |
|  | <b>Ma<br/>in1</b>         | 43 lm/11 h          | 40 lm/11 h  |
|  | <b>Fir<br/>efl<br/>y2</b> | 2 lm/8 d            | 1.9 lm/8 d  |
|  | <b>Fir<br/>efl<br/>y1</b> | 0.11 lm/60 d        | 0.1 lm/60 d |
| <b>Power source</b>                                    |                           | 1×18350 Li-Ion      |             |
| <b>Time of charging (18350 Li-Ion 900 mAh battery)</b> |                           | 1 h 30 min          |             |
| <b>Length/Body diameter/Head diameter</b>              |                           | 76 mm/20.4 mm/33 mm |             |
| <b>Weight without/with battery</b>                     |                           | 55 g/80 g           |             |

Ingress protection, Submersion and Impact resistance IP68. Depth up to 10 m for 5 h. Height up to 10 m All the above specifications are test results based on ANSI/PLATO FL 1-2019 Standard. The data may vary due to the environment, heat dissipation, and other factors.

## Set description

Flashlight, 18350 Li-Ion 900 mAh battery, USB-C cable, headmount, clip, spare O-ring, user manual. The producer reserves the right to change the package at his own discretion without modifying this manual. Specifications are subject to change without

notice.

## Initial Service

### TO SET/REPLACE BATTERY

1.

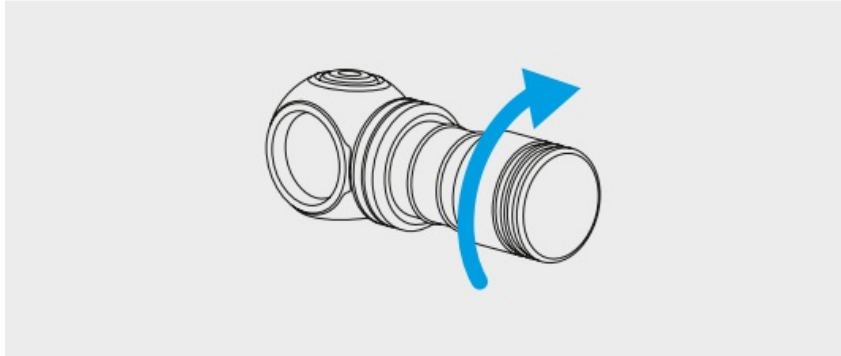

Unscrew the tailcap.

2. Place the battery with the positive contact (+) facing the head of the flashlight.
3. Adjust the tailcap and tighten it as far as it can go.

The flashlight is ready for operation.

### FLASHLIGHT CHARGING

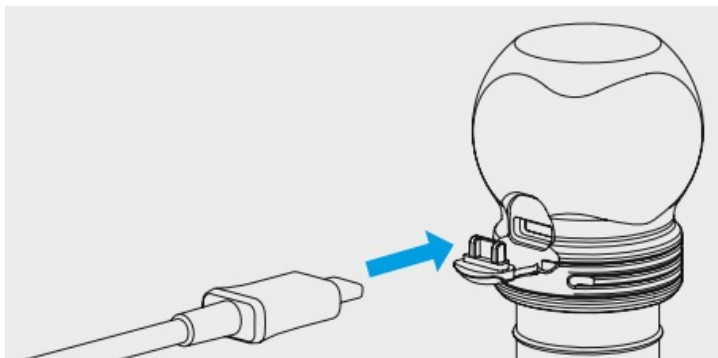

Turn off the flashlight and connect the cable. Color indication in the button displays the charging stage: red — the flashlight is charging, green — the flashlight is charged. If there is no indication, the battery is removed or installed in the wrong polarity.

Approximate time for charging a fully discharged battery is 1 h 30 min. We recommend using adapters with 1A current and higher.

## Operation

**Before use:** Tighten the tailcap as far as it can go.

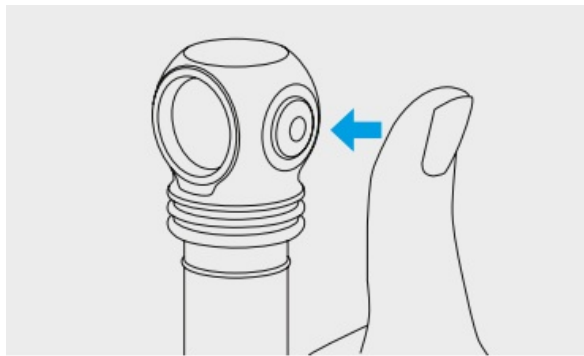

### **In the OFF state**

1 click: To turn on the last used mode. Press and hold: To start cycling through Firefly modes. Release to select. Keeping the button pressed will start cycling through the Main modes.

### **In the ON state**

1. Click: To turn off the flashlight. Press and hold: To start cycling through the Main modes from any mode. In Firefly1, cycling through Main modes starts after cycling through Firefly modes. Release to select.
2. Clicks: To turn on Turbo mode from any mode. The second double click brings back the last used mode.

## **MOMENTARY ACCESS**

### **Firefly**

Press and hold the button in the OFF state to start cycling through Firefly modes. Release to select. Keeping the button pressed will start cycling through the Main modes.

### **Main**

A short click from the OFF state activates Main mode if it was the last used mode.

### **Turbo**

Double click in any mode in ON state. The second double click brings back last used mode. Cycling through Main modes. In ON state press and hold the button in any mode. Main modes will start switching cyclically. In Firefly1 cycling through Main modes starts after cycling through Firefly modes. Release to select. Lamp mode. The flashlight can

work without battery in Firefly1, Firefly2, and Main1 modes. For this, connect the USB-C cable to the flashlight and power source, and remove the battery. 1 click: To turn on/off the flashlight.

**Press and hold:** To start cycling through modes.

**For activation of the timer,** unscrew the tailcap to 1/4 while the flashlight is off, press the button, and tighten the tailcap while keeping the button pressed. Press and hold the button for 5 seconds. When the flashlight starts flashing with the main LED, release the button. Press the button the required number of times to set the timer: 1 click – 2 min; 2 clicks – 5 min; 3 clicks and more – 10 min. The main LED will flash from 1 to 3 times, confirming the action: 1 flash – 2 min; 2 flashes – 5 min; 3 flashes – 10 min. After confirming the activation of the timer, the flashlight will work in the previously selected mode for a specified period of time. The next click turns the flashlight off and resets the timer.

**To return to permanent on,** unscrew the tailcap to 1/4 while the flashlight is off, press the button, release it, and tighten the tailcap.

**Automemorizing.** After switching off, the last used mode is memorized for quick access at the next switch-on.

**Lock-out function.** Unscrew the tailcap to 1/4 for protection from accidental switching on. Multicolor indication will be turned off. Safe high brightness modes. Turbo modes give maximum brightness until the temperature of the flashlight and discharge current of the battery exceed critical values.

### **Safe Soft-Start System**

allows increasing runtimes, getting longer battery life and protecting the battery from overdischarge or overheating.

### **Active real-time temperature control**

When the temperature becomes close to +58 °C, the brightness decreases, which allows avoiding flashlight and battery overheating, as well as LED degradation. Under good cooling conditions, the flashlight delivers light without stepping down.

## **BATTERY LEVEL AND FLASHLIGHT TEMPERATURE INDICATION**

The flashlight has a multicolor temperature, battery level, and state indication (indication by the color LED in the button), as well as a low battery level indication by light (indication by the main LED of the flashlight). The flashlight indication in ON state includes a multicolor battery level and temperature indication, and a low battery level indication by light. When the flashlight is in the OFF state, there is a multicolor state indication.

### **Battery level is more than 25%**

The color LED in the button flashes green once every 4 seconds.

### **Low battery level**

When the battery level becomes less than approximately 25%, the color LED in the button indicates the warning level by flashing orange 1 time every 2 seconds. With a further drop in voltage, the brightness begins to decrease in steps to ensure the safety of

the battery and the user. If the brightness of the mode (except Firefly modes and Main1) drops below approximately 25% of the nominal value, the main LED flashes 2 times.

When the battery level becomes critical, less than approximately 10%, the color LED flashes red 1 time every second.

### **High temperature**

When the temperature of the flashlight increases to the warning level, the color LED in the button flashes orange 3 times every 2 seconds. At critical level the LED flashes red 3 times every second. The brightness begins to decrease to a safe level.

### **Multicolor state indication**

Short flashes of the LED in the button every 4 seconds show the battery level when the flashlight is in the OFF state (until the battery level becomes lower than the critical one). The indication also helps to find the flashlight in the dark.

### **Switching the multicolor indication on/off**

Multicolor indication has 2 operating modes:



1. The indication is switched off in Firefly modes (disabled after 10 seconds of operation) and in the OFF state (by default).
2. The indication is switched on in any state.

To change the operating mode, unscrew the tailcap to 1/4 while the flashlight is off, press the button and keeping the button pressed, tighten and unscrew the tailcap again. The settings will be memorized even when the battery is changed. Ultra-low current consumption allows multicolor indication to work for a maximum period of time.

## Warnings

For effective operation of the flashlight, we recommend branded 18350 Li-Ion batteries or 16340 Li-Ion batteries without PCB (unprotected) or with PCB, which guarantees 3A discharge current. The flashlight can get hot in Turbo mode quickly and discharge the battery with high current. Don't leave it without your attention as very bright light might heat objects and cause fire. For storage or transportation of the flashlight in a pocket or a bag it is necessary to activate the lock-out function to ensure protection from accidental switching on. It is forbidden to charge the battery inside the flashlight when the ambient temperature is below 0 °C.

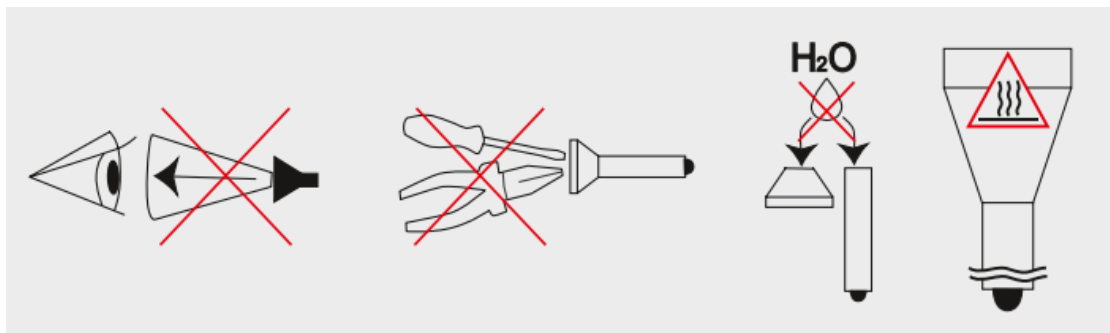

1. Always follow the instructions from this manual and recommendations on battery usage.
2. Apply only the recommended power sources.
3. Do not reverse battery polarity.
4. Do not modify or recast the flashlight and its components as it will deprive you of the warranty.
5. Do not allow water or any other liquid to leak into the flashlight.
6. Do not aim a switched-on flashlight at people's or animals' eyes — it can cause

temporary blindness.

7. Do not allow children to use the flashlight without your assistance.

The producer will not be liable for any harm done to the user if it was caused by improper use of the product.

## **Care and Storage**

It is recommended to clean the threads and O-rings off dirt and old grease once or twice per year. Remember that reliable protection from water and dust cannot be provided by worn-out sealing. The fouling, as well as the lack of grease causes fast wear-out of the threads and sealing rings. To clean the threads, do the following:

1. Unscrew the tailcap and remove the sealing rings carefully with a toothpick (do not use sharp metal objects as they can damage the rings).
2. Wipe the sealing rings thoroughly with a soft cloth (or tissue). Do not use solvents. If the sealing ring is worn out or damaged, replace it with a new one.
3. Clean the metal threads with a brush using ethanol. Be careful not to allow the applied liquid inside the flashlight, as it can cause malfunctioning of the flashlight.

After cleaning, grease the threads and the sealing rings that have been installed in place with polyalphaolefin-based silica grease, e.g., Nyogel 760 G. The application of other types of grease is unacceptable. In case of active operation and exploitation in dusty environments, it is recommended to clean and grease the parts as often as necessary arises. **WE DO NOT RECOMMEND** leaving power supplies (especially non-rechargeable) inside the flashlight for a long storage period, as they can leak for various reasons and damage the inner parts of the flashlight. If you want to keep your flashlight in a standby state with batteries in, previously install new and high-quality batteries, store the flashlight in acceptable for battery operational temperature, and revise the batteries' state at least once a month. If you have noticed any signs of defects, withdraw the batteries from the flashlight and dispose of them.

## **Warranty and Service**

Armytek provides free warranty repairs for 10 years (excluding batteries, chargers, mounts, holders, switches, and connectors, which have a 2-year warranty) from the date

of purchase if there is a document confirming the purchase. The warranty does not apply to magnets, silicone covers of connectors and buttons, silicone installation rings and holders, clips, silicone grips, holsters, lanyards, O-rings and pads, and Velcro tapes. The warranty also does not extend to damage during:

1. Improper usage.
2. Attempts to modify or repair the flashlight by non-qualified specialists.
3. Application in chlorinated, contaminated liquids or seawater.
4. Immersion in liquids in case of broken leakproofness.
5. Exposure to high temperatures and chemicals, including the liquids from defective batteries.
6. Usage of low-quality batteries.

### **Armytek Worldwide / Representative and importer in the EU**

- Germany, 10551 Berlin, Jonasstraße 6
- +1 (206) 785-95-74, +49 (30) 3119-68-00
- [service@armytek.com](mailto:service@armytek.com)
- [www.armytek.com](http://www.armytek.com)

### **FAQs**

#### **Q: Can I use the flashlight without batteries?**

A: Yes, the flashlight can work without batteries directly from a Powerbank or any USB power supply.

#### **Q: What is the peak beam intensity of the Elf C1 flashlight?**

A: The peak beam intensity is 2670 cd for the white light version and 2590 cd for the warm light version.

## **Documents / Resources**

|  |  |
|--|--|
|  | <p><a href="#">ARMYTEK ELF C1 Multi Flashlight [pdf] User Manual</a></p> <p>Elf C1 white light, Elf C1 warm light, ELF C1 Multi Flashlight, ELF C1, Multi Flashlight, Flashlight</p> |
|--|--|

## References

- [User Manual](#)

ARMYTEK, ELF C1, ELF C1 Multi Flashlight, Elf C1 warm light, Elf C1 white light, Flashlight, Multi

ARMYTEK Flashlight

—Previous Post

[ARMYTEK ELF C2 Multi Flash Light User Manual](#)

---

## Leave a comment

Your email address will not be published. Required fields are marked \*

Comment \*

Name

Email

Website

---

Save my name, email, and website in this browser for the next time I comment.

**Post Comment**

[Manuals+](#), [Privacy Policy](#) | [@manuals.plus](#) | [YouTube](#)

This website is an independent publication and is neither affiliated with nor endorsed by any of the trademark owners. The "Bluetooth®" word mark and logos are registered trademarks owned by Bluetooth SIG, Inc. The "Wi-Fi®" word mark and logos are registered trademarks owned by the Wi-Fi Alliance. Any use of these marks on this website does not imply any affiliation with or endorsement.