



ARKROCKET ARCP01 Coryphaus Turntable Record Player User Manual

[Home](#) » [ARKROCKET](#) » ARKROCKET ARCP01 Coryphaus Turntable Record Player User Manual 

Contents

- [1 ARKROCKET ARCP01 Coryphaus Turntable Record Player](#)
- [2 instructions](#)
- [3 Front View](#)
- [4 Quick Set Up](#)
- [5 Troubleshooting](#)
- [6 Needle Replacement](#)
- [7 Installing Needle](#)
- [8 Technical Specifications](#)
- [9 Documents / Resources](#)
 - [9.1 References](#)



ARKROCKET ARCP01 Coryphaus Turntable Record Player



instructions

Read and understand this entire manual before using this product. Keep these instructions for future reference.

1. Do not use this product near water.
2. This product should be operated only by the type of power source indicated on the marking label or in this instruction manual.
3. Do not defeat the safety purpose of the polarized plug. A polarized plug has two blades with one blade wider than the other. This plug will fit into the power outlet only one way. If you are unable to insert the plug fully into the outlet try
4. reversing the plug. If the plug should still fail to fit, contact your electrician.
5. Protect the power cord from being walked on or pinched particularly at plugs, convenience receptacles, and the point where they exit from the product.
6. Do not overload wall outlets, extension cords, or integral convenience receptacles as this can result in a risk of fire or electric shock.
7. Never push objects of any kind into this product through openings as they may touch dangerous voltage points or short-out parts that could result in a fire or electric shock. Never spill liquid of any kind on the product.
8. Do not attempt to service this product yourself as opening or removing covers may expose you to dangerous voltage or other hazards. Refer all servicing to qualified service personnel.
9. Changes or modifications to this unit not expressly approved by the party responsible for compliance could void the user's authority to operate the equipment.
10. Do not use attachments not recommended by the product manufacturer as they may cause hazards.
11. A product and cart combination should be moved with care. Quick stops, excessive force, and uneven surfaces may cause the product and cart combination to overturn. Slots and openings in the cabinet are provided for ventilation and to

12. ensure reliable operation of the product and to protect it from overheating. Do not block or cover these openings.
13. Unplug the product during lightning storm or when unused for long periods of time.

Front View

- A:Turnatble
- B:Tone Arm Rest with Arm Locking Clip
- C:Spindle
- D:Tone Arm
- E:Adapter E
- F:Counterweight
- G:Case
- H:Lever For Lifting
- Tone Arm
- I:Transmit ON/(Button
- J:USB REC USB Port
- K Stop Rec
- L:Line Port
- M: Mode Selection Dial R N:On/Off Switch And Volume Dial
- O:Operation Indictor Light
- P:Phone Headphone Port
- Q:Autostop Switch
- R:Speed Switch 78/45/33
- S:Pickup With Stylus
- T:Speaker

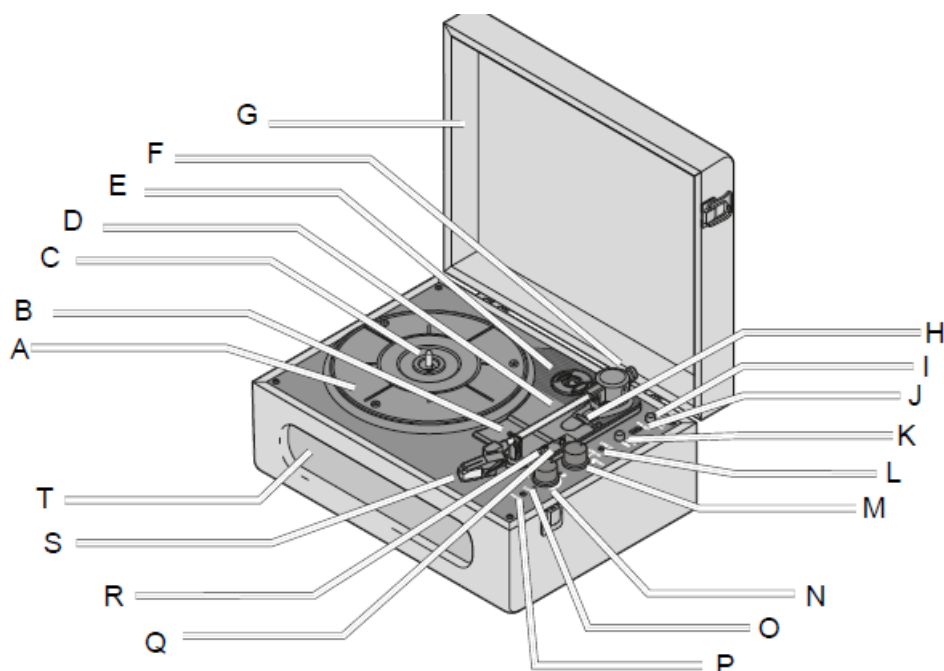

Back View

U: Line in Port

- Use to connect the turntable audio output to active external speakers.

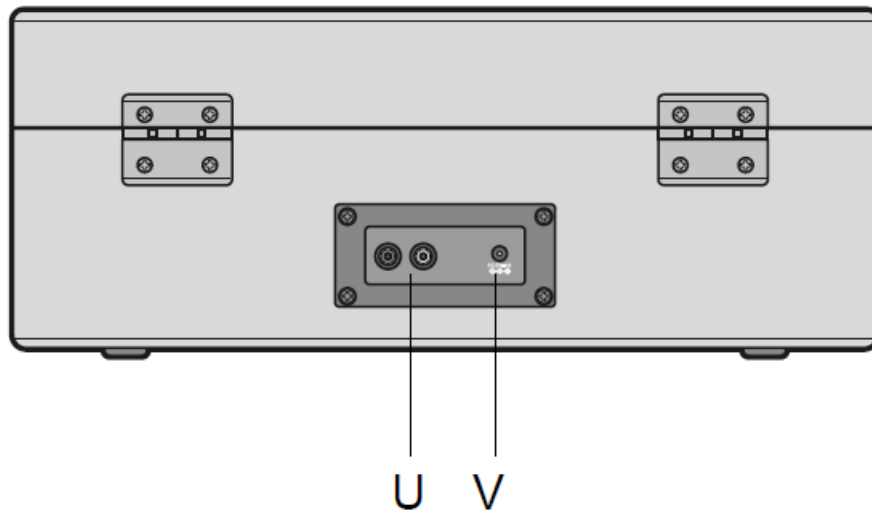

Quick Set Up

Power Operation

1. Insert the DC plug of the adapter into the DC Jack on the back of the unit.
2. Plug the AC Adapter plug into the mains outlet. Connecting this system to any other power source may cause damage to the system.

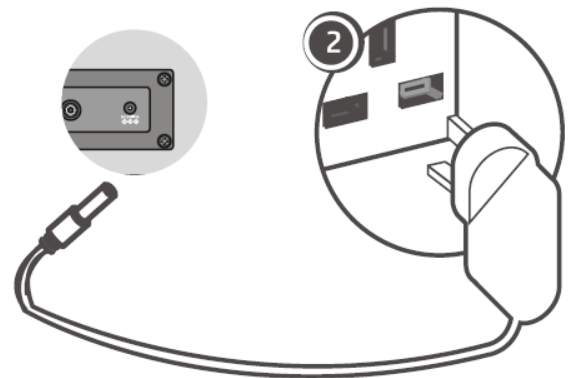
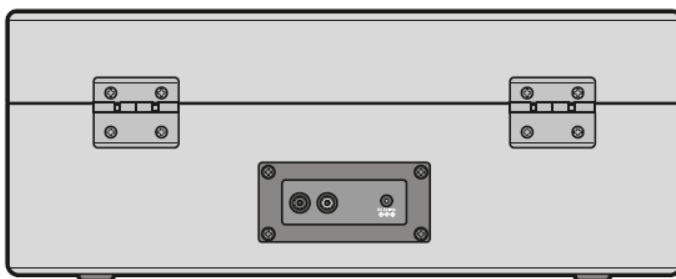

Bluetooth Operation

1. Turn the function control to the BT position, The blue indicator light will begin to flash.
2. Turn your devices Bluetooth setting on ,and search devices.
3. Select the Bluetooth pairing name " Arkrocket ARCP01 "to connect to the record player
4. Once you are connected the blue indicator light will stop flashing ,you can now play music from your device through your record player use the volume control dial to adjust the volume

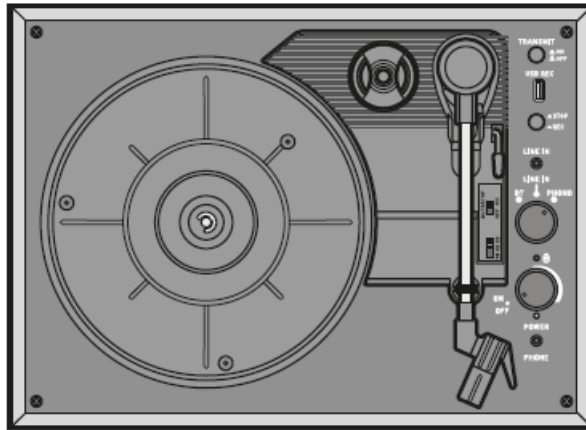

Note: After initial pairing the record player will stay paired to your device unless it is unpaired manually or the device is reset

Bluetooth transmitter Operation

1. Turn the function control to the Gramophone Transmit function, when a record player is working, the LED light will be flash.
2. Then units can be wireless connected with other device of Bluetooth speakers.
3. Once Paring successful ,the LED light will show blue and stop flash.

After finish the music transmit, you can listening record music with other device.

NOTE:When transmit connected ,the volume control knob on main unit is not controlled.

Line in Operation

1. Use an audio cable with one 3.5mm stereo plug on each end of the cable.
2. Plug one end into the line-in jack on the main unit and plug the other end of the cable into the line-out of your external audio device.
3. Turn on the unit and your external audio device.
4. To select auxiliary audio input turn the function control to the line-in position.
5. The volume level can now be controlled through the main unit, Operate all other functions on the auxiliary device as normal.

Line Out

1. You can listen to your new turntable using the built in speakers but you may wish to connect it to your existing Hi Fi system. Connect the audio plugs to the line input on your mixer or amplifier using an RCA cable.

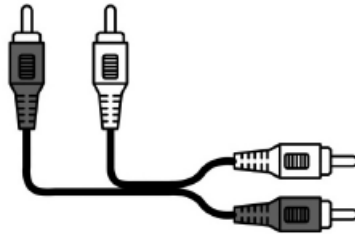
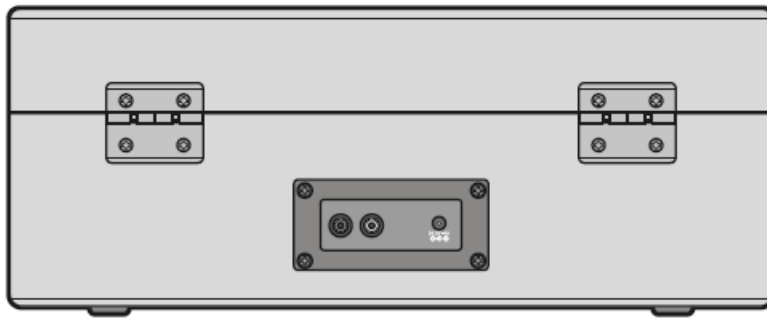

Line out cable not included

Headphone Out

1. Use a wired earphone or headphone (not included) and insert the 3.5mm stereo plug in phone jack on the turntable.

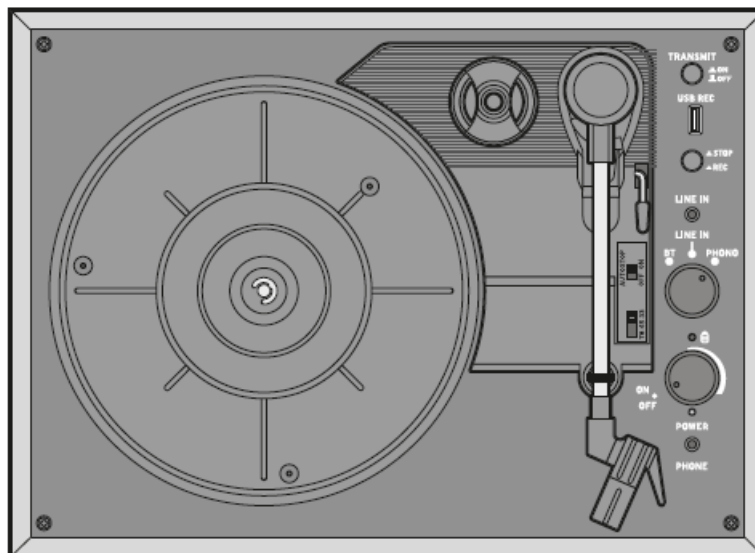

Playing a Record

1. Carefully holding the vinyl record by the edges, place the record on the Revive Turntable.
2. Turn on the power and select Phono mode.
3. Select the correct speed for the record that you want to play.
4. Release the tone arm lock.
5. Carefully raise the tone arm. The turntable will start to rotate.
6. Place the stylus over the first track of the record.
7. Put down the stylus slowly on to the record to play.
8. When a record reaches the end, the turntable will stop automatically if the autostop switch is in the ON position.

Troubleshooting

Problem	What to do
Power does not come on when the unit is switched on.	Plug the AC adapter into a wall outlet.
No sound comes out of the speakers.	Adjust the volume. Re-select the desired input source using the mode button
The unit does not respond.	Remove the power cord and all other power supplies from the device, and then plug in the unit again after one minute.
The sound is distorted when playing the record.	Place the stylus in the centre.
Unit gets warm after extended play at high volume.	Turn the unit off a period of time or lower volume.

Needle Replacement

Removing Needle

1. Gently pull down the front edge of the needle.
2. Pull needle forward.
3. Pull out and remove.

Installing Needle

1. Position the needle with its tip facing down.
2. Line up the back of the needle with the cartridge.
3. Insert the needle with its front end at a downward angle and gently lift the front of the needle upward until it snaps into place.

Technical Specifications

Model number	ARCP01
Bluetooth version	JL 5.1
Input	AC 100-240V ~50/60Hz
Power supply	5V = 1000mA
Speaker driver	3 INCH
Speaker power	2x3W
Dimensions	W355 x D120 x H278mm
Weight	3500g

Information on Waste Disposal

for Consumers of Electrical & Electronic Equipment This mark on a product and/or accompanying documents indicates that when it is to be disposed of, it must be treated as Waste Electrical & Electronic Equipment (WEEE). Any WEEE marked waste products must not be mixed with general household waste, but kept separate for the treatment, recovery and recycling of the materials used. For proper treatment, recovery and recycling; please take all WEEE marked waste to your Local Authority Civic waste site, where it will be accepted free of charge. If all consumers dispose of Waste Electrical & Electronic Equipment correctly, they will be helping to save valuable resources and preventing any potential negative effects upon human health and the environment, of any hazardous materials that the waste may contain.

Documents / Resources

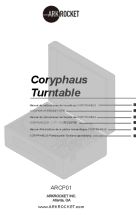
	<p>ARKROCKET ARCP01 Coryphaus Turntable Record Player [pdf] User Manual ARCP01 Coryphaus Turntable Record Player, ARCP01, Coryphaus Turntable Record Player, T urntable Record Player, Record Player, Player</p>
---	--

References

- [User Manual](#)