



## ARIZA B600 Bluetooth Key Finder Key Locator Device User Manual

[Home](#) » [ARIZA](#) » ARIZA B600 Bluetooth Key Finder Key Locator Device User Manual 

# ARIZA

Smart key finder  
Finding easy for your wallet,  
phone, keys, toys and other important items.

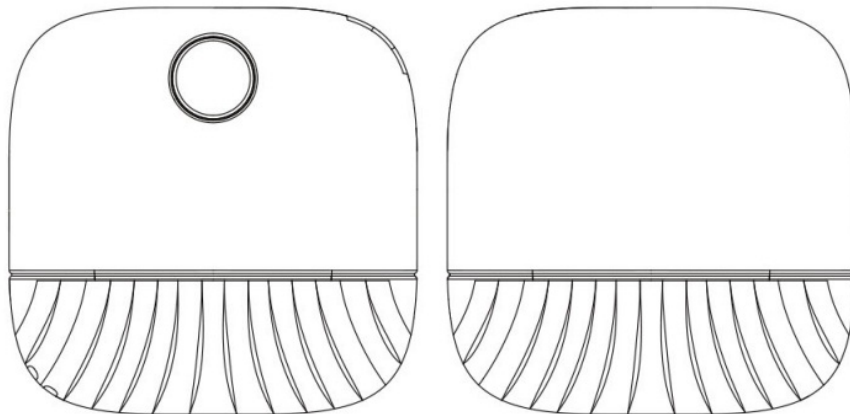

vi .0  
User manual

**Gct to know the Device**

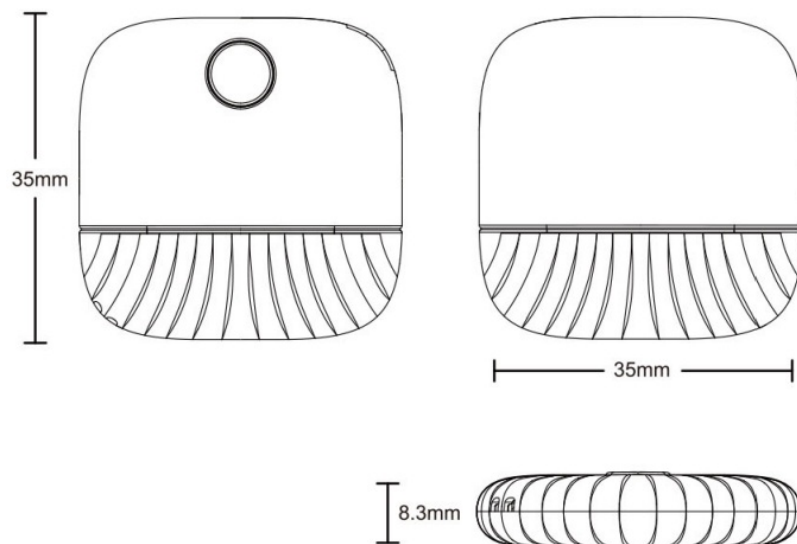

## Contents

- [1 Getting Started](#)
- [2 Functions](#)
- [3 Specifications](#)
- [4 FAQ](#)
- [5 FCC Caution](#)
- [6 Documents / Resources](#)
- [7 Related Posts](#)

## Getting Started

Download the App Search for "Smart life" App on Google Play or Apple App Store to download the App.



## Registration or log in

Open the "Smart life" App to register a new account or log in with your existed account.

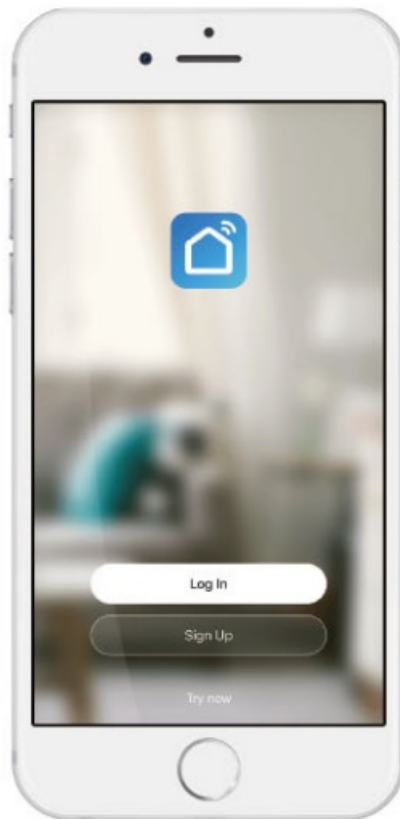

### Pair the device with your phone

Turning Bluetooth on before pairing the device with your phone's smart App allows adding multiple devices in one account.

1. Click the "Add device" or "+" button
2. Select 'Auto Scan' in the app.

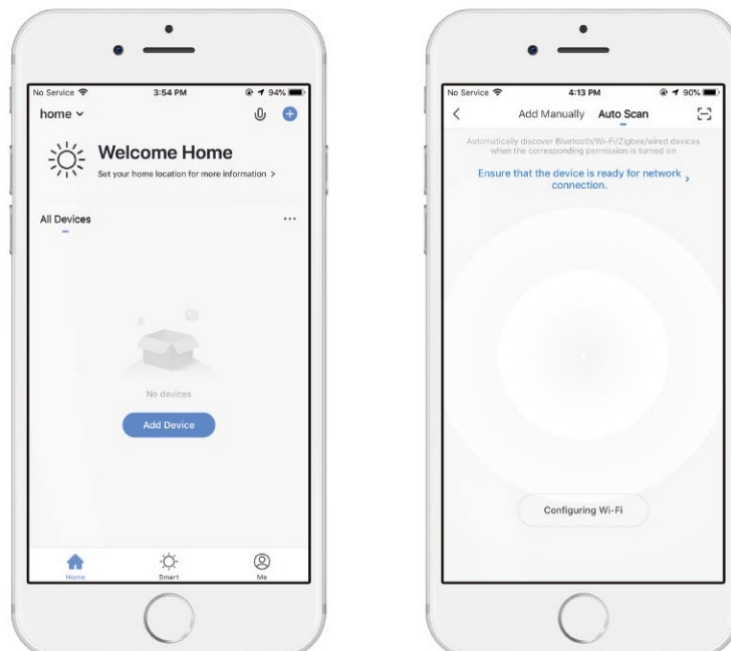

3. Put the device close to your phone. Press and hold the button until the device beeps. The app will detect the device automatically.

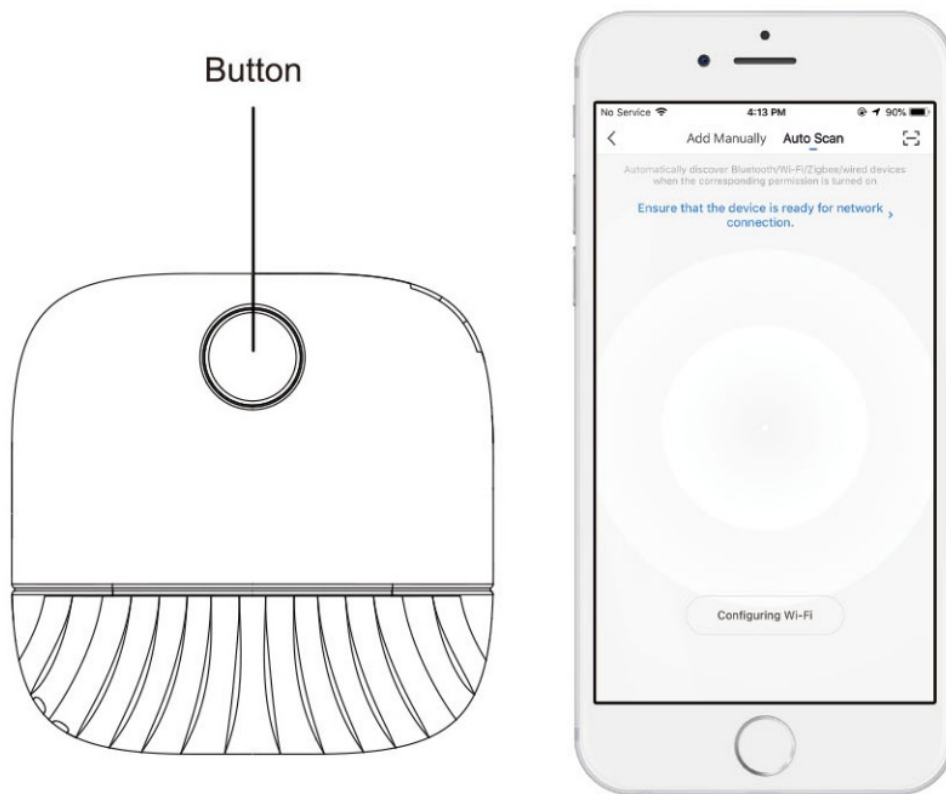

4. Click “Next” to finish the pairing, you will hear ‘beeps- when it pairs successfully.

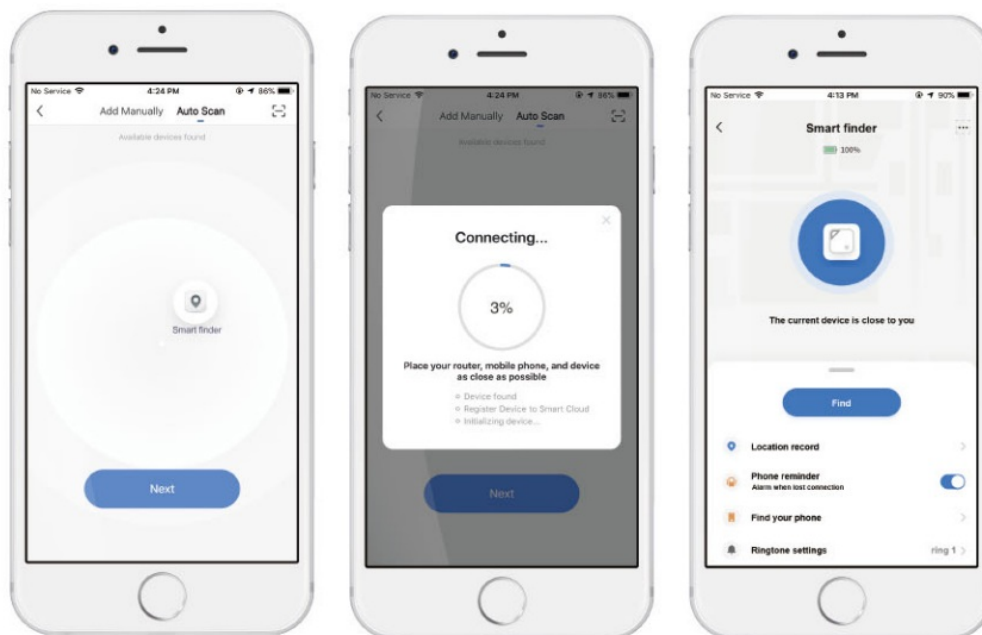

## Functions

### 1. Find your Items

Press the ‘Find” button in App to ring your device, you can follow the sound to find it.

### 2. Find your Phone

Press the button twice quickly on the device to ring your phone.

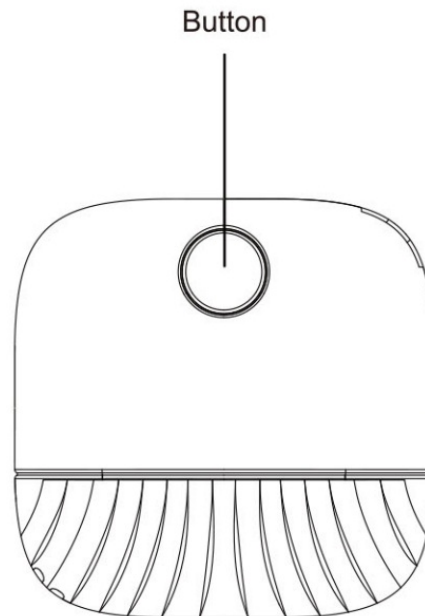
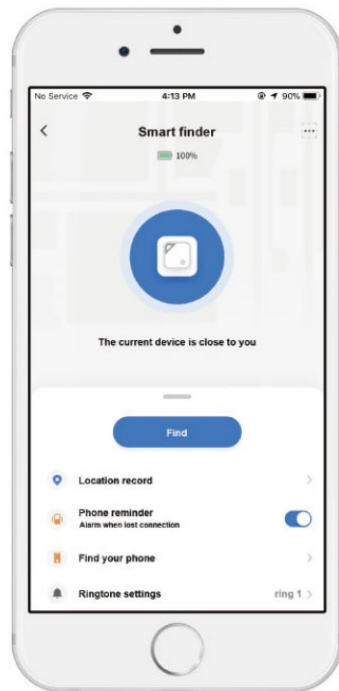

3. **Anti-Lost** When the distance between the mobile phone and the device is more than 40 meters. the Bluetooth is disconnected, both your phone and the device will make a sound.

#### 4. **Location Records**

Our app will record the latest “disconnected location” automatically, tap”location record” to view the location information.

#### 5. **Ringtone and Volume Setting**

Tap” Ringtone settings” to set the phone ringtone. Tap”Volume setting” to set the ringtone volume.

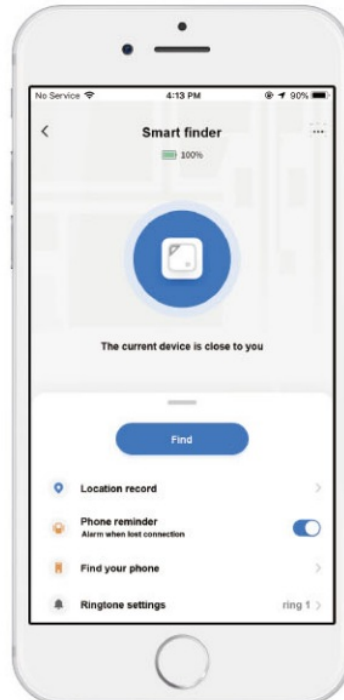
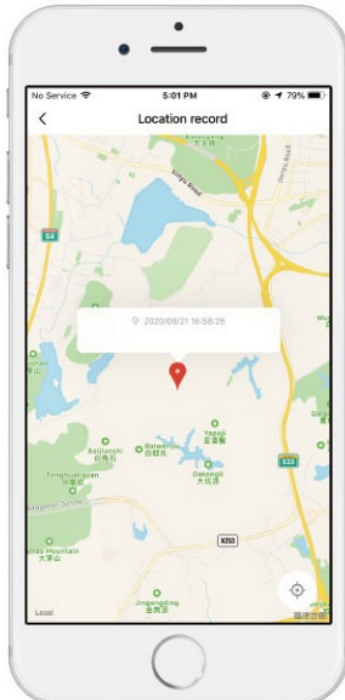

6. **Sharing, Rename the device, and Set the device icon**

Tap  at the upper right corner to go to device settings.

Tap the device name to edit the device name and device icon.

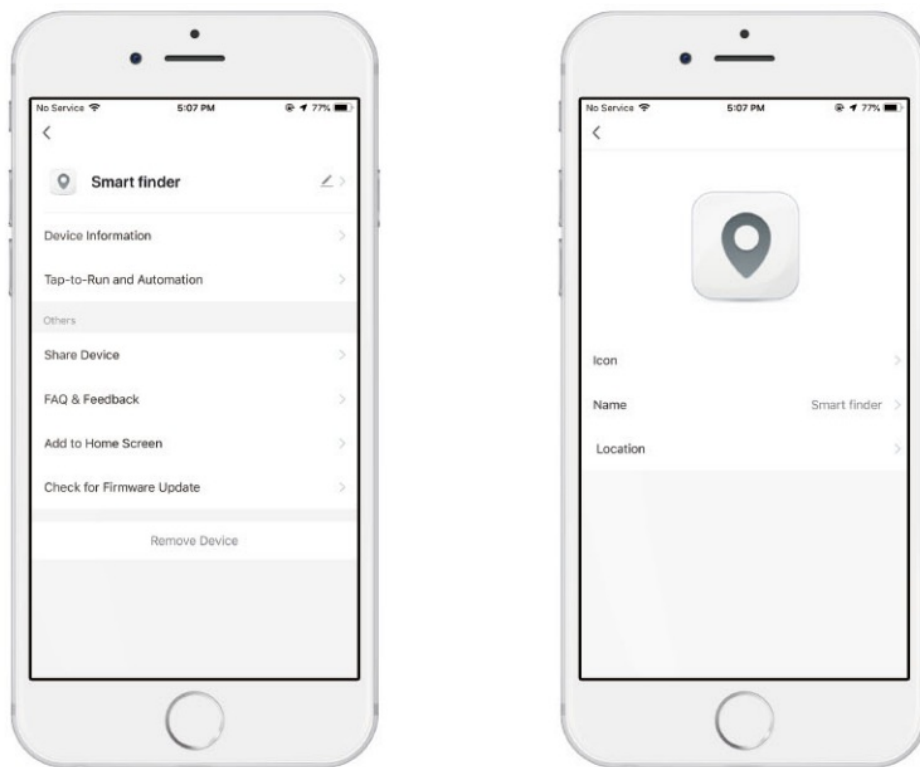

Tap “Share Device” to share the device with your family or your friends. Before you share the device, please confirm that your friend or your family member has an “Smart life”App account. There is no limit to the number of people sharing.

## Specifications

Features	Specifications
Battery	CR2032
No connection standby	560 days
Connected standby	180 days
Operating Voltage	DC-3V
Stand-by current	<40uA
Alarm current	<12mA
Low battery detection	Yes
Bluetooth frequency band	2.4G
Bluetooth distance	40 meters
Operating temperature	-10 C -70 C
Product shell material	ABS
Product size	35*35*8.3mm
Product Weight	IOg
Bluetooth	5.2

**Bluetooth:4.2+**

## **FAQ**

What is the effective distance between the phone and the device? The effective distance is determined by the environment. In an empty environment(Not obstructed place), it can reach a maximum of 40 meters. In-office or at home, there are walls or other barriers. the distance will be shorter about 10-20 meters.

### **How many devices can be added to one mobile phone at the same time?**

Android support 4 to 6 devices according to different brands. iOS support 12 devices.

### **What is the battery type and how to replace the battery?**

The battery is a CR2032 battery button. One battery can work for about 6 months. Hold the product with your left hand and the lanyard buckle with your right hand. Turn the lanyard buckle clockwise until you hear a “click”. Open the case from the crack and take out the battery. With the positive side of the new battery facing up, insert the new battery, and then close the case.

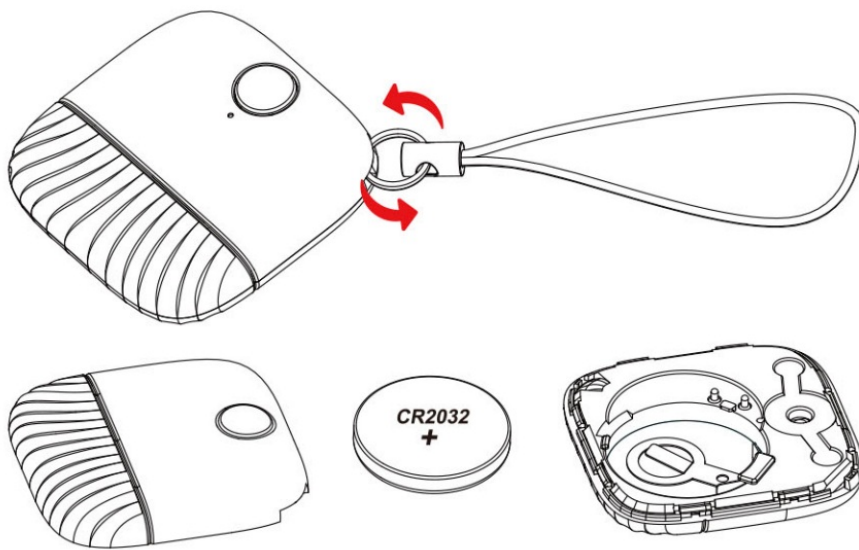

### **How to unbind the device from the phone?**

Tap  at the upper right corner to go to device settings, then tap “Remove Device” to unbind.

### **How to share the device with others?**

Please follow the below steps:

1. Confirm the added people have an account of the Smart life App.
2. Find the “Share device” option, then tap “Add Sharing”.
3. Enter his account to finish the sharing.

### **How to use the lanyard?**

You can open the shell and put the lanyard into it, or use a thin needle to pass the lanyard directly.

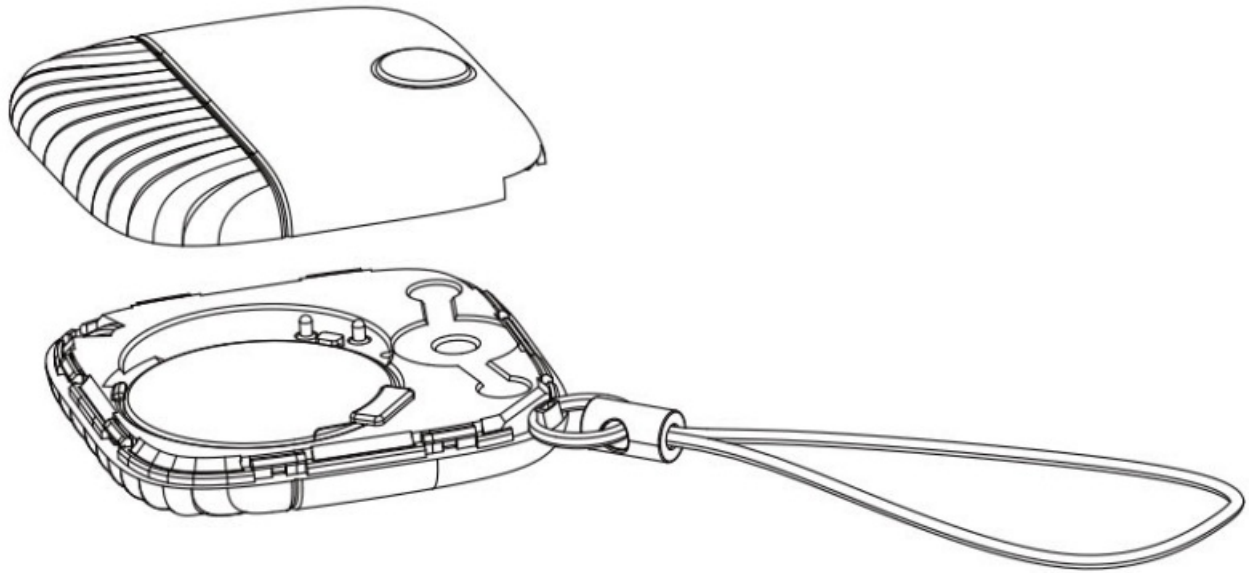

## FCC Caution

This device complies with part 15 of the FCC Rules. Operation is subject to the following two conditions: (1) This device may not cause harmful interference, and (2) this device must accept any interference received, including interference that may cause undesired operation.

Any changes or modifications not expressly approved by the party responsible for compliance could void the user's authority to operate the equipment.

**Note:** This equipment has been tested and found to comply with the limits for a Class B digital device, pursuant to part 15 of the FCC Rules. These limits are designed to provide reasonable protection against harmful interference in a residential installation. This equipment generates uses and can radiate radio frequency energy and, if not installed and used in accordance with the instructions, may cause harmful interference to radio communications. However, there is no guarantee that interference will not occur in a particular installation. If this equipment does cause harmful interference to radio or television reception, which can be determined by turning the equipment off and on, the user is encouraged to try to correct the interference by one or more of the following measures:

- Reorient or relocate the receiving antenna.
- Increase the separation between the equipment and receiver.
- Connect the equipment into an outlet on a circuit different from that to which the receiver is connected.
- Consult the dealer or an experienced radio/TV technician for help.

The device has been evaluated to meet general RF exposure requirements. The device can be used in portable exposure conditions without restriction.

## Documents / Resources



[ARIZA B600 Bluetooth Key Finder Key Locator Device](#) [pdf] User Manual  
B600, 2ATJ8-B600, 2ATJ8B600, Bluetooth Key Finder Key Locator Device, B600 Bluetooth Key Finder Key Locator Device