



## Aria X2 Transceiver WiFi and Bluetooth User Manual

[Home](#) » [Aria](#) » Aria X2 Transceiver WiFi and Bluetooth User Manual 

## Contents

- 1 Aria X2 Transceiver WiFi and Bluetooth
- 2 DOCUMENT VERSION
- 3 GENERAL INFORMATION
  - 3.1 INTRODUCTION
- 4 BOX CONTENTS
- 5 CUSTOMER SUPPORT
- 6 IMPORTANT NOTICE!
- 7 LIMITED WARRANTY (USA ONLY)
- 8 WARRANTY RETURNS
- 9 SAFETY GUIDELINES
- 10 INDOOR / DRY LOCATIONS USE ONLY!
- 11 OVERVIEW
- 12 REAR CONNECTIONS
- 13 DMX SETUP
- 14 DMX SETUP
- 15 INSTALLATION INSTRUCTIONS
- 16 INSTALLATION GUIDELINES
- 17 SYSTEM MENU
- 18 FREQUENCY & WIRELESS LOCATION GUIDELINES
- 19 FIRMWARE UPDATE
- 20 MAINTENANCE GUIDELINES
- 21 SPECIFICATIONS
- 22 DIMENSION DRAWINGS
- 23 OPTIONAL ACCESSORIES
- 24 FCC STATEMENT
- 25 Specifications
- 26 Frequently Asked Questions (FAQ)
  - 26.1 Q: Can I use the ARIA X2 TRANSCEIVER outdoors?
  - 26.2 Q: How often should I perform maintenance on the ARIA X2 TRANSCEIVER?
- 27 Documents / Resources
  - 27.1 References
- 28 Related Posts

## Aria X2 Transceiver WiFi and Bluetooth

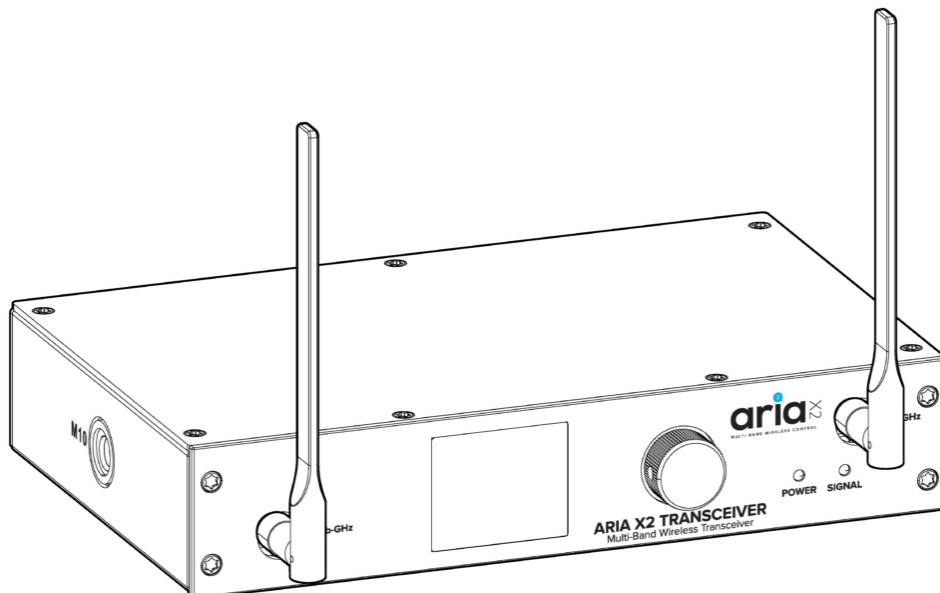

# USER MANUAL

## ARIA X2 TRANSCEIVER

The ARIA X2 TRANSCEIVER is a professional lighting product offered by Elation Professional. It is designed to provide reliable and efficient wireless communication for lighting setups in various environments.

©2024 ELATION PROFESSIONAL all rights reserved. Information, specifications, diagrams, images, and instructions herein are subject to change without notice. ELATION PROFESSIONAL logo and identifying product names and numbers herein are trademarks of ELATION PROFESSIONAL. Copyright protection claimed includes all forms and matters of copyrightable materials and information now allowed by statutory or judicial law or hereinafter granted. Product names used in this document may be trademarks or registered trademarks of their respective companies and are hereby acknowledged. All non-ELATION brands and product names are trademarks or registered trademarks of their respective companies.

ELATION PROFESSIONAL and all affiliated companies hereby disclaim any and all liabilities for property, equipment, building, and electrical damages, injuries to any persons, and direct or indirect economic loss associated with the use or reliance of any information contained within this document, and/or as a result of the improper, unsafe, insufficient and negligent assembly, installation, rigging, and operation of this product.

Elation Professional USA | 6122 S. Eastern Ave. | Los Angeles, CA. 90040

[323-582-3322](tel:323-582-3322) | [www.elationlighting.com](http://www.elationlighting.com) | [info@elationlighting.com](mailto:info@elationlighting.com)

Elation Professional B.V. | Junostraat 2 | 6468 EW Kerkrade, The Netherlands

+31 45 546 85 66 | [www.elationlighting.eu](http://www.elationlighting.eu) | [info@elationlighting.eu](mailto:info@elationlighting.eu)

Elation Professional Mexico | AV Santa Ana 30 | Parque Industrial Lerma, Lerma, Mexico 52000+52 [728-282-7070](tel:728-282-7070)

## DOCUMENT VERSION



Due to additional product features and/or enhancements, an updated version of this document may be available online. Please scan the QR Code with your mobile device or visit [www.elationlighting.com](http://www.elationlighting.com) for the latest revision/update of this manual, before installation and/or programming.

Date	Document Version	Software Version >	Modes	Notes
07/16/24	1	1.00	N/A	Initial Release
09/25/24	1.1	N/A	N/A	Updated DMX Setup

## GENERAL INFORMATION

### INTRODUCTION

Please read and understand the instructions in this manual carefully and thoroughly before attempting to operate this device. These instructions contain important safety and use information.

This product is intended for use by professionally trained personnel only, and is not suitable for private use.

## Unpacking

Every device has been thoroughly tested and has been shipped in perfect operating condition. Carefully check the shipping carton for damage that may have occurred during shipping. If the carton is damaged, carefully inspect the device for damage, and be sure all accessories necessary to install and operate the device have arrived intact. In the event damage has been found or parts are missing, please contact our customer support team for further instructions. Please do not return this device to your dealer without first contacting customer support. Please do not discard the shipping carton in the trash. Please recycle whenever possible.

## BOX CONTENTS

- 1.83M locking power cable
- 2 antennas

## CUSTOMER SUPPORT

Contact ELATION Service for any product related service and support needs.

Also visit [forums.elationlighting.com](https://forums.elationlighting.com) with questions, comments or suggestions.

ELATION SERVICE USA – Monday – Friday 8:00am to 4:30pm PST

[323-582-3322](tel:323-582-3322) | [support@elationlighting.com](mailto:support@elationlighting.com)

ELATION SERVICE EUROPE – Monday – Friday 08:30 to 17:00 CET

+31 45 546 85 63 | [support@elationlighting.eu](mailto:support@elationlighting.eu)

REPLACEMENT PARTS – please visit [parts.elationlighting.com](https://parts.elationlighting.com)

## IMPORTANT NOTICE!

THERE ARE NO USER SERVICEABLE PARTS INSIDE THIS UNIT.

DO NOT ATTEMPT ANY REPAIRS YOURSELF; DOING SO WILL VOID YOUR MANUFACTURER'S WARRANTY. DAMAGES RESULTING FROM MODIFICATIONS TO THIS FIXTURE AND/OR THE DISREGARD OF SAFETY INSTRUCTIONS AND GUIDELINES IN THIS MANUAL VOID THE MANUFACTURER'S WARRANTY AND ARE NOT SUBJECT TO WARRANTY CLAIMS AND/OR REPAIRS.

## LIMITED WARRANTY (USA ONLY)

A. Elation Professional hereby warrants, to the original purchaser, Elation Professional products to be free of manufacturing defects in material and workmanship for a period of two years (730 days), and Elation Professional product rechargeable batteries to be free of manufacturing defects in material and workmanship for a period of six months (180 days), from the original date of purchase. This warranty excludes discharge lamps and all product accessories. This warranty shall be valid only if the product is purchased within the United States of America, including possessions and territories. It is the owner's responsibility to establish the date and place of purchase by acceptable evidence, at the time service is sought.

B. For warranty service, send the product only to the Elation Professional factory. All shipping charges must be pre-paid. If the requested repairs or service (including parts replacement) are within the terms of this warranty, Elation Professional will pay return shipping charges only to a designated point within the United States. If any product is sent, it must be shipped in its original package and packaging material. No accessories should be shipped with the product. If any accessories are shipped with the product, Elation Professional shall have no liability what so ever for loss and/or damage to any such accessories, nor for the safe return thereof.

C. This warranty is void if the product serial number and/or labels are altered or removed; if the product is modified in any manner which Elation Professional concludes, after inspection, affects the reliability of the product; if the product has been repaired or serviced by anyone other than the Elation Professional factory unless prior written authorization was issued to purchaser by Elation Professional; if the product is damaged because not properly maintained as set forth in the product instructions, guidelines and/or user manual.

D. This is not a service contract, and this warranty does not include any maintenance, cleaning or periodic check-up. During the periods as specified above, Elation Professional will replace defective parts at its expense, and will absorb all expenses for warranty service and repair labor by reason of defects in material or workmanship. The sole responsibility of Elation Professional under this warranty shall be limited to the repair of the product, or replacement thereof, including parts, at the sole discretion of Elation Professional. All products covered by this warranty were manufactured after January 1, 1990, and bare identifying marks to that effect.

E. Elation Professional reserves the right to make changes in design and/or performance improvements upon its products without any obligation to include these changes in any products theretofore manufactured.

F. No warranty, whether expressed or implied, is given or made with respect to any accessory supplied with the products described above. Except to the extent prohibited by applicable law, all implied warranties made by Elation Professional in connection with this product, including warranties of merchantability or fitness, are limited in duration to the warranty periods set forth above. And no warranties, whether expressed or implied, including warranties of merchantability or fitness, shall apply to this product after said periods have expired. The consumer's and/or dealer's sole remedy shall be such repair or replacement as is expressly provided above; and under no circumstances shall Elation Professional be liable for any loss and/or damage, direct and/or consequential, arising out of the use of, and/or the inability to use, this product.

G. This warranty is the only written warranty applicable to Elation Professional products and supersedes all prior warranties and written descriptions of warranty terms and conditions heretofore published.

## **WARRANTY RETURNS**

All returned service items whether under warranty or not, must be freight pre-paid and accompany a return authorization (R.A.) number. The R.A. number must be clearly written on the outside of the return package. A brief description of the problem as well as the R.A. number must also be written down on a piece of paper and included in the shipping container. If the unit is under warranty, you must provide a copy of your proof of purchase invoice. Items returned without a R.A. number clearly marked on the outside of the package will be refused and returned at customer's expense. You may obtain a R.A. number by contacting customer support.

## **SAFETY GUIDELINES**

This device is a sophisticated piece of electronic equipment. To guarantee a smooth operation, it is important to follow all instructions and guidelines in this manual. Elation Professional is not responsible for injury and/or damages resulting from the misuse of this device due to the disregard of the information printed in this manual. Only the original included parts and/or accessories for this device should be used. Any modifications to the device, included and/or accessories will void the original manufactures warranty and increase the risk of damage and/or personal injury.



**PROTECTION CLASS 1 – FIXTURE MUST BE PROPERLY GROUNDED**



THERE ARE NO USER SERVICEABLE PARTS INSIDE THIS UNIT.  
DO NOT ATTEMPT ANY REPAIRS YOURSELF; DOING SO WILL VOID YOUR MANUFACTURER'S WARRANTY. DAMAGES RESULTING FROM MODIFICATIONS TO THIS FIXTURE AND/OR THE DISREGARD OF SAFETY INSTRUCTIONS AND GUIDELINES IN THIS MANUAL VOID THE MANUFACTURE'S WARRANTY AND ARE NOT SUBJECT TO ANY WARRANTY CLAIMS AND/OR REPAIRS.



DO NOT PLUG FIXTURE INTO A DIMMER PACK!  
NEVER OPEN THIS FIXTURE WHILE IN USE!  
UNPLUG POWER BEFORE SERVICING FIXTURE!  
NEVER TOUCH FIXTURE DURING OPERATION, AS IT MAY BE HOT!  
KEEP FLAMMABLE MATERIALS AWAY FROM FIXTURE!



## **INDOOR / DRY LOCATIONS USE ONLY!**

- DO NOT EXPOSE FIXTURE TO RAIN AND MOISTURE!
- DO NOT shake the device; avoid brute force when installing and/or operating the device.
- DO NOT operate the device if the power cord is frayed, crimped, damaged, and/or if any of the power cord connectors are damaged and do not insert into the fixture securely with ease.
- NEVER force a power cord connector into the device. If the power cord or any of its connectors are damaged, replace it immediately with a new one of a similar power rating.
- When installing the fixture in a suspended environment, always use mounting hardware that is no less than M10 x 25 mm, and always install the fixture with an appropriately rated safety cable.
- Always disconnect the fixture from the main power source before performing any type of service and/or cleaning procedure.
- Only handle the power cord by the plug end; never pull out the plug by tugging the wire portion of the cord.
- During the initial operation of this fixture, light smoke or a smell may emit from the interior of the fixture. This is a normal process and is caused by excess paint in the interior of the casing burning off from the heat associated with the lamp and will decrease gradually over time.
- Consistent operational breaks will ensure the fixture functions properly for many years.

- ONLY Use the original packaging and materials to transport the fixture for service.

## OVERVIEW

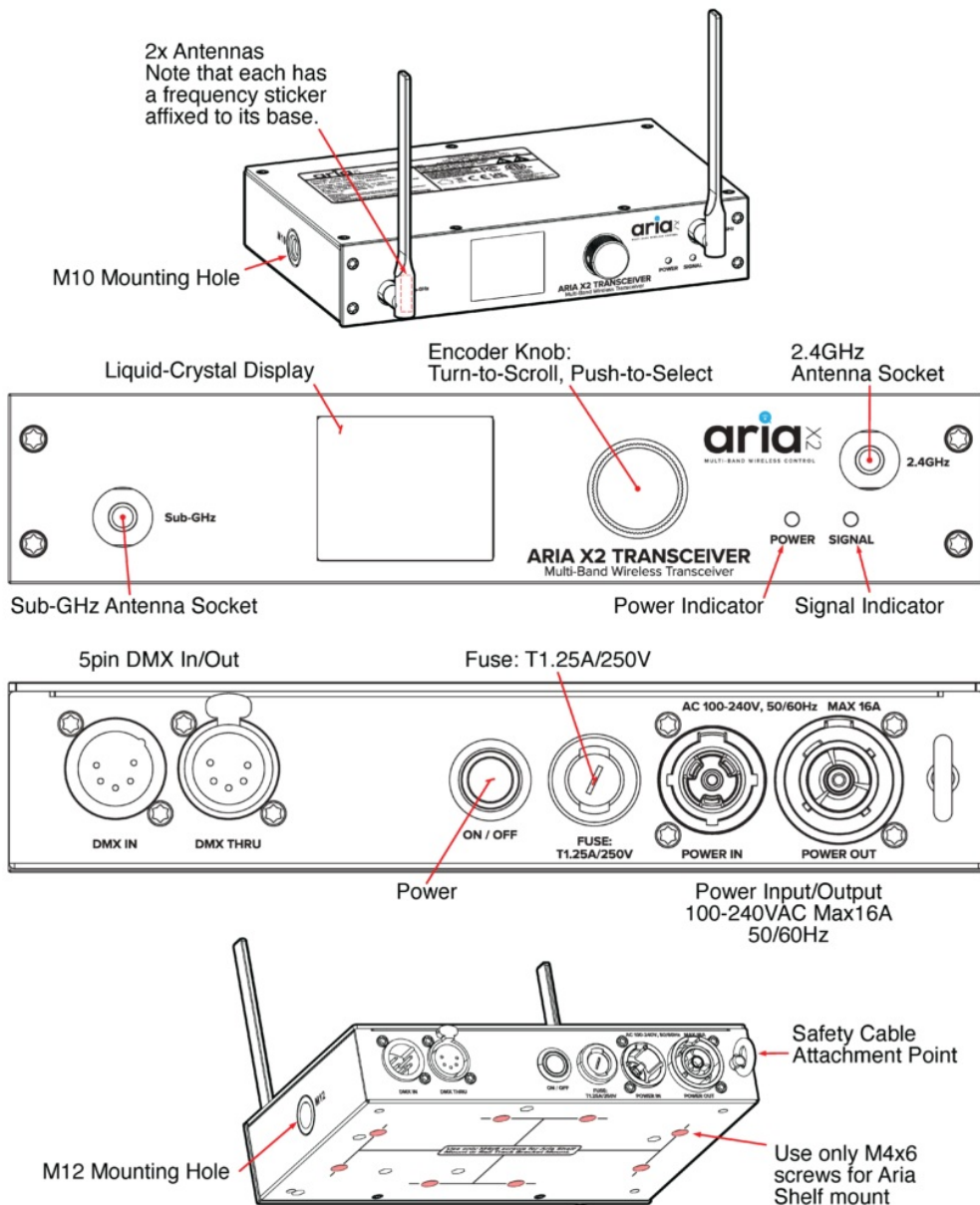

## REAR CONNECTIONS

### AC CONNECTIONS

The Aria X2 Transceiver is rated for 100-240V 50/60Hz, and accepts AC mains power within that range. Do not connect it to power outside this range. Note that the device uses a T1.25A/250V fuse. Damage resulting from incorrect connection is not covered under warranty. A cable with a NEMA 15-5P plug is provided for use with the NET 8 in the USA and Canada. This approved cable must be used in North America.



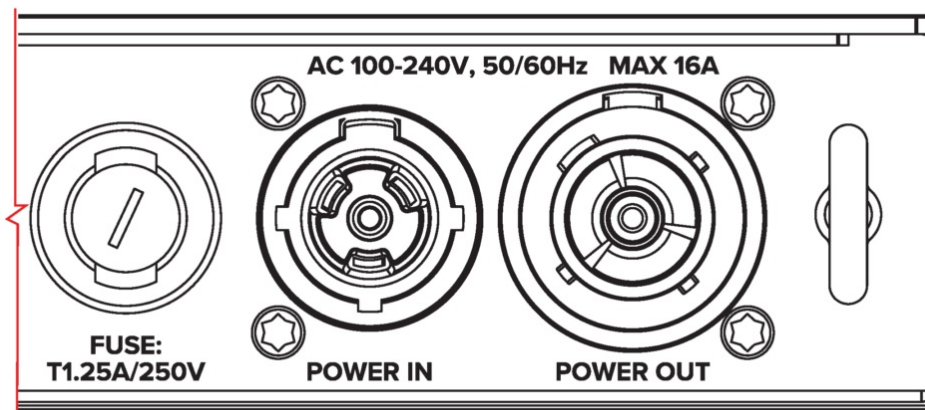

## DMX CONNECTIONS:

The DMX Input/Output connections are 5pin male/female XLR. The pin-out on the socket is pin 1 to shield, pin 2 to cold (-), and pin 3 to hot (+). Pins 4 and 5 are not used. Carefully connect DMX cables to the respective ports. To prevent damaging the DMX ports, provide strain relief and support. Avoid connecting FOH Snakes to the ports directly.

Pin	Connection
1	Com
2	Data -
3	Data +
4	Not connected
5	Not connected

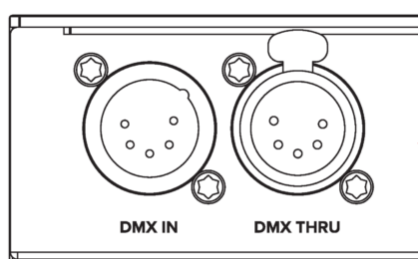

## DMX SETUP

### DMX-512:

Digital Multiplex, or DMX, serves as a universal protocol utilized by most lighting and controller manufacturers for communication between intelligent fixtures and controllers. A DMX controller sends DMX data instructions from the controller to the fixture. DMX data is transmitted as serial data, traveling from fixture to fixture through the DATA 'IN' and DATA 'OUT' XLR terminals found on all DMX fixtures. Most controllers only have a DATA 'OUT' terminal.

### DMX LINKING:

As a language, DMX enables all makes and models from different manufacturers to be connected and operated from a single controller, provided that all fixtures and the controller are DMX compliant. To ensure proper DMX data transmission when using multiple DMX fixtures, use the shortest cable path possible. The order in which fixtures are connected in a DMX line does not affect the DMX addressing. For example, a fixture assigned a DMX address of 1 can be placed anywhere in a DMX line—at the beginning, at the end, or anywhere in the middle. Therefore, the first fixture controlled by the controller could be the last fixture in the chain. When a fixture is assigned a DMX address of 1, the DMX controller knows to send data assigned to address 1 to that unit, regardless of its position in the DMX chain.

### DATA CABLE (DMX CABLE) REQUIREMENTS:

The Aria X2 Transceiver can be controlled via the DMX-512 protocol. The DMX address is electronically set using the controls on the front panel of the unit. Both the unit and the DMX controller require an approved DMX-512 110 Ohm Data cable for data input and output. Accu-Cable DMX cables are recommended. If you are making your own cables, ensure that you use standard 110-120 Ohm shielded cable (which can be purchased at most professional sound and lighting stores). Cables should be made with a male and female XLR connector on either end of the cable. Additionally, keep in mind that DMX cable must be daisy-chained and cannot be split.





### **LINE TERMINATION:**

When using longer runs of cable, one may need to use a terminator on the last unit to avoid erratic behavior. A terminator is a 110-120 ohm 1/4-watt resistor, which connects between pins 2 and 3 of a male XLR connector (DATA + and DATA -). Insert this unit into the female XLR connector of the last unit in your daisy chain to terminate the line. Using a cable terminator (ADJ part number Z-DMX/T) will decrease the possibilities of erratic behavior.

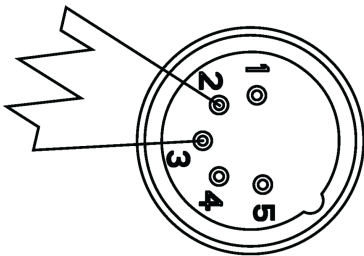

A DMX512 terminator reduces signal errors, avoiding most signal reflection interference. Connect PIN 2 (DMX-) and PIN 3 (DMX+) of the last fixture in series with a 120 Ohm, 1/4 W Resistor to terminate the DMX512.

### **DMX SETUP**

#### **ARIA X2 TRANSCEIVER OPERATION INSTRUCTION**

**Transmitter Mode:** When transmitting, the signal indicator turns orange. You can set either 2.4G or Subgig to choose a different channel.

**Receiver Mode:** When you set the device to receiver mode with the same frequency (2.4G or Subgig) and channel as the transmitter device, the LED indicator turns green. You can then control the lighting.

#### **ARIA X2 TRANSCEIVER AS TRANSMITTER**

When you connect the Aria X2 Transceiver to a DMX controller, the DMX signal indicator turns green.

The indicator of the Aria X2 Transmitter turns orange, which indicates that it is in a transmitting status. Please note that the transmitting unit will automatically connect to other nearby Aria X2

Transceiver units that have been set to the same frequency setting.

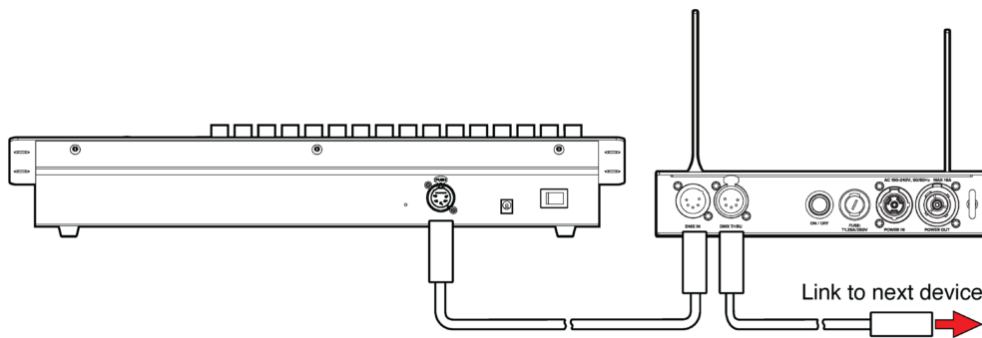

## ASSIGNING DEVICE LABELS

Devices can be assigned a custom label, in order to help distinguish individual devices from one another. To do so, use the encoder knob to navigate to the Label menu in the main menu, then select either Rename or Modify and enter in the desired label for the device.

- + Rename allows the user to create a new label from scratch, starting with a completely blank label.
- + Modify allows the user to begin with the label that is currently in use (which by factory default will be “Aria X2 T”), and make changes to that label.

## INSTALLATION INSTRUCTIONS

- **DISCONNECT POWER BEFORE PERFORMING ANY MAINTENANCE!**
- **ELECTRICAL CONNECTIONS**
  - A qualified electrician should be used for all electrical connections and/or installations.
  - USE CAUTION WHEN POWER LINKING OTHER MODEL DEVICES AS THE POWER CONSUMPTION OF OTHER MODEL DEVICES MAY EXCEED THE MAXIMUM POWER OUTPUT OF THIS DEVICE. CHECK SILK SCREEN FOR MAXIMUM AMPS.
  - THE ARIA X2 TRANSCEIVER IS DESIGNED TO BE TRUSS-MOUNTED; HOWEVER, IT CAN BE USED STAND-ALONE, WHERE THE DEVICE MUST SIT ON A FIRM FLAT SURFACE.

Device MUST be installed following all local, national, and country commercial electrical and construction codes and regulations.

## POWER LINKING

USE CAUTION WHEN POWER LINKING AS THE POWER CONSUMPTION MAY EXCEED THE MAXIMUM POWER OUTPUT ON THIS DEVICE. CHECK SILK SCREEN FOR MAXIMUM AMPS.

## INSTALLATION GUIDELINES

### RACK MOUNT INSTALLATION

1. Slide the Aria X2 Transceiver units into the rear of the Rack Shelf.
2. Align the mounting holes on the bottom of each Aria X2 Transceiver with the corresponding holes on the Rack Shelf, and secure each unit to the Rack Shelf with (4x) M4x6 screws.

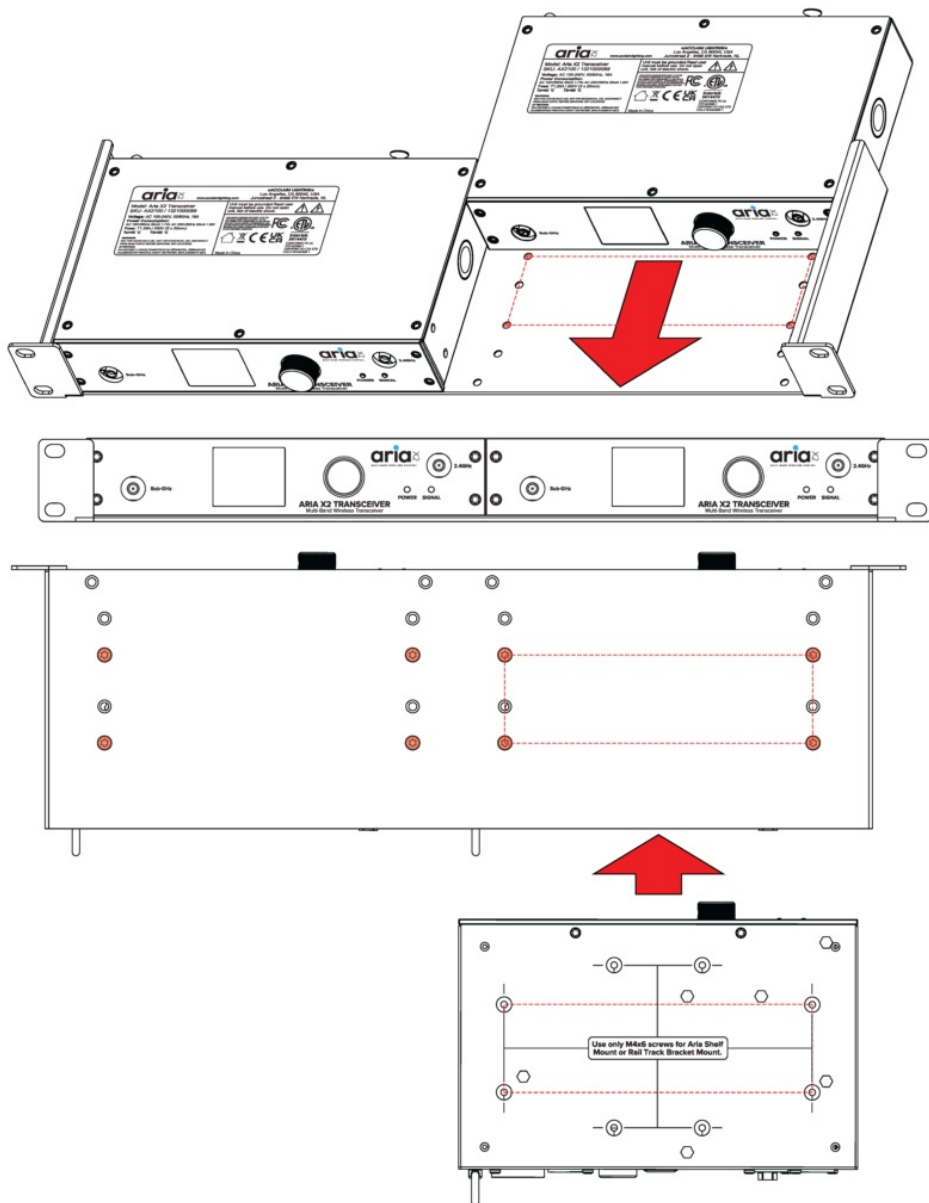

### ARIA RACK SHELF (SOLD SEPARATELY):

3. Align the mounting holes of the Aria Rack Shelf Ears with the corresponding vertical holes on the rack, making sure to position the device at the desired height.
4. Insert (4x) screws through the mounting holes of the 19" Rack Shelf Ears, and securely tighten them.
5. Ensure that the devices are firmly mounted to the 19" Rack Shelf, and that it is securely attached to the rack before connecting any cables.

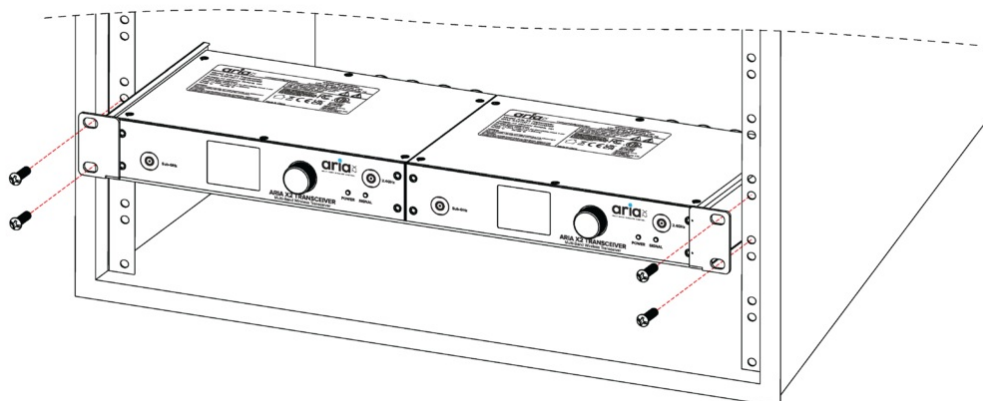

## 35MM DIN RAIL ADAPTERS (SOLD SEPARATELY):

1. Secure 2x 35mm DIN Rail Adapters to the bottom of the Aria X2 Transceiver using (2x) M4x6 screws.
2. Mount the Aria X2 Transceiver by aligning the 35mm DIN Rail Adapters with the slots on the 35mm DIN rail. Slide the Aria X2 Transceiver onto the rail until it clicks or locks into place to securely.

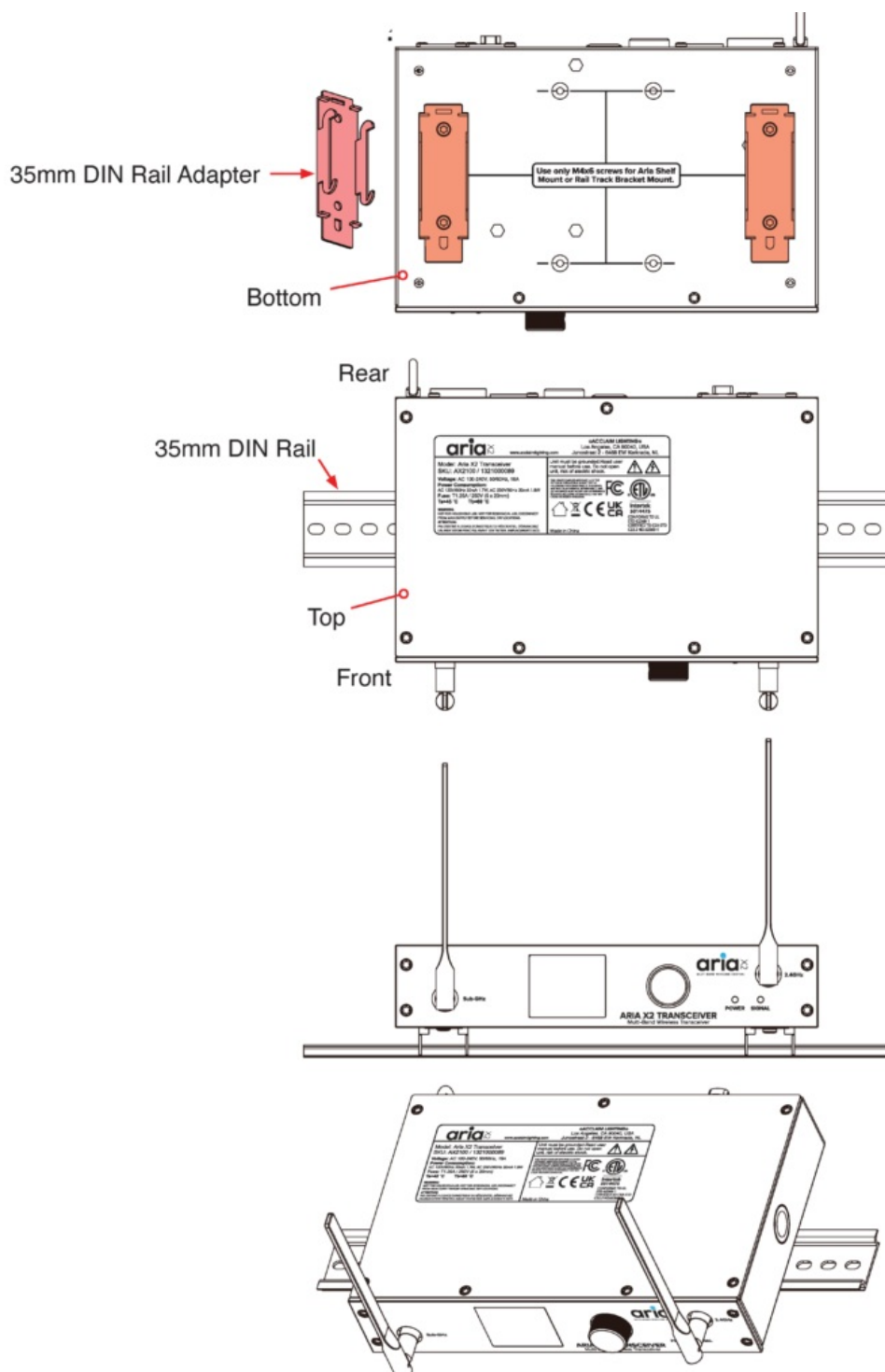

## TRUSS MOUNT INSTALLATION

Insert 18.8 steel M10x20mm or M12x25mm bolt (not included) through the respective mounting hole of the clamp (not included), and then thread it into the matching 10M hole (shown below left), or 12M hole (shown below right). The bolt must be threaded at least 18mm (0.7ins) into the fixture base.

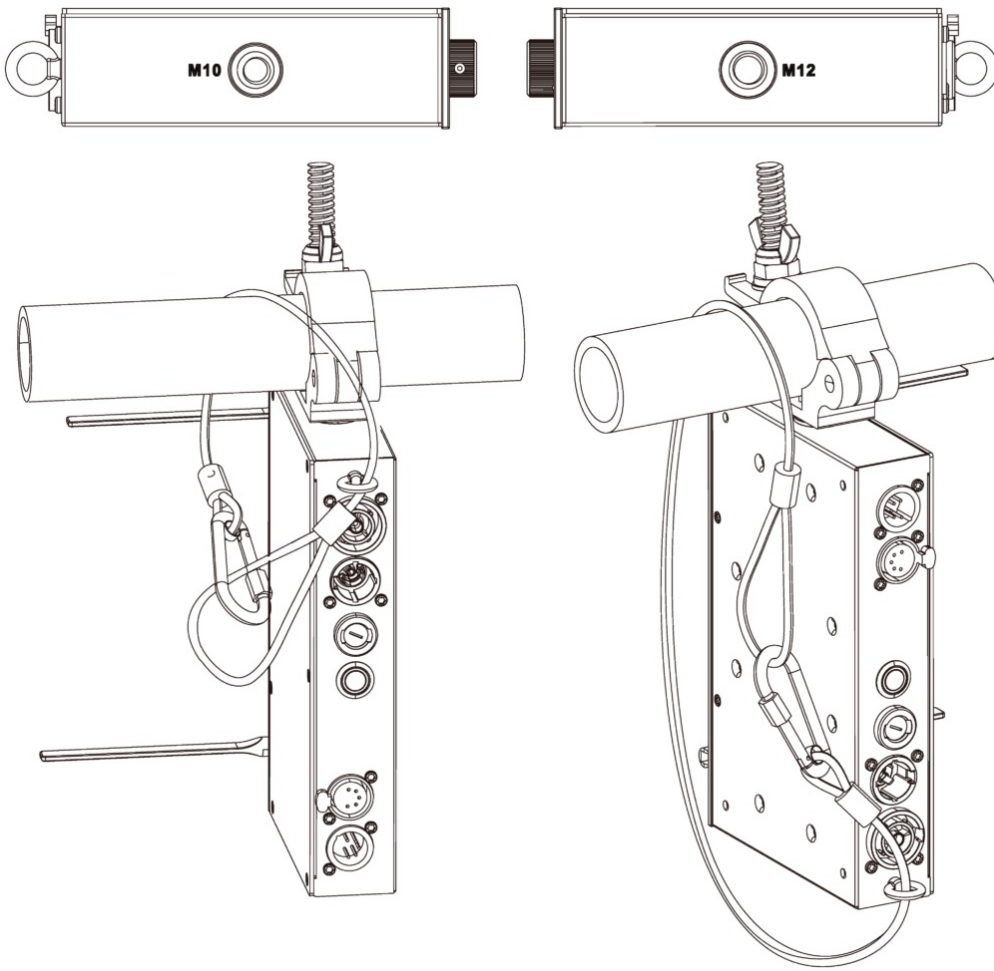

FALLING FIXTURES CAN CAUSE SEVERE INJURY OR SERIOUS EQUIPMENT





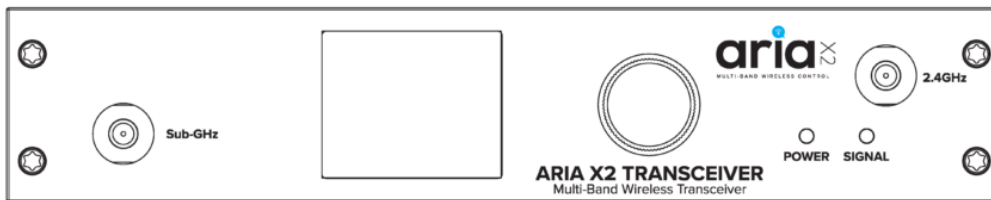

DAMAGE! FOR THIS REASON, FIXTURES SHOULD BE INSTALLED AND INSPECTED ONLY BY QUALIFIED PERSONNEL. DO NOT INSTALL THE UNIT IF YOU LACK THE QUALIFICATIONS TO DO SO, OR IF YOU HAVE DOUBTS ABOUT THE SAFETY AND SECURITY OF THE INSTALLATION SETUP OR LOCATION!

ALWAYS ATTACH A SAFETY CABLE WHENEVER INSTALLING THIS FIXTURE IN A SUSPENDED ENVIRONMENT TO ENSURE THE FIXTURE WILL NOT FALL IF THE CLAMP FAILS.

## SYSTEM MENU

The Aria X2 Transceiver features an LCD display screen with an Encoder Knob, which can be used to easily adjust any device settings, turn to scroll, push-to-select.



MAIN MENU	OPTIONS / VALUES (Default Settings in <b>BOLD</b> )		
<b>Aria Settings</b> 	Frequency	<b>2.4Ghz.</b>	<b>2.4 GHz</b>
		Sub Gig US	
		Sub Gig EU	
	2.4 Ghz. CH	00~15	<b>1</b>
	Sub Gig CH	00~09	<b>1</b>
	Mesh	ON/OFF	<b>OFF</b>
	Bluetooth	ON/OFF	<b>ON</b>
<b>Display</b> 	Timeout	<b>OFF</b> - 10 minutes	<b>OFF</b>
	Passcode	Enable/ <b>Disable</b>	<b>Disable</b>
	Edit Passcode	Passcode	<b>xxx</b>
	Screen Rotation	YES / NO / <b>Auto</b>	<b>Auto</b>
<b>Label</b> 	Rename	AaBbCcDd...()~+0123456789	<b>Aria X2 T</b>
	Modify		
<b>Service</b> 	Passcode	Factory Restore	<b>YES / NO</b>
<b>Information</b> 	Software Version	x.xx	
	RDM UID	xxxxxx	
	Label	xxxxxx	
<b>Esc</b> 			

## FREQUENCY & WIRELESS LOCATION GUIDELINES

### 2GHZ Versus Sub-Gig (GHz) Frequencies:

Sub-GHz frequencies provide superior reliability and range compared to higher frequencies, making them perfect for consistent communication across vast distances or in difficult conditions. Devices operating in the sub-GHz range, which refers to frequencies below 1 GHz, can transmit signals over significant distances and can penetrate physical barriers such as walls and buildings more effectively.

Additionally, these frequencies experience less interference compared to those in the heavily congested 2.4-GHz band, which is commonly used by wireless devices.

In the United States, the 900 MHz band is a versatile frequency range that is utilized by various services, with the FCC overseeing its allocation and regulation.

In the European Union, the 868 MHz frequency is designated by ETSI as the Sub-Gig frequency.

In summary, if an application demands high data rates and more bandwidth in urban or densely populated areas where interference management is feasible, the 2.4 GHz frequency is a suitable choice. On the other hand, for applications requiring long-range communication and better obstacle penetration, particularly in rural or industrial settings with fewer regulatory constraints, a sub-GHz frequency (<1 GHz) is a better option.

### Installation Recommendations:

With the many factors that affect and/or interrupt a wireless signal such as walls, glass, metal, objects, and

people, it is highly recommended to:

Install devices a minimum of 9.8 ft. (3m) above audiences and/or ground level where practical.

Adjust the wireless antenna in a vertical upright position

« Position devices in direct line of sight of the controlling E-FLY device

Careful planning and testing of the selected installation location is critical to ensure optimum and reliable wireless operation.

9.8 ft (3m)  
Above Ground



## **FIRMWARE UPDATE**

1. First, turn on the fixture and ensure that Bluetooth is enabled.
2. Next, open the Aria X2 app on your phone and press the 'Refresh' button. The app will search for devices and display the current software version of the fixture and Aria module.
3. To update the fixture, press 'Update', select 'Aria X2', click 'Update Radios', then click 'Update Fixture'.
4. Click the upload icon, select the fixture update file from your phone, and then click 'Update 1 Radio'. The fixture will begin updating, and after it finishes, the software file version and update date will be displayed.
5. To update the Aria module, follow the same steps, but select 'Update Aria' instead.

## **MAINTENANCE GUIDELINES**

**DISCONNECT POWER BEFORE PERFORMING ANY MAINTENANCE!**

### **FUSE REPLACEMENT**

Locate and remove the unit's power cord. Once the cord has been removed, locate the fuse holder next to the power socket. Insert a flat-head screw driver into the slot, and gently turn the cover of the fuse holder. Remove the bad fuse, and replace with a new one. Double check silkscreen for fuse value (T1.25A/250V).

### **CLEANING**

Frequent cleaning is recommended to ensure proper function, optimized light output, and an extended life. The frequency of cleaning depends on the environment in which the fixture operates: damp, smoky, or particularly dirty environments can cause greater accumulation of dirt on the fixture's optics. Clean the external lens surface periodically with a soft cloth to avoid dirt/debris accumulation.

NEVER use alcohol, solvents, or ammonia-based cleaners.

## **MAINTENANCE**

Regular inspections are recommended to ensure proper function and extended life.

There are no user serviceable parts inside this fixture, please refer all other service issues to an authorized ADJ service technician. Should you need any spare parts, please order genuine parts from your local ADJ dealer.



Please refer to the following points during routine inspections:

- A detailed electrical check by an approved electrical engineer every three months, to make sure the circuit contacts are in good condition in order to prevent overheating.
- Be sure all screws and fasteners are securely tightened at all times. Loose screws may fall out during normal operation, resulting in damage or injury as larger parts could fall.
- Check for any deformations on the housing, rigging hardware, and rigging points (ceiling, suspension, trussing).
- Electric power supply cables must not show any damage, material fatigue, or sediments.
- NEVER remove the ground prong from the power cable.

## **SPECIFICATIONS**

### **Features:**

Single DMX Universe

Sub-GHz, 2.4 GHz WiFi and Bluetooth

Configuration via App (Coming Soon) or Front panel

Wireless to DMX or DMX to Wireless

### **Supported Protocols:**

DMX

RDM (Planned for future software release)

Proprietary 802.15.4

Aria X2 Mesh Protocol

Bluetooth 5.2 (BLE)

Aria X2 Serial Protocol

This is our proprietary serial protocol for communicating with a variety of fixtures.

### **RF Characteristics:**

Frequency range

2404-2480 MHz

863-870 MHz (EU)

902-928 MHz

Radio module: Aria X2

Interference mitigation

CSMA

Adaptive frequency hopping (on the roadmap)

OTA updates

### **Connectors:**

Antenna: 5G JT SMA

DMX: 5-pin XLR Input and Output

DC: 2.5mm/5.5mm Barrel connector

Outdoor Locking Power Input and Output

### **Power:**

AC100-240V 50/60Hz

### **Power Consumption:**

AC120V 60Hz 30mA 1.7W

AC230V 50Hz 20mA 1.9W

Power Fuse: T1.25A/250V. (5 x 20mm)

### **Physical:**

IP20 Aluminum / Metal enclosure

Front panel digital screen and rotary knob

M10 and M12 Threads

Safety Eyelet

Max ambient operating temp: 113°F (45°C)

Max operating humidity: <75%

Storage temperature: 77°F (25°C)

Rack and wall mount accessories

**Dimensions and Weight:**

Length: 6.46" (164mm)

Width: 8.48" (215.30mm)

Height: 1.66" (42mm)

2.7lbs (1.23kgs.)

**DIMENSION DRAWINGS**

Drawings not to scale

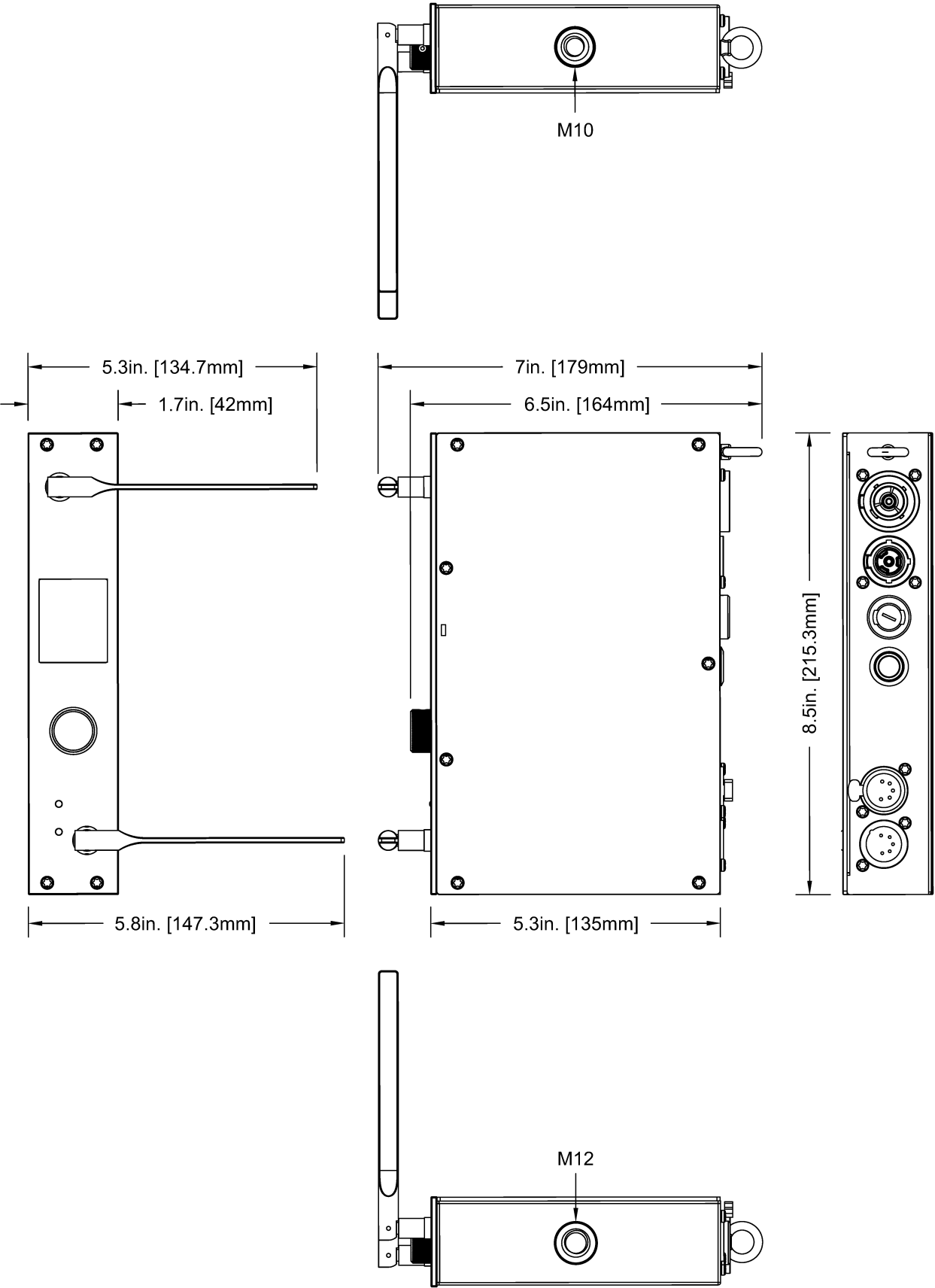

**OPTIONAL ACCESSORIES**

ORDER CODE		ITEM
US	EU	
AX2100	1321000089	ARIA X2 TRANSCEIVER
AX2113	1321000090	ARIA X2 BRIDGE
TOU027	N/A	Tour Link 5P10
		Additional Cable Lengths Available



## FCC STATEMENT

This device complies with Part 15 of the FCC Rules. Operation is subject to the following two conditions: (1) this device may not cause harmful interference, and (2) this device must accept any interference received, including interference that may cause undesired operation.

## FCC RADIO FREQUENCY INTERFERENCE WARNINGS & INSTRUCTIONS

This product has been tested and found to comply with the limits as per Part 15 of the FCC Rules. These limits are designed to provide reasonable protection against harmful interference in a residential installation. This device uses and can radiate radio frequency energy and, if not installed and used in accordance with the included instructions, may cause harmful interference to radio communications. However, there is no guarantee that interference will not occur in a particular installation. If this device does cause harmful interference to radio or television reception, which can be determined by turning the device off and on, the user is encouraged to try to correct the interference by one or more of the following methods:

- » Reorient or relocate the device.
- + Increase the separation between the device and the receiver.
- + Connect the device to an electrical outlet on a circuit different from which the radio receiver is connected.
- + Consult the dealer or an experienced radio/TV technician for help.

## Energy Saving Matters (EuP 2009/125/EC)

Saving electric energy is a key to help protecting the environment. Please turn off all electrical products when they are not in use. To avoid power consumption in idle mode, disconnect all electrical equipment from power when not in use. Thank you!

## Specifications

**Product:** ARIA X2 TRANSCEIVER

**Software Version:** 1.00

**Modes:** N/A

**Date:** 07/16/24 09/25/24

**Document Version:** 1.1

## Frequently Asked Questions (FAQ)

**Q: Can I use the ARIA X2 TRANSCEIVER outdoors?**

**A:** No, it is recommended to use the fixture in indoor/dry locations only and avoid exposure to rain and moisture to prevent damage.

**Q: How often should I perform maintenance on the ARIA X2 TRANSCEIVER?**

**A:** Regular maintenance checks should be performed to ensure optimal performance. It is recommended to clean the fixture, check connections, and inspect for damage periodically.

## Documents / Resources

 <p>The image shows the cover of the 'ARIA X2 TRANSCEIVER User Manual'. It features the 'aria' logo at the top, a line drawing of the transceiver unit in the center, and the text 'ARIA X2 TRANSCEIVER User Manual' at the bottom.</p>	<p><a href="#">Aria X2 Transceiver WiFi and Bluetooth</a> [pdf] User Manual X2 Transceiver WiFi and Bluetooth, X2, Transceiver WiFi and Bluetooth, WiFi and Bluetooth, and Bluetooth, Bluetooth</p>
--	---

## References

-  [Topics | Elation Lighting Forums](#)
-  [elationlighting.eu](https://elationlighting.eu)
- [User Manual](#)

[Manuals+](#), [Privacy Policy](#)

This website is an independent publication and is neither affiliated with nor endorsed by any of the trademark owners. The "Bluetooth®" word mark and logos are registered trademarks owned by Bluetooth SIG, Inc. The "Wi-Fi®" word mark and logos are registered trademarks owned by the Wi-Fi Alliance. Any use of these marks on this website does not imply any affiliation with or endorsement.