

ARDESTO™
WMW-6104DG
Front Loading
Washing Machine



ARDESTO WMW-6104DG Front Loading Washing Machine Instruction Manual

[Home](#) » [ARDESTO](#) » ARDESTO WMW-6104DG Front Loading Washing Machine Instruction Manual 

Contents

- [1 ARDESTO WMW-6104DG Front Loading Washing Machine](#)
- [2 Specifications](#)
- [3 PRECAUTIONS](#)
- [4 Electrical hazard](#)
- [5 DEVICE DESCRIPTION](#)
- [6 DEVICE DIMENSIONS](#)
- [7 INSTALLATION INSTRUCTIONS](#)
- [8 WASHING MACHINE USAGE](#)
- [9 CARE AND MAINTENANCE](#)
- [10 TROUBLESHOOTING GUIDE](#)
- [11 FAQs](#)
- [12 Documents / Resources](#)
 - [12.1 References](#)
- [13 Related Posts](#)

ARDESTO™

ARDESTO WMW-6104DG Front Loading Washing Machine



Specifications

Model	WMW-6104DG
Rated washing capacity*	6.0 kg
Rated spin capacity*	6.0 kg
Rated voltage	220-240 V~ / 50 Hz
Rated washing power	250 W
Rated spin power	250 W
Rated heating power	1800 W
Maximum power	2000 W
Washing noise	62 dB(A)
Spin noise	75 dB(A)
Water pressure	0.05-0.85 MPa
Overall dimensions	598×465×845 (mm)

Note: The maximum weight of dry laundry for which the washing machine is designed should not exceed the nominal values.

PRECAUTIONS

1. This appliance can be used by children aged 8 years and above and persons with reduced physical sensory or mental capabilities or lack of experience and knowledge if they have been given supervision or instruction concerning the use of the appliance safely and understand the hazards involved. Children shall not play with the appliance. Cleaning and user maintenance shall not be done by children without supervision.
2. Children under 3 years of age should be kept away from the appliance unless they are under constant supervision.
3. If the supply cord is damaged, it must be replaced by the manufacturer, its service agent, or a similarly qualified person to avoid a hazard.
4. This appliance is intended to be used in household and similar applications such as:
 - staff kitchen areas in shops, offices, and other working environments;

- farmhouses;
 - By clients in hotels, motels, and other residential-type environments:
 - bed and breakfast type environments;
 - areas for communal use in blocks of flats or launderettes.
5. Do not block the inlet and outlet openings. For appliances with vents in the base, make sure nothing is blocking the vents.
 6. Before connecting the device to the mains, make sure that the voltage indicated in the technical specifications of the device corresponds to the voltage in the local network.
 7. Never use the washing machine near flammable objects or substances.
 8. The washing machine cannot be used if industrial chemicals have been used for cleaning.
 9. Keep the washing machine clean. Lint must not accumulate around the washing machine.
 10. Fabric softeners or similar products should be used according to the fabric softener instructions.
 11. Remove all items from the pockets before washing.
 12. The appliance must not be supplied through an external switching device such as a timer, or connected to a circuit that is regularly switched on and off by a utility.
 13. The appliance must not be installed behind a lockable door, a sliding door, or a door with a hinge on the opposite side to that of the device in such a way that a full opening of the device door is restricted.
 14. When the appliance is disconnected from the mains, the door lock can be opened even if the water level in the drum is high. Therefore, in any case, check the water level in the drum before opening the door. If the water level is high, do not open the door to avoid water leakage.
 15. The maximum weight of dry clothes for washing, for which the washing machine is designed, is 6 kg.

Electrical hazard

1. Use a 230 V ~ 10 A outlet with reliable grounding.
2. Hold the plug to insert and remove the power cord. Do not use a damaged power cord. If there is dirt on the plug of the power cord, wipe it with a dry cloth in time.
3. Do not insert or remove the power plug with wet hands.
4. When the device is not in use, for maintenance or cleaning, disconnect the device from the power supply.

Danger of fire or electric leakage

1. Do not place the washing machine near sources of fire and do not place volatile materials on it.
2. Do not pour water directly on the control panel of the washing machine.
3. Do not place the washing machine in a place with a significant amount of water and humidity.
4. Secure the drain pipe before use and ensure that the sewer is not blocked.

Risk of burns due to high temperature

1. When washing at high temperatures the door glass will get hot. Please do not touch the door glass, especially children.
2. When the door needs to be opened with high-temperature washing, please wait until the temperature drops to a safe temperature and the door lock is automatically unlocked.

Risk of injury

- 1. Keep the packaging materials out of the reach of children. Do not allow children to play with the packaging materials.
- 2. Children are not allowed to play with the washing machine or climb on it to play.
- 3. Close the door when the washing machine is not in use to prevent children from entering the washing machine.

Risk of washing machine damage

- 1. Do not put heavy objects on the washing machine.
- 2. Two people are required to move or service the washing machine.
- 3. Do not attempt to repair or modify the washing machine yourself. Repairs and maintenance of the washing machine should be performed only by representatives of an authorized service center.

Risk of damage to clothing





- 1. Please do not wash waterproof clothes, such as raincoats, down products, sleeping bags, etc.
- 2. Only machine-washable clothes can be washed. If in doubt, please follow the washing instructions on the garment.

Risk of explosion

- 1. Do not wash the clothes stained with kerosene, gasoline, diluent,t, and other flammable materials.
- 2. Do not operate the washing machine when the gas leaks.

DEVICE DESCRIPTION

Attachment specification

User manual (includes warranty card) Energy label and data sheet (the set depends on the country of destination)	Water supply hose	Wrench	Transportation bolt caps
			

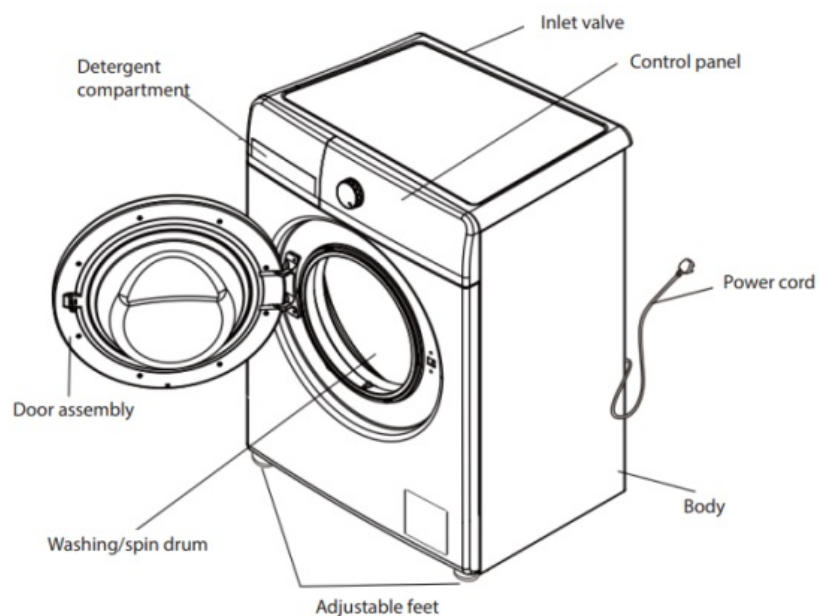

The images in the manual are for reference the actual device may vary.

Notes

1. When using it for the first time, some water may flow from the washing machine. This is what is left during the performance test at the factory. This phenomenon is normal.
2. After using, please pull out the power plug, and turn off the faucet to prevent unexpected water leakage and fire.

DEVICE DIMENSIONS

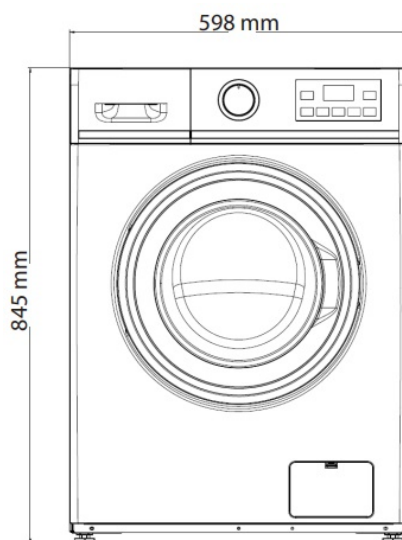

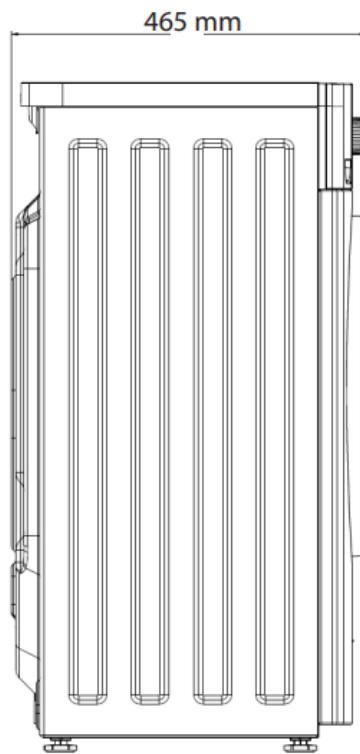

INSTALLATION INSTRUCTIONS

- Do not install or use the washing machine in areas where the temperature may drop below 0 °C, or where weather conditions may affect the operation of the appliance. Do not install outdoors.
- Install the washing machine according to this user manual and local standards.
- Adjust the feet to provide the necessary ventilation if the appliance is installed on a carpeted surface. Do not block the base vents.
- Keep the area around the device clean. Any damage caused by insects or other pests is not covered under warranty.

Transportation bolts disassembling

1. Transportation bolts are installed in the washing machine to prevent internal damage in transit.
2. Before using the washing machine dismantle 4 transportation bolts. If the bolts are not dismantled, violent vibration, noise, and trouble will be caused.
3. Disassemble the 4 shipping bolts, rubber pads, and plastic rods. Use the attached wrench to loosen the 4 bolts.
4. Use the supplied plastic plugs to cover the four holes.
5. The shipping bolts shall be installed every time before the washing machine is transported

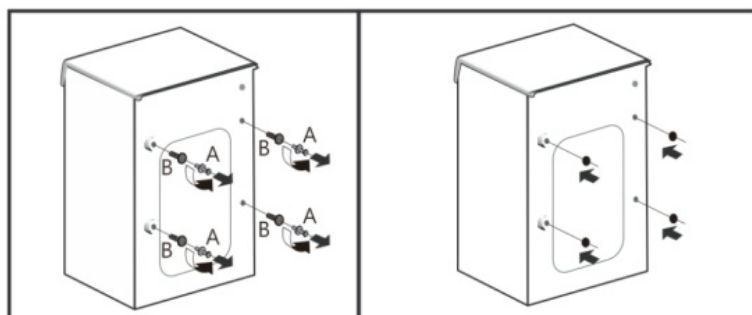

Note: please do not dismantle the drain pipe fixation.

Requirements for installation place

- The device must be installed on a solid, dry, clean, level surface.
- Horizontal adjustment: the tilt angle shall not exceed 1 degree.
- The distance between the washing machine and the outlet should be within 1.5 meters.
- Power outlet: don't use too many electrical appliances in one outlet.
- Allow sufficient safety distance between the washing machine and the wall (distance between the back/left/right of the washing machine and a wall >5cm).

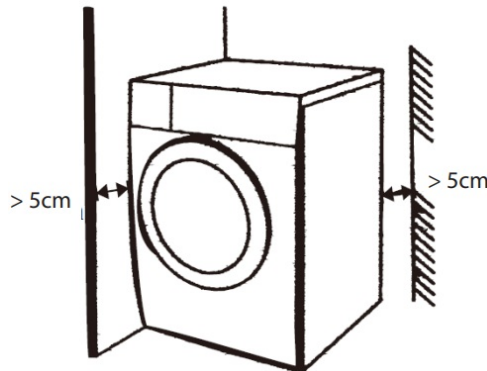

- Install the washing machine on a hard and flat floor with a drain. Do not install it on soft carpeted or wooden floors.
- Do not put clothes to be washed or other objects at the worktop of the washing machine because they will affect the normal operation.



Connecting the power supply

1. Do not use an extension cord.
2. If the power cord is damaged, it must be replaced by the manufacturer, service center, or similarly qualified personnel to avoid a hazard.
3. After use, remove the plug from the outlet and close the faucet.
4. Connect the power cord of the washing machine to a grounded power outlet and follow the wiring rules. If necessary, seek help from a qualified specialist.
5. The washing machine shall be installed at a place where it can connect to the power outlet easily.
6. Repair of the washing machine should be carried out only by specialists of an authorized service center.
7. If the washing machine has been at a temperature below 0 °C, e.g. during transportation, leave it at room temperature for at least 2 hours before connecting it.
8. The washing machine must have grounding devices. In the event of a malfunction, such a device can reduce the risk of electric shock. The device is equipped with a cable (including a wire and a grounded plug). A grounded plug must be inserted into the appropriate outlet.
9. Contact a professional to check if the washing machine is properly grounded. If the outlet and plug do not match, do not replace the plug.

10. If the washing machine smokes or emits a specific smell, turn off the power and contact a specialist.

Water inlet connection

The washing machine should be connected to the water inlet. Please use the new water supply hose from the delivery set. The old hose assembly cannot be reused. To ensure the quality, water injection tests are carried out before the device leaves the factory, so there may be water inside the internal tub, door seals, and normal door panels.

ATTENTION! Do not connect to hot water!

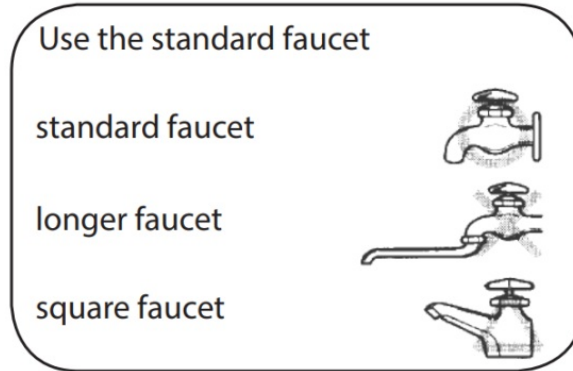

1. The water supply pressure shall be from 50kPa to 850kPa.
2. During the connection of the water supply hose and the inlet valve, do not screw them tightly to avoid slipping.
3. There are 2 seal rings in connectors at both ends of the water supply hose to prevent water from leaking.
4. Turn on the faucet to check the connectors for any water leakage.
5. Check the water supply hose regularly and replace it if necessary.
6. Make sure that the water supply hose is not warped or damaged.

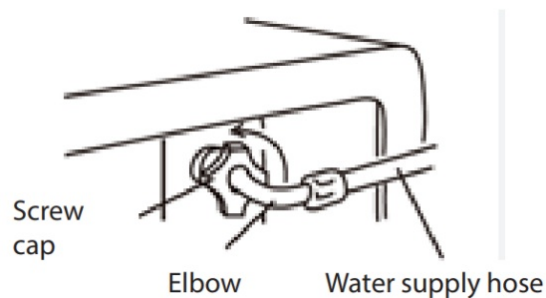

Connection of water supply hose to faucet

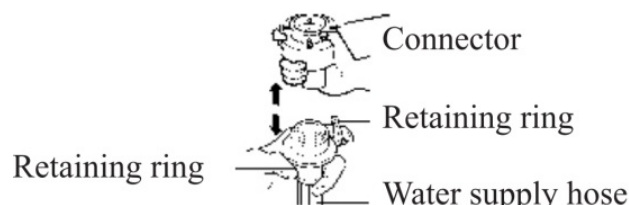

1. Hold the connector with one hand, press the retaining ring with the other hand, and pull it down to separate the connector from the water supply hose.

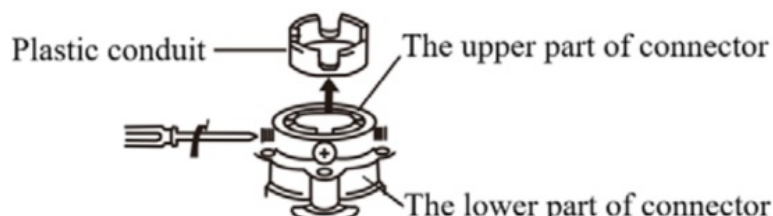

2. Loosen the four mounting screws on the upper part of the connector, and rotate the lower part of the connector

to leave a distance enough (equal to the height of 3 threads) for installing screws between the upper part and the lower part of the connector.

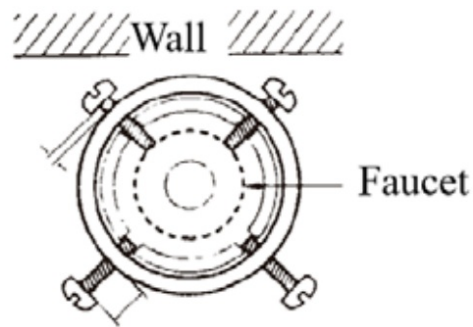

3. Adjust the four screws of the connector evenly so that two screws near the wall are fully in contact with the exterior of the faucet first. Screw near the wall can be screwed several threads in advance.

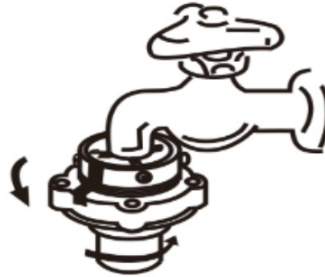

4. Hold the upper part of the connector against the mouth of the faucet so that the seal ring in the connector is fully in contact with the faucet (please do not take out the seal ring). Please choose a standard faucet, the faucet mouth must be smooth. If it is uneven, file it.

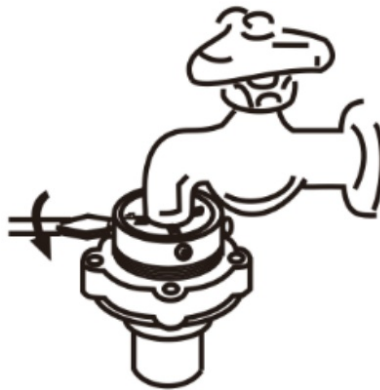

5. Rotate two screws opposite to the wall so that they are in contact with the faucet, and screw them with a screwdriver tightly.

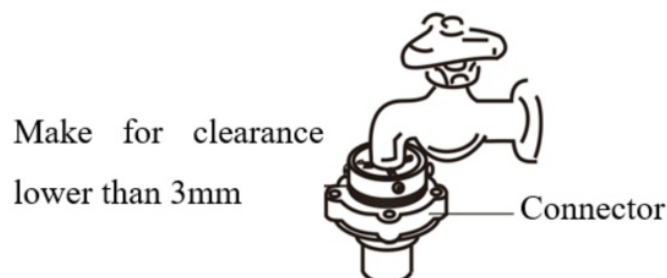

6. Rotate the lower part of the connector to screw it tightly (or else, water may leak from the connection). After rotation, the clearance between the lower part and the upper part of the connector shall be lower than 3mm.

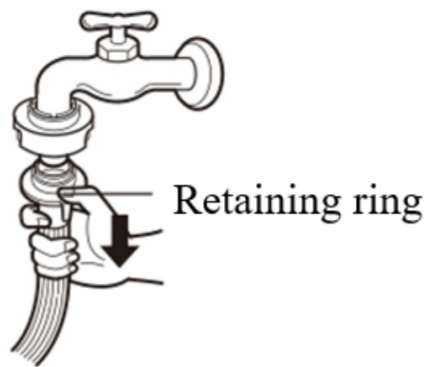

7. To remove the water supply hose, please press the retaining ring of the water supply hose.

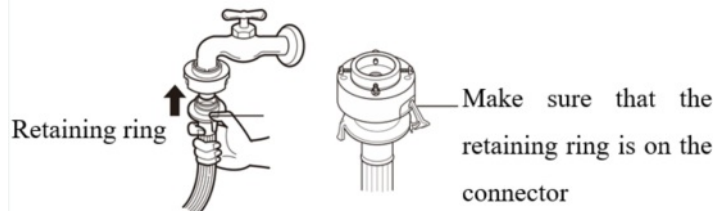

8. To install the water supply hose, please turn the retaining ring of the water supply hose back to release it.

9. Check whether or not the lower part of the connector and the water supply hose are connected firmly.

- Screw the connector of the water supply hose and the inlet valve tightly. Slowly turn on the faucet to check for water leakage.
- If water leaks from the connection, please turn off the faucet and assemble it again. (Water may leak from the connection if the upper part of the connector is not assembled correctly or the upper part and the lower part of the connector are not screwed on tightly.)
- After using it for a long time, the connection may be loosened. Then, please assemble parts again by following steps 1-9. (If it is necessary to assemble the connector of the water supply hose after a move, please follow steps 1-9 too.)

NOTES

- If a special faucet shown in the figure below is used, please take the following steps to assemble the parts:

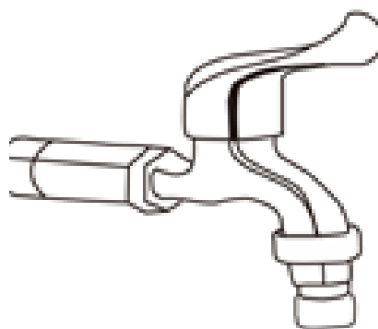

Replace the original connector with the supplied standard connector.

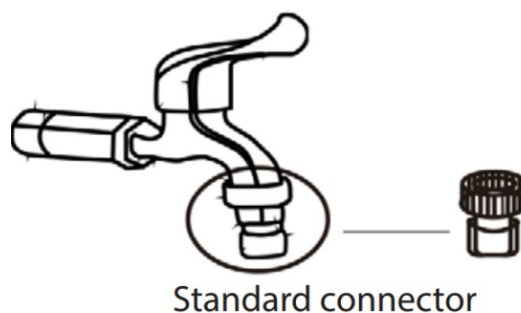

Hold the connector with one hand, press the retaining ring with the other hand, and pull it down to separate the connector from the water supply hose.

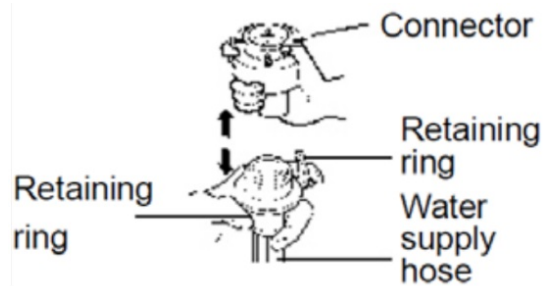

Press both sides of the retaining ring and pull it down to insert the water supply hose into the standard connector directly

- The washing machine is designed for home use only. Do not use it on ships, travel trucks, or airplanes.
- If the washing machine will be not used for a long time (such as on vacations), please turn off the faucet.
- Packaging materials (such as films and foams) can be dangerous to children, and may cause suffocation!

Notes: Keep all packaging material out of the reach of children.

Installing the drain hose

- To ensure normal operations of the washing machine, the inner diameter or width of the end of the drain hose to be inserted into the sewer shall be no less than 4cm.
- The height of the outlet of the drain hose shall be within a certain range. For specific data, please refer to the figure below. The end of the drain hose cannot be immersed in water.

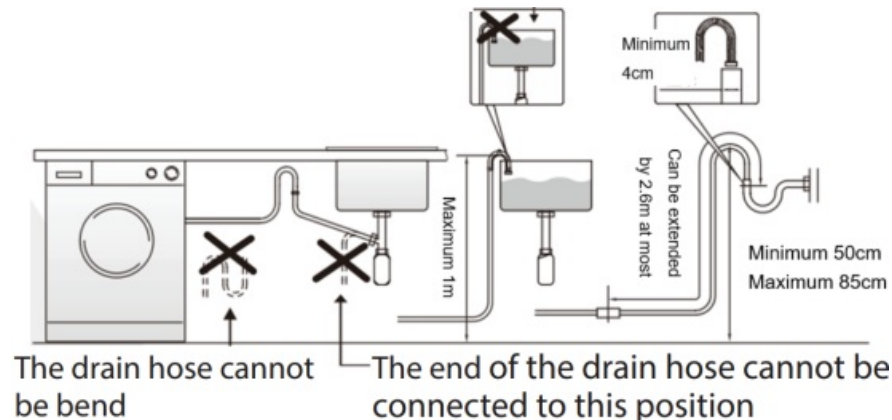

Horizontal adjustment

1. Adjust the level of the washing machine to avoid additional noise and vibrations. Install the washing machine on a hard and horizontal floor (the corner of a room is preferred).
2. If the floor is not flat, please adjust the adjustable feet. (Do not insert objects such as wood chips under the adjustable feet). Make sure that the four adjustable feet are in contact with the floor firmly and check that the washing machine is horizontal. (Using a spirit level is allowed).
3. Adjust the adjustable feet so that the washing machine is flat and stable on the floor. After position adjustment, screw the locknuts tightly to keep the washing machine stable.
4. Do not place the washing machine on a table on the floor to prevent it from falling accidentally.
5. When pressing any position on the diagonals of the worktop of the washing machine, the washing machine cannot shake. (Check on both diagonals. If the washing machine still shakes, please adjust the adjustable feet

again.)

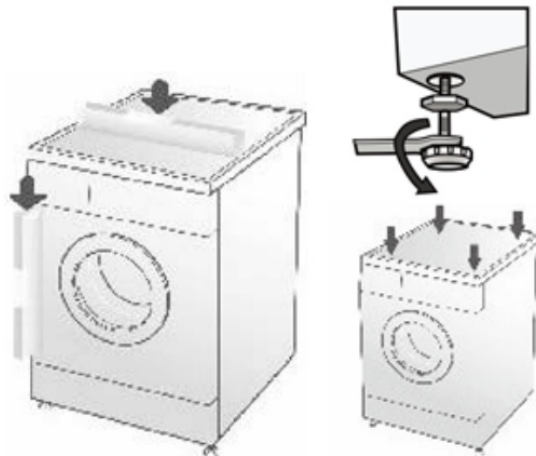

DOOR LOCKING AND UNLOCKING METHODS

Door locking

After startup, the door will be locked automatically and cannot be opened. Then, the “Lock” light/icon on the control panel illuminates.

Door unlocking

- When the “Lock” light/icon on the control panel illuminates, press the “Start/Pause” button. After the washing/spin drum stops rotating, wait for 2 minutes until the door is unlocked automatically.
- During washing, the door cannot be opened at high temperatures.
- During washing, the door cannot be opened with a high water level.

USAGE OF DETERGENT COMPARTMENT

I

Synthetic detergent powder

Clean the detergent compartment in advance.

Please dissolve detergent (e.g. soap pieces) before putting into detergent box.

The quantity of detergents varies with models.

II

Liquid detergent—bleach

Please use synthetic low-foam liquid detergents.

If concentrated liquid detergents are used, please dilute them with water (2:1) and pour them into the detergent compartment.

I

Synthetic detergent powder

Clean the detergent compartment in advance.

Please dissolve detergent (e.g. soap pieces) before putting into detergent box.

The quantity of detergents varies with models.

- Use detergents made specially for drum washing machines.
- Do not use too much detergent or too much foam may affect the rinse effect or cause functional faults.

- Please follow the instructions of the manufacturer to use detergents on the kinds and colors of clothes, water temperature, degree of staining, etc.
- Using appropriate detergents has a good washing effect and is beneficial for environmental protection.

MEASURES BEFORE WASHING

1. Care labels on clothes

- Read the care labels of clothes. The kind, material, and washing method of cloth are printed on a care label.
- Check whether or not the clothes are machine-washable.

2. Wash by kinds of clothes.

- To obtain the best washing effect, only wash one kind of clothes in a washing period.
- Water temperature, spin speed, and programs vary with clothes. Dark clothes shall be washed separately from light and white clothes. Dyed clothes and cotton velvet clothes shall be washed separately, or the clothes may be stained. If possible, do not wash very dirty clothes with moderately dirty clothes.
- Wash by kinds of clothes and degree of staining (severe, moderate, minor).
- White clothes shall be washed separately from colored clothes. Sort by color (white, light, dark).
- Cotton velvet (clothes whose cotton velvets are easy to drop out and clothes easy to adhere to cotton velvets)

3. For clothes whose buttons or accessories are easy to be damaged during washing, please wear them inside out.

4. Remove dust and stuck dirt from clothes before washing.

5. Take out objects such as keys, hairpins, pins, coins, etc. from pockets.

6. Put delicates into a laundry bag before washing.

7. Wash clothes with oil stains or clothes that are easy to fade separately.

FUNCTIONAL DESCRIPTION OF CONTROL PANEL

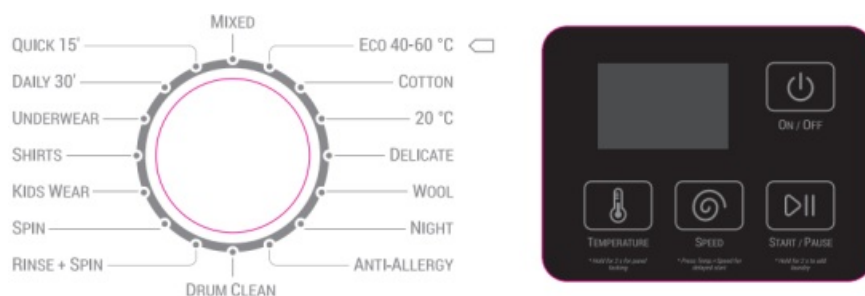

ON/OFF button

To switch on or switch off the washing machine.

Program selection turning knob

Select an appropriate program by kind of clothes and degree of stains.

Temperature button

- Select the water temperature by the kinds of clothes and degree of staining.
- The range of water temperature varies with programs. The water temperature setting is not required for some programs.

Spin speed button

- Choose spin speed according to the amount and type of laundry.
- The range of speed varies with programs.
- After powering on, press this button for 2 seconds to enter the «single spin» program.

Control panel locking function

After the program starts, press the Temperature button for more than 2 seconds to turn on or off the control panel locking function. After setting the control panel locking function, all buttons are inactive except the On/Off button.

Delayed start function

Press the temperature button + Speed button at the same time to enter delayed start mode. You can set the washing start delay from 1 to 24 hours in 1-hour increments.

Start/Pause button

- Press this button to start the operation.
- During operations, press this button to stop a program temporarily, and press it again to restore this program.
- Press and hold this button for 2 seconds to open the door temporarily for adding laundry during operation.

WASHING MACHINE USAGE

1. Prepare for washing
 - Open the door, add laundry to the drum, and close the door.
 - Open the detergent compartment, add detergent and fabric softener, and close the compartment.
 - Connect the water supply hose, and make sure that the faucet is turned on.
 - Connect to the mains.
2. Switch on the washing machine by pressing the ON/OFF button.
3. Select the required program by turning the knob.
4. If necessary, adjust the temperature, speed, and time of washing.
5. Press the Start/Pause button to start washing.
6. When the operation is ended, the indicator flashes, and the buzzer sounds.
7. Open the door to take out the clothes. Close the door.
8. Switch off and unplug the washing machine, turn off the faucet.

DESCRIPTION OF WASHING PROGRAMS

Program	Max load (kg)	Water temperature (°C)	Spin speed (rpm)	Rinse (times)	Default duration (h:min)
Mixed	≤4	40 (20)	800 (1000/0/600)	2	1:16 (1:01)
Eco 40-60 °C	Rated	—	1200 (0/600/800/1000)	2	2:50
Cotton	Rated	40 (60/85/20)	800 (1000/0/600)	2	1:27 (2:02/2:17/1:22)
20 °C	≤3	20	800 (1000/0/600)	2	0:54
Delicate	≤3	40 (20)	600 (0)	2	0:60 (0:45)
Wool	≤3	20	600 (0)	2	0:42
Night	≤4	40 (60/20)	600 (800/0)	2	1:04 (1:24/0:54)
Anti-Allergy	≤4	85	800 (1000/0/600)	2	2:00
Drum Clean	—	85	800	2	1:30
Rinse + Spin	Rated	—	800 (1000/0/600)	1	0:17
Spin	Rated	—	800 (1000/0/600)	—	0:11
Kids Wear	≤4	60 (85/20/40)	800 (1000/0/600)	3	1:42 (1:57/1:12/1:22)
Shirts	≤4	40 (20)	800 (1000/0/600)	2	1:02 (0:56)
Underwear	≤3	40 (60/20)	600 (0)	2	1:23 (1:43/1:13)
Daily 30'	≤2	20	800 (0/600)	2	0:30
Quick 15'	≤2	20	800 (0/600)	2	0:15

Eco 40-60 °C is a standard washing program that is suitable for cleaning normally soiled cotton laundry and is the most efficient in terms of combined energy and water consumption for washing cotton laundry.

Notes

- The first parameter of water temperature and spin speed is the default parameter at startup. You can select other parameters manually. The washing time required may vary with water pressure, drainage conditions, kinds of clothes, and water temperature.
- When the washing machine starts up after a power failure, it runs from the time node before the power failure.

CARE AND MAINTENANCE

- After using it for a long time, please service the washing machine immediately.
- Good servicing practices may extend the service life of the washing machine.
- Before servicing, please unplug the power plug to avoid dangers from happening.

Body

- Please wipe the body with a soft and clean cloth every time after the washing machine is used.
- When there are serious stains, please wipe the body with a cloth dipped in appropriate detergents or soapy water.
- Do not spray water on the body directly.
- Do not wipe the body with abrasive agents and chemicals such as diluting agents, gasoline, alcohol, etc.

Door seal

Please wipe stains and foreign matters such as thread chips away with a towel every time after using. If there are foreign matters such as pins in the groove of the door seal, please take them out.

Cleaning the detergent compartment

- To prevent detergents from becoming moldy on the wall of the detergent compartment, please clean the detergent compartment regularly.
- Press the specified position pull out the detergent compartment, wash it with water, and put it back.

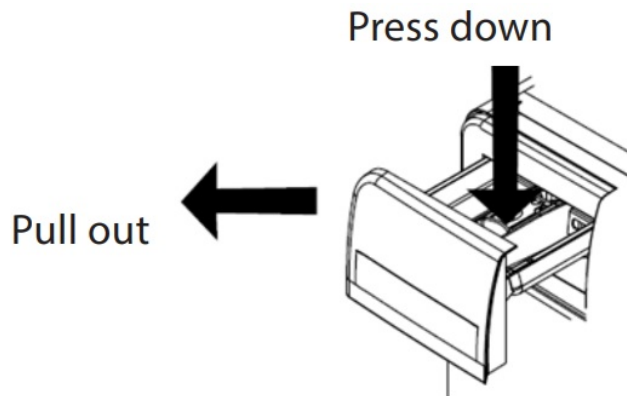

Precautions against freezing of the washing machine

1. Wrap the faucet and the universal coupling with a hot towel
2. Remove the water supply hose and immerse it in hot water at a temperature of approximately 50 °C.
3. Pour 2~3 liters of hot water at the temperature of approximately 50 °C into the drum.
4. Connect the water supply hose again, turn on the faucet, start up the washing machine, and check whether or not the water supply and drainage are normal.

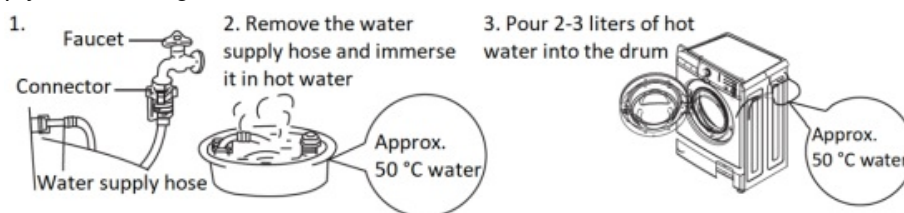

Self-cleaning of a drum (once a month is recommended)

After using it for a long time, there may be stains in the washing drum. The Clean drum program can be used to clean the exterior and the interior of the drum.

Notes: During the self-cleaning function, do not add clothes or detergents.

Cleaning the universal coupling (once every six months is recommended)

1. Remove the water supply hose from the universal coupling.
2. Screw off the fastener by following the arrow.
3. Rinse the interior of the fastener with water.
4. Install the clean fastener and the water supply hose.

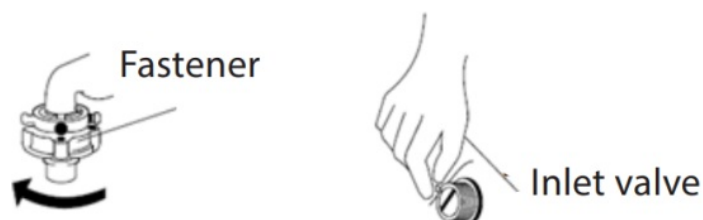

Cleaning the inlet valve (once every six months is recommended)

1. Remove the water supply hose from the washing machine.
2. Take out the filter screen from the inlet valve.
3. Clean the filter screen thoroughly with a toothbrush or similar tools. Install it to the inlet valve.
4. Connect the water supply hose again.

Cleaning the filter of the drainage pump (once a month is recommended)

1. After drainage, disconnect the power plug, press the clip above the decorative cover for the drainage pump at the right corner in the front of the body, and open the filter cover. (**Note:** if there is hot water in the washing machine, please take the above actions only after cooling.)
2. Screw off the filter anti-clockwise.
3. Rinse the filter thoroughly with water.
4. Insert the filter, screw it clockwise, and close the decorative cover for the drainage pump.

Notes

- The filter must be tightly screwed to prevent water from leaking.
- Do not clean the filter when a program is running.

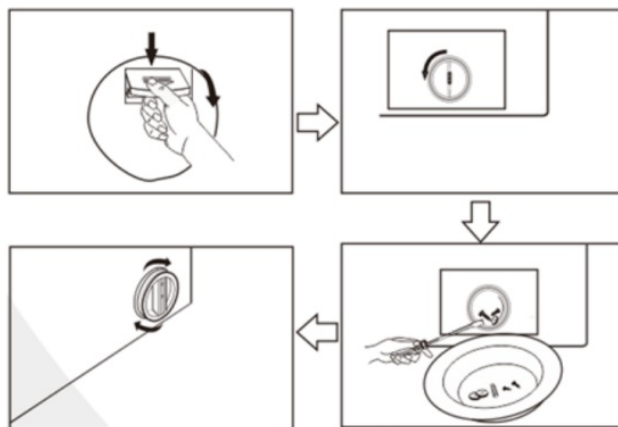

TROUBLESHOOTING GUIDE

Troubles	Check points	Solutions
The washing machine cannot start	1) Is the "On/Off" button or "Start/Pause" button pressed? 2) Is the plug of the power cord pulled out? 3) Is there a power failure? 4) Are the fuses damaged in the shield?	1) Press the "On/Off" button or "Start/Pause" button. 2) Insert the plug of the power cord. 3) Please wait. 4) Check the fuses.
Abnormal spin	1) Are the shipping bolts disassembled? 2) Is the washing machine assembled firmly? 3) Is there a small amount of laundry in the drum? 4) Are the locknuts for the adjustable feet screwed tightly?	1) Disassemble the shipping bolts. 2) Put the washing machine on a flat and even floor. 3) Add similar laundry. 4) Screw locknuts tightly.
Water inlet fault E01	1) Is the faucet turned off? 2) Is there a water outage or is water pressure lower? 3) Is the water supply hose frozen? 4) Is the water supply hose or the inlet valve blocked?	1) Turn on the faucet. 2) Please wait. 3) Unfreeze the water supply hose with hot water. 4) Take the filter screens out from the water supply hose and the inlet valve and thoroughly clean them.
Water drain fault E03	1) Is the height of the drain hose too high? 2) Is the drain hose frozen? 3) Is the drain hose blocked by foreign objects? 4) Is the floor drain blocked by foreign objects?	1) Please put the drain hose well and make sure that the height is below 1m. 2) Unfreeze the drain hose with hot water. 3) Take the foreign objects out and empty the drain hose. 4) Remove foreign objects from the floor drain.
Door fault E02	Are the doors closed tightly?	Close the door tightly.
Heating failure E06	Turn off the faucet and disconnect the power plug. Then, contact authorized service center.	
Continuous water inflow fault E04	Turn off the faucet and disconnect the power plug. Then, contact authorized service center.	
Too many foam	Are low-foam detergents special for drum washing machines used?	It is recommended to add the appropriate detergents in an appropriate quantity.

If the above actions did not help to eliminate the problem, please contact an authorized service center for help.

The following conditions do not represent faults:

The door cannot be opened	A program is running.
Peculiar smell	Because rubber parts are used in the washing machine, there can be a rubber smell at the beginning.
Low water quantity during washing and rinsing	Washing machine does not need a lot of water for washing.
Water inflow during running of programs	If the water level decreases, the washing machine automatically replenishes water.
Water leaks during washing	Are too many or high-foam detergents added?
Variation of remaining time	During spinning, if the clothes are off center, the spin time will increase appropriately to correct this phenomenon. If the water pressure is too low, the inflow time will increase appropriately.
Abnormal sound during spinning	Is the power cord contact with the body? Are the shipping bolts disassembled? Are there foreign objects such as hairpins and coins in the drum?

CORRECT DISPOSAL OF THIS PRODUCT

This marking indicates that this product should not be disposed of with other household wastes. To prevent possible harm to the environment or human health from uncontrolled waste disposal, recycle it responsibly to promote the sustainable reuse of material resources. To return your used device, please use the return and collection system or contact the retailer where the product was purchased. They can take this product for environmentally safe recycling. Dispose of the packaging materials environmentally. The packaging is made entirely of recyclable materials which should be disposed of at local recycling facilities. Observe the marking of the

packaging materials for waste separation, which are marked with abbreviations (a) and numbers (b) with the following meaning: 1–7: plastics / 20–22: paper and fiberboard / 80–98: composite materials.

WARRANTY CARD

Dear Buyer! Congratulations on your purchase of the ARDESTO brand appliance, which was designed and manufactured by the highest quality standards, we thank you for choosing this product. Keep this card during the warranty period. When purchasing a product ask for the warranty card to be filled out.

1. Warranty service is carried out only if there is a correctly and filled original warranty card, which indicates: the product model, date of sale, serial number, warranty service period, and the seller's seal.
2. The service life of household appliances is 5 years.
3. The product is intended for consumer use. When using the product in commercial activities, the seller/manufacturer does not bear warranty obligations, and after-sales service is performed on a paid basis.
4. Warranty repair is carried out within the period specified in the warranty card for the product in an authorized service center on the conditions and terms determined by applicable law.
5. The product is withdrawn from the warranty in case of violation by the consumer of the operating rules outlined in the instruction manual.
6. The product is removed from warranty service in the following cases:
 - misuse and non-consumer use;
 - mechanical damage;
 - damage caused by the ingress of foreign objects, substances, liquids, and analects;
 - damage caused by natural disasters (rain, wind, lightning, etc.), fire, domestic factors (excessive humidity, dust, aggressive environment, etc.)
 - damage caused by non-compliance of power and cable network parameters with state standards and other similar factors;
 - when operating equipment in the power supply network with a missing single ground loop;
 - in case of violation of seals installed on the product;
 - lack of serial number of the device, or inability to identify it.
7. The warranty does not cover consumables and accessories, as well as filters, shelves, drawers, stands, and other containers for storing products.
8. The warranty period is 12 months from the date of sale.

Tear-off maintenance tickets are provided by an authorized service center.

FAQs

Q: How do I clean the washing machine?

A: Run a cleaning cycle with vinegar and hot water once a month to remove any buildup.

Q: Why is my washing machine vibrating excessively during spin cycles?

A: Ensure the machine is level and not overloaded. Adjust the feet if needed for balance.

Q: Can I use bleach in this washing machine?

A: Yes, you can use bleach in moderation following the manufacturer's guidelines.

Documents / Resources

	ARDESTO WMW-6104DG Front Loading Washing Machine [pdf] Instruction Manual WMW-6104DG Front Loading Washing Machine, WMW-6104DG, Front Loading Washing Machine, Loading Washing Machine, Washing Machine, Machine
--	---

References

- [ARDESTO WMW-6104DG Front Loading Washing Machine \[pdf\] Instruction Manual](#)
- [User Manual](#)

[Manuals+](#), [Privacy Policy](#)

This website is an independent publication and is neither affiliated with nor endorsed by any of the trademark owners. The "Bluetooth®" word mark and logos are registered trademarks owned by Bluetooth SIG, Inc. The "Wi-Fi®" word mark and logos are registered trademarks owned by the Wi-Fi Alliance. Any use of these marks on this website does not imply any affiliation with or endorsement.