



ARDESTO WMS-6115 Fully Automatic Front Loading Washing Machine User Manual

[Home](#) » [ARDESTO](#) » ARDESTO WMS-6115 Fully Automatic Front Loading Washing Machine User Manual 

ARDESTO

Fully automatic front loading washing machine
USER MANUAL



WMS-6115
WMS-7115

Contents

- [1 WMS-6115 Fully Automatic Front Loading Washing Machine](#)
- [2 Part name](#)
- [3 Installation instruction](#)
- [4 Requires for positions](#)
- [5 Grounding introduction](#)
- [6 Install drain-pipe](#)
- [7 Function Introduction of Operating Panel](#)
- [8 Wool program Introduction](#)
- [9 Mix Program Introduction](#)
- [10 Sports Program Introduction](#)
- [11 Synthetics Program Introduction](#)
- [12 Cotton Program Introduction](#)
- [13 Duvet Program Introduction](#)
- [14 Underwear program](#)
- [15 Maintenance](#)
- [16 Varieties of Functions](#)
- [17 Notice Before Washing](#)
- [18 Troubleshooting guide](#)
- [19 Specification](#)
- [20 Warranty conditions](#)
- [21 Documents / Resources](#)
- [22 Related Posts](#)

WMS-6115 Fully Automatic Front Loading Washing Machine



WARNING

- This appliance is not indented for use by persons (including children) with reduced physical, sensory or mental capabilities, or lack of experience and knowledge, unless they have been given supervision or instruction concerning use of the appliance by a person responsible for their safety.
 - Children should be supervised to ensure that they do not play with the appliance.
 - The appliance can be used by children aged from 8 years and above and persons with reduced physical, sensory or mental capabilities or lack of experience and knowledge if they have been given supervision or instruction concerning use of the appliance in a safe way and understand the hazards involved. Children shall not play with the appliance. Cleaning and user maintenance shall not be made by children without supervision.
 - Children of less than 3 years should be kept away unless continuously supervised.
 - If the supply cord is damaged it must be replaced by the manufacturer, its service agent or similarly qualified persons in order to avoid a hazard.
 - **CAUTION:** In order to avoid a hazard due to inadvertent resetting of the thermal cut-out, this appliance must not be supplied through an external switching device such as a timer, or connected to a circuit that is regularly switched on and off by the utility.
 - The new hose-sets supplied with the appliance are to be used and that old hose-sets should not be reused.
- Safety Notifications (Please be sure to follow)
- In order to prevent the harm or damage to the user or the person and property of others, please make sure to follow the safety issues.

WARNINGS

- **The risk of electric shock**

1. Please use 220-240V, above 10A with ground wire dedicated socket.
2. When inserting and pulling out the power cord please use the plug, please. Don't use the damaged power cord. When the power cord pin is dirty please wipe clean with dry cloth in time.
3. Do not insert or remove the plug with a wet hand.
4. Please pull out the plug when finishing, repairing or cleaning.

- **The danger of high temperature**

1. When washing in high temperature, the door glass will be heating. Please do not touch the door glass, especially Children.
2. When opening the door after high temperature washing, please wait for the temperature cooled down to a safe level and the door will unlocked automatically.

- **The danger of injury**

1. Do not put any heavy things on the top of the washing machine.
2. If you want to move the machine, please remember ask for help.
3. Please do not ask unprofessional people to repair the machine.

- **The danger of explosion**

1. Please do not washing the cloths which stained with kerosene, gasoline, thinner, inflammable goods.
2. Please do not washing when gas leakage.

- **The danger of fire and current leakage**

1. Do not allow the washing machine close to the fire, or lighted cigarettes, candles and volatile materials.
2. Please do not sprinkle the water on the control panel of washing machine.
3. Please do not put the washing machine in the place of wet and outside place.
4. Please fix the drain pump and make sure the sewer unobstructed.

- **The danger of getting hurt**

1. Please handle the carton box after removing, don't let the children touch or eat.
2. Do not allow the children to operate or climb up to the washing machine.
3. Please close the door after use to avoid the children enter into the drum.

- **The danger of damage the cloths**



1. Please do not wash the cloths which is waterproof, like Raincoat, feather products, sleeping bags.
2. Please wash the cloths which can be washed, if you have any doubt, please following the instructions.

- **When pull out the plug, the lock can be unlock even if there is lot of water inside.**

So please check the water level inside before unlock the door in order to avoid the unnecessary loss.

Part name

Attachment specification

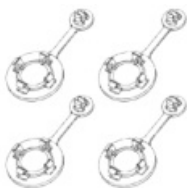
User manual (includes warranty card) Energy label and data sheet (the set depends on the country of destination)	water supply hose	wrench	transportation bolt caps
			

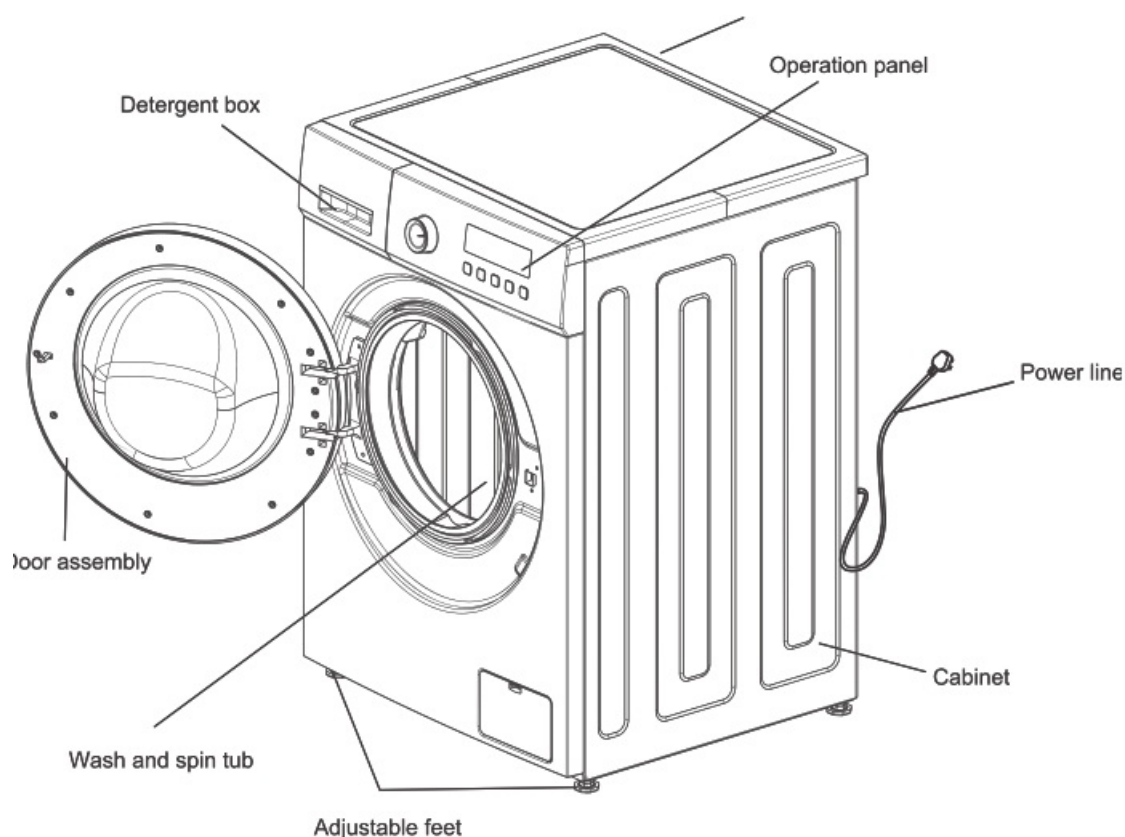

The above picture is just for reference, the detailed information should be based on the real product !

Notice :

1. The first use may drain some water out. It's residual water after performance test, belong to the normal phenomenon.
2. After each use, please pull the plug and turn off the faucet to prevent accidental flood or fire.

Installation instruction

- Make sure the temperature of the places where the washer is installed or placed above 0°C or put it outside.
- Place the washer correctly according to management standards and regulations.
- Keep the base of washer ventilated when it is placed on the ground with carpet.
- There are too much pests in villages. Please keep the surroundings clean because any damages caused by cockroaches or other pests don't belong to warranty.

Transport bolt

- Washers are installed with transport bolt to prevent internal damage in transit.

Dismantle the transport bolt

1. In order to prevent internal damage in transit, 4 bolts are installed. Before using the washer, dismantle the bolt.
(see chart 1)
 - If the bolts are not dismantled, violent vibration, noise and trouble will be caused.
2. Use the attached wrench to loosen the 4 bolts. (see chart 2)
3. Twist the bolt rubber slightly and then pull out the bolts, keep the bolts and wrench as standby. (see chart 3)
 - The bolts should be remounted no matter when to transport the washer.
4. Use attached stopples to seal the screw holes. (see chart 4)

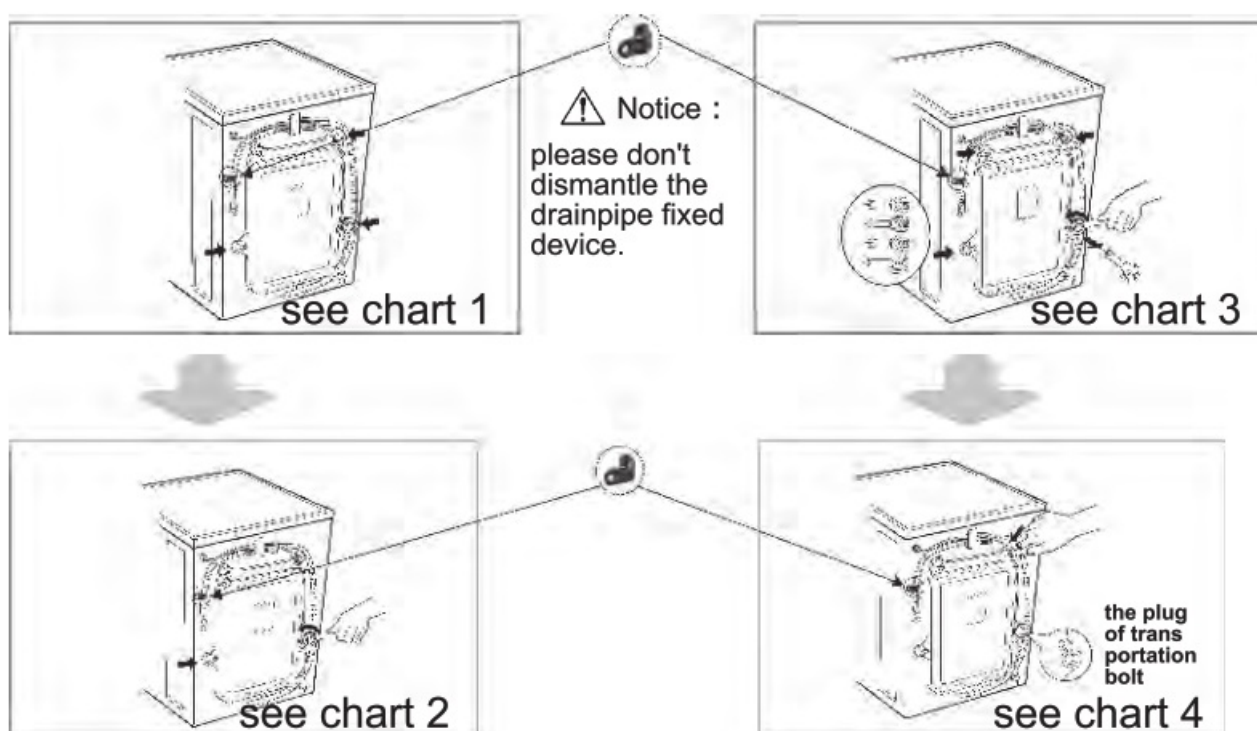

Requires for positions

The device must be installed on a solid, dry, clean, level surface.

Horizontal adjustment:

- The slant angle should be less than 1 degree.

Power outlet

- The distance between any side of washer and power outlet should be within 1.5 meters.
- Don't use too many electrical appliances in one outlet.

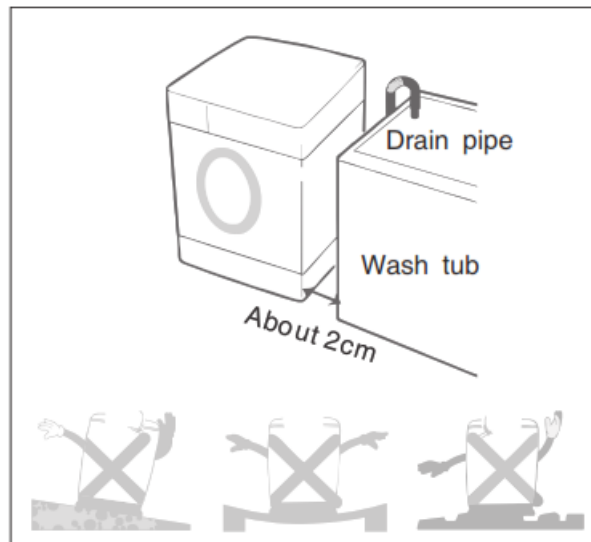

Environment cleaning

- It's necessary to clean the wall, door and ground.
- Install the washer on a hard and steady ground with floor drain rather than soft blanket or wooden floor.
- Don't put dirty clothes or some other goods on a washer's head cover, otherwise it may impact the normal operation.



Notice

Power connection

1. Don't use the wiring board or something like that.
2. If the power lines are damaged, please contact professionals to repair.
3. After the use of washer, pull the plug and turn the tap off.
4. Connect the washer with grounded outlet to correspond to the wiring principles.
5. Place the washer in which is easy to connect the outlet.
 - Contact the maintenance center and ask professionals to repair washer. laypeople may cause damages and troubles on the washer.
 - Don't put the washer in the place where the temperature is below zero. The pipes will be frozen and break. Moreover, the temperature below zero will damage the programming controller.
 - If move the washer in an environment whose temperature is below zero, please keep the washer at room temperature for a few hours before starting it.

Grounding introduction



- A washer must have the grounding devices. if a trouble happens, the device can reduce the risk of electrical shock. The device is equipped with a cable (including a wire and a grounded plug). The grounded plug must be inserted in an appropriate outlet. If you want to know if the washer is grounded correctly, please contact with professional maintenance staff. If the plug can't match with outlet, please don't change the plug by yourself.
- Once your washer smokes or emits an odor, please cut the power and contact with professional maintenance staff.

Washers should be connected with water inlet. Please use attached new plumbing rather than the old.
In order to ensure the quality, water injection tests are carried out before the washer leaves factory, so there may be water inside the internal tub, door seals and door panel, which are normal.

Water inlet connection

ATTENTION! Do not connect to hot water!

1. The pressure of supply water should be between 30kPa and 1000kPa.
2. Don't abrade the screw thread when connect the inlet pipes with valves.
3. Please install dropping equipment if the pressure of supply water surpasses 1000kPa.
 - Two seals are supplied in the connectors of both ends of the pipe to prevent water leaking.
 - Turn on the tap and check if the connectors leak.
 - Check the pipes regularly. Please change them if necessary.

CUse the standard faucet	
standard faucet	
longer faucet	
square faucet	

- Make sure the pipes don't be damaged or twine with each other.

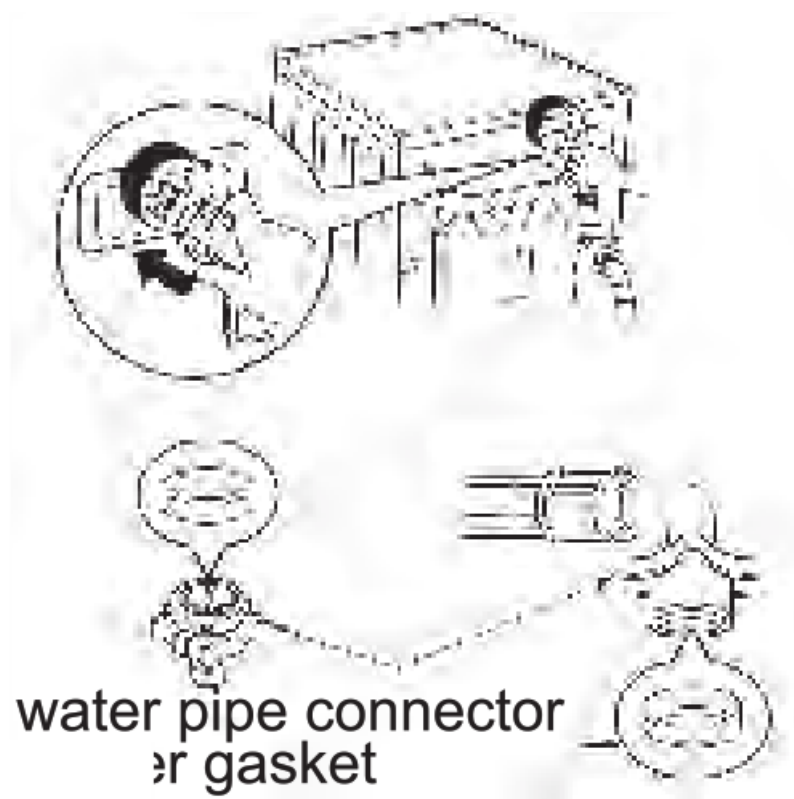

The connection of inlet pipes and taps

1. Check the rubber seals on both sides of the hose. Insert a rubber seal into the threaded fittings on each hose to prevent leaking.

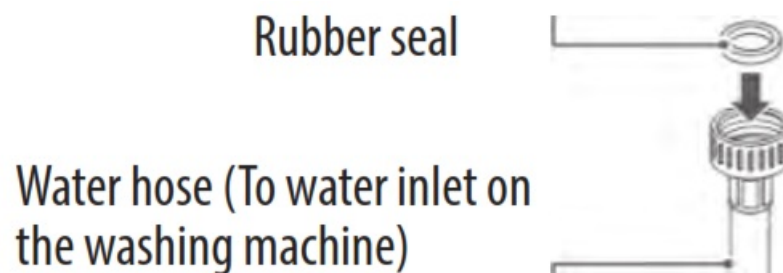

2. Connect the water supply hoses to the water faucets tightly by hand and then tighten another 2/3 turn with pliers. Connect the blue hose to water faucet.

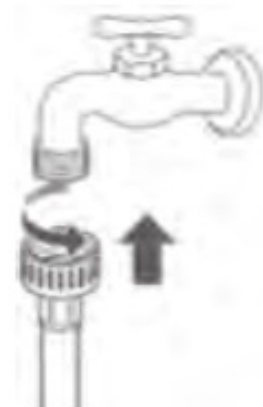

WARNING

Do not overtighten. Damage to the coupling can result.

3. After connecting inlet hose to water faucets, turn on the water faucets to flush out foreign substances (dirt, sand or sawdust) in the water lines. Let water drain into a bucket, and check the water temperature.



4. Connect the hoses to the water inlet tightly by hand and then tighten another 2/3 turn with pliers.

Water
inlet

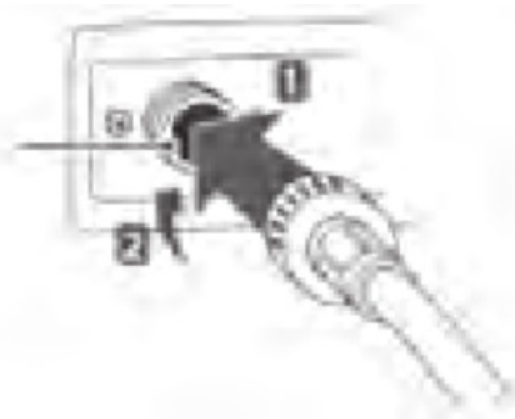

WARNING

Do not overtighten the hoses. overtightening can damage the valves resulting in leaking and property damage.

5. Check for leaks by turning on the faucets. If water leaks, check steps 1 to 4 again.

- Such washing machine is designed for home appliances, please do not install it on ship, traveling truck or plane.
- Please turn off the stopcock if long time out of use. (e.g vacation)
- Please remove plug and cancel door lock function to avoid child locking himself/herself inside.
- Packaging materials (e.g. film, foam) can harm the safety of the child and cause suffocation!

ATTENTION: MAKE SURE ALL PACKAGING MATERIALS ARE OUT OF THE REACH OF CHILDREN.

Install drain-pipe

- Please fix the drain-pipe by a lifting rope.
- For the sake of lightening damage of leak towards ground, please place the drain-pipe correctly.
- In order to avoid siphon , the height of drain-pipe should between (0.85m-l.25m), moreover, the terminal of drainpipe should not be placed in water.
- If the drain-pipe is too long, please do not force to insert it into washing machine, which would cause abnormal noise.

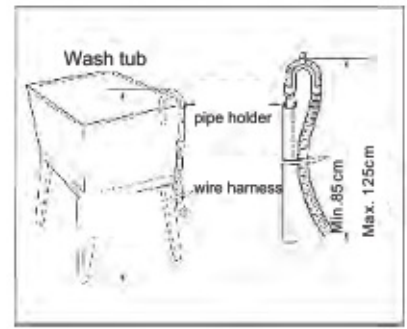
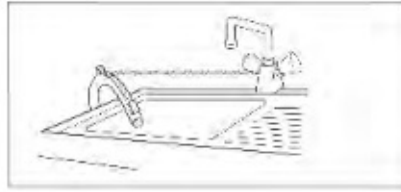

the instruction of installation of pipe

Horizontal Adjustment

- To avoid noise and vibrate by adjusting washing machine level. Place it at the room corner preferably.
- If ground not level, please adjust alignment pins. (Do not put wood pieces or something like), please make sure four alignment pins touch ground tightly, and machine level completely.



- Adjust alignment pins
Adjust the adjustable feet to make sure the washing machine in balance, which can be placed on the ground steadily. After settling, screw the locknut to guarantee. Do not place the washing machine in the platform, which is higher than the ground, in order to prevent the machine from falling down because of other accidents.
- The diagonal check
Applying force downward on the diagonal of the washing machine, washing machine should not shake. (both diagonal need to check, if the washing machine shake, must readjust adjustable foot.)

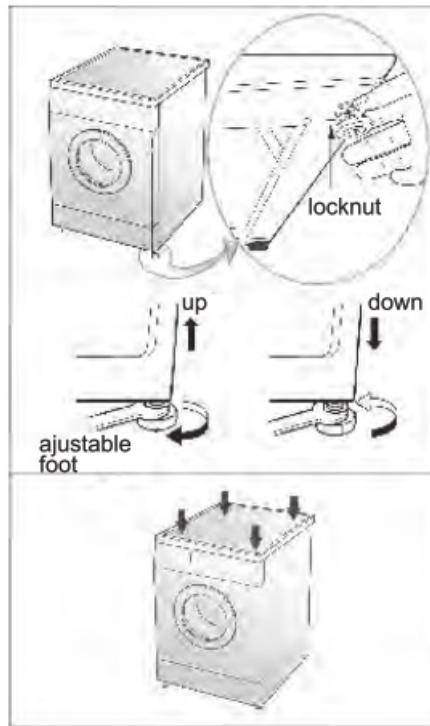

Methods of Door Lock and Remove DOOR LOCK

- After operating, the door will be locked automatically and “DOOR LOCK” light/picture on the panel is lighting. WASHING/DEWATERING drum stop operating. Please wait for about

Remove Door Lock

- When “DOOR LOCK” light/picture is lighting, press “Start/ Pause”, WASHING/DEWATERING drum stop operating. Please wait for about 10s door lock will be removed automatically.
- Unplug directly and wait for about 10s ,door lock will be removed automatically.
- Foam overflowing if open the door during operating, please catch foam with towel.
- If temperature is too high, the door can not be opened during operating.
- If water level is too high, the door can not be open during operating.

The Usage Method of the Detergent Box

Synthetic Detergent Powder 

- Please dissolve detergent (e.g soap pieces) before putting into detergent box.

Liquid detergent. Bleach 

- Please use detergent with less foam.
- Please use two times water to dilute the concentrated type detergent before putting into detergent box.

Softener 

- Please put softener before washing, which will pour into drum automatically when last potch happening.
- When using concentrated type softener, please dilute it with appropriate water.
- Do not exceed MAX mark.

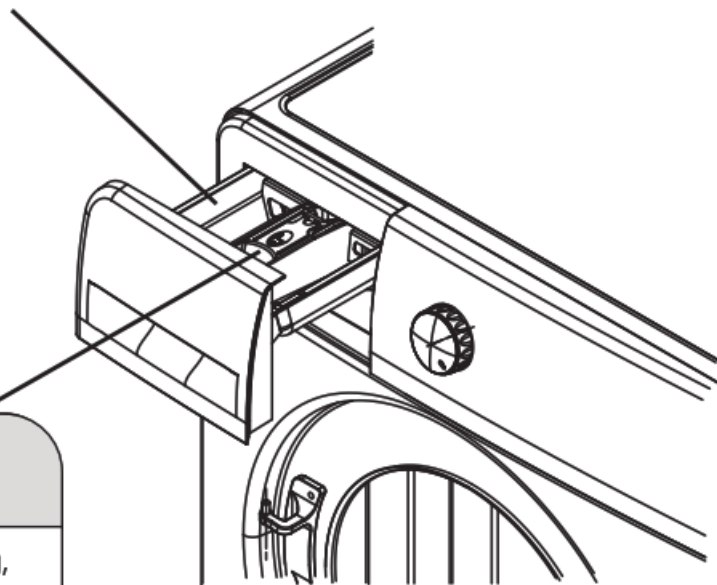

- Use special detergent.
- Do not use too much detergent which will cause too much foam and affect washing quality or will cause malfunction.
- Select detergent according to cloths variety, color, water temperature and contamination level.
- Please use moderate detergent to get washing effect and protect environment.

The recommendations on detergent use at the various temperatures

- When washing heavily soiled whites, we recommend using cotton programs of 60°C or above and a normal washing powder (heavy duty) that contains bleaching agents that at medium/high temperatures provide excellent results.
- For washes between 40°C and 60°C, the type of detergent used needs to be appropriate for the type of fabric and level of soiling. Normal powders are suitable for "white" or colour fast fabrics with high soiling, while liquid detergents or "colour protecting" powders are suitable for coloured fabrics with light levels of soiling.
- For washing at temperature below 40°C we recommend the use of liquid detergents or detergents specifically labeled as suitable for low temperature washing.

Function Introduction of Operating Panel

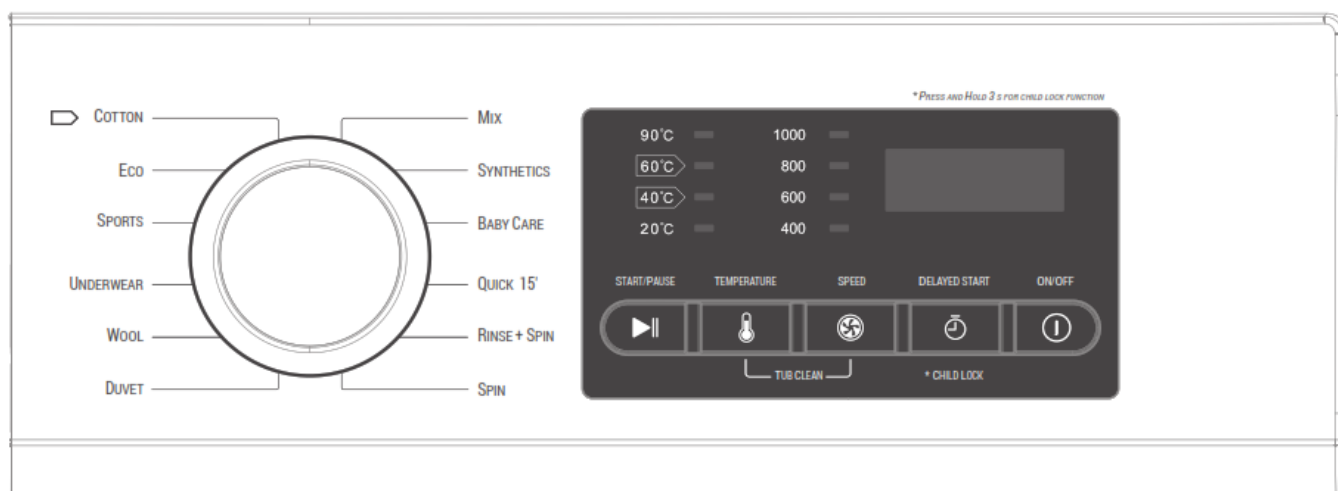







Image shown here is indicative only. Actual product you receive may differ.

1. **«ON/OFF» («Power») button** 
 - Turn on or turn off the device.
 - After washing, press this button to turn off the device.
3. **«Delayed start» button»** 
 - Delayed start time means a period of time from the designation of the washing mode to the start of washing.
4. **«Speed» button»** 
 - Select the spin speed according to the type and quantity of clothes.
4. **«Temp.» temperature selection button**
 - Select the water temperature according to the type and degree of soiling of your clothes.
 - You can select different washing modes and temperatures; some modes are not available.
5. **«Start/Pause» button** 
 - Press this button to start the washing machine.
 - To stop the appliance, press this button during washing, then press again to continue washing.
6. **«Program switch» turning knob** 
 - Select a program according to the type and degree of soiling of the clothes.
7. **Tub clean**
 - For removing dirt which remains after washing and for sterilization and disinfection.
 - Press and hold iremperatureD and «Speech> buttons at the same time within 3 seconds to start the tub cleaning program. Press the «Start/Pause» button to start the function.
8. **Child lock**
 - If the Child Lock is enabled, other buttons than the «On/Off» button do not work.
 - Press and hold the «Delayed Start» button for 3 seconds to turn on/off the child lock function.

The introduction of function and program

Usage of routine clothes

1. Preparation for washing.
 - Open the door put clothes in and closes the door.
 - Pull out the detergent box, add detergent and close the box.
 - Connect the inlet pipes and make sure the tap turned on.
 - Connect to a power source.
2. Press the power button
3. The programs can be selected according to requirements.
 - Cotton – Eco – Sports – Duvet – Baby Care – Underwear – Mix – Quick – Synthetics – Wool – Rinse + Spin – Spin.
4. Press Start/Pause button to start washing.
5. When all operations finished:
 - Screen shows END, and buzzer rings.
 - Open the door to get cloths out.
 - Turn off the device, unplug it from the socket and turn off the stopcock.

The usage of self-compiled program

Use this when need to set up the temperature, time and the revolution of spin.

1. Preparation for washing.
 - Open the door, put clothes in and close the door.
 - Pull out the detergent box, add detergent and close the box.
 - Connect the inlet pipes and make sure the tap turned on.
 - Connect to a power source.
2. Press the power button
3. The programs can be selected according to requirements.
4. Press Temp./Speed/Delay to setup water temperature, spin speed and appoint time.
5. Press the Start/Pause button to start washing.
6. When all operations finished:
 - Screen shows END and buzzer rings.
 - Get cloths out.
 - Turn off the device, unplug it from the socket and turn off the stopcock.

Wool program Introduction

This function is set for woolen and fibrous clothes. Please confirm the washing icon in clothes before washing them.

1. Follow the preparation for washing.
2. Press the On/Off button.
3. Rotate the program button and choose the “Wool”
 - Please choose appropriate temperature and rotate speed according to requirements.
4. Press the Start/Pause button to start washing.
5. When all operations finished, you will hear a signal.
 - Washing capacity should be less than 2 kg.

When finish all programs, please take out all clothes quickly to prevent them from distorting.

The washing can't be ordered.

In order to prevent clothes from damaging, the water temperature should be less than 40°C.

Please separate white or bright color clothes from dark clothes.

Use the detergent specially for woolen clothes to prevent damaging them.

ECO program Introduction

Wash the clothes lightly polluted can save time and energy.

1. Follow the preparation for washing.
2. Press the On/Off button.
3. Rotate the program button and choose the "ECO"
 - Please choose appropriate temperature and rotate speed according to requirements.
4. Press the Start/Pause button to start washing.
5. When all operations finished, you will hear a signal.
 - When the washer is working, if you want to change its setting, please press the Start/Pause button to stop running temporarily and then choose the program you need.

Baby Care program Introduction

This function can use high temperature to sterilize and remove the mites.

1. Follow the preparation for washing.
2. Press the On/Off button.
3. Rotate the program button and choose the "Baby Care"
 - Please choose appropriate temperature and speed according to requirements.
4. Press the Start/Pause button to start washing.
5. When all operations finished, you will hear a signal.

Spin program Introduction

1. To spin clothes after washing.
2. Press the On/Off button.
3. Rotate the program button and choose the "Spin"
 - Pressing "Speed" button can adjust the speed.
4. Press the Start/Pause button to start the program.
5. When all operations finished, you will hear a signal.
 - Before spinning, please make sure there are no nails, keys or other foreign matters in the tub to avoid unnecessary loss.
 - During the process of spinning, the actual spinning speed may be inconsistent with the program speed, which is because the washer adjusts the speed according to the balance between clothes.
 - There may be rhythmic drone during spinning, which is the normal voice of drain bump rather than the machine fault.

Mix Program Introduction

This function can be used to wash mix clothes like cotton, synthetic and soon (please do not mix wash the clothes that easily rub off).

1. Follow the preparation for washing.
2. Press the On/Off button.
3. Turn the program button to choose "Mix" program
 - Choose the needed water temperature and spin speed.
4. Push "Start/Pause" button to start washing.
5. When the program ends, you will hear a signal.
 - If you want to change the current setting during the process of washing, please push "Start/Pause" button first and stop washing, then push button to reset.
 - In order to prevent clothing damage, speed cannot set the highest speed, the temperature cannot be set to «60°C» and «90°C»
 - Please separate white or bright color clothes from dark clothes.

Sports Program Introduction

This program is designed for washing sportswear that is machine washable.

1. Follow the preparation for washing.
2. Press the On/Off button.
3. Turn the program button to choose "Sport" program
 - Choose the needed water temperature and spin speed.
4. Push "Start/Pause" button to start washing.
5. When the program ends, you will hear a signal.
 - If you want to change the current setting during the process of washing, please push "Start/Pause" button first and stop washing, then push button to reset.
 - In order to prevent clothing damage, speed cannot set the highest speed, the temperature cannot be set to «60°C» and «90°C»

Synthetics Program Introduction

To wash the synthetic clothes

1. Follow the preparation for washing.
2. Press the On/Off button.
3. Turn the program button to choose «Synthetics» program.
 - Choose the needed water temperature and spin speed.
4. Push "Start/Pause" button to start washing.
5. When the program ends, you will hear a signal.
 - If you want to change the current setting during the process of washing, please push "Start/Pause" button first and stop washing, then push button to reset.
 - In order to prevent clothing damage, speed cannot set the highest speed, the temperature cannot be set to «90°C»

Cotton Program Introduction

This program is suitable for the clothes which are moderate or mild dirty, like cotton beddings, underwear, towels and shirt, etc.

1. Follow the preparation for washing.
2. Press the On/Off button.
3. Turn the program button to choose "Cotton" program
 - Choose the needed water temperature and spin speed.
4. Push "Start/Pause" button to start washing
5. When the program ends, you will hear a signal.
 - If you want to change the current setting during the process of washing, please push "Start/Pause" button first and stop washing, then push button to reset.
 - When the washing machine washing towel, the yarn will be squeezed, washing will get rough surface, using the fiber softening agent, to prevent this kind of phenomenon happens to the greatest extent.

Rinse and Spin Program Introduction

1. To rinse and spin clothes after washing.
2. Press the On/Off button.
3. Turn the program button to choose "Rinse+ Spin" program.
 - Choose the proper spin speed.
4. Push "Start/Pause" button to start the program.
5. When the program ends, you will hear a signal.
 - If you want to change the current setting, please push "Start/Pause" button first and stop washing, then push «Spin Speed» button to reset.
 - The Spin speed can be selected the highest, but the temperature cannot be set.

Quick 15' Program Introduction

To wash clothes that are changed frequently, not too dirty and thin clothes

1. Follow the preparation for washing.
2. Press the On/Off button.
3. Turn the program button to choose "Quick 15'" program
 - Choose the needed water temperature and spin speed.
4. Push "Start/Pause" button to start washing.
5. When the program ends, you will hear a signal.
 - If you want to change the current setting during the process of washing, please push "Start/Pause" button first and stop washing, then push button to reset.
 - In order to prevent clothing damage, speed cannot set the highest speed, the temperature can be set to «cold», «20°C», «40°C» prevent the door from distorting.
 - In order to ensure the washing effect, washing is suitable for the washing capacity under 2 kg.

Duvet Program Introduction

The cloths have the machine-washable mark, like bedding, bed sheets, curtains, etc.

1. Follow the preparation for washing.
2. Press the On/Off button.
3. Turn the program button to choose "Duvet" program
 - Choose the needed water temperature and spin speed.
4. Push "Start/Pause" button to start washing.
5. When the program ends, you will hear a signal.
 - If you want to change the current setting during the process of washing, please push "Start/Pause" button first and stop washing, then push button to reset.
 - The electric blanket and carpet cannot be washed. (It will damage the machine and clothes).
 - Put the clothes in the washing drum properly and uniform when spinning, in order to avoid large vibration and drying time may be extended.
 - Heavy clothes cannot be entanglement, need to put inside the washing machine after shaking loose.
 - Une ven clothes can lead to not spinning (display UE), take out again in the after washing to shake loose.

Underwear program

For washing delicate laundry suitable for machine washing.

1. Follow the preparation for washing.
2. Press the On/Off button.
3. Turn the program selector to select the Underwear program.
 - Select the appropriate temperature and spin speed according to your requirements.
4. Press the «Start/Pause» button and start the washing process.
5. After the end of washing, you will hear a signal.
 - If you want to change the current settings during washing, first press the «Start/Pause» button and stop the washing process, then press again to set the settings.

Programs for WMS-6115

Program	Temperature (°C)	Spin speed (rpm)	Time (min)	Max load (kg)
Cotton	Cold water (20°C, 40°C, 60°C, 90°C)	800 (0, 400, 600, 1000)	88	rated
Eco	20°C (cold water, 40°C, 60°C)	1000 (0, 400, 600, 800)	69	≤2
Sports	20°C (cold water, 40°C)	800 (0, 400, 600)	79	≤4
Underwear	40°C (cold water, 20°C)	800 (0, 400, 600)	71	≤3
Wool	Cold water (20°C, 40°C)	600 (0, 400)	56	≤2
Duvet	60°C (cold water, 20°C, 40°C, 90°C)	1000 (0, 400, 600, 800)	119	≤2,5
Spin	—	800 (0, 400, 600, 1000)	14	rated
Rinse + Spin	—	800 (0, 400, 600, 1000)	34	rated
Quick 15'	Cold water (20°C, 40°C)	600 (0, 400, 800)	15	≤2
Baby Care	60°C (40°C, 90°C)	800 (0, 400, 600)	107	≤3
Synthetics	40°C (cold water, 20°C, 60°C)	800 (0, 400, 600)	73	≤3
Mix	Cold water (20°C, 40°C)	800 (0, 400, 600)	66	≤4

Programs for WMS-7115

Program	Temperature (°C)	Spin speed (rpm)	Time (min)	Max load (kg)
Cotton	Cold water (20°C, 40°C, 60°C , 90°C)	1000 (0, 400, 800, 1200)	88	rated
Eco	20°C (cold water, 40°C, 60°C)	800 (0, 400, 1000, 1200)	69	≤2
Sports	Cold water, (20°C, 40°C)	800 (0, 400)	71	≤4
Underwear	40°C (cold water, 20°C)	800 (0, 400, 1000)	71	≤3
Wool	40°C (cold water, 20°C)	800 (0, 400)	66	≤2
Duvet	40°C (cold water, 20°C)	800 (0, 400)	118	≤2,5
Spin	—	1000 (0, 400, 800, 1200)	14	rated
Rinse + Spin	—	1000 (0, 400, 800, 1200)	34	rated
Quick 15'	Cold water (20°C, 40°C)	800 (0, 400)	15	≤2
Baby Care	60°C (40°C, 90°C)	800 (0, 400, 1000)	107	≤3
Synthetics	40°C (cold water, 20°C, 60°C)	1000 (0, 400, 800, 1200)	73	≤3
Mix	Cold water (20°C, 40°C)	800 (0, 400)	66	≤4

Standard Cotton at 60 °C and 40 °C are suitable to clean normally soiled cotton laundry and they are the most efficient programs in terms of combined energy and water consumptions for washing that type of cotton laundry; in addition, the actual water temperature may differ from the declared cycle temperature.

Remarks:

1. The time consumption will be changed according to the water pressure, cloths variety, quantity, water

temperature.

2. The difference between displayed on screen and actual time consumption will happen.
3. If speed is too lower, poor washing effect will happen, please add more rinse time.
4. Different parameters, different models.
5. When self-designed default procedure is energy procedure, the washing time will be increased automatically.

Maintenance

- Please maintenance washing machine to extend service life.
- Before maintenance, please unplug.

Body of washing machine

After washing, please clean it with soft cloth. If much contamination, please use appropriate detergent or soap.

- Do not watering directly.
- Do not use putty-powder, diluent, gasoline, alcohol to clean machine body.

Door Gasket Ring

After washing, please remove contamination, wastepaper and so on, if foreign matter exists, please remove.

The Cleaning of Detergent Box

Please clean the detergent box regularly. Pull it out and wash with clean water, then insert back.

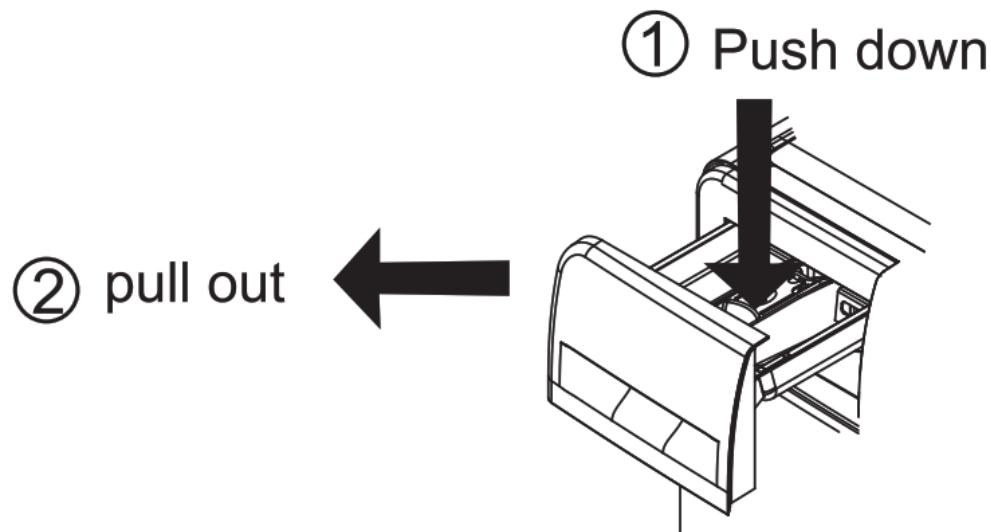

The Cleaning of Universal coupling (semiannually)

- If waste accumulated, it will influence water inlet speed.
 1. Take off the soft pipe from the universal coupling side.
 2. Take off the screwing device according to the arrow showed.
 3. Wash the inside of the screwing device.
 4. Install the cleaned screwing device with the inlet soft pipe.



The cleaning of inlet water valve (semiannually)

1. Take off the soft pipe from washing machine side.
2. Take off the filter net from water valve.
3. Clean the filter net with tooth-brush.
4. Install the soft inlet pipe.

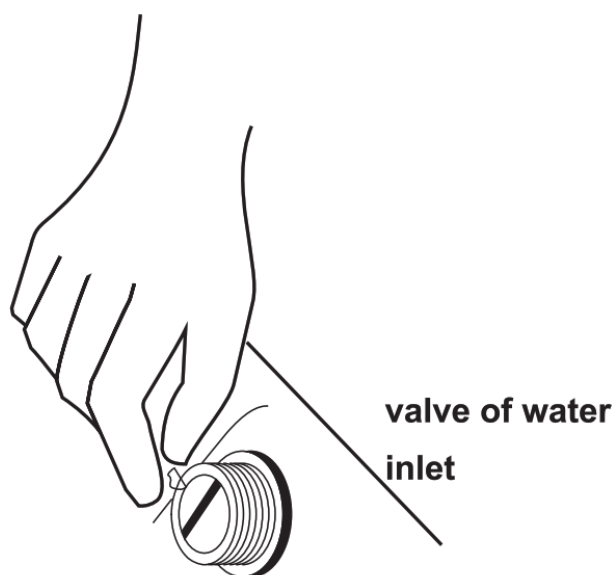

When washing machine is frozen

1. Cover stopcock and the universal coupling with hot towel.
2. Take off the inlet pipe, and put it into 50 degree water.
3. Pour into the drum about 2-3L of 50 degree water.
4. Connect inlet pipe, turn on the stopcock and start the washing machine, please check whether inlet and outlet is normal.

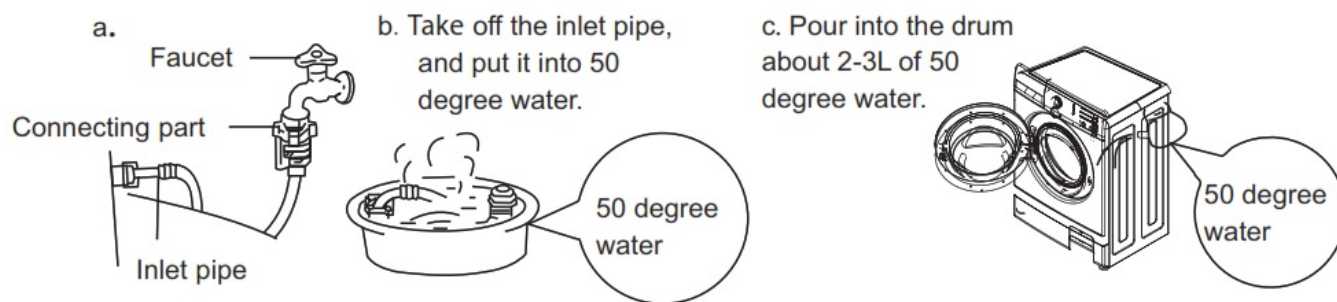

The Clearance of dewatering-pump filter (once a month)

1. Press fastener on the pump after water draining and power off, open the lip of water-pump filter. Attention: if hot water is inside, only go ahead after it become cold.
2. Take off the filter anticlockwise.
3. Wash the filter.
4. Direct at pump and insert the filter, tighten it clockwise and tighten the lid.

Attention: a. Please tighten the filter well to avoid leak.

b. Please do not clean during operation.

The Drum Clearance (once a month)

After using for a period, some dirt maybe exist. You can clean the inside and outside of drum by operating the drum procedure.

Attention: please do not put cloths and detergent when clearing the drum.

Varieties of Functions

1. Child Lock function: You can lock and unlock the child lock function by pushing «Delayed Start» 3 seconds when the machine is running.
 - Once the child lock function set, all the other buttons will be locked except the power button.
 - When the washing process ending or push "Power" button or default warning, the child lock function cannot be unlocked. It means that the child lock function must be unlocked by hand. When the power on and start the machine, if the child lock function is going on (the lamp of child lock light up, you need to push «Delayed Start» button for 3 second to unlock the child lock function and then continue to operate the washing machine.
2. Power-off Memory: When there is power on again after a period of power-off, the machine will continue the working process at the time node of last power-off action.
3. Door self-lock: After selecting procedure, the door locked automatically, 2 minutes after operation over, lock removed.
4. Tub clean: The program of drum clean is use the high water level, high water temperature, high speed to clean the drum and kill the bacteria.
5. Add garment function: During the process running, if you want to add garment, please push «Start/Pause» button to stop running;
 - After around 5 seconds, it has a sound of unlocking, meanwhile the door lock mark in the screen disappear then you can open the door.
 - Add the additional garment into the drum(Don't let the door clamp clothes, this will cause failure of leakage and error).
 - Forced to open the door part, damage may occur, such as safety problem. When there are many bubble in

the inner barrel and plenty of water, open the door, water and foam will flow out .

6. • When the inner drum is running, it is in danger status since the temperature of water is above 45°C and there is plenty of water inside. At this time, the door can not be forced to open. If want to open the door, please follow the below instructions: (1) Wait till the inner drum stop running. (2) Wait till the water temperature cool down to below 45 °C. If want to open is above 45 °C, please shut off the power and open the door after 5 minutes.
- Abnormal power off for 2 minutes, you can open the door. During the process of running, the required condition for opening door (water level below door gasket, water temperature below 45 °C, spin speed is 0), push «Start/ Pause» button, wait till door lock mark disappear, then open the door. When closing the door, press the middle place of the door handle.
 - Push «Start/Pause» button to start the washing machine, it is normal to hear «Clicking» sound, which is door locking sound not an error. If it occurs «dE» warnings, please use hand to push and shut the door. Push two times of «Start/ Pause» button to continue running of the machine.

Notice Before Washing

- Please check the tag on the garment which shows the texture of the garment and washing methods.
- Please wash cloth of the same texture. Different texture needs different water temperature, speed and washing procedure.
- Please split colored cloths from white cloths. Split dyed cloths from cotton, otherwise cloths would be discolored.
- If possible please do not wash high contaminated clothes with easily contaminated ones together.
- Classify clothes by soiling degree.
- Classify clothes by color: white, light color, dark color.
- Velveteen crumbles easily, sticks to clothes.

3. Notes

- When put big and small clothes together, put the big first and they have to be less than half of total clothes. Please don't wash single cloth because it may cause the trouble of imbalance. Please add one or two similar clothes.
- Small clothes like silk stockings and handkerchiefs should be put into mesh bags to wash. Before washing the bra with steel rings, please take the rings off. If it is inconvenient to do this, please put them into mesh bags to prevent the bra slipping into the gap between internal and external tubs.
- Check all pockets and make sure nothing in them. Nails, hairpin, match, pen, coin and key will damage your washer and clothes.
- Zip up all clothes, fix the button and hook and tie the loose belt, make sure that other clothes cannot be damaged by them.
- Firstly use the water with a little detergent to wash the parts with too many stains, such as collar and cuffs, which can make the clothes cleaner.
- Check the door seals and make sure nothing on them.
- Make sure there is nothing in the tub before washing.
- To make sure there is cloth caught in the door sealing ring, in order to avoid the cloths and door seal ring from damaging.

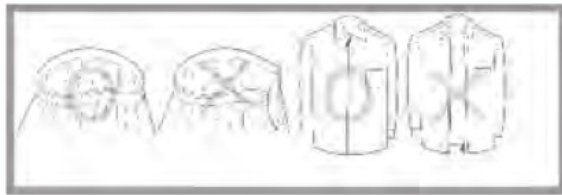

The door can't open.	<ul style="list-style-type: none"> •The program is running. •There are clothes between the door and door seals.
There is an odor.	<ul style="list-style-type: none"> •There may be a smell of rubber because some components are made up of rubber.
There is too little water when wash and rinse.	<ul style="list-style-type: none"> •Roller washing machine just needs a little water when operating.
No water inflowing.	<ul style="list-style-type: none"> •Is the tap turned on? •Is the inlet pipe frozen? •Are the filters blocked?
Water inflows halfway	<ul style="list-style-type: none"> •If the water level declines, the washer will supply water automatically.
Water outflows when washing.	<ul style="list-style-type: none"> •Check if add the detergent with too much bubbles.
Remaining time changes	<ul style="list-style-type: none"> •If clothes are off center when spin, spinning time will extend to correct the deviation.
There is abnormal noise when spin.	<ul style="list-style-type: none"> •Check if the power line touches with cabinet. •Have the transport bolts been dismantled? •Are there some hairpins or coins in the roller?
The washer can't work after the failure of electricity.	<ul style="list-style-type: none"> •The washer will stop working after the failure of electricity. When the power is restored, it still can't continue to work. Please press the power button and reset the program.

Troubleshooting guide

Phenomenon	check points	solutions
Washer can't start	<ul style="list-style-type: none"> • Check if press the power button or start/pause button? • Is the plug pulling out? • Is there a power failure? • Check if cut the leakage protector? 	Press the power button or start/ pause button. Connect the plug. Please wait. Open the leakage protector.
Spinning screen shows "UE"	<ul style="list-style-type: none"> • Check if disassemble the carriage bolt? • Is the machine placed steadily? • Are the clothes too small or light? • Are the locknuts on under the feet tightened up? 	Disassemble the carriage bolt. Place the machine on a steady ground. Add more clothes. Tighten up the locknuts.
Water inflow screen shows "IE"	<ul style="list-style-type: none"> • Check if turn the tap off? • Is the water supply cut off or the water pressure too low'? • Are the water inlet pipes frozen? • Are the filters blocked? 	Open the stopcock. Please wait. Use hot water to unfreeze the pipes. Take out the filters and clean them.
Water outflow screen shows "OE"	<ul style="list-style-type: none"> • Are the outlet pipes placed too highly? • Are the outlet pipes frozen? • Are the outlet pipes blocked? • Are the floor drain blocked? 	Please put away the outlet pipes and make sure the height within 1 M. Use hot water to unfreeze the pipes. Take out the foreign matter and dredge the pipes. Clean the floor drain.
Door trouble screen shows "DE"	<ul style="list-style-type: none"> • Make sure if start the washer without closing the door well. 	Make sure the door truly closed
No heating screen shows „FE,	Please pull the plug and entrust the after-sales service	
Continuous water inflow screen shows "FE"	Close the stopcock, pull the plug and ,entrust the after-sales service.	
The screen shows "LE" or "CE" when wash tub doesn't rotate.	Close the stopcock, pull the plug and ,entrust the after-sales service.	
Too much foam	<ul style="list-style-type: none"> • Check if add too much detergent? • Check if add too much detergent? 	Add reasonable amount of detergent. Use the detergent correctly.

Specification

Model	WMS-6115	WMS-7115
Rated washing capacity*	6,0 kg	7,0 kg

Rated spinning capacity*	6,0 kg	7,0 kg
Rated voltage	220-240 B, 50 Hz	220-240 B, 50 Hz
Rated washing power	250 W	300 W
Rated spin power	400 W	500 W
Power consumption in off-mode	0.45 W	0.45 W
Power consumption in standby mode	0.50 W	0.50 W
Rated heating power	1500 W	1500 W
Maximum power	1750 W	1750 W
Water consumption (Based on 220 standard washing cycles for cotton program at 60 °C and 40 °C at full and partial load)	10560 L/annum (Actual water consumption will depend on how the appliance is used)	11500 L/annum (Actual water consumption will depend on how the appliance is used)
Energy consumption (Based on 220 standard washing cycles for cotton program at 60 °C and 40 °C at full and partial load)	170 kWh/annum (Actual energy consumption will depend on how the appliance is used)	196 kWh/annum (Actual energy consumption will depend on how the appliance is used)
Maximum spin speed	1000 rpm	1200 rpm
Spin-drying efficiency class	C	B
Washing noise (Airborne acoustical noise emission during washing phase for standard 60 °C cotton program at full load)	60 dB(A)	60 dB(A)

Spin noise (Airborne acoustical noise emission during spinning phase for standard 60 °C cotton program at full load)	74 dB(A)	76 dB(A)
Waterproof class	IPX4	IPX4
Water pressure	0.03-1 MPa	0.03-1 MPa
Energy efficiency class	A++	A++
External dimensions	595*440*850 mm	595*480*850 mm

*Note: The maximum weight of dry laundry for which the washing machine is designed should not exceed the nominal values.

Environmental Protection

Correct disposal of the device



This marking indicates that this product should not be disposed with other household wastes. To prevent possible harm to the environment or human health from uncontrolled waste disposal, recycle it responsibly to promote the sustainable reuse of material resources. To return your used device, please use the return and collection systems or contact the retailer where the product was purchased. They can take this product for environmentally safe recycling.

For notes

.....
.....
.....

Warranty conditions

The plant guarantees normal operation of the product within 12 months from the date of the sale, provided that the consumer complies with the rules of operation and care provided by this Manual. Service life of the product is 5 years. In order to avoid any misunderstanding we kindly ask you to carefully study the Owner's Manual, the terms of warranty, and check the correctness of filling the Warranty Card. The Warranty Card is valid only if the following information is correctly and clearly stated: model, serial number of the product, date of sale, clear seals of the company seller, signature of the buyer. The model and serial number of the product must correspond to those specified in the Warranty Card. If these terms are violated, and if the information specified in the Warranty Card is changed, erased or rewritten, the Warranty Card is considered invalid. Setup and installation (assembly, connection, etc.) of the appliance are described in the attached documentation; they can be carried out both by the user, and by specialists having the necessary qualification sent by USC or selling companies (on a paid basis). In this case, the person (the institution) installing the appliance shall be responsible for the correctness and quality of installation (setup). Please pay attention to the importance of the correct installation of the appliance, both for its reliable operation, and for obtaining warranty and free service. Require the installation specialist to enter all the necessary information about the installation in the Warranty Card. In case of failure of the appliance during the warranty period by the fault of the manufacturer, the owner is entitled to free warranty repair upon presentation of the correctly filled Warranty Card together with the appliance in the factory configuration packed in the original packaging to the warranty workshop or the place of its purchase. Satisfaction of the customer's claim

due to the fault of the manufacturer shall be made in accordance with the law «On Protection of Consumers' Rights». In the case of warranty repair the warranty period shall be extended for the period of repair and shipment.

WARRANTY CARD

Dear Buyer! Congratulations on your purchase of the ARDESTO brand appliance, which was designed and manufactured in accordance with the highest quality standards, and we thank you for choosing this particular instrument.

We ask you to keep the coupon during the warranty period. When purchasing a product, require a full warranty card.

1. Warranty service is carried out only if there is a correctly and clearly filled original warranty card, which indicates: product model, date of sale, serial number, warranty service period, and the seller's seal. *
2. The service life of household appliances is 5 years.
3. The product is intended for consumer use. When using the product in commercial activities, the seller / manufacturer does not bear warranty obligations, after-sales service is performed on a paid basis.
4. Warranty repair is carried out within the period specified in the warranty card for the product in an authorized service center on the conditions and terms determined by applicable law.
5. The product is withdrawn from the warranty in case of violation by the consumer of the operating rules set forth in the instruction manual.
6. The product is removed from warranty service in the following cases:
 - misuse and non-consumer use;
 - mechanical damage;
 - damage caused by the ingress of foreign objects, substances, liquids, insects;
 - damage caused by natural disasters (rain, wind, lightning, etc.), fire, domestic factors (excessive humidity, dust, aggressive environment, etc.)
 - damage caused by non-compliance of power and cable network parameters with state standards and other similar factors;
 - when operating equipment in the power supply network with a missing single ground loop;
 - in case of violation of seals installed on the product;
 - lack of serial number of the device, or inability to identify it.
7. The warranty does not cover consumables and accessories, as well as filters, shelves, drawers, stands and other containers for storing products.
8. The warranty period is 12 months from the date of sale.

* Tear-off maintenance tickets are provided by an authorized service center.

The completeness of the product is checked. I have read the terms of the warranty service, no complaints.

Customer Signature _____

Warranty card

Product information.....

Product.....

Model.....

Serial number.....

Seller Information.....

Trade organization name.....

The address.....

Date of sale.....

Seller stamp.....

Coupon 3

Seller stamp

Date of the application.....
Cause of damage.....
Date of completion.....

Coupon 2

Seller stamp

Date of the application.....
Cause of damage.....
Date of completion.....

Coupon 1

Seller stamp

Date of the application.....
Cause of damage.....
Date of completion.....



Documents / Resources

	<p>ARDESTO WMS-6115 Fully Automatic Front Loading Washing Machine [pdf] User Manual WMS-6115 Fully Automatic Front Loading Washing Machine, WMS-6115, Fully Automatic Front Loading Washing Machine, Front Loading Washing Machine, Loading Washing Machine, Washing Machine</p>
--	--