

ARC Thinkware Dash Cam App



ARC Thinkware Dash Cam App User Guide

[Home](#) » [ARC](#) » ARC Thinkware Dash Cam App User Guide 

Contents

- [1 ARC Thinkware Dash Cam App](#)
- [2 Product Information](#)
- [3 Power the Dash Cam](#)
- [4 Download the App](#)
- [5 Connect to the App](#)
- [6 Install The Cameras](#)
- [7 Dash Cam Settings in the App](#)
- [8 FAQ & Help Desk](#)
- [9 Documents / Resources](#)
 - [9.1 References](#)

ARC

ARC Thinkware Dash Cam App



Product Information

Specifications

- **Product Model:** 4XLFN6WDUW*XLGH
- **Dimensions:** Standard
- **Weight:** Standard

FAQ

How do I connect the device to Wi-Fi?

To connect the device to Wi-Fi, follow these steps:

1. Access the settings menu on the device.
2. Locate the Wi-Fi settings and select your network from the available options.
3. Enter the password for your Wi-Fi network if required.

How do I reset the device?

- To reset the device, locate the reset button on the device and press it for a few seconds until the device restarts.

Power the Dash Cam

Use one of the following options

The included cable options vary depending on the dash cam model purchased.

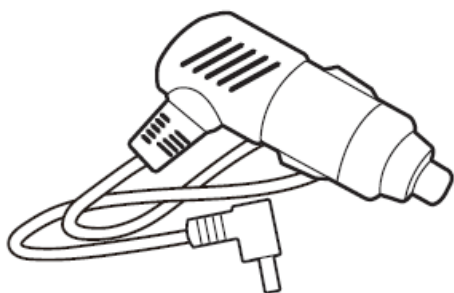

12V Power Cable

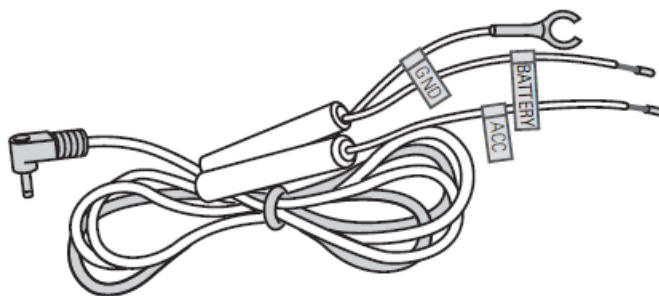

Hardwiring Cable*

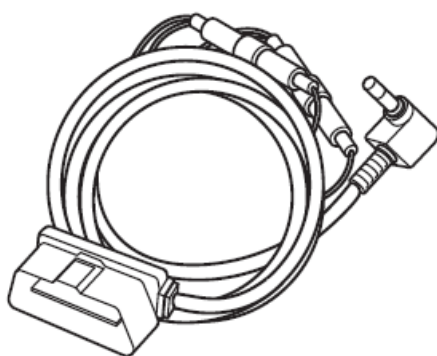

OBD-II Cable*

- To enable Parking Surveillance mode, the dash cam needs to be powered by either the OBD-II Cable or Hardwiring Cable (professional installation recommended).

Download the App

Download the THINKWARE DASHCAM LINK App

On your smartphone, open the Google Play Store or Apple App Store and download and install THINKWARE DASH CAM LINK.



THINKWARE DASH CAM LINK



Apple Store (iOS)



Google Play Store (Android)

Connect to the App

Follow the on-screen instructions



1. Press the Wi-Fi  icon on the dash cam you want to connect.



2. Scan the QR code and connect according to the app instructions.
3. If a connection using the QR code is not available, connect it manually using Wi-Fi Connection.

Install The Cameras

Install the Front Camera

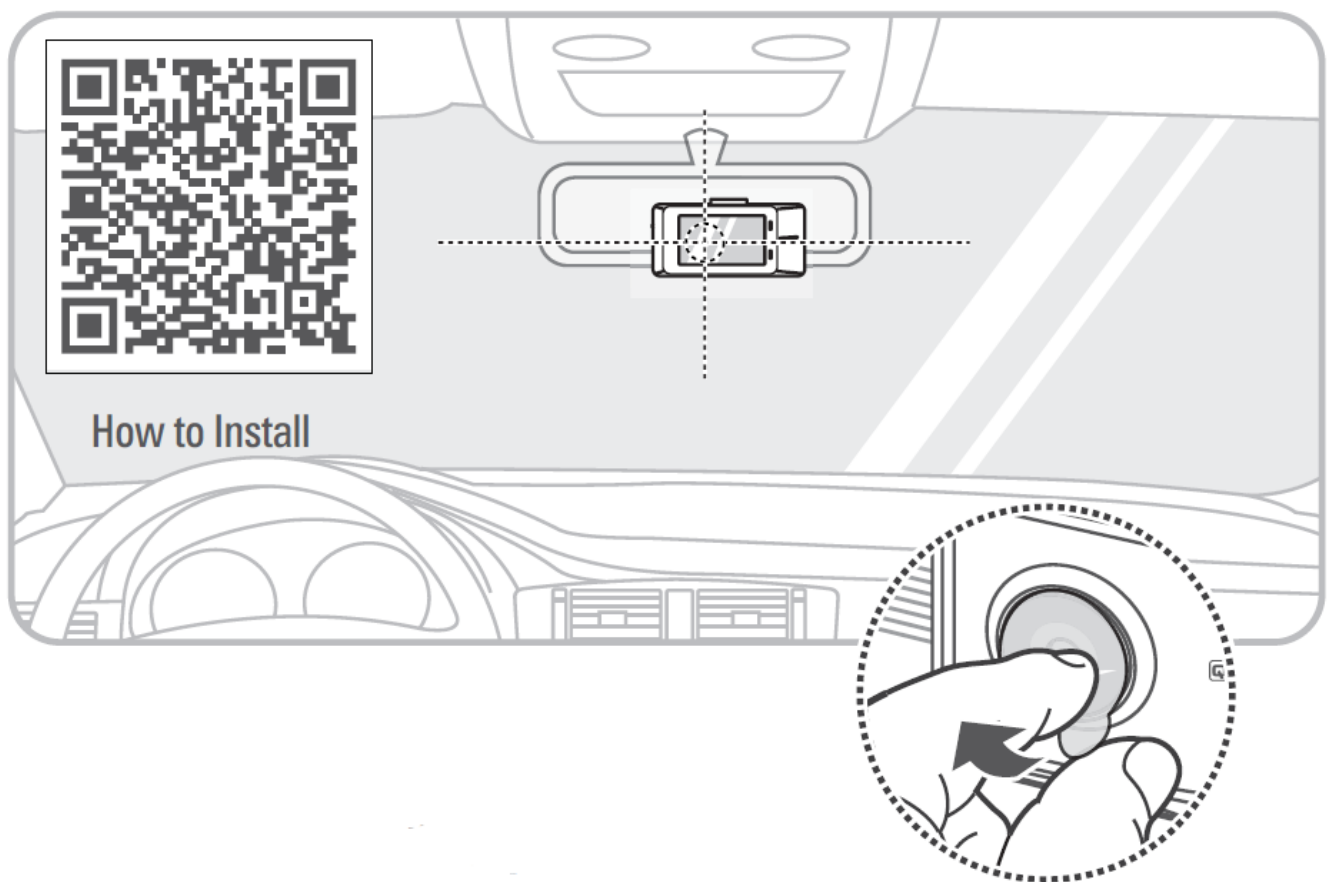

Open Live View in the app

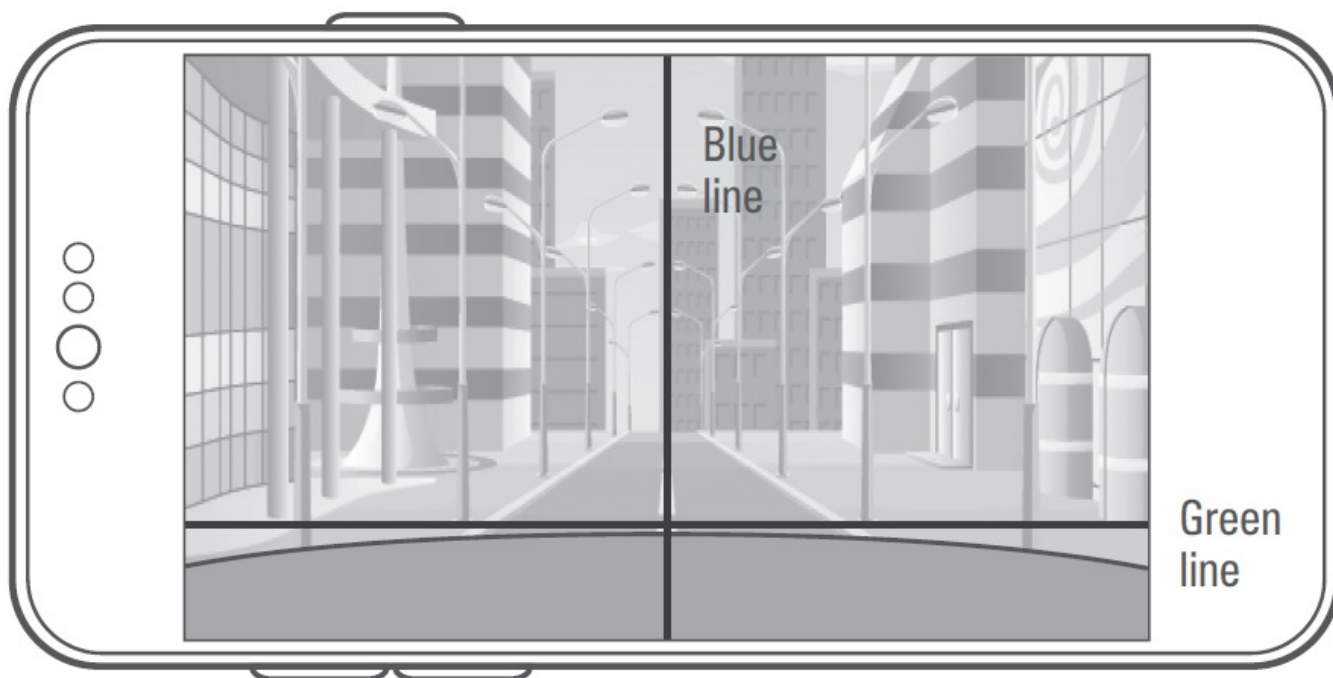

- Blue line with the center
- Green line with the front edge of the hood

Install the Rear View Camera

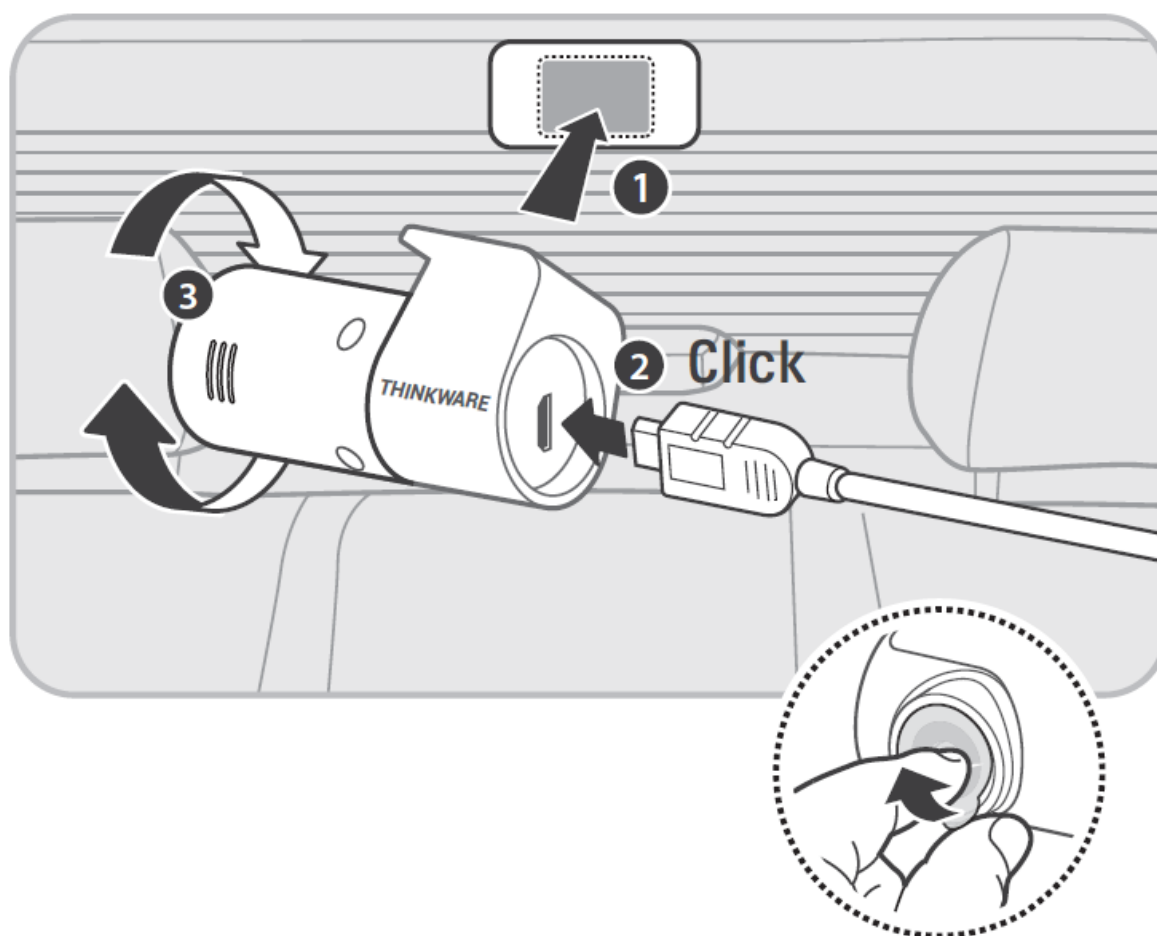

Open Live View Rear Camera in App



- Red line with the trunk center
- Yellow line with the center of the horizon
- Green line with the trunk line

Dash Cam Settings in the App

Default settings out of the box

The default settings are as follows, and you have the option to adjust them according to your preference.

Options	Description
Voice Recording	Enabled
System Volume	0 1 2 3
Parking Mode	Motion Detection
Smart Parking Mode	Thermal Protection – Enabled
	Long-Time Recording – Disabled
Battery Protection	Enabled
Super Night Vision	Parking Mode
ADAS	Disabled
Speed Stamp	Disabled
Safety Camera	Disabled

FAQ & Help Desk

Still have questions or issues?

For further assistance or to report any issues, please contact our support team.

- **North America**
 - 1 [844-865-9273](tel:844-865-9273)
 - support@thinkware.com
- **United Kingdom**
 - 44 (0) 333-121-0008
 - support.eu@thinkware.com
- **European Union**
 - (+49) 69-943-22200
 - support@thinkware.com

FAQs & Help Desk



Please refer to CS Information QR in the box for other countries.

Documents / Resources

<div>THINKWARE DASH CAM™ Quick Start Guide ARC</div>	<div>ARC Thinkware Dash Cam App [pdf] User Guide Thinkware Dash Cam App, Dash Cam App, Cam App, App</div>
-------------------------------------------------------------------	-------------------------------------------------------------------------------------------------------------------------------

References

- [User Manual](#)