



**Contents** [ [hide](#) ]

- 1 AQUALUX 103458 Filtration Unit
- 2 TECHNICAL INFORMATION
- 3 INSTALLATION
- 4 SETTING
- 5 INSTALLATION OF THE PUMP
- 6 HYDRAULIC CONNECTIONS
- 7 ELECTRICAL CONNECTIONS
- 8 THE SETTING
- 9 WINTERING
- 10 USER GUIDE
- 11 POSSIBLE BREAKDOWNS
- 12 WARRANTY
- 13 Documents / Resources
  - 13.1 References

**AQUALUX**

**AQUALUX 103458 Filtration Unit**



## TECHNICAL INFORMATION

Ref	Pool Volume (m <sup>3</sup> )**	Flow rate (m <sup>3</sup> /h)*	Diameter filter (mm)	Filtering area (m <sup>2</sup> )	Pump power	Sand quantity (kg)
103458	23 – 40	5	365	0,10	1/4CV – 180W	40
103460	36 – 60	8	515	0,20	1/25CV – 300W	100
105799	36 – 60	8	515	0,20	1/25CV – 300W	100
103461	45 – 80	10	515	0,20	1/2CV – 370W	100
103463	55 – 95	12	615	0,28	0,8CV – 600W	150

\* : for given flow rates from 50 m<sup>3</sup>/h/m<sup>2</sup> – \*\* : Recycling time : 4h30

Maximum operating pressure: : 2 bars

- It is imperative to verify the non-closure of suction holes.
- It is advisable to turn off the filter during maintenance of the filtration system.
- Regularly monitor the level of filter clogging.
- Deny access to the pool in case of damage or filtration systems

## **INSTALLATION**

### **THE PACKAGE CONSISTS OF:**

- 1 Sand filter
- 1 Prewired Filtration Pump
- 1 Base Pump
- 1 Multi-way valve + flanges + gasket
- 1 Accessories bag

### **THE DECK IS INSTALLED:**

- More than 3.50 m from the edge of the pool
- In a sheltered from rain and easy to access
- On a flat surface, below the water level

### **TOOLS REQUIRED:**

- 1 Phillips screwdriver pH12

- 2 Keys (flat or mixed) # 13

## SETTING

Make sure the 8 laterals are correctly clipped into their holes (fig.1, n°8).

**FIG. 1**

## FILTRE TOP

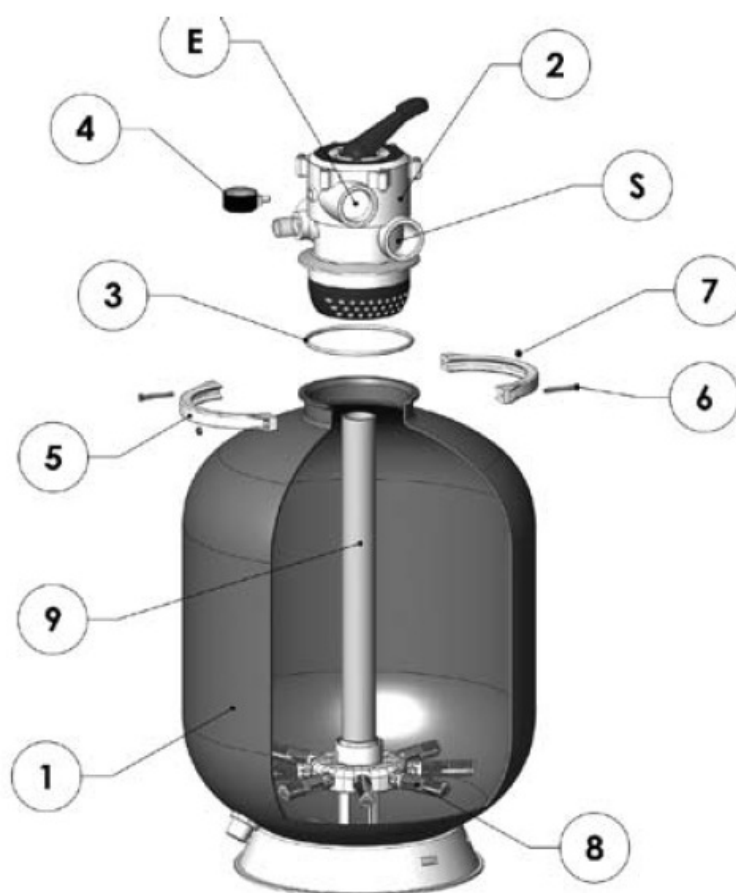

## HANDLING STRAINERS (IF NECESSARY)

Press gently and simultaneously the 2 buttons (No. 1) on either side of the screen, lift it out. Do the reverse for the establishment.

Every manipulation of the screen, make sure it is properly clipped, folded outwards and secured to the collector.

- Obstruct temporarily the top hose (fig. 1, n°9) in order to avoid filling it with sand.
- Installation of the filtering charge :
- Fulfil the tank (fig.1, n°1) with 1/3 water in order to protect the laterals when the filtering charge falls down.

- Pour the quantity of filtering charge needed, according to your filter's capacity (cf table page 1). The filtering charge should not exceed 2/3 of the tank's height.
- CAUTION : be sure that the central hose (fig.1, n°9) is in the axis of the upper opening. Pour with care the first bag of the filtering charge in order to keep the central hose in the axis.
- Check the position of the central hose (vertical).
- Once the tank is full, clean the surround of the filter's upper opening.
- Open the central hose and make a global visual check-up (stability, positioning...)

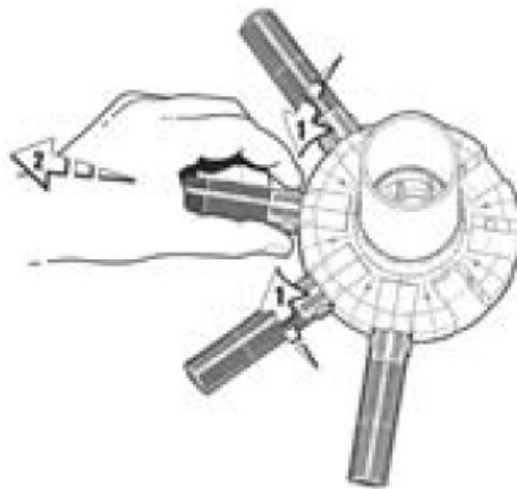

## SETTING OF THE VALVE :

- Put the o'ring under the valve (fig.1, n°3).
- It is advisable to put a bit of silicon oil on the o'rings.
- Position the valve so that the 'RETURN' outlets (discharge, fig.1, letter S) and 'PUMP' (suction, fig.1, letter E) are directed towards the pump, in order to facilitate the connection of the linking hose (fig.2).

Filtration unit

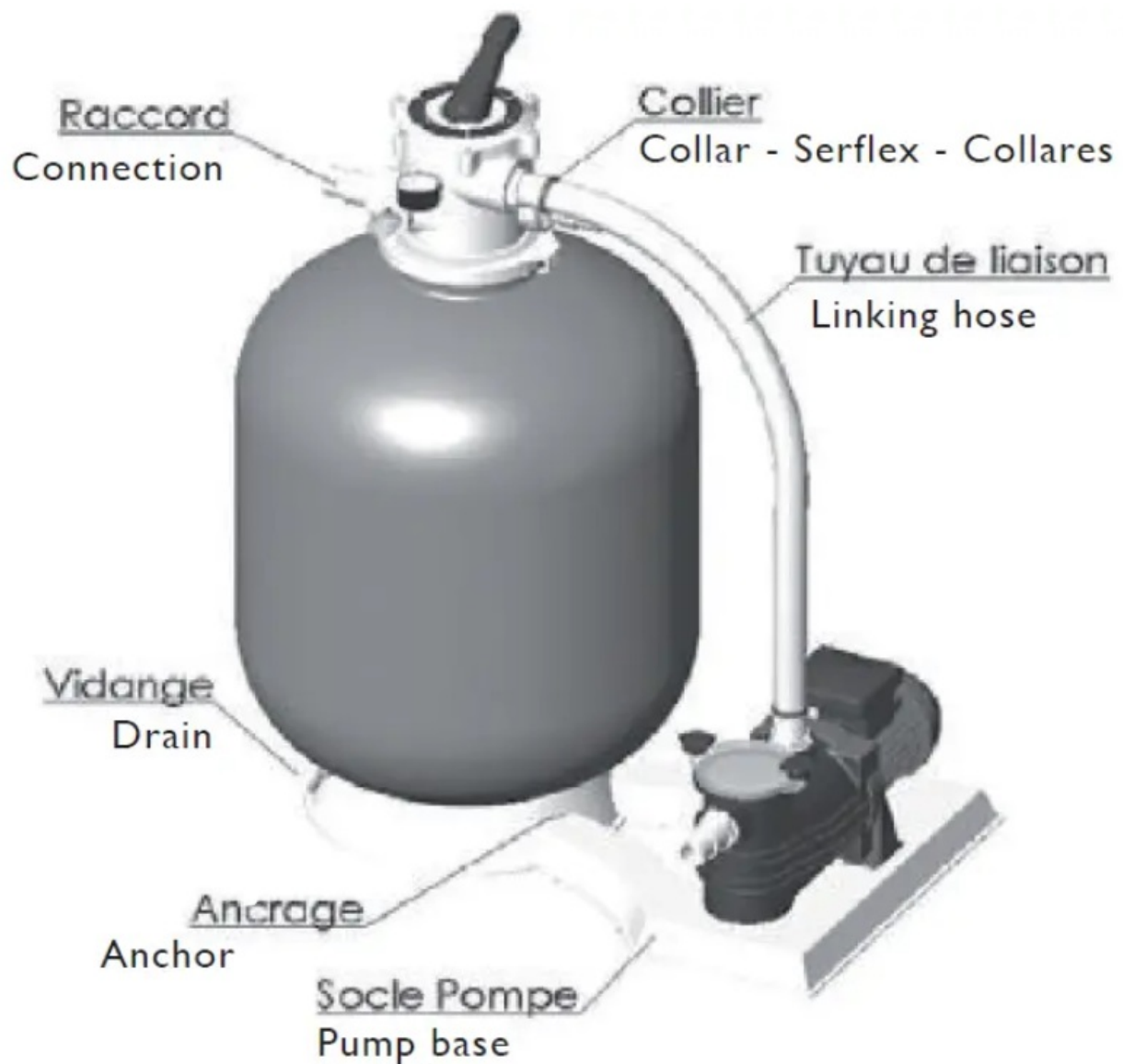

- Put the two half-flanges (fig.1, n°5) on each side of the valve and be careful to put 'nut prints' on the opposite side. Make sure to insert the valve and filter flanges in the flange.
- Insert the screws (fig.1, n°6) and nuts (fig.1, n°7) according to the scheme with a Phillips screwdriver.

Alternate the screwing on both screws in order to have a homogeneous tightening couple.

- Your valve is now firmly attached to the tank and the waterproofness is ensured.
- Except on ref. 105799, unscrew the nut situated on the side of the valve, and put the manometer (fig.1, n°4) at this place, after putting Teflon on the thread.

## INSTALLATION OF THE PUMP

### FIXATION OF THE PUMP ON ITS BASE

- The pump is packaged in its original box for a higher safety. It is electrically wired and ready for use.
- Place the pump on its bases (fig.2) at the level of the fixation holes. Fix the pump using the screws, plastic rings & nuts.
- Set both bases together (pump and tank) with the aid of the clips, according to figure n°2.
- Concerning the pump's running, please refer to user manual.

## **HYDRAULIC CONNECTIONS**

### **COMPONENTS SUPPLIED :**

#### **REF : 103458-103460/105799**

- 5/2 threaded unions (fig.2) 1"1/2 – 32/38
- 5 stainless clamp collars (fig.2)
- 1 flexible pump-filter connecting hose (fig.2)
- 1 PTFE roll

#### **REF : 103461/103463**

- 3 threaded connections (Fig.2) 1"1 / 2 – 32/38
- 3 stainless steel clamps (Fig.2)
- 1 connection kit pump / filter + threaded ends
- 1 PTFE roll

Wrap the threading of the unions with Teflon in order to ensure a perfect waterproofness.

- Except for ref.105799\*, screw on the first three threaded unions on the valve, on the provided locations : 'RETURN' (fig.1, letter S) : outlet towards inlet(s). // 'PUMP' (fig.1, letter E) : filter entry, corresponding to pump discharge // 'WASTE'

\* The ref.105799 has a valve integrating the fluted connections.

- Screw on the two threaded unions on the pump :

- Vertical : pump discharge
- Horizontal : pump suction
- Thread the two stainless collars on the flexible PVC hose. Connect the hose, on one side with the valve link 'PUMP', and on the other side with the vertical link of the pump (pump discharge).
- Check if the hose is driven at the maximum in the unions.
- Tighten the stainless collars in order to ensure their waterproofness.
- Screw the barbed fitting on the pump suction
- Screw the connection kit one hand on the valve by putting the TCB band, on the other hand on the pump discharge (vertical).
- Repeat the operation to link together the pump suction (horizontal link) to the skimmer(s) and the valve outlet ("RETURN") to the inlet. Provide a drainage pipe on the "WASTE" outlet for liquid waste.
- At the time of the installation, we advise you to provide a stopping valve for the suction and another one for the pump discharge, in order to be able to isolate the filtering unit from the pool (especially for the pump's basket cleaning).

## **ELECTRICAL CONNECTIONS**

The supplying electrical installation must comply with the European and local standards in force and must be done by a skilled electrician. Please refer to the annexed pump instructions for additional details.

The whole installation must be provided with an earth plug as well as with a 30 mA differential switch.

Caution : the pump must never be used without water. Always prime the pump before starting up the pump for the first time. In order to facilitate the priming, put the multi-port valve on the "RECIRCULATION" position and start the pump for a few seconds. Please refer to the installation manual of the pump.

**CAUTION : NEVER MANIPULATE THE VALVE WHILE THE PUMP IS ON.**

## **THE SETTING**

- The first operation consists in checking all connections, collars and unions as well as the water level in the pool.
- Check that the pump strainer contains its basket, that the strainer is filled with water



and that the transparent lid is well screwed on.

## **DO A FILTER BACK-WASH IN 9 STEPS :**

1. Check that the pump is off.
2. Put the multi-port valve lever on the "BACK-WASH" position (fig.4, position 1).
3. Turn the pump on. After a few seconds, the water will drain off through the multi-port valve "WASTE" outflow.
4. Wait about 2 minutes until the water becomes clear again and turn the pump off (see backwash sight glass).
5. Put the valve lever on the "RINSE" position (fig.4, position 2).
6. Turn the pump on. The water still drains off from the "WASTE" outlet. Wait about 20 seconds.
7. Turn the pump off again.
8. Put the multi-ways valve lever on the "FILTER" position (fig.4, position 3) for the usual running.
9. Turn the pump on.

During the first back-washes of your filter, some filtering charge may come out of the "WASTE" outlet. This is normal. If some filtering charge is evacuated through inlets in the pool, you just have to make the rinse phase last longer (steps 4, 5 and 6). Remember to check the water level of your pool during the back washes and add some water if required.

## **WINTERING**

IT IS ADVISABLE TO EMPTY THE FILTER AND THE PUMP DURING THE POOL WINTERING :

- Unplug the electrical supplying of the filtration unit.
- Isolate the unit from the pool in turning off the valves linking them together.
- Remove the multi-port valve from the filter.
- Unscrew the drain cap (fig.2) in order to empty the tank. Caution : an air entrance must be implemented on the top of the tank.
- Remove the pump lid (fig.3, n°66), empty the strainer basket (fig.3, n° 64) and

unscrew the pump draining cap (fig.3, n°69).

- Keep the filtration unit away from extreme cold.

## USER GUIDE

Regularly clean the skimmer basket and pump strainer.

Maintain a maximum water level in your pond (2 / 3 the height of the skimmer) so that the pump does not suck air.

- When the chemicals have been used to treat the pool water is recommended to respect a minimum filtration time to preserve the health of swimmers that depends on the health rules.<sup>4</sup> As the running of your filtration unit on 'FILTRATION' position goes along, the filtering charge clogs up, the pressure on the manometer increases. The filter needs to be unblocked by a filter wash or back-wash (see § 6, "Do a filter back-wash in 9 steps").
- Regularly check that the pump basket is not full : indeed, it can be obstructed by litters pumped in by the skimmer and so make the manometer pressure decrease.
- Regularly check the manometer pressure. If it has increased, do a back-wash (see §6).
- Make a point of turning the pump off before handling the multi-port valve.
- In order to empty the pool quickly (if equipped with a main drain), you can put the multi-port valve lever on the 'WASTE' position (fig.4, position 4). The water sucked-up from the pool is evacuated outside straight away.
- The 'RECIRCULATION' position (fig.4, position 5) on the valve enables you to make the water circulate in your pool without the water being filtered. This position is often used in order to improve the spreading of shock products (chlorine shock, ph-/ph+ powder, wintering products).
- Put the lever on the 'CLOSE' position (fig.4, position 6) in order to turn off all internal pipes of the valve.
- During the pool use period, the filtration must be put into service every day. The time of filtration depends on the number of people using the pool and the water temperature (from 2 to 12 hours a day).
- In order to get a clear and safe water, regularly check up (once a week) the pH and the disinfectant level (chlorine, bromine...). For an optimal efficiency of the disinfectant, it is essential to keep the pH between 7 and 7,4.

## POSSIBLE BREAKDOWNS

It is imperative to change as rapidly as soon as any element or combination of items damaged. Use only approved parts responsible for the placing on the market.

NO PRIMING	LOW FLOW	ABNORMAL NOISE	DOES NOT START	SAND IN THE POOL	CAUSES	SOLUTIONS
x	x	x			Air inlet	Check the tightness of connections (PTFE tape), the pipe, valve and cover gasket
x		x			No water in the pump housing	Fill the body pump with water
		x	x		Blocking / friction fan	Refocus the hood and check no object blocking, run the pump with a screwdriver
		x			Internal friction (Bearing / trim / turbine)	Run the pump by inserting a screwdriver horizontally on the screw head into the fan cover (this simply confirms the diagnosis) Requires then dismantling the pump by a professional)
			x		Axis locked	Unlocking the axis by inserting a screwdriver horizontally on the screw head in the fan hood
		x			Poor fixation of the pump on the bas	Fix the pump on the base and place the plate on a stable and not sound reverberator
	x				Obstruction of the hydraulic circuit	Clean the skimmer basket, the basket of the pump, check the absence of foreign body in the pipes, making a filter against washing
	x				Foreign body in the turbine	Requires disassembly of the pump by a professional
			x		No power	Reconnect the plug, if a guard is appliance is switched off (30mA, circuit breaker, fuse) clearly identify the cause before re-arming in doubt consult a qualified electrician
				x	Internal fault element (broken strainer mounting / valve)	Check manipulating the absence of sand in the valve (seal wear) = replace the valve, remove the sand and check the condition of the strainers = replace the screen
				x	Use of sand not suitable (masonry, ...)	Replace with pool filter sand

## IMPORTANT REMARKS

- In order to improve our products quality, we reserve the right to modify the composition and the configuration of our filtration unit at any time and without any advance warning.
- Descriptions and characteristics featured on this document are given for information only and are not contractual.
- Are not guaranteed :
  - Problems due to a commercial, professional or collective use.
  - Damages due to an installation, which does not comply with the manufacturer prescriptions and methods.
- Failure to observe installation and/or use conditions leads to the warranty cancellation and disclaims all responsibility of the manufacturer.

## WARRANTY

Sand filters are warranted against defects in material and workmanship for a period of 5 years for the tank, 1 year for pump (excluding dry running) and 1 year for the rest of the components, from the date of shipping. Other components (strainers, collector, base, trim, etc.) are considered consumables. Wear parts are not covered by this warranty. This warranty is subject to compliance with the assembly instructions and / or maintenance. Interventions under the warranty shall not have the effect of extending the length of it. The presentation of the invoice must be submitted when the guarantee is invoked. Under this warranty, the only obligation of the seller will be free replacement or repair of the product or component found to be defective by the services of the seller. All other costs will be the responsibility of the buyer. To qualify for this warranty, all products must be submitted in advance to the customer service of the seller, whose agreement is essential for any replacement. The guarantee does not apply in case of defect. Also excluded are defects and deterioration caused by normal wear, defects resulting from assembly and / or a non-conforming use, and product modifications carried out without the consent of the seller.

**Legal guarantee:** provided that the purchaser makes the proof of hidden defect, the seller must legally repair all the consequences (Article 1641 of the Civil Code). If the buyer goes to court, it must do so within a short time after the discovery of the hidden defect (Article 1648 of the Civil Code).

- To improve the quality of our products, we reserve the right to modify at any time and without notice, the composition and configuration of our filtration plates.
- Descriptions and specifications contained in this document is provided for information only and are not contractual.
- Not covered:
  - Problems arising from commercial to use, professional or collective.
  - Damage caused by dry running of the pump (overheating / alteration of the mechanical seal).

Install the pump outside the pool below the water level / Constantly maintain at all times the water level to 2 / 3 of the height of the skimmer.

In case of frost, drain the pre-filter with the bleeder screw, in the event of prolonged stop

(winter) store the pump in a dry and cool place.

287, Avenue de la Massane | 13210 Saint-Rémy-de-Provence | France



- [www.aqualux.com](http://www.aqualux.com)

## Documents / Resources

	<p><a href="#">AQUALUX 103458 Filtration Unit [pdf]</a> User Manual</p> <p>103458, 103460, 103461, 103463, 105799, 103458 Filtration Unit, 103458, Filtration Unit, Unit</p>
---	--

## References

- [User Manual](#)

 103458, 103458 Filtration Unit, 103460, 103461, 103463, 105799, AQUALUX, Filtration Unit,  AQUALUX Unit

---

## Leave a comment

Your email address will not be published. Required fields are marked \*

Comment \*

Name

Email

Website

☐ Save my name, email, and website in this browser for the next time I comment.

**Post Comment**

**Search:**

**Search**

[Manuals+](#) | [Upload](#) | [Deep Search](#) | [Privacy Policy](#) | [@manuals.plus](#) | [YouTube](#)

This website is an independent publication and is neither affiliated with nor endorsed by any of the trademark owners. The "Bluetooth®" word mark and logos are registered trademarks owned by Bluetooth SIG, Inc. The "Wi-Fi®" word mark and logos are registered trademarks owned by the Wi-Fi Alliance. Any use of these marks on this website does not imply any affiliation with or endorsement.