

AQFORM
LIGHTING SOLUTIONS
FLATTRACK
Surface
System

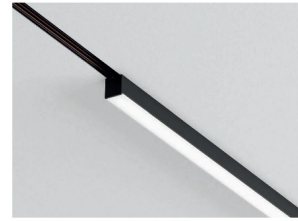

AQFORM FLATTRACK Surface System Installation Guide

[Home](#) » [AQFORM](#) » AQFORM FLATTRACK Surface System Installation Guide 

Contents

- [1 AQFORM FLATTRACK Surface System](#)
- [2 WHAT IS IN THE BOX](#)
- [3 Installation Steps](#)
- [4 Mechanical Connections](#)
- [5 Specifications](#)
- [6 Power Box Dimensions](#)
- [7 FAQ](#)
- [8 Documents / Resources](#)
 - [8.1 References](#)
- [9 Related Posts](#)



AQFORM FLATTRACK Surface System

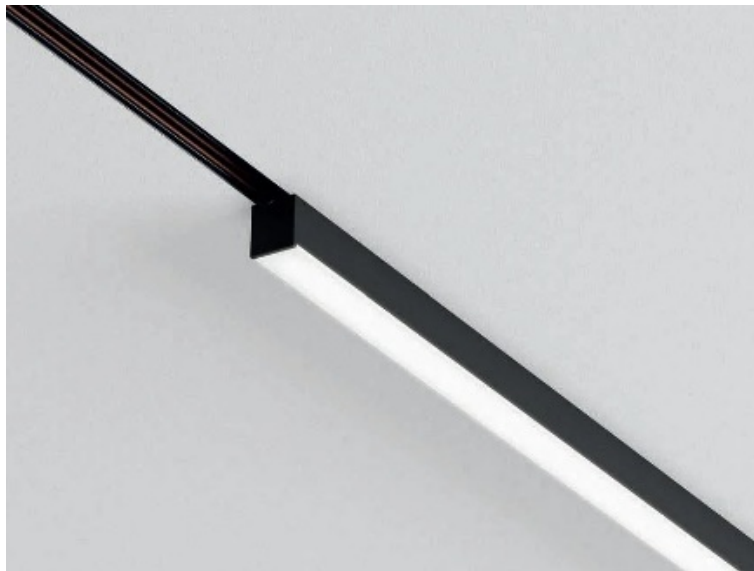

WHAT IS IN THE BOX

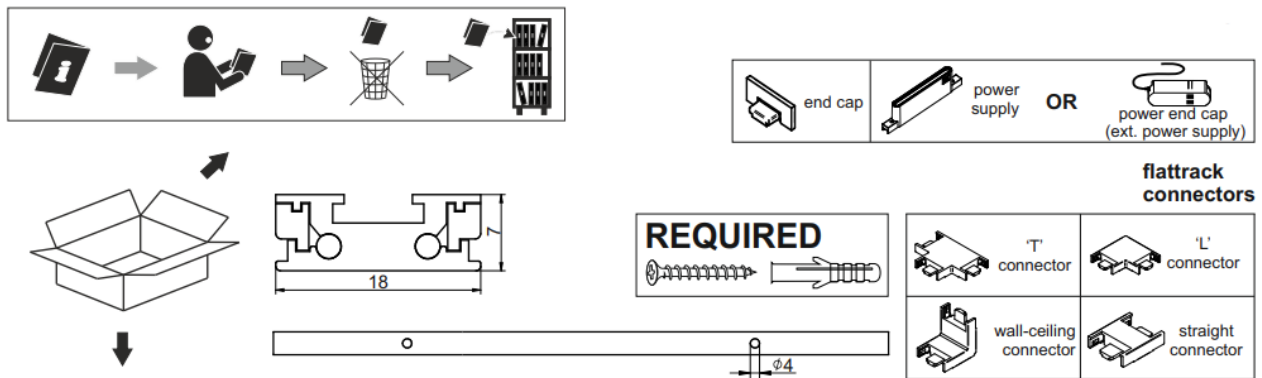

Straight Flattrack Line Requirements

- End Cap
- Power Supply OR Power End Cap (External Power Supply)

Flattrack Connectors

- 'T' Connector
- 'L' Connector
- Wall-Ceiling Connector
- Straight Connector

Required Tools

- Screwdriver

Installation Steps

Step 1

Unpack the components and ensure all parts are included.

Step 2

1. Position the track on the ceiling.
2. Secure the track using screws.
3. Ensure the track is level and properly aligned.

Turn off the power supply before proceeding.

Step 3

Connect the track power supply:

1. Attach the power supply to the track.
2. Secure the power supply with screws.
3. Connect the power cables to the power supply.

Step 4

Install the end cap:

1. Place the end cap on the track.
2. Secure the end cap with screws.

Step 5

Connect the power supply box:

1. Attach the power supply box to the track.
2. Connect the power cables to the power supply box.
3. Secure the power supply box with screws.

Turn on the power supply to test the installation.

1

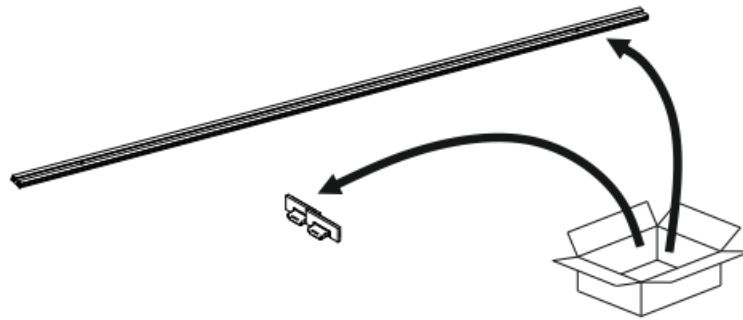

2

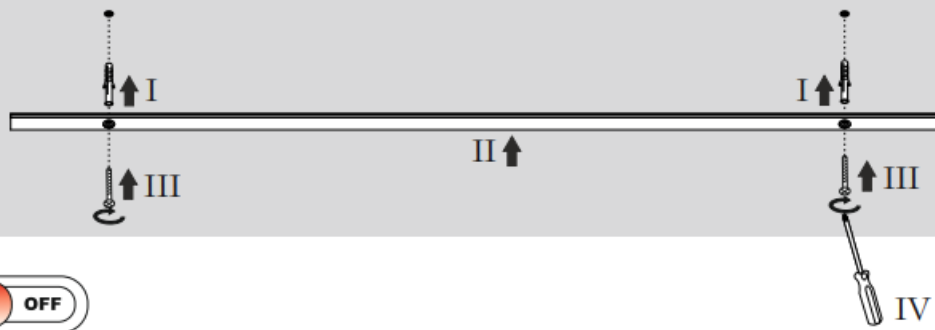

Track power supply

3

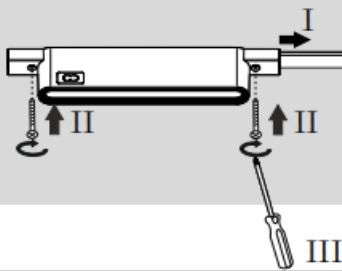

4



5

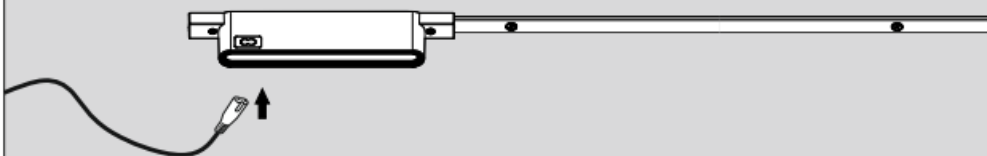

Box with power supply

3



4

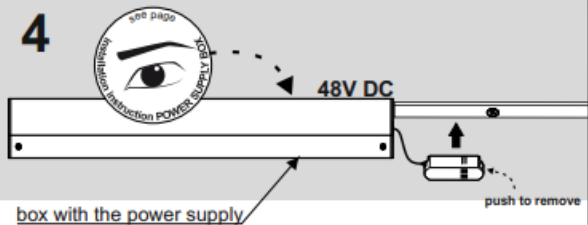

5



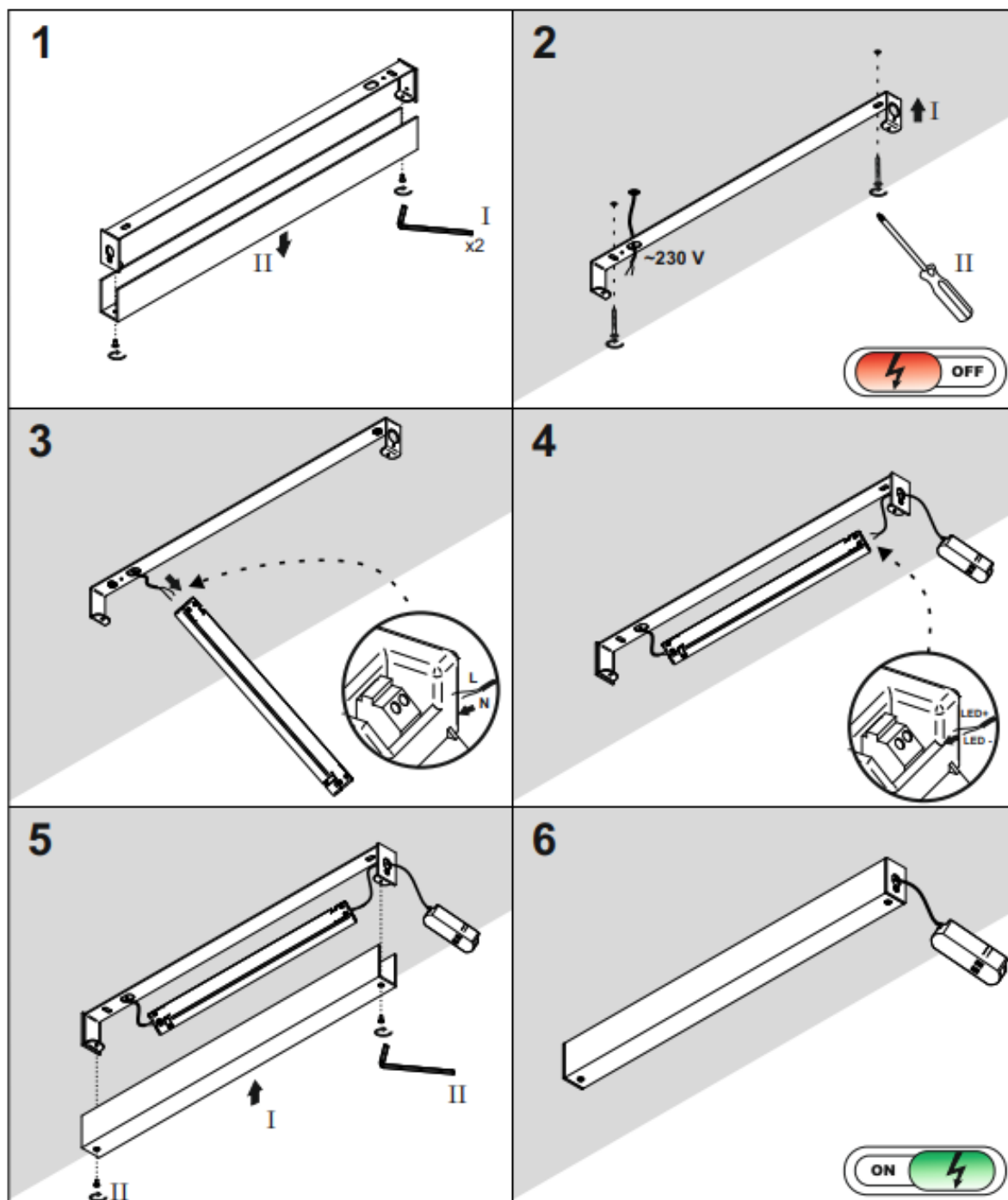
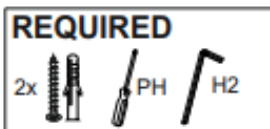

Mechanical Connections

'L' Connection	'T' Connection	Straight Connection	Wall-Ceiling Connection
Connect the 'L' connect or to the track.	Connect the 'T' connect or to the track.	Connect the straight connector to the track.	Connect the wall-ceiling connector to the track.

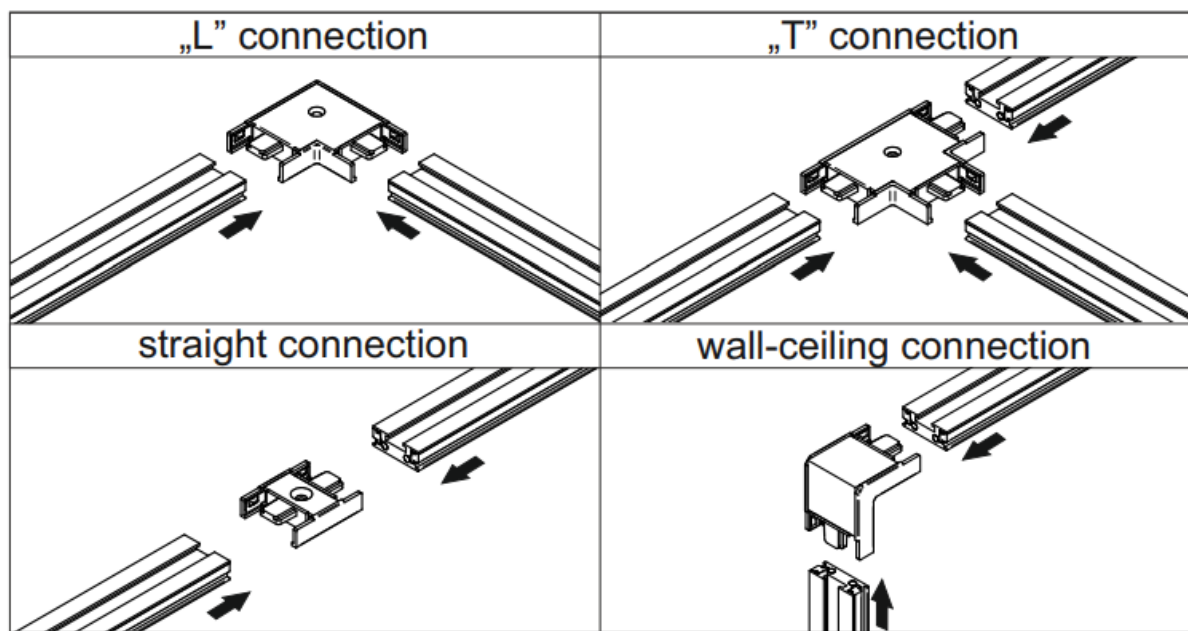

Specifications

Dimension	Value (mm)
Length	292
Width	24
Height	20
Power Supply Hole	14 x 28

Power Box Dimensions

The power box dimensions are as follows:

- Length: 292 mm
- Width: 24 mm
- Height: 20 mm
- Power Supply Hole: 14 x 28 mm

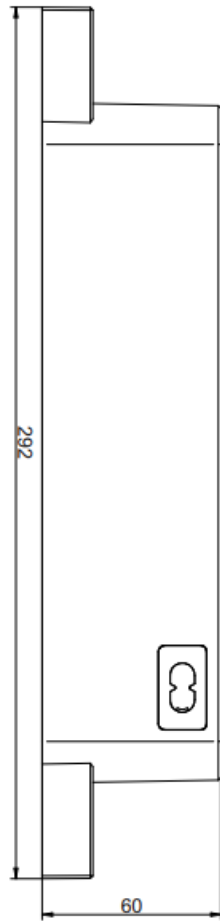

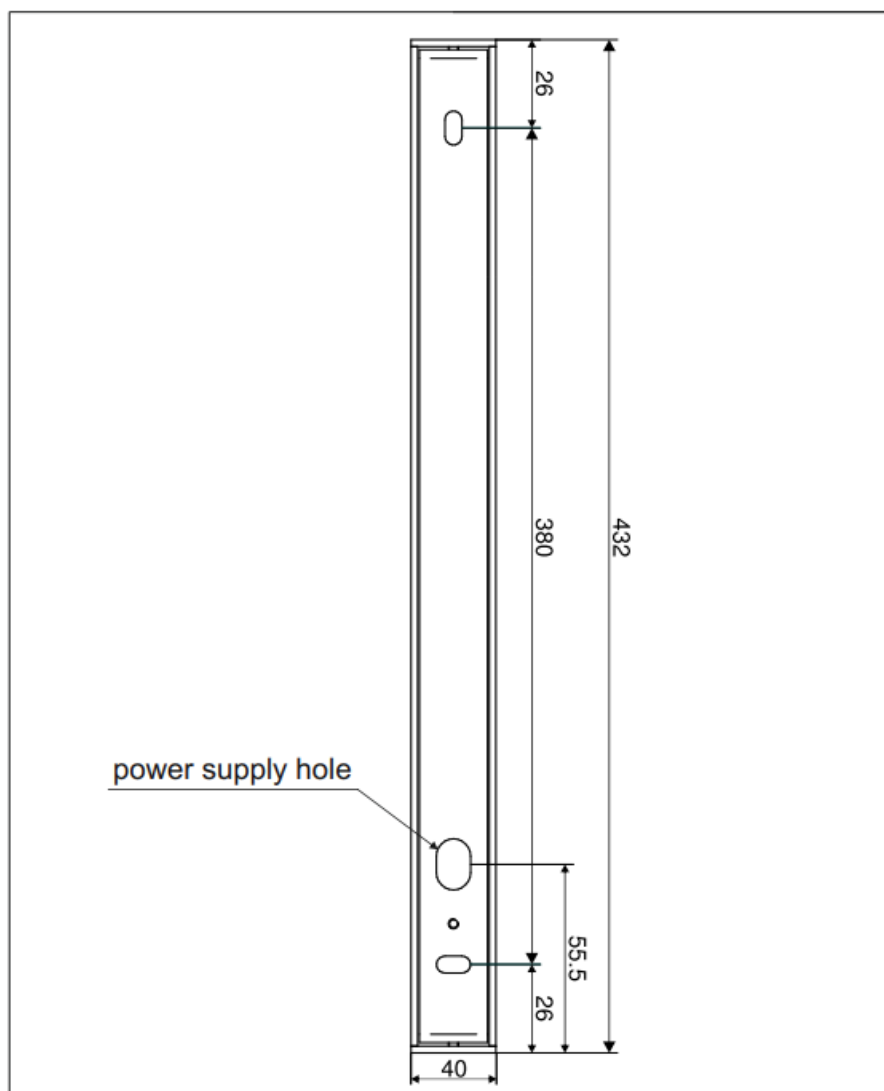

FAQ

- **Q: What tools are required for the installation?**

A screwdriver is required for the installation.

- **Q: How do I connect the power supply?**

A: Attach the power supply to the track, secure it with screws, and connect the power cables.

- **Q: How do I install the end cap?**

A: Place the end cap on the track and secure it with screws.

- **Q: What are the dimensions of the power box?**

A: The power box dimensions are 292 mm (length), 24 mm (width), 20 mm (height), and the power supply hole is 14 x 28 mm.

For further assistance, please contact AQFORM Inc. sp. z o.o. at ul. Przemysłowa 12-14, 32-070 Czernichów, Poland, or call +48 12 270 21 22.

AQUAFORM Inc. sp. z o.o. ul. Przemysłowa 12-14 | 32-070 Czernichów | Poland | +48 12 270 21 22 | info@aqform.com | www.aqform.com

Documents / Resources

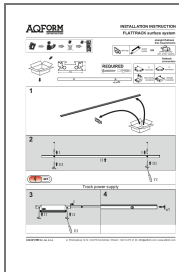

[AQFORM FLATTRACK Surface System](#) [pdf] Installation Guide
FLATTRACK Surface System, FLATTRACK, Surface System, System

References

- [User Manual](#)

Manuals+, Privacy Policy

This website is an independent publication and is neither affiliated with nor endorsed by any of the trademark owners. The "Bluetooth®" word mark and logos are registered trademarks owned by Bluetooth SIG, Inc. The "Wi-Fi®" word mark and logos are registered trademarks owned by the Wi-Fi Alliance. Any use of these marks on this website does not imply any affiliation with or endorsement.