



# Aqara WSDCGQ11LM Smart Temperature and Humidity Sensor User Guide

[Home](#) » [Aqara](#) » Aqara WSDCGQ11LM Smart Temperature and Humidity Sensor User Guide 



## Temperature and Humidity Sensor User Guide

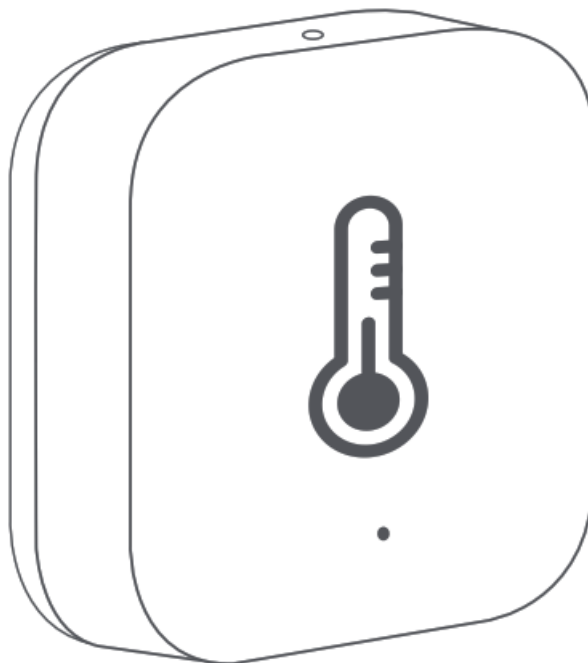

Temperature and Humidity Sensor

## Contents

- 1 Product Introduction
- 2 Quick Setup
- 3 Specifications
- 4 Documents / Resources
  - 4.1 References
- 5 Related Posts

## Product Introduction

Aqara Temperature and Humidity Sensor monitor and records indoor temperature, humidity, and atmospheric pressure in real time. The current and historical data is displayed in the app. It can also trigger other smart accessories to automate your home.

- A hub is required.
- Aqara Hub is required to enable Aqara Temperature and Humidity Sensor to work with HomeKit technology. See [www.aqara.com](http://www.aqara.com) for more details.
- This product is for indoor use only.

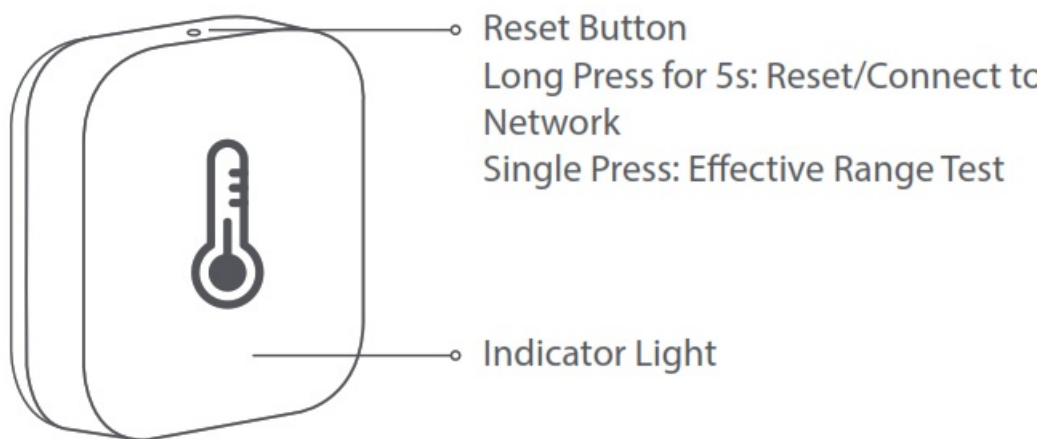

## Quick Setup

1. Before activating the accessory, please make sure you have the Aqara Home app downloaded and the Aqara hub installed.
2. Please open the app, tap "Home" and then tap "+" in the top right corner to enter the "Add Device (Accessory)" page. Select "Temperature and Humidity Sensor", and add it according to the instructions.

\* If the connection fails, please move the accessory closer to the Hub and try again.

### Installation

Effective Range Test: Single press the reset button on the accessory at your desired position. If the Hub makes voice prompts, it indicates that the accessory can communicate effectively with the Hub.

\* Avoid metal surfaces to maximize signal strength.

**Option 1:** Place it directly in the desired position.

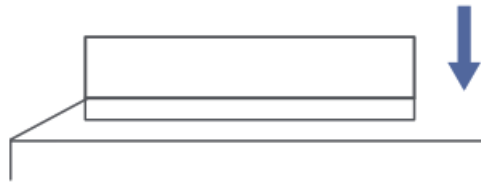

**Option 2:** Remove the protective lm, and stick it to the desired position.

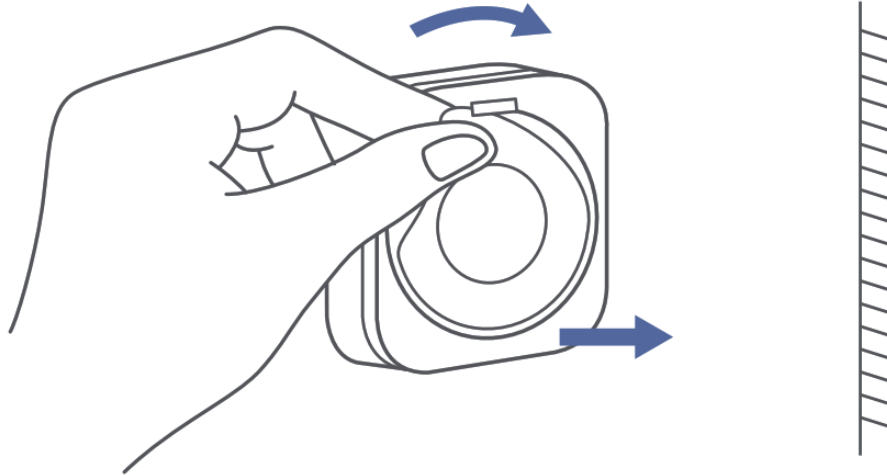

\* Keep the surface clean and dry.

## Specifications

Model: WSDCGQ11LM

Dimensions: 36 × 36 × 9 mm (1.42 × 1.42 × 0.35 in.)

Wireless Protocol: Zigbee

Battery: CR2032

Temperature Range and Precision: -20° – +50°C, ±0.3°C (-4° – 122°F ±0.54°F)

Humidity Range and Precision: 0 – 100% RH, ±3%

Atmospheric Pressure Range and Precision:

30 kPa – 110 kPa, ±0.12 kPa

Maximum Transmit Power (Zigbee): 9.99 dBm

Working Frequency: 2400 MHz – 2483.5 MHz

Online Customer Service: [www.aqara.com/support](http://www.aqara.com/support)

Email: [support@aqara.com](mailto:support@aqara.com)

Manufacturer: Lumi United Technology Co., Ltd.

Address: 8th Floor, JinQi Wisdom Valley, No.1 Tangling Road,  
Liuxian Ave, Taoyuan Residential District, Nanshan District,  
Shenzhen, China.

## Warnings

1. This product is NOT a toy. Please keep children away from 1. this product.
2. This product is designed for indoor use only. Do NOT use in humid environments or outdoors.
3. Beware of moisture, do NOT spill water or other liquids onto the product.
4. Do NOT place this product near a heat source. Do NOT place it in an enclosure unless there is normal ventilation.
5. Do NOT attempt to repair this product by yourself. All repairs should be performed by an authorized professional. This product is only suitable for improving the entertainment, and convenience of your home life

and reminding you about the device status.

6. If a user violates the product use instructions, the manufacturer will NOT be liable for any risks and property losses.

**FCC ID: 2AKIT-WSDCGQ11LM**

Federal Communications Commission (FCC) compliance statement:

1. This device complies with part 15 of the FCC Rules. Operation is subject to the following two conditions:
  - (1) This device may not cause harmful interference, and
  - (2) this device must accept any interference received, including interference that may cause undesired operation.
2. Changes or modifications not expressly approved by the party responsible for compliance could void the user's authority to operate the equipment.

**Note:** This equipment has been tested and found to comply with the limits for a Class B digital device, pursuant to part 15 of the FCC Rules. These limits are designed to provide reasonable protection against harmful interference in a residential installation. This equipment generates, uses and can radiate radio frequency energy and, if not installed and used in accordance with the instructions, may cause harmful interference to radio communications. However, there is no guarantee that interference will not occur in a particular installation. If this equipment does cause harmful interference to radio or television reception, which can be determined by turning the equipment off and on, the user is encouraged to try to correct the interference by one or more of the following measures:

- Reorient or relocate the receiving antenna.
- Increase the separation between the equipment and receiver.
- Connect the equipment into an outlet on a circuit different from that to which the receiver is connected.
- Consult the dealer or an experienced radio/TV technician for help.

**RF Exposure statement:**

This equipment complies with FCC radiation exposure limits set forth for an uncontrolled environment. This equipment should be installed and operated with a minimum distance of 20 cm between the radiator and your body. This transmitter must not be co-located or operating in conjunction with any other antenna or transmitter.

IC: 22635-WSDCGQ11LM

**IC NOTICE TO CANADIAN USERS**

This device contains license-exempt transmitter(s)/receiver(s) that comply with Innovation, Science, and Economic Development Canada's license-exempt RSS(s). Operation is subject to the following two conditions:

- (1) This device may not cause interference.
- (2) This device must accept any interference, including interference that may cause undesired operation of the device.

This Class B digital apparatus complies with Canadian ICES -003. This device complies with RSS -247 of Industry Canada. Operation is subject to the condition that this device does not cause harmful interference.

This equipment complies with IC radiation exposure limits set forth for an uncontrolled environment. This equipment should be installed and operated with a minimum distance of 20 cm between the radiator and your body. This transmitter must not be co-located or operating in conjunction with any other antenna or transmitter.



**CAUTION**

Risk of explosion if the battery is replaced by an incorrect type.

Dispose of used batteries according to the instructions.

Do not ingest battery, Chemical Burn Hazard.

This product contains a coin/button cell battery. If the coin/button cell battery is swallowed, it can cause severe internal burns in just 2 hours and can lead to death.

Keep new and used batteries away from children.

If the battery compartment does not close securely, stop using the product and keep it away from children.

If you think batteries might have been swallowed or placed inside any part of the body, seek immediate medical attention.

1. The equipment is only suitable for mounting at heights  $\leq 2$  m
2. Disposal of a battery into fire or a hot oven, or mechanically crushing or cutting of a battery, which can result in an explosion Leaving a battery in an extremely high temperature surrounding environment that can result in an explosion or the leakage of flammable liquid or gas A battery subjected to extremely low air pressure may result in an explosion or the leakage of flammable liquid or gas



Hereby, [Lumi United Technology Co., Ltd.] declares that the radio equipment type [Temperature and Humidity Sensor, WSDCGQ11LM] is in compliance with Directive 2014/53/EU. The full text of the EU declaration of conformity is available at the following internet address: <http://www.aqara.com/DoC/>



■ All products bearing this symbol are waste electrical and electronic equipment (WEEE as in directive 2012/19/EU) which should not be mixed with unsorted household waste. Instead, you should protect human health and the environment by handing over your waste equipment to a designated collection point for the recycling of waste electrical and electronic equipment, appointed by the government or local authorities. Correct disposal and recycling will help prevent potential negative consequences to the environment and human health. Please contact the installer or local authorities for more information about the location as well as the terms and conditions of such collection points.



□ The symbol on the product or on its packaging indicates that this product may not be treated as household waste. Instead, it shall be handed over to the applicable collection point for the recycling of electrical and electronic equipment.



## Documents / Resources

	<a href="#">Aqara WSDCGQ11LM Smart Temperature and Humidity Sensor</a> [pdf] User Guide WSDCGQ11LM Smart Temperature Humidity Sensor, WSDCGQ11LM, Smart Temperature Humidity Sensor, Temperature and Humidity Sensor, Humidity Sensor, Sensor
---	--

## References

- [Home](#)
- [CE-DOC](#)
- [Support](#)