



# Aqara 100381 Temperature and Humidity Sensor User Guide

[Home](#) » [Aqara](#) » Aqara 100381 Temperature and Humidity Sensor User Guide

## Contents [ [hide](#) ]

- [1 Aqara 100381 Temperature and Humidity Sensor](#)
- [2 Product Introduction](#)
- [3 Quick Setup](#)
- [4 Installation](#)
- [5 Specifications](#)
- [6 Documents / Resources](#)
  - [6.1 References](#)
- [7 Related Posts](#)



**Aqara 100381 Temperature and Humidity Sensor**



## Product Introduction

Aqara Temperature and Humidity Sensor monitors and records indoor temperature, humidity and atmospheric pressure in real time. The current and historical data is displayed in the app. It can also trigger other smart accessories to automate your home.

- A hub is required.
- Aqara Hub is required to enable Aqara Temperature and Humidity Sensor to work with HomeKit technology.  
See [www.aqara.com](http://www.aqara.com) for more details.
- This product is for indoor use only.

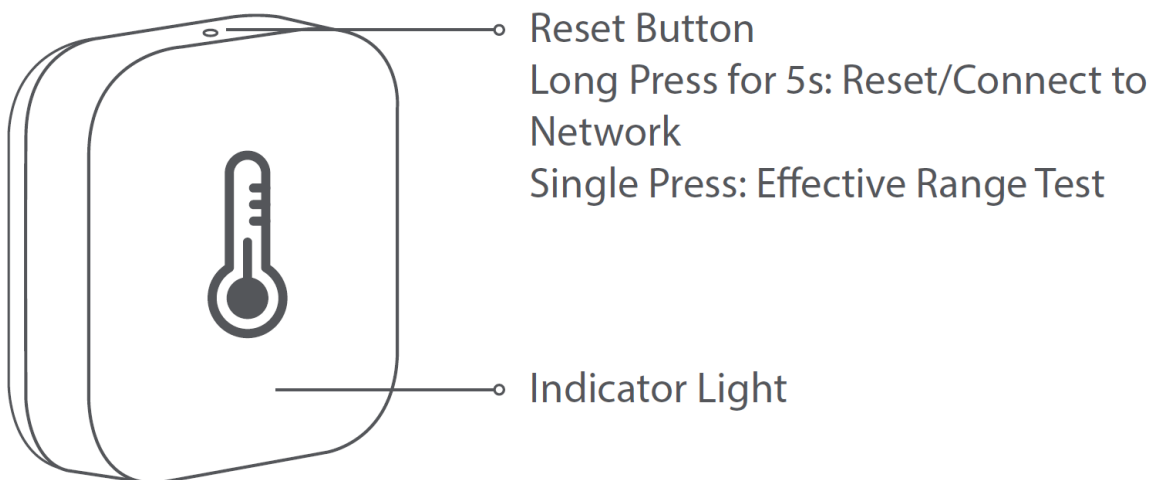

## Quick Setup

1. Before activating the accessory, please make sure you have the Aqara Home app downloaded and Aqara hub installed.
2. Please open the app, tap “Home” and then tap “+” in the top right corner to enter “Add Device (Accessory)” page. Select “Temperature and Humidity Sensor”, and add it according to instructions.
  - If the connection fails, please move the accessory closer to the Hub and try again.

## Installation

Effective Range Test: Single press the reset button on the accessory at your desired position. If the Hub makes voice prompts, it indicates that the accessory can communicate effectively with the Hub.

\* Avoid metal surface to maximize signal strength.

**Option 1:** Place it directly in the desired position.

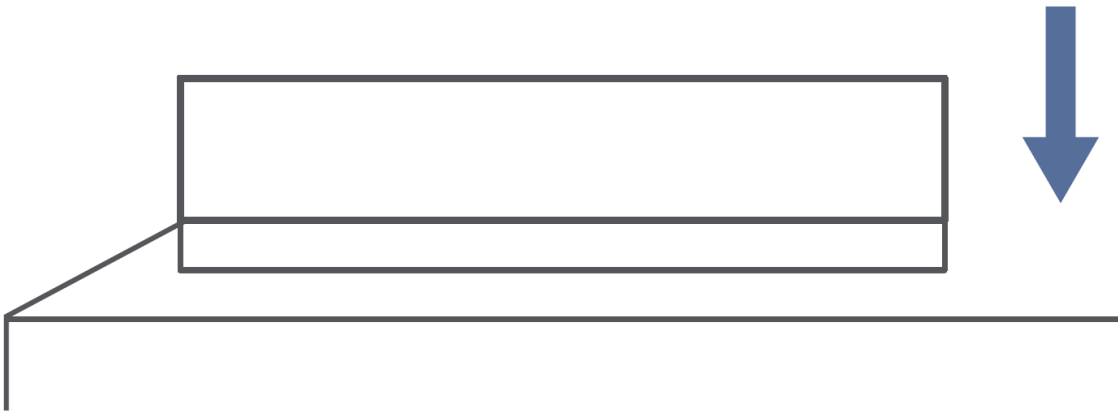

**Option 2:** Remove the protective film, and stick it to the desired position.

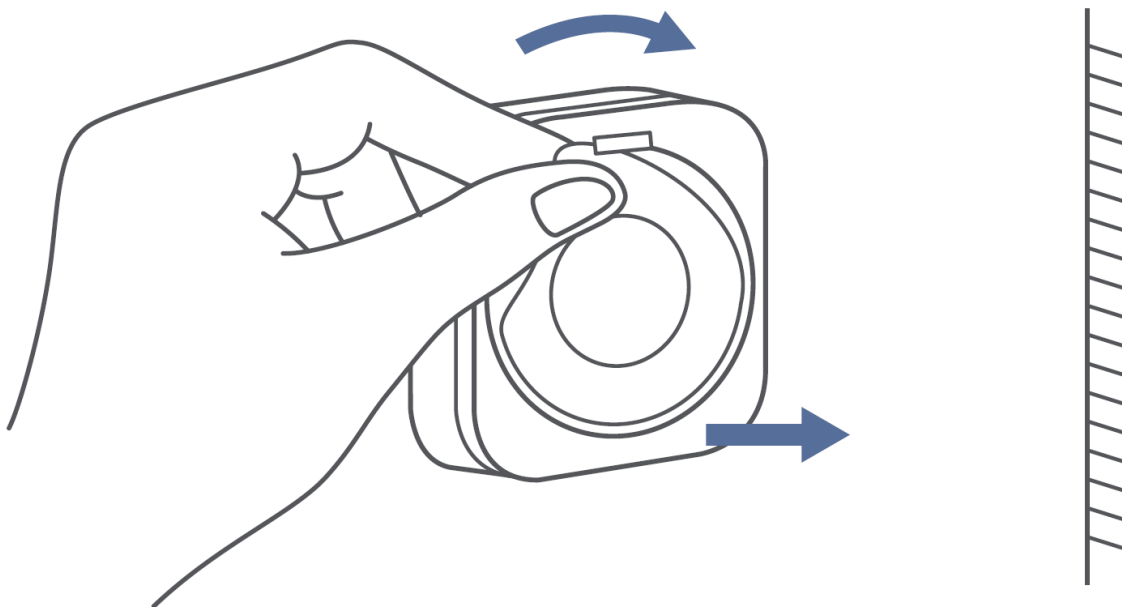

\* Keep the surface clean and dry.

## Specifications

- **Model:** WSDCGQ11LM
- **Dimensions:** 36 × 36 × 9 mm (1.42 × 1.42 × 0.35 in.)
- **Wireless Protocol:** Zigbee

- **Battery:** CR2032
- **Temperature Range and Precision:** -20° – +50°C, ±0.3°C (-4° – 122°F ±0.54°F)
- **Humidity Range and Precision:** 0 – 100% RH, ±3%
- **Atmospheric Pressure Range and Precision:** 30 kPa – 110 kPa, ±0.12 kPa
- **Maximum Transmit Power (Zigbee):** 9.99 dBm
- **Working Frequency:** 2400 MHz – 2483.5 MHz

Online Customer Service: [www.aqara.com/support](http://www.aqara.com/support)

Email: [support@aqara.com](mailto:support@aqara.com)

Manufacturer: Lumi United Technology Co., Ltd.

Address: 8th Floor, JinQi Wisdom Valley, No.1 Tangling Road, Liuxian Ave, Taoyuan Residential District, Nanshan District, Shenzhen, China.

## Warnings

1. This product is NOT a toy. Please keep children away from this product.
2. This product is designed for indoor use only. Do NOT use in humid environments or outdoors.
3. Beware of moisture, do NOT spill water or other liquids onto the product.
4. Do NOT place this product near a heat source. Do NOT place it in an enclosure unless there is normal ventilation. Do NOT attempt to repair this product by yourself. All repairs should be performed by an authorized professional.
5. This product is only suitable for improving the entertainment, convenience of your home life and reminding you about the device status.
6. If a user violates the product use instructions, the manufacturer will NOT be liable for any risks and property losses.

FCC ID: 2AKIT-WSDCGQ11LM

Federal Communications Commission (FCC) compliance statement:

1. This device complies with part 15 of the FCC Rules.  
Operation is subject to the following two conditions:
  - This device may not cause harmful interference, and
  - This device must accept any interference received, including interference that may cause undesired operation.
2. Changes or modifications not expressly approved by the party responsible for compliance could void the user's authority to operate the equipment.

**Note:** This equipment has been tested and found to comply with the limits for a Class B digital device, pursuant to part 15 of the FCC Rules. These limits are designed to provide reasonable protection against harmful interference in a residential installation.

This equipment generates, uses and can radiate radio frequency energy and, if not installed and used in accordance with the instructions, may cause harmful interference to radio communications. However, there is no guarantee that interference will not occur in a particular installation. If this equipment does cause harmful interference to radio or television reception, which can be determined by turning the equipment off and on, the user is encouraged to try to correct the interference by one or more of the following measures:

- Reorient or relocate the receiving antenna.

- Increase the separation between the equipment and receiver.
- Connect the equipment into an outlet on a circuit different from that to which the receiver is connected.
- Consult the dealer or an experienced radio/TV technician for help.

#### RF Exposure statement:

This equipment complies with FCC radiation exposure limits set forth for an uncontrolled environment. This equipment should be installed and operated with minimum distance of 20 cm between the radiator and your body. This transmitter must not be co-located or operating in conjunction with any other antenna or transmitter.

IC: 22635-WSDCGQ11LM

#### IC NOTICE TO CANADIAN USERS

This device contains license-exempt transmitter(s)/receiver(s) that comply with Innovation, Science and Economic Development Canada's license-exempt RSS(s). Operation is subject to the following two conditions:

1. This device may not cause interference.
2. This device must accept any interference, including interference that may cause undesired operation of the device.

This Class B digital apparatus complies with Canadian ICES-003. This device complies with RSS-247 of Industry Canada. Operation is subject to the condition that this device does not cause harmful interference.

This equipment complies with IC radiation exposure limits set forth for an uncontrolled environment. This equipment should be installed and operated with minimum distance of 20 cm between the radiator and your body. This transmitter must not be co-located or operating in conjunction with any other antenna or transmitter.



## Documents / Resources

The icon shows a white, rectangular Aqara Temperature and Humidity Sensor with a small circular sensor at the top. The Aqara logo is above the sensor, and the text 'Temperature and Humidity Sensor' is below it.	<p><a href="#">Aqara 100381 Temperature and Humidity Sensor</a> [pdf] User Guide 100381, Temperature and Humidity Sensor, Humidity Sensor, Temperature Sensor</p>
--	---

## References

- [🏠 Home](#)
- [📄 CE-DOC](#)
- [🛠 Support](#)