

APS IB-006C&H iBoard Side Step Running Boards



APS IB-006C&H iBoard Side Step Running Boards Installation Guide

[Home](#) » [APS](#) » APS IB-006C&H iBoard Side Step Running Boards Installation Guide 

Contents

- [1 APS IB-006C&H iBoard Side Step Running Boards](#)
- [2 Product Information](#)
- [3 Information](#)
- [4 PART LIST](#)
- [5 Installation Instructions](#)
- [6 Documents / Resources](#)
 - [6.1 References](#)

APS

APS IB-006C&H iBoard Side Step Running Boards



Product Information

Specifications

- **Part Number:** IB-006C&H
- **Fastener Sizes:** 6mm, 8mm, 10mm, 12mm, 14mm
- **Tightening Torque (ft-lbs):** 6-7, 16-18, 31-32, 56-58, 92-94

FAQ

- **Q:** Do I need to drill during installation?
 - **A:** Drilling may be required for certain steps in the installation process. Always follow the provided instructions carefully.
- **Q:** What are the contact details for customer support?
 - **A:** For customer support, you can reach out to info@iboardauto.com.

READ INSTRUCTIONS CAREFULLY BEFORE START ING INSTALLATION. REMOVE CONTENTS FROM BOX AND VERIFY ALL PARTS ARE PRESENT. ASSISTANCE IS RECOMMENDED.

Information

*BODY FRAME MOUNT

*DRILLING MAYBE REQUIRED

Fastener Size	Tightening Torque (ft-lbs)	Required
6mm	6-7	X
8mm	16-18	√
10mm	31-32	√
12mm	56-58	√
14mm	92-94	X

PART LIST

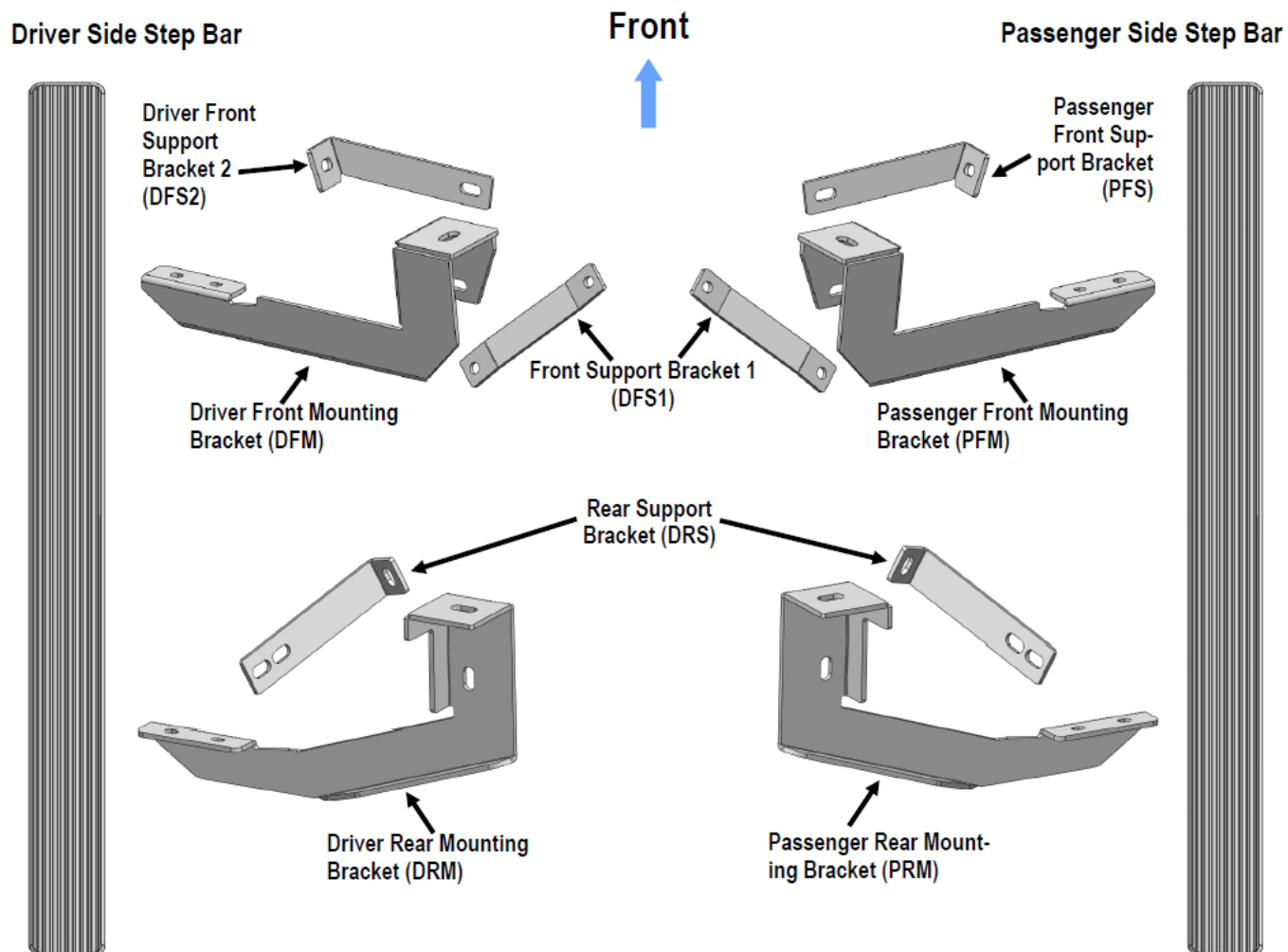

Hardware Package A (For Bracket Installation)



1#



2#



3#



4#



5#



6#



7#



8#



9#



10#

Item	QTY	Description	Item	QTY	Description
1#	4	Spacer Plates	6#	4	M12 Lock Washers
2#	4	M10X40 Bolt Plates	7#	6	M10X1.5-30mm Hex Bolts
3#	4	M10 Plastic Washers	8#	16	M10 Large Flat Washers
4#	4	M12X1.75-120mm Hex Bolts	9#	10	M10 Lock Washers
5#	4	M12 Large Flat Washers	10#	10	M10 Hex Nuts

Hardware Package B (For Stainless Steel Step Bar Installation)



1 #



2 #



3 #



4 #

Item	QTY	Description	Item	QTY	Description
1#	8	M8X1.25-35mm Carriage Bolts	3#	8	M8 Nylon Lock Nuts
2#	8	M8 Large Flat Washers	4#	4	Sliders (Packed with Step Bars)

Installation Instructions

STEP 1

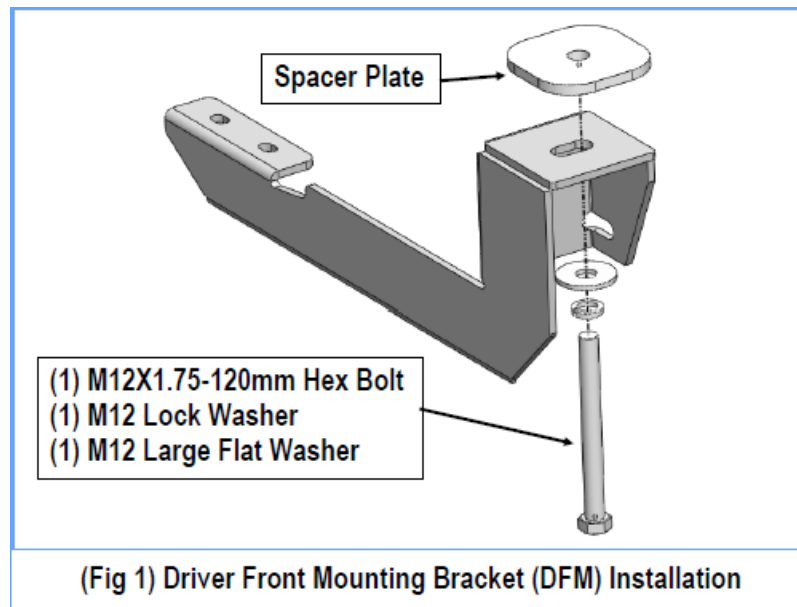

- Start installation from the driver side front of the vehicle. Remove the factory body mount bolt. The rubber bushing will be reused. Select (1) Driver Front Mounting Bracket (DFM), install with (1) Spacer Plate, (1) M12X1.75-120mm Hex Bolt, (1) M12 Large Flat Washer and (1) M12 Lock Washer, (Fig 1). Do not fully tighten hardware at this time.
 - **Note:** Put the spacer Plate between the Mounting Bracket and the factory rubber bushing.

STEP 2

Next, select the correct Front Support Bracket for your application. 2002-2005 Models:

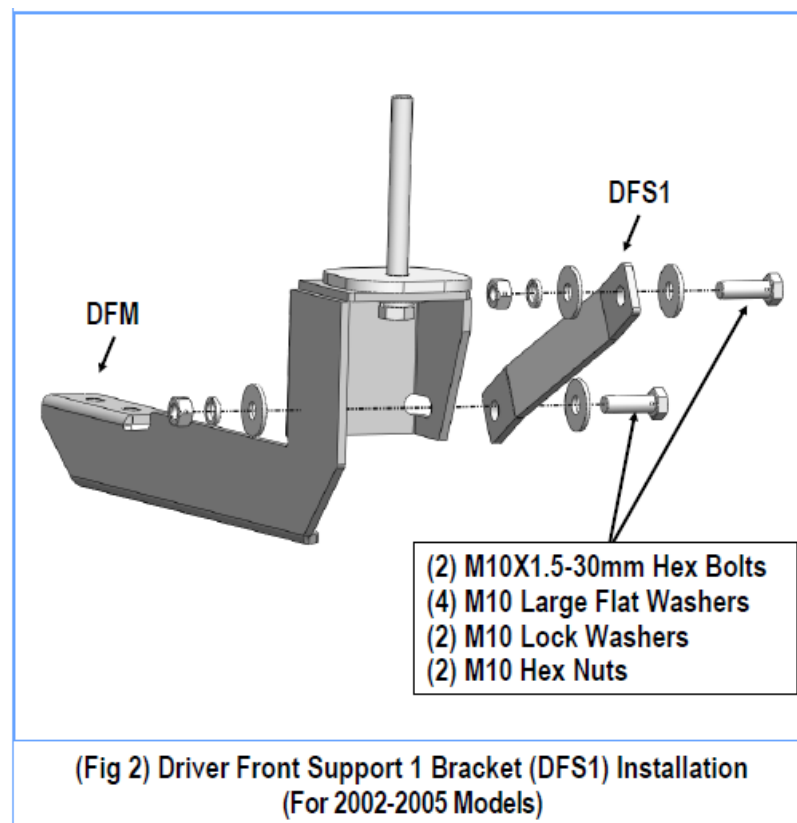

- Select the Driver Front Support Bracket 1 (DFS1) with the straight 2 -hole. Attach one end to the Driver Front Mounting Bracket (DFM) with (1) M10X1.5-30mm Hex Bolt, (2) M10 Large Flat Washers, (1) M10 Lock Washer

and (1) M10 Hex Nut, (Fig 2). Do not fully tighten hardware at this time.

- Line up the other end of the support bracket with the hole on the factory body mount bracket. Bolt the Support Bracket to the body mount bracket with (1) M10X1.5-30mm Hex Bolt, (2) M10 Large Flat Washers, (1) M10 Lock Washer and (1) M10 Hex Nut, (Fig 2). Do not fully tighten hardware at this time.
 - **NOTE:** Some models may require to drill a mounting hole on the factory body mount bracket if not equipped.
 - **IMPORTANT!** Any cutting or drilling tool may break or shatter. Government regulations require safety glasses & equipment at all times when cutting or drilling.

2006-2008 Models:

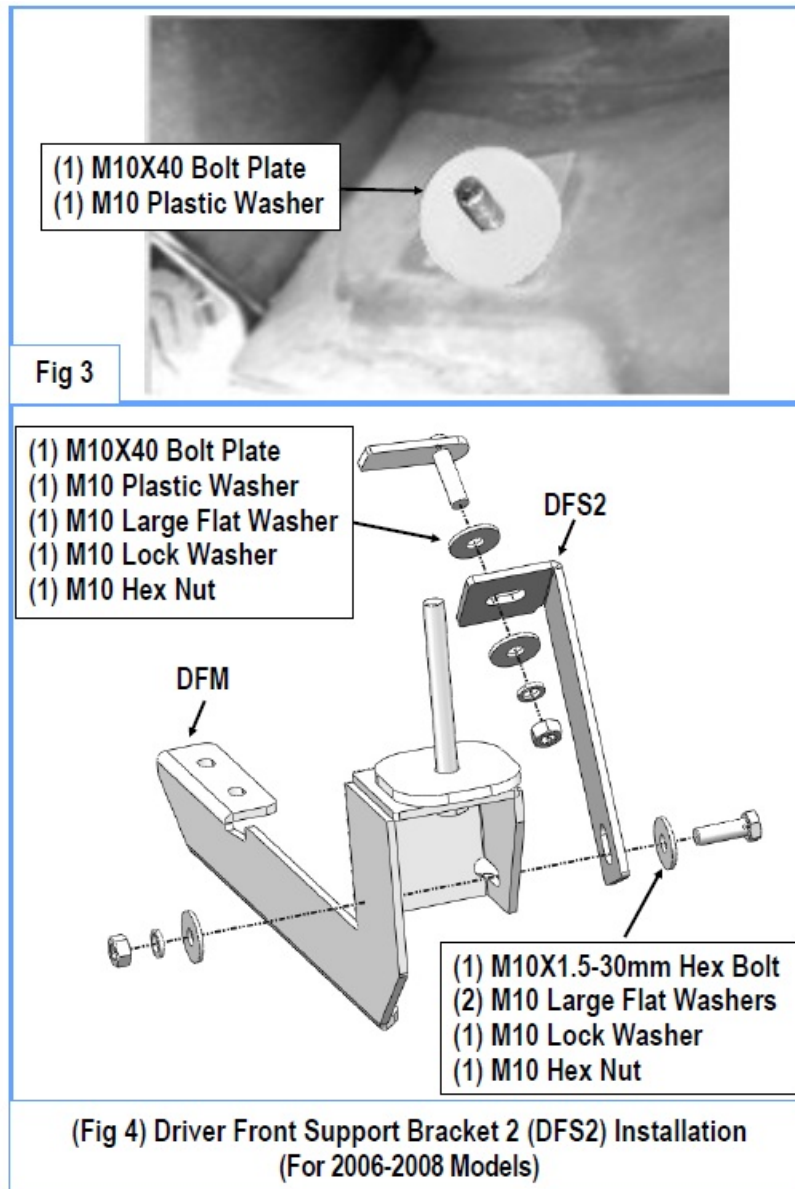

Select the Driver Front Support Bracket 2 (DFS2). Remove the sealing tape on the mounting location on the body panel. Partially thread (1) M10 Plastic Washer onto (1) M10X40 Bolt Plate. Insert the M10 Bolt Plate into the mounting hole and thread the M10 Plastic Washer down against the body panel to hold the bolt plate in place, (Fig 3). NOTE: The M10 Plastic Washer is designed to prevent the M10 Bolt Plate from falling into the body cavity within bracket installation.

Secure the short end of Support Bracket 2 to the installed M10 Bolt Plate with (1) M10 Large Flat Washer, (1) M10 Lock Washer and (1) M10 Hex Nut. Attach the long end of the Support Bracket to the Mounting Bracket with (1)

M10X1.5-30mm Hex Bolt, (2) M10 Large Flat Washers, (1) M10 Lock Washer and (1) M10 Hex Nut, (Fig 4). Do not fully tighten hardware at this time.

STEP 3

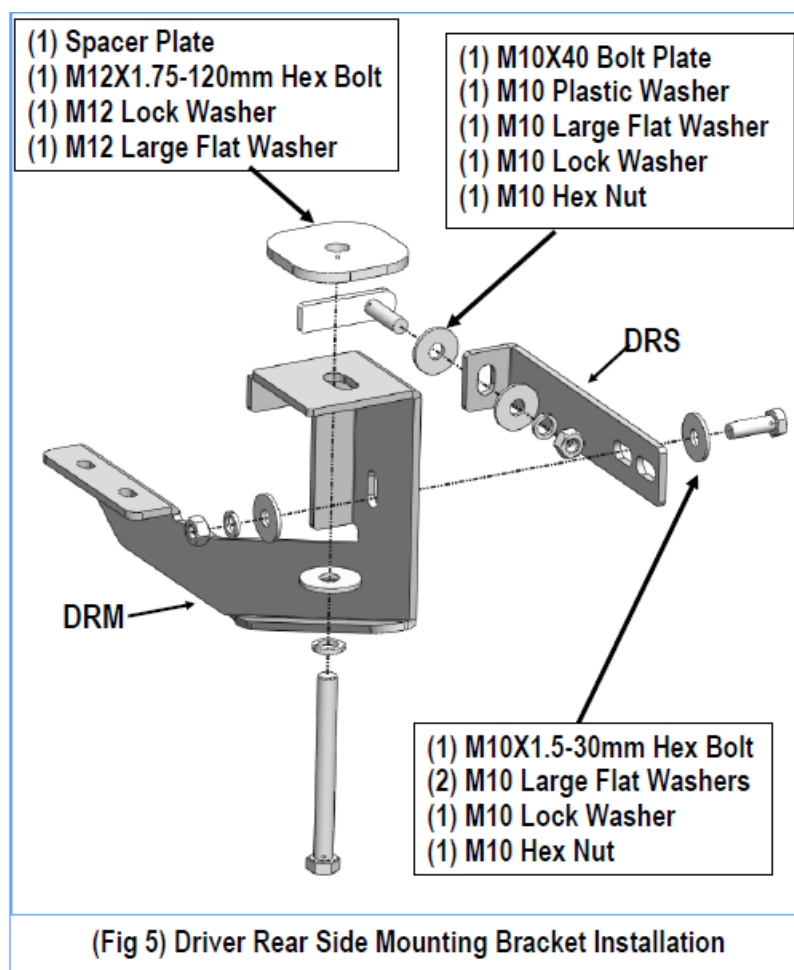

- Move to Driver Side Rear Mounting Location. Repeat Step 2 for the Driver Rear Mounting Bracket (DRM) installation, (Fig 5).
- Next, select the Driver Rear Support Bracket (DRS), (90- degree bend on one end). Remove the sealing tape on the inner body panel to uncover the mounting location. Partially thread (1) M10 Plastic Washer onto (1) M10X40 Bolt Plate.
- Insert the M10 Bolt Plate into the mounting hole and thread the M10 Plastic Washer down until it is flush against the body panel, (Fig 5).
- Secure the Support Bracket to the M10 Bolt Plate with (1) M10 Flat Washer, (1) M10 Lock Washer and (1) M10 Hex Nut. Attach the Support Bracket to the front-facing side of the Mounting Bracket with (1) M10X1.5-30mm Hex Bolt, (2) M10 Large Flat Washers, (1) M10 Lock Washer and (1) M10 Hex Nut, (Fig 5). Do not fully tighten hardware at this time.
- **NOTE:** The Driver Rear Support Bracket is not required on the Regular Cab models.

STEP 4

Once all (2) Driver side mounting brackets are installed, then proceed to the Step Bar installation. (Figs 6 & 7)

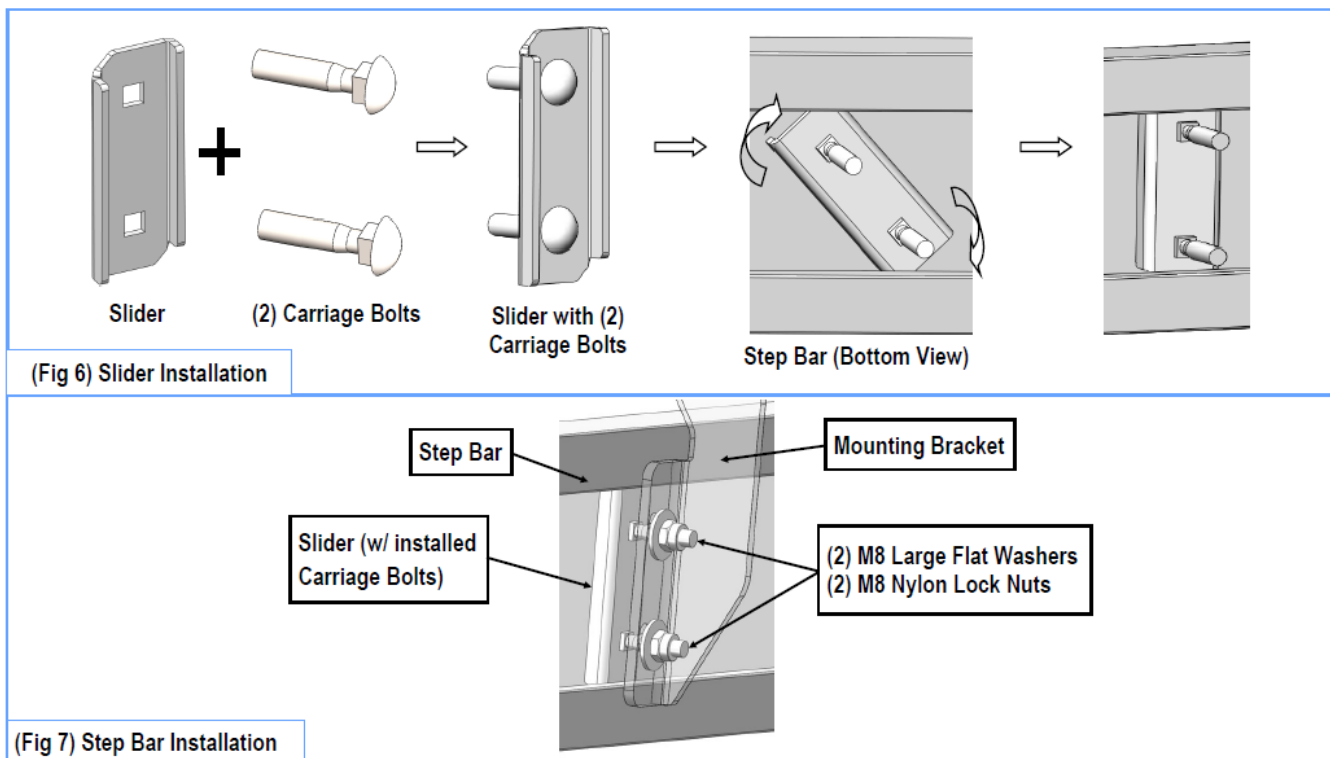

1. Select (1) Slider and (2) M8X1.25-35mm Carriage Bolts;
2. Install (2) M8X1.25-35mm Carriage Bolts in (1) Slider.
3. Slide the Slider (with carriage bolts) to the Step Bar.
4. Repeat to install the other (1) slider to the step bar.
5. Attach the Step Bar (with the Sliders) onto the installed mounting brackets. Position the Sliders to the installed brackets. Secure the Step Bar to the installed Brackets by using (4) M8 Large Flat Washers and (4) M8 Nylon Lock Nuts and (2) Sliders, (Fig 7). Do not fully tighten hardware at this time.

Note: The Sliders are packed with the Step Bars.

Level and adjust the Step Bar and fully tighten all hardware.

Repeat Steps 1-4 for the other side Step Bar installation. The installation is completed!!!

Attention

- Do periodic inspections to the installation to make sure that all hardware is secure and tight.
- In order to protect your bars/boards, please use mild soap/non-abrasive products for cleaning only.

Customer Support: info@iboardauto.com

Scan for Installation Video



Documents / Resources

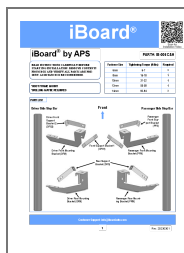

[APS IB-006C&H iBoard Side Step Running Boards](#) [pdf] Installation Guide
IB-006C H iBoard Side Step Running Boards, IB-006C H, iBoard Side Step Running Boards, Side Step Running Boards, Step Running Boards, Running Boards, Boards

References

- [User Manual](#)

Manuals+, Privacy Policy

This website is an independent publication and is neither affiliated with nor endorsed by any of the trademark owners. The "Bluetooth®" word mark and logos are registered trademarks owned by Bluetooth SIG, Inc. The "Wi-Fi®" word mark and logos are registered trademarks owned by the Wi-Fi Alliance. Any use of these marks on this website does not imply any affiliation with or endorsement.