



Apps MiniMed Mobile App User Guide

[Home](#) » [APPs](#) » Apps MiniMed Mobile App User Guide 

Medtronic

MiniMed Mobile App User Guide



Contents

- [1 Setting up & using the MiniMed™ mobile app](#)
- [2 Home Screen View](#)
- [3 Documents / Resources](#)
- [4 Related Posts](#)

Setting up & using the MiniMed™ mobile app

1. Check the Compatibility Chart found on your local website FAQ.
2. Download the MiniMed™ Mobile app on the Apple® or Google Play™ app store.

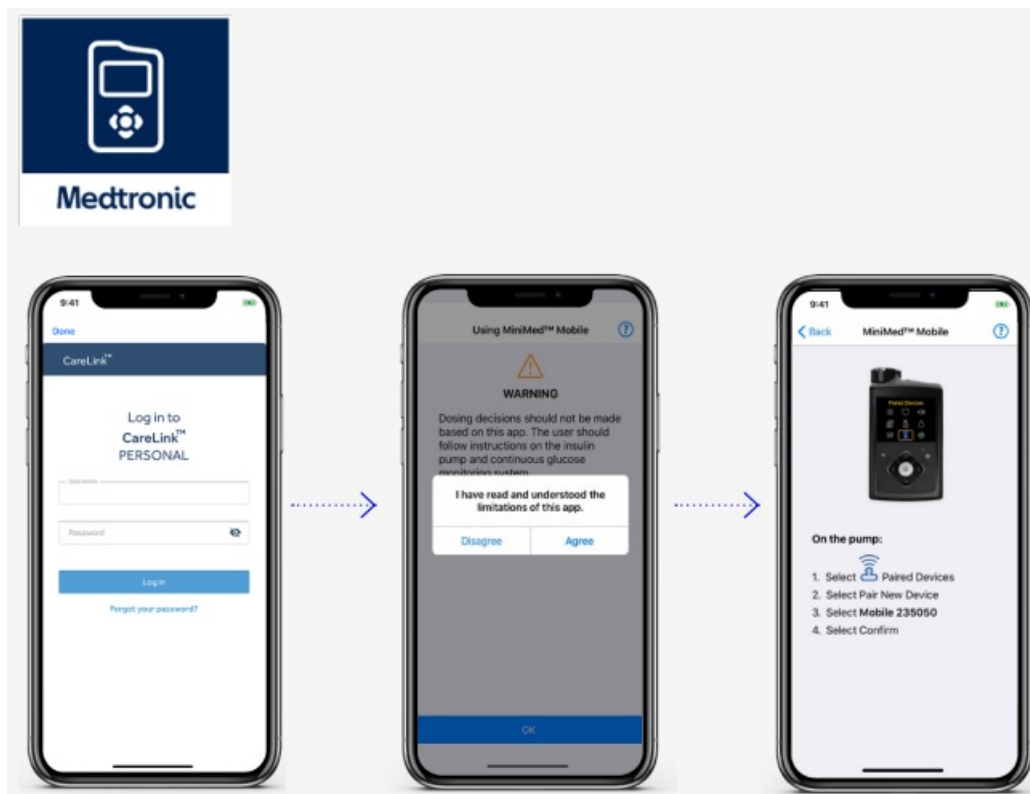

Important – We recommend turning off your Operating system auto-updates to help ensure that you won't be using an unverified version of the app.

3. Follow the On Screen prompts.
4. Create or sign into your CareLink™ Personal Account.
5. Tap Agree to proceed through the end-user agreements and consent.
6. Pair the App with your Pump
7. Read the Dosing Disclaimer that states dosing decisions should not be made based on the app then tap agree.
8. For Automatic Syncing with CareLink™ to allow automatic uploads and sharing with care partners, click on the menu icon and ensure 'sync to CareLink™' is active.

The app is now ready to use.

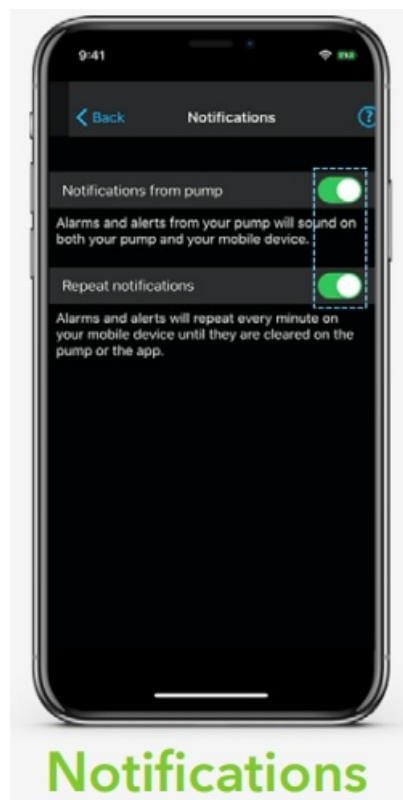

Notifications need to be on to receive alerts, alarms, messages and reminders. They will show as banners.



RED – Alarm
 ORANGE – Alert
 GREY – Reminder
 BLUE – Messages



App users using a pump and sensor can swipe left to access time in range (TIR) data and graphs for the last 24 hours.

Home Screen View

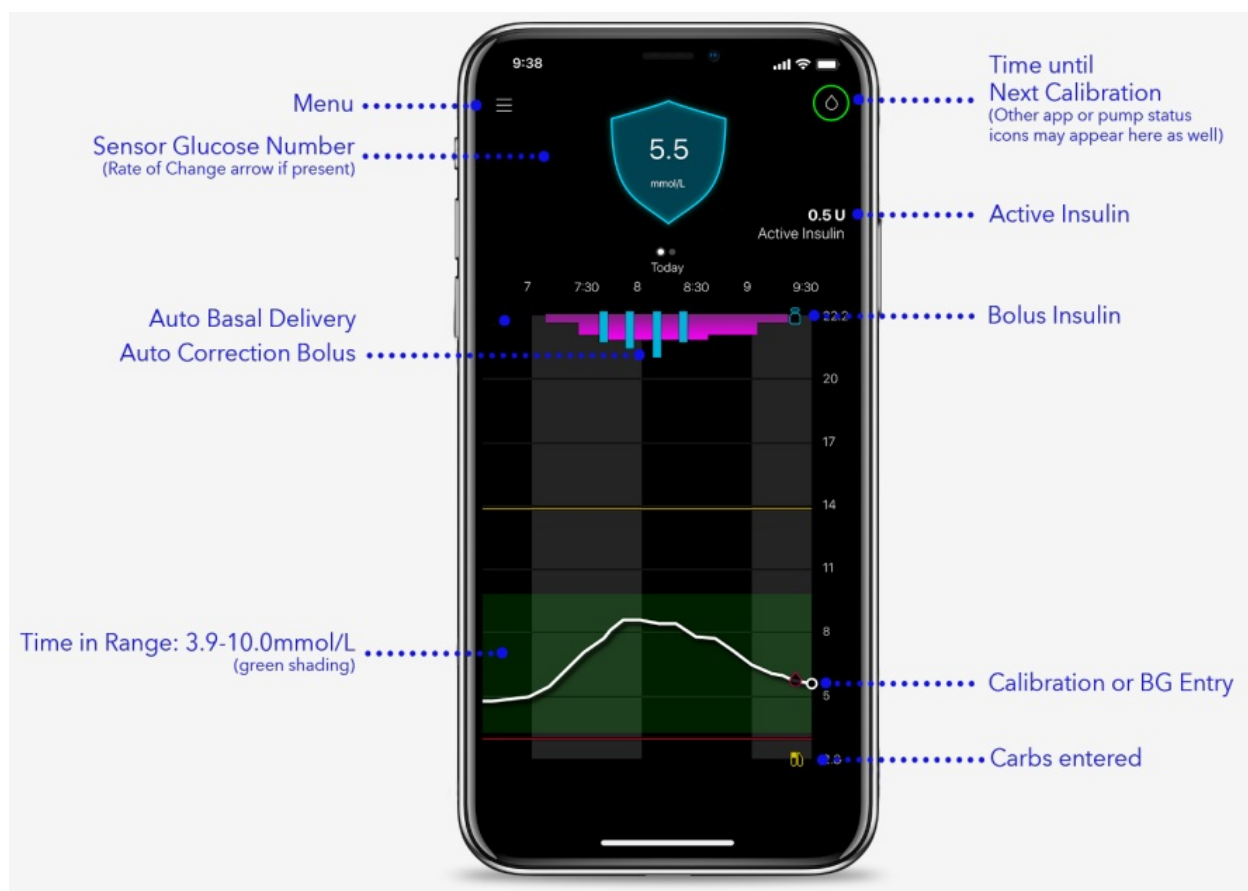

Personalized diabetes insights anytime, anywhere.

Always read the instructions for use.

For detailed information regarding the instructions for use, indications, contraindications, warnings, precautions,

and potential adverse events, please consult the device manually. For further information, contact your local Medtronic representative. © 2021 Medtronic Australasia Pty Ltd. All Rights Reserved. Please note: In contacting Diabetes Toll-Free, your personal and health information may be disclosed to an operator located outside Australia. 10230-102021



Medtronic Australasia Pty Ltd

2 Alma Road

Macquarie Park, NSW 2113, Australia

Tel: +61 2 9857 9000

Fax: +61 2 9889 5167

Toll-Free: 1800 777 808

E-Mail: australia.diabetes@medtronic.com

Facebook: www.facebook.com/MedtronicDiabetesAUS

YouTube: Medtronic Diabetes ANZ <https://www.medtronic-diabetes.com.au/>

Documents / Resources



[Apps MiniMed Mobile App](#) [pdf] User Guide

MiniMed Mobile App