



**Plus5E Series 2000VA  
Integrated with  
Microprocessor Controller**



# APlus Plus5E Series 2000VA Integrated with Microprocessor Controller User Manual

[Home](#) » [APlus](#) » APlus Plus5E Series 2000VA Integrated with Microprocessor Controller User Manual 

## Contents

- [1 APlus Plus5E Series 2000VA Integrated with Microprocessor Controller](#)
- [2 INTRODUCTION](#)
- [3 OVERVIEW](#)
- [4 OPERATION](#)
- [5 BATTERY CHARGING AND STORAGE](#)
- [6 INDICATION TABLE](#)
- [7 CHANGE BATTERY](#)
- [8 TROUBLESHOOTING](#)
- [9 SPECIFICATION](#)
- [10 Documents / Resources](#)
  - [10.1 References](#)
- [11 Related Posts](#)



**APlus Plus5E Series 2000VA Integrated with Microprocessor Controller**



## INTRODUCTION

### System Description

- The Product is line interactive UPS provides guaranteed battery backup power during outages and unsafe fluctuation, along with full protection from damaging surges and spikes.
- The UPS is integrated with a microprocessor controller, voltage stabilizer, and LED or LCD indicators in a stand-alone unit, to provide the perfect protection to safeguard your critical devices and valued data.

### Features

- Equipped with 2-Steps Boost & 1-Step Buck AVR to provide stable utility voltage.
- Off-mode charging enables UPS to charge itself even power switch is OFF.
- Built-in CC/CV battery charger and battery over-drain protection.
- DC start function enables UPS to start without AC power supplied.
- Provide lightning, surge, overload, and short circuit protection.
- Line interactive design with microprocessor controlled.
- Battery easy replacement design (Optional).
- 5VDC USB Charging Port (Optional).
- Auto restart upon AC recovery.

### CAUTION

- The UPS contains potentially hazardous electricity. Qualified or certified technicians should proceed with all repairs, maintenance, and installation.
- The UPS has its internal energy source (battery). The output receptacles may be active even when the UPS is not connected to an AC supply.
- The UPS is suitable for computers and electronic equipment with linear loads, but not suitable for electronic equipment with non-linear loads, such as motors & fluorescent lamps.
- Be sure to operate within the power rating of the UPS. Below 1/2 or 1/3 of the rated power is recommended for longer backup time.

- ## OVERVIEW

1. Power Switch: ON/OFF or Silence button
2. On-line LED
3. Back-up LED
4. Cut-off LED

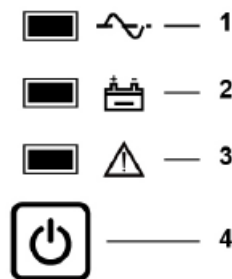

1. Power Switch: ON/OFF or Silence button
2. LCD screen

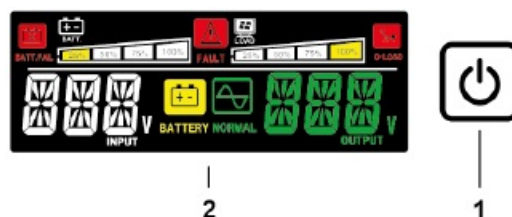

1. AC input line cord
2. AC circuit breaker
3. Backup/AVR/surge protection outlet
4. Surge protection outlet
5. Tel/Line/Modem surge protection RJ-45 or RJ-11 port (Optional)
6. Smart USB communication port (Optional)

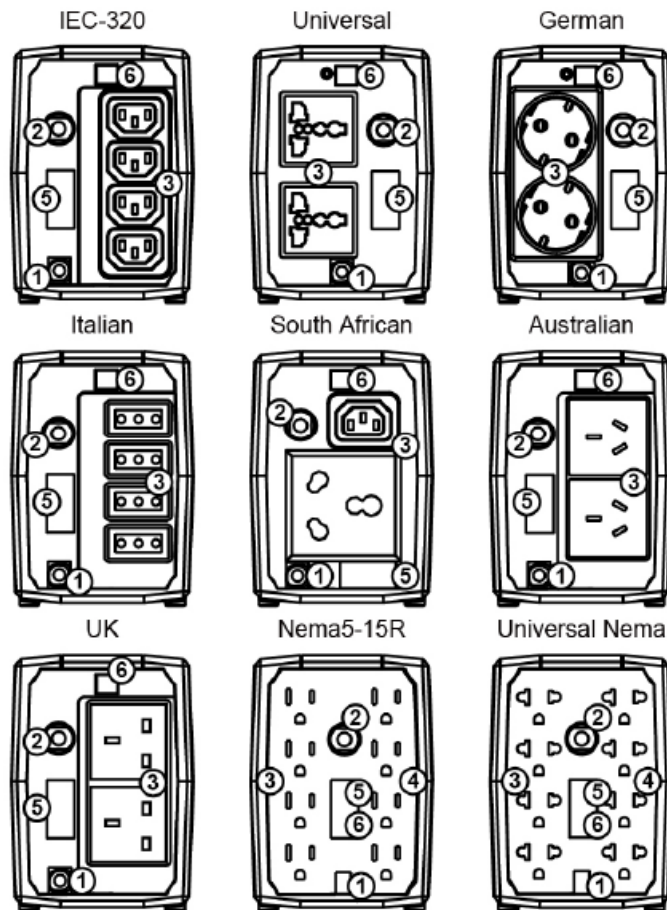

## OPERATION

### Turn On/Off the Unit

- Turn on the UPS unit in AC mode by pressing the power switch for 1 second.
- Turn off the UPS unit on AC mode by pressing the power switch for 4 seconds.

### Connect to Utility and Charging

- When the UPS is connected to AC power and the power switch is on, the UPS will charge the battery automatically.
- The UPS is designed with the function of OFF-Mode Charging, so UPS will charge the battery continuously when the power switch is off and AC power is supplied. To power off UPS completely on OFF mode, please remove the input of AC power.

### DC Start

- Turn on the UPS unit on Battery mode by pressing the power switch for 1 second.
- Turn off the UPS unit on Battery mode by pressing the power switch for 4 seconds, and UPS will be completely turned off in 10 seconds.
- Wait another 10 seconds to press the power switch for 1 second if you want to turn on the UPS again.

### Buzzer

- The buzzer will beep when UPS is in Battery mode or having fault situations.
- Mute the buzzer by pressing the power switch once. Restart the Buzzer by pressing the power switch once again.

## BATTERY CHARGING AND STORAGE

- The UPS is shipping from the Factory with an internal full-charged battery, but battery power might be lost during the transportation.
- So please plug in the AC input line cord to the wall outlet. For the best result, charge the battery for at least 10 hours before initial use.

Storage Temperature	Recharge Period	Charging Duration
-15°C to 30°C (5°F to 86°F)	Every 6 Months	10 Hours
30°C to 45°C (86°F to 113°F)	Every Month	10 Hours

## INDICATION TABLE

### LED Model

- Battery Mode

Status	Back-up LED (Yellow)	On-line LED (Green)	Cut-off LED (Red)	Buzzer
Battery normal & Load normal	LED is ON when UPS is on Battery mode; LED flash twice every 4 seconds when battery and load are normal	LED is OFF	Depends on fault condition	Beeps twice every 8 seconds
Battery low voltage	LED flash 4 times every second			Beeps 4 times every second

### AC Mode

Status	Back-up LED (Yellow)	On-line LED (Green)	Cut-off LED (Red)	Buzzer
Battery fully charged	LED is OFF	LED is ON	Depends on fault condition	Buzzer is OFF
Battery 70-90% charged		LED flash once every 8 seconds		
Battery 50-70% charged		LED flash once every 4 seconds		
Battery 30-50% charged		LED flash once every 2 seconds		
Battery 0-30% charged		LED flash once every second		

## OFF Mode

Status	Back-up LED (Yellow)	On-line LED (Green)	Cut-off LED (Red)	Buzzer
AC input disconnected	LED is OFF	LED is OFF	LED is OFF	Buzzer is OFF
AC input normal: Battery is in charging		LED flash once every 2 seconds	Depends on fault condition	
AC input normal: Battery is fully charged		LED is OFF		
UPS working schedule: Set via Smart USB port	LED flash once every 2 seconds	Refer to On-line LED (Green) of AC mode	LED is OFF	

## Fault

Status	Back-up LED (Yellow)	On-line LED (Green)	Cut-off LED (Red)	Buzzer
Over temperature	Depends on AC input or load condition		LED is OFF	Rapid beeping
Overload			LED flash twice every second	Constant tone
Output short circuit			LED is ON	Rapid beeping

## LCD Model

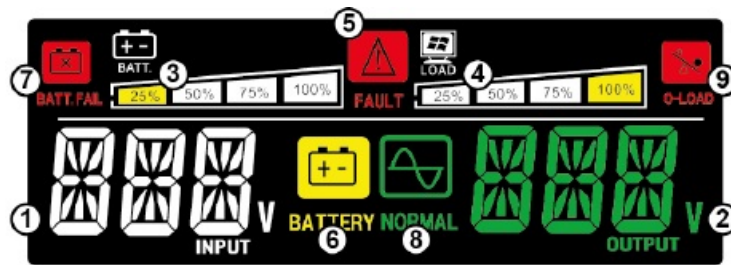

	Indicators	Description
1	Input Voltage	Indicate input line voltage.
2	Output Voltage	Indicate output voltage.
3	Battery Capacity	Indicate estimated battery capacity. The accuracy will be influenced by UPS operation mode and load capacity.
4	Load Capacity	Indicate load level, the percentage of UPS full load.
5	Fault Icon	Icon is ON when UPS is fault. Buzzer beeps constantly or rapidly.
6	Battery Icon	Icon is ON when AC power is abnormal and UPS is on Battery mode. Buzzer beeps twice every 8 seconds when battery and load are normal. Buzzer beeps 4 times every second when battery low voltage.
7	Battery Fail Icon	Icon is ON when UPS battery is abnormal.
8	Normal Icon	Icon is ON when UPS is normal.
9	Overload Icon	Icon is ON when UPS is overload. Buzzer makes constant tone.

## CHANGE BATTERY

### CHANGE BATTERY(OPTIONAL)

**Note:** Small sparks may occur during battery connection, this is normal.

1. Turn the UPS over, and slide the battery compartment cover off the battery housing.
2. LIFT the battery out of the compartment, and disconnect wires from battery positive ( + ) and negative ( - ) terminals. Get a new battery and make sure to re-connect wires to positive and negative terminals correctly.
3. Align all arrow marks and slide the battery compartment cover back onto the battery housing. Double-check if the battery compartment is well-locked.

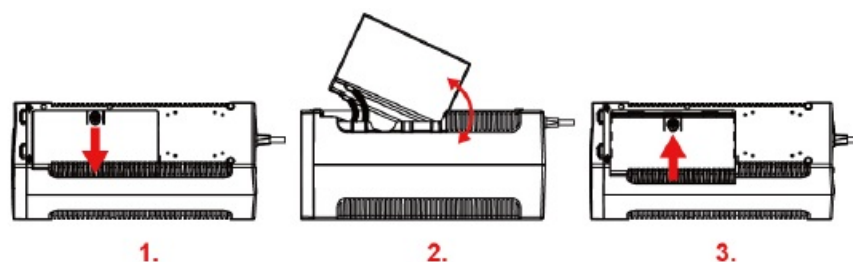

## TROUBLESHOOTING

Check UPS with the below steps when you face a UPS failure problem:

- Is the power switch of the UPS turned on?
- Is UPS plugged into a working wall outlet?
- Is line voltage within the rating specified?
- Is the circuit breaker on the UPS back panel active?
- Is UPS overloaded?
- Is the UPS battery not fully charged?

Use the table below to solve the UPS operation problems. If the problems cannot be resolved, please provide the model name, serial number, date of purchase, date the problem occurred, and full description of the problem including load status, UPS LED or LCD status, UPS buzzer status, and installation environment. .. etc. when calling for service.

Problem	Probable Cause	Solution
UPS will not turn on and LED or LCD is not ON	Battery voltage is less than 10VDC	Charge the UPS at least 5 hours
	PCB is failure	Call for service to replace the PCB
UPS is always on Battery Mode	Power cord is loose	Reconnect the power cord properly
	Circuit breaker is tripped	Reset the circuit breaker on the UPS back panel
	PCB is failure	Call for service to replace the PCB
Backup time is shortening	Battery is not fully charged	Charge the UPS at least 5 hours
	Battery defect	Replace the battery with same type of battery
Buzzer continuously beeping when AC is normal	UPS is overloaded	Remove some loads first. Make sure the equipment plugged in to the UPS is not overloading the capacity of UPS

## SPECIFICATION

### INPUT

Voltage	110/115/120VAC or 220/230/240VAC
Voltage Range	-30%, +25%
Frequency	50/60Hz (Auto-sensing)

### OUTPUT



Capacity	Label specified
Voltage Regulation	+/-10%
(Battery Mode)	
Frequency	50/60Hz +/-1Hz
Waveform	Simulated sinewave
Transfer Time	<6ms (Typical)

## BATTERY

Voltage	12VDC
Recharge Time	5 hours to 90% after fully discharged
Safety Protection	Over charge and over discharge protection
Advance Battery Management	Yes

## INDICATORS

LED Model	AC normal(Green), Backup(Yellow), UPS Cut-off(Red)
LCD Model	Programmed LCD
Alarm	Buzzer ON for battery mode, low battery, overload, fault

## PROTECTION

Short circuit	Line Mode: AC breaker and electronic circuit ; Battery Mode: electronic circuit
Over-temperature	Thermal switch
Over/Under Voltage	Yes
Surge Protection	175 Joules

## SAFETY/REGULATORY

Safety Approvals	EN 62040-1
EMC Compliance	EN 62040-2

## PHYSICAL

Operating Temperature	0°C to 40°C (5°F to 104°F)
Related Humidity	0 to 95% (Non-condensing)
Audible Noise	<40dB at 1M
Dimension(D*W*H)	315.5*100*141mm

Product specifications are subject to change without further notice.

This manual provides safety, installation, and operation instructions that will guide you to the best performance of your equipment. Please read and keep this manual.

APLUS® is a trademark of APLUS POWER CORP. and is manufactured under its authority.

All designs and contents are subject to changes without prior notice. ©Copyright 2025 APLUS® all rights reserved.

## Documents / Resources

	<p><a href="#">APlus Plus5E Series 2000VA Integrated with Microprocessor Controller</a> [pdf] User Manual Plus5E Series, Plus5E Series 2000VA Integrated with Microprocessor Controller, 2000VA Integrated with Microprocessor Controller, Integrated with Microprocessor Controller, Microprocessor Controller, Controller</p>
---	---

## References

- [User Manual](#)

### [Manuals+](#). [Privacy Policy](#)

This website is an independent publication and is neither affiliated with nor endorsed by any of the trademark owners. The "Bluetooth®" word mark and logos are registered trademarks owned by Bluetooth SIG, Inc. The "Wi-Fi®" word mark and logos are registered trademarks owned by the Wi-Fi Alliance. Any use of these marks on this website does not imply any affiliation with or endorsement.