



APC PBS-KW Wireless Push Button User Manual

[Home](#) » [APC](#) » APC PBS-KW Wireless Push Button User Manual 

APC PBS-KW Wireless Push Button User Manual



Wireless Push Button Pairing Procedure

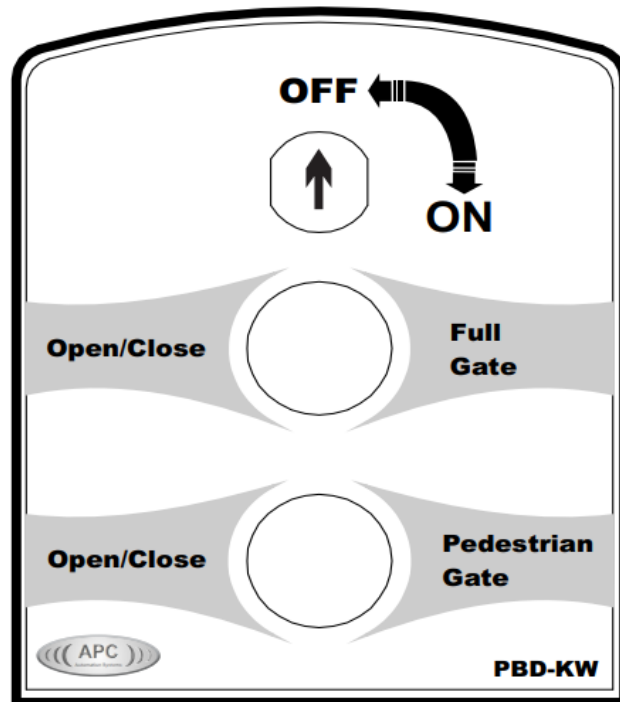
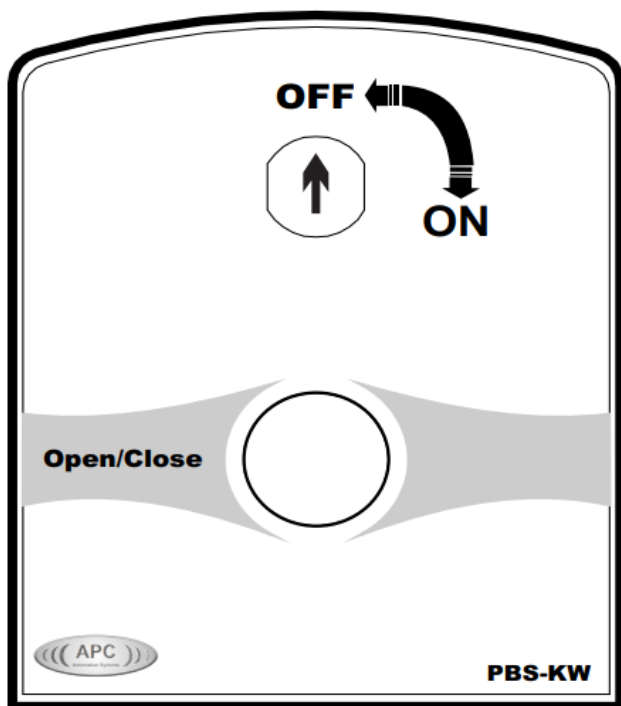

Contents

- [1 Specifications](#)
- [2 Setting your push button feature](#)
- [3 Control Board Identification](#)
- [4 Pairing Procedure](#)
- [5 Swing Gate Systems](#)
 - [5.1 Pairing](#)
- [6 Swing Gate Systems](#)
- [7 Sliding Gate Systems](#)
- [8 Sliding Gate Systems](#)
- [9 Documents / Resources](#)
- [10 Related Posts](#)

Specifications

- **Over 50m Operating Range**
- Robust ABS Plastic Design
- Powered by 23A 12V Battery
- Configurable Function
- ON/OFF Lockout Key Switch
- IP Rating 64
- 0 mA Standby / 16m A Working Consumption

Setting your push button feature

STEP 1

PBD-KW

(Double Push Button Switch)

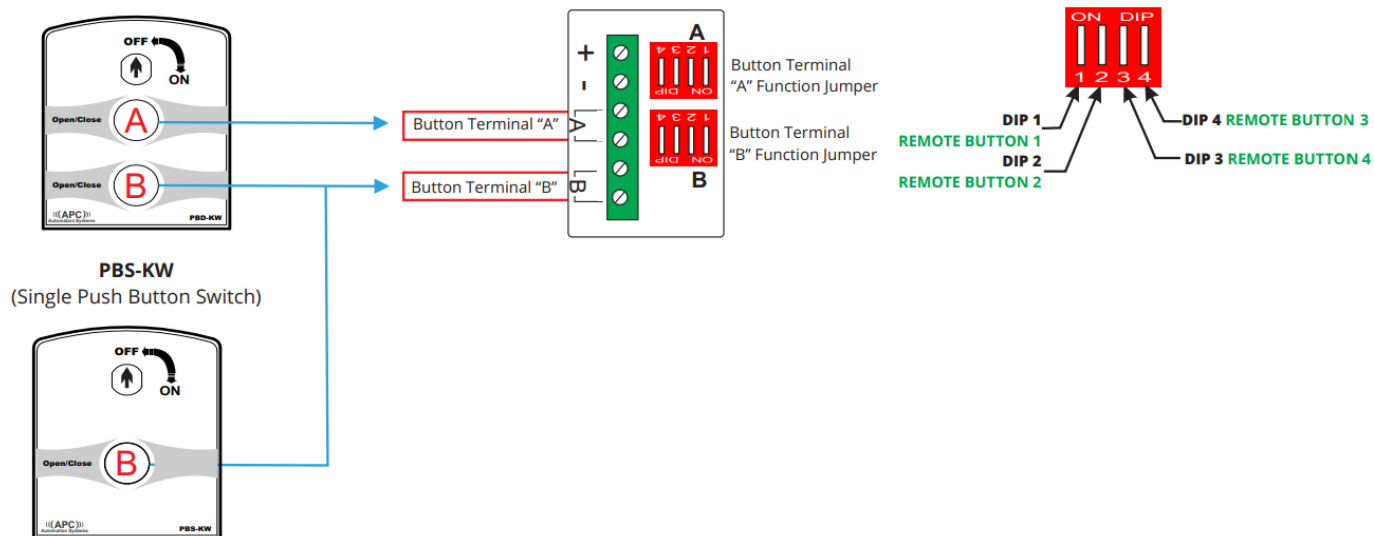

Using the DIP switch associated with the button in use (see linked diagrams on the left). You can adjust your DIP switch to enable it to toggle a specific feature.

Simply turn the respective DIP switch to the ON position that relates to the button on your remote control.

Example: If the remote number 2 button operates the gate partially set the number 2 DIP switch to the on position for the same feature.

Note: ONLY one feature per DIP Switch can be enabled

Control Board Identification

STEP 2

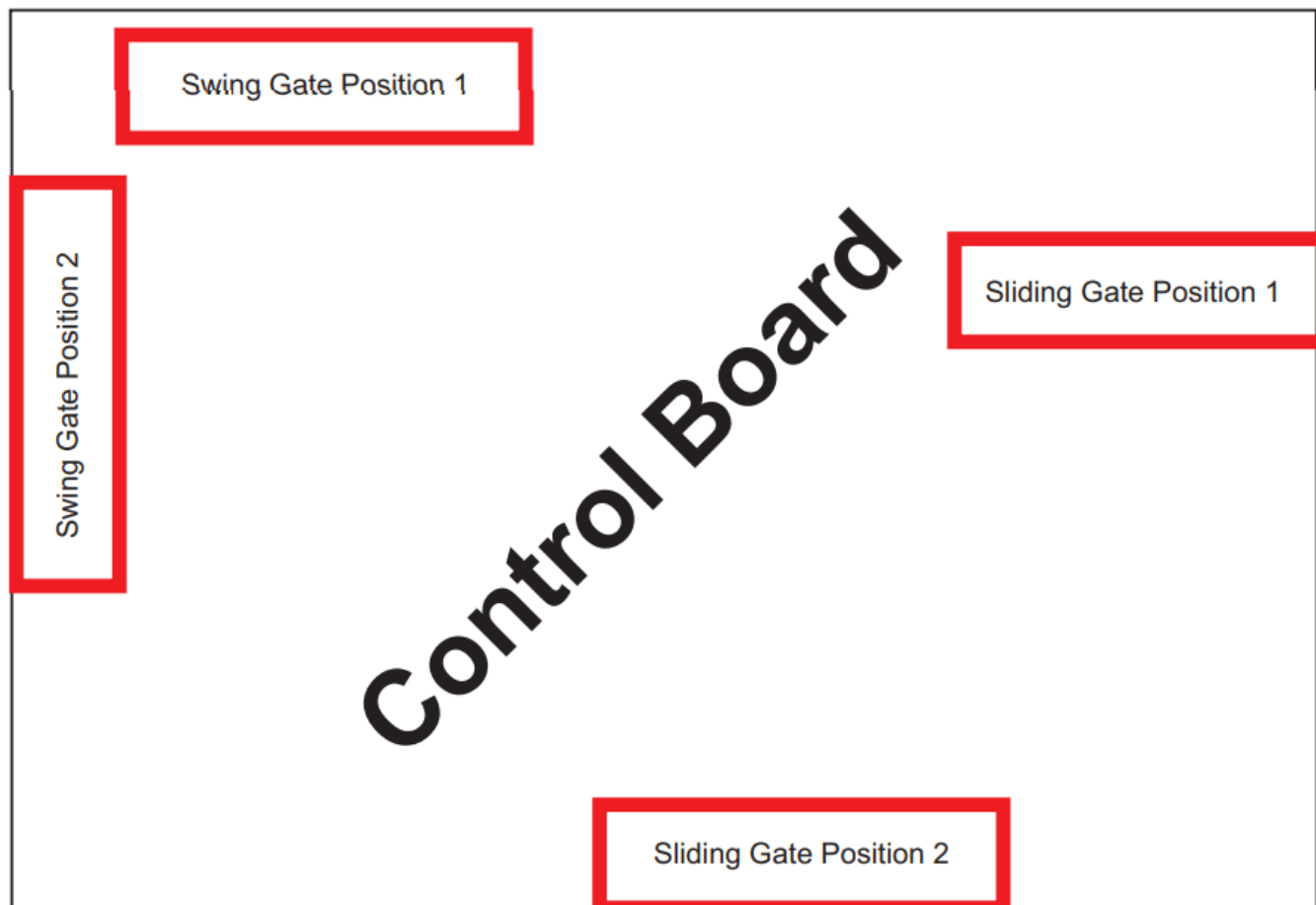

Pairing Procedure

STEP 3

Use the relevant instruction set located on one of the following pages to pair your wireless push button.

Swing Gate Systems

Pairing

- Press the small REMOTE button once on the circuit board and the LED Indicator will start to flash.
- Press any of the buttons on the wireless push button for ONE second (ensuring the key is in the ON position)

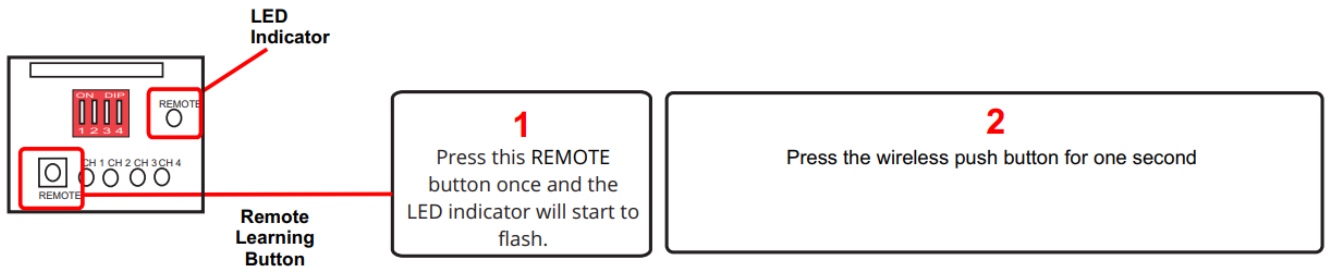

Deleting

- Press and hold the REMOTE button on the control board until the LED indicator is on solid then release the REMOTE button.

WARNING: This will delete all wireless equipment from the system.

Pairing

1. Press the LEARN CH button once for the channel group you wish to pair the remote too. (CH1/2 OR CH3/4).
2. Cycle to the desired channel by pressing the LEARN CH button.
(The control panel indicates which channel you are on by flashing the channel's LED)
3. Press any of the buttons on the wireless push button for ONE second (ensuring the key is in the ON Position)

Repeat the above process for any additional remote's or wireless buttons that require programming.

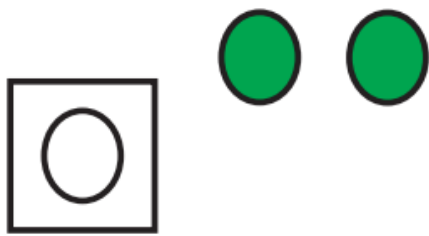

Learn CH1/CH2

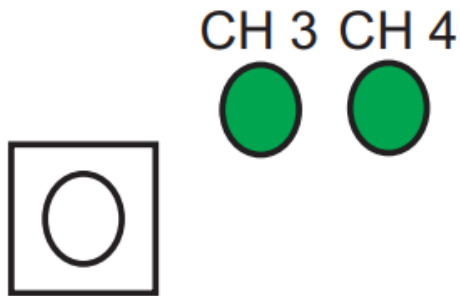

Learn CH3/CH4

CH 1 Double Gate Opening
CH 2 Single Gate Opening
CH 3 Party Mode
(Cancel Auto Close for one cycle)
CH 4 Pedestrian Gate Unlock (Lock 2)

Deleting

1. PRESS AND HOLD the LEARN CH button for the channel group you wish to delete until the channel groups LED's begin flashing simultaneously.
2. Release the LEARN CH button and wait for the LED's to stop flashing.
3. If the LED's Simultaneously flashed 3 times then stopped you have successfully deleted the remote's and/or buttons from this channel group.

WARNING: This will delete all wireless equipment from the system.

Pairing

1. Press SELECT button two/three times until cycled to the Learn Remote D-Gate (Double gates) or Learn Remote S-Gate (Single gates) LED.
2. Press any of the buttons on the wireless push button for ONE second (ensuring the key is in the ON position)

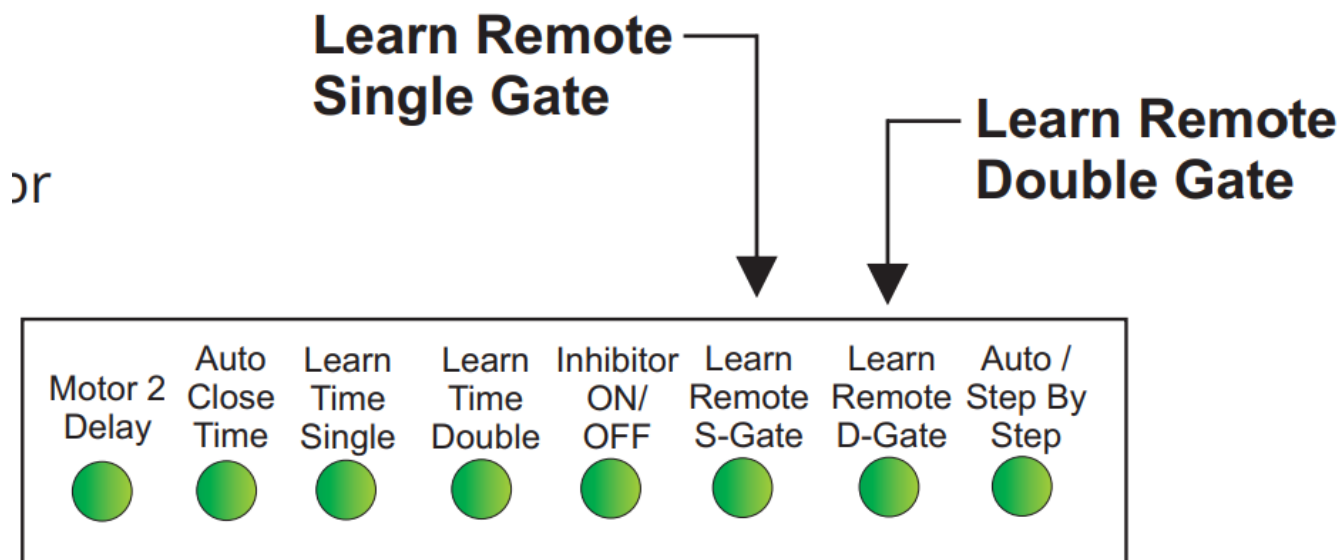

Deleting

1. Press SELECT button two/three time until cycled to the Learn Remote D-Gate (Double gates) or Learn Remote S-Gate (Single gates) LED
2. Press SET button to clear the memory

WARNING: This will delete all wireless equipment from the system.

Swing Gate Systems

Pairing

- Press the button on the receiver once and the LED Indicator will start to flash.
- Press any of the buttons on the wireless push button for ONE second (ensuring the key is in the ON position)

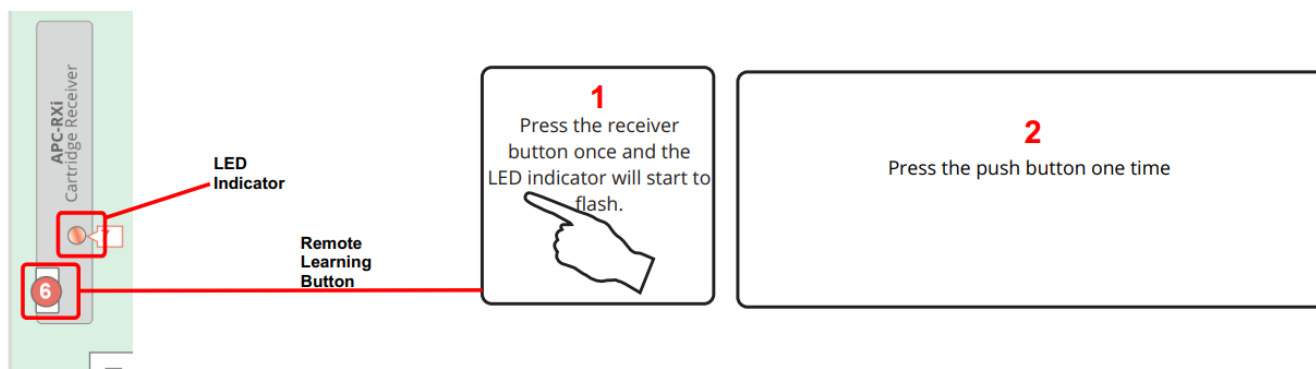

Deleting

- Turn off system power
- HOLD the button on the receiver whilst powering the system ON
- The LED's will blink FOUR times to indicate the process is complete, now the button can be released.

WARNING: This will delete all wireless equipment from the system.

Sliding Gate Systems

Pairing

- Press the small REMOTE button once on the circuit board and the LED Indicator will start to flash.
- Press any of the buttons on the wireless push button for ONE second (ensuring the key is in the ON position)

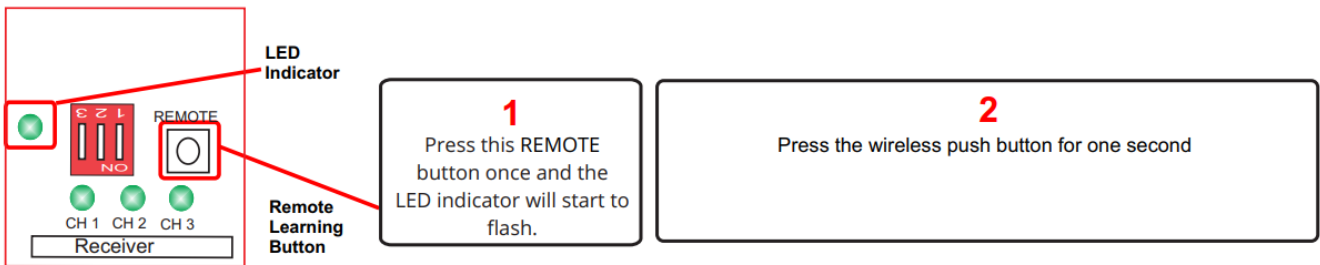

Deleting

- Press and hold the REMOTE button until the LED indicator is on solid then release the REMOTE button.

WARNING: This will delete all wireless equipment from the system.

Pairing

- Press the small STUDY button for ONE SECOND then release.
- Press any of the buttons on the wireless push button for ONE second (ensuring the key is in the ON position).

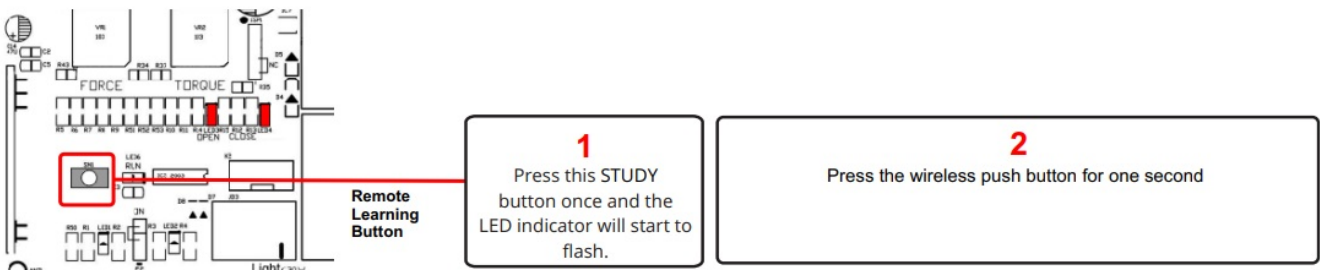

Deleting

Clearing the memory (Formatting)

- Press and hold the STUDY button for 5 seconds and a small BEEP will be heard. Release the STUDY button and all wireless equipment will be deleted.

WARNING: This will delete all wireless equipment from the system.

Pairing

- Press the small AUTO LEARN button once and the AUTO LEARN Green LED will turn on.
- Press any of the buttons on the wireless push button for ONE second (ensuring the key is in the ON position)

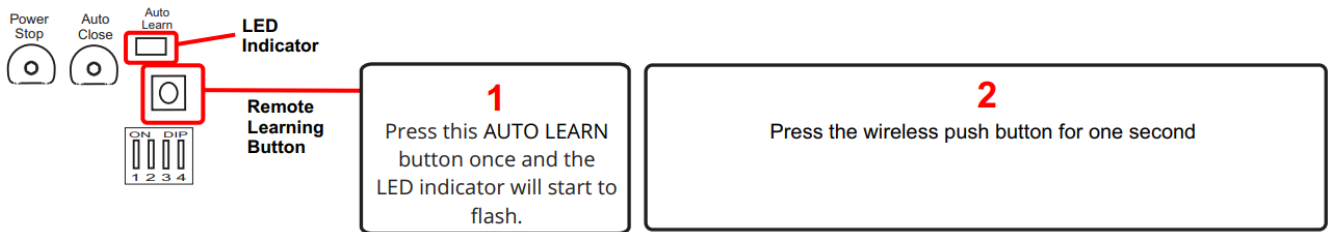

Deleting

Clearing the memory (Formatting)

- Press and hold the Auto Learn button for 7 seconds and the Green Auto Learn LED will start flashing, release the black button after 3 flashes and all wireless equipment will be cleared.

WARNING: This will delete all wireless equipment from the system.

Pairing

1. Press the LEARN CODE button once/twice to cycle to the function you wish to pair the remote button too.
2. Press any of the buttons on the wireless push button for ONE second (ensuring the key is in the ON position)

Repeat the above process for any additional remote's or wireless buttons that require programming.

LED2 Full Gate Opening

LED1 Pedestrian Function/Party Mode (refer to installation manual)

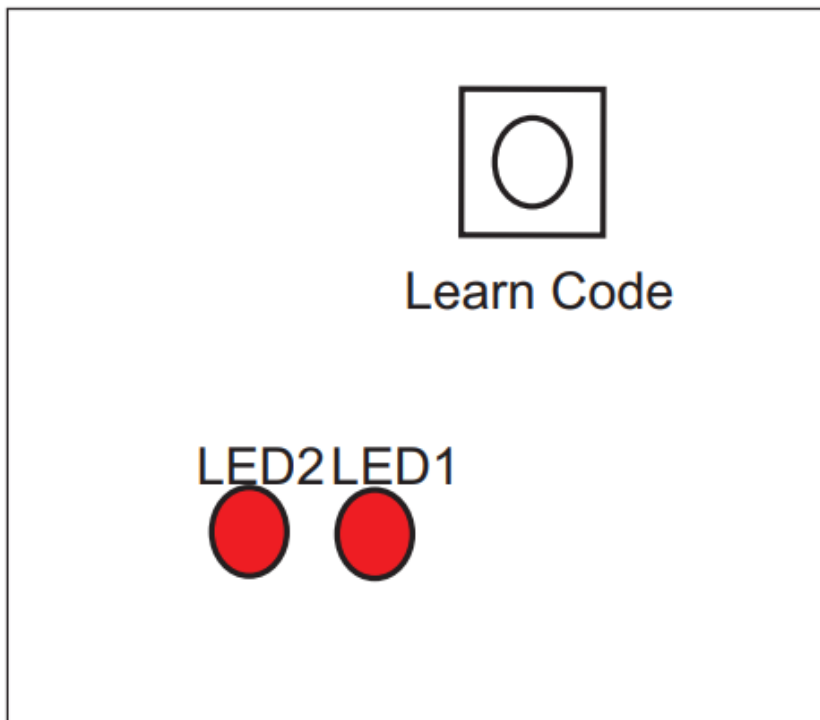

Deleting

1. PRESS AND HOLD the LEARN CODE button until BOTH LED's begin to flash simultaneously then release.

WARNING: This will delete all wireless equipment from the system.

Sliding Gate Systems

Pairing

- Press the button on the receiver once and the LED Indicator will start to flash.
- Press any of the buttons on the wireless push button for ONE second (ensuring the key is in the ON position).

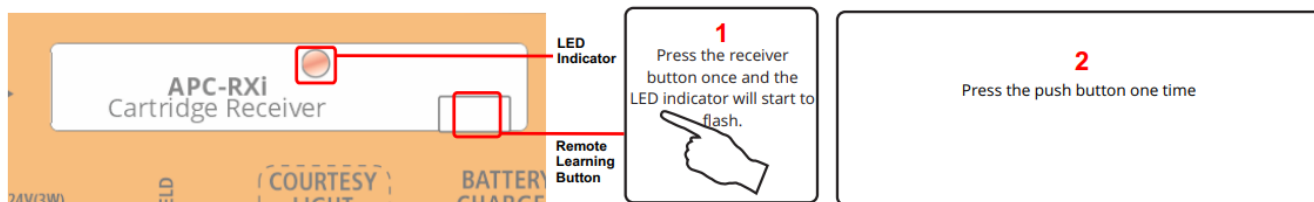

Deleting

- Turn off system power
- HOLD the button on the receiver whilst powering the system ON
- The LED's will blink FOUR times to indicate the process is complete, now the button can be released.

WARNING: This will delete all wireless equipment from the system.

Documents / Resources

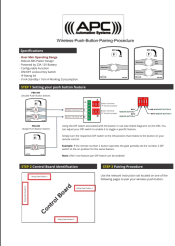
	<p>APC PBS-KW Wireless Push Button [pdf] User Manual</p> <p>PBS-KW Wireless Push Button, PBS-KW, Wireless Push Button, Push Button, Button</p>
---	--